

1 ROOF PLAN  
A-4.01 1/8" = 1'-0"

**ROOF PLAN LEGEND**

- EXISTING ROOF DRAIN. SEE KEY NOTE D-01
- EXISTING PARAPET. SEE KEY NOTE D-06
- ROOF SLOPE - 1/4" PER FOOT MIN. U.N.O.
- EXISTING ROOF SYSTEM TO REMAIN
- NEW PVC SINGLE PLY ROOF SYSTEM; W/ COVERBOARD OVER EXISTING BUILT-UP ROOFING SYSTEM. REMOVE EXISTING GRAVEL, TOPPING AND REMOVE & REPLACE DAMAGED INSULATION AS REQUIRED.

**GENERAL NOTES FOR REROOFING AREAS**

1. ALL EXISTING ITEMS TO REMAIN ARE TO BE PROTECTED THROUGHOUT DEMOLITION & CONSTRUCTION.
2. ALL ITEMS DAMAGED DURING DEMOLITION &/OR CONSTRUCTION SHALL BE REPAIRED OR REPLACED TO MATCH ORIGINAL.
3. CONTRACTOR TO FIELD VERIFY ALL EXISTING CONDITIONS PRIOR TO BEGINNING WORK.
4. PRIMARY SUBSTRATE SLOPES ARE INDICATED ON ROOF PLAN. CONTRACTOR TO FIELD VERIFY LOCATIONS OF EXISTING TAPERED INSULATION CRICKETS AND PROVIDE NEW WHERE REQUIRED TO MAINTAIN MINIMUM 1/2" PER FOOT DRAINAGE FOR REPLACEMENT ROOFING.
5. PAINT ALL EXPOSED NON-FINISHED EQUIPMENT INCLUDING ROOF MOUNTED PIPING & CONDUIT IN REROOFING AREA.
6. PROVIDE WALKWAY PROTECTION AT ALL CONDENSATE LINE SPLASHBLOCKS, AND 3'-0" PERIMETER AROUND MECHANICAL EQUIPMENT UNITS AND ROOF HATCH IN REROOFING AREA.
7. FLASH NEW ROOFING AT EXISTING WASTE VENTS AS DETAILED IN C7/A-4.10. CONTRACTOR TO FIELD VERIFY LOCATIONS AND QUANTITIES.

**ROOF PLAN KEY NOTES**

- REMOVE & DISPOSE OF EXISTING ROOF DRAIN STRAINER DOME AND CLAMPING RING. MEASURE, SIZE AND INSTALL NEW RETIGHT ROOF DRAIN PER MANUFACTURER'S RECOMMENDATIONS. REFER TO DETAIL C4/A-4.10.
- REMOVE & DISPOSE OF EXISTING OVERFLOW SCUPPER AND REPLACE WITH NEW - SEE DETAIL E4/A-4.10.
- REMOVE & DISPOSE OF EXISTING ROOF BALLAST, C.I. COVER/ FLASHING. PROVIDE NEW COVERBOARD, SINGLE-PLY ROOFING MEMBRANE, FLASHING, AND EXP. JT. COVER AT EXPANSION JOINT AS SHOWN IN DETAIL E1/A-4.10
- REMOVE & DISPOSE OF EXISTING BALLAST DOWN TO THE EXISTING ROOF FELLS & ADD NEW COVERBOARD & MEMBRANE ROOF. REFER TO DETAILS SHEET A-4.10.
- EXISTING ROOF HATCH, RTU, EXHAUST FANS & SUPPORT CURBS TO REMAIN. REFER TO DETAIL C1/A-4.10 FOR ROOFING DETAIL AT CURB.
- REMOVE & DISPOSE OF EXISTING PARAPET FLASHING AND REPLACE WITH NEW - SEE DETAILS F4B7/A-4.10

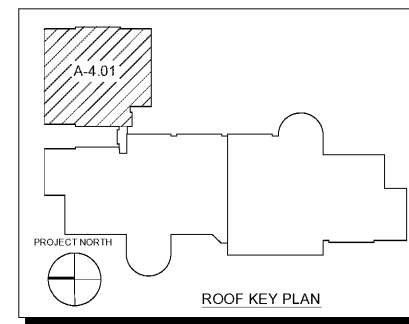

ARCHITECTURE  
MECHANICAL  
ELECTRICAL  
PLUMBING  
FACILITATION DESIGN

CHAPMAN GRIFFIN LANIER ARCHITECTS  
REGISTERED ARCHITECT



DATE	NO.	DESCRIPTION
10/11/18	000	FINAL SUBMITAL
10/28/18	001	ISSUE FOR BID

**ANNISTOWN ELEMENTARY SCHOOL  
ROOFING RENOVATIONS**  
FACILITY NO. 667-0282  
3150 Spain Road, Snellville, GA 30039  
GWINNETT COUNTY SCHOOL DISTRICT

PROJECT NO. 18007.01  
DATE OCTOBER 11, 2018

PROJECT TITLE  
ROOF PLAN

PROJECT NO. 18007.01  
DATE OCTOBER 11, 2018  
SHEET NO. A-4.01

CHAPMAN GRIFFIN LANIER SUSSENBACH ARCHITECTS  
400 Griffin Parkway • Suite 105 • Atlanta, Georgia 30309 • Phone 404.732.4400

Order Plans @ www.LDILine.com