

Order Plans @ WWW.LDILine.com

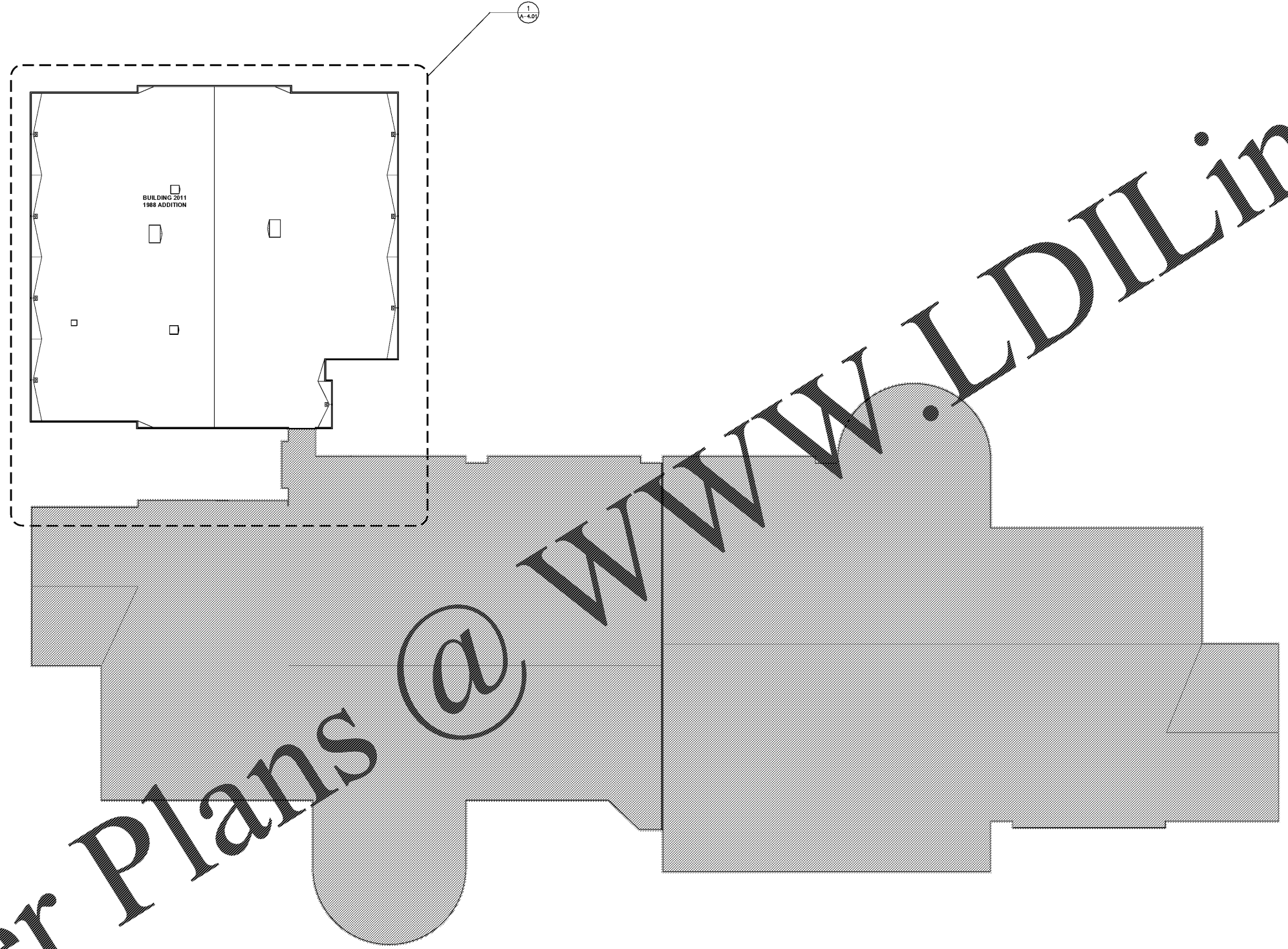

1 OVERALL REFERENCE ROOF PLAN
A-4.01/1/18 - 1'-0"

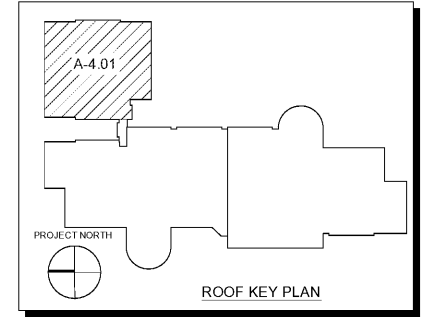

Architectural
Facilitation Design

CHAPMAN GRIFFIN LANIER SUSENBACH ARCHITECTS

ANNISTOWN ELEMENTARY SCHOOL
ROOFING RENOVATIONS
FACILITY NO. 667-0282
3150 Spain Road, Snellville, GA 30039
GWINNETT COUNTY SCHOOL DISTRICT

REBECCA S. LANIER
REGISTERED ARCHITECT

DATE	NO.	DESCRIPTION
10/11/18	000	FINAL SUBMITTAL
10/28/18	001	ISSUE FOR BID

PROJECT NO. 18007.01
DATE OCTOBER 11, 2018
SHEET NO. A-4.00

CHAPMAN GRIFFIN LANIER SUSENBACH ARCHITECTS
406 Griffin Parkway • Suite 105 • Atlanta, Georgia 30309 • Phone 404.732.4400