

GENERAL MOLDING NOTES

- A. REFER TO MOLDING FINISH SCHEDULE FOR INDIVIDUAL FINISH CODES.
- B. ALL MOLDING TO BE PAINT GRADE WOOD PAINTED SW7006 EXTRA WHITE. SEMI-GLOSS FINISH, UNLESS NOTED OTHERWISE.
- C. PLACE TOP OF CROWN MOLDING AT TOP OF ALL INTERIOR WALLS TO MATCH EXISTING CROWN HEIGHT ON ALL PERIMETER WALLS OF THE SHOWROOM UNLESS NOTED OTHERWISE.
- D. ALL WOOD CROWN AND BASE MOLDING THROUGHOUT THE ENTIRE SHOWROOM IS TO BE PAINTED WHITE COLOR EXTRA WHITE SW7006. ALL WOOD CROWN AND BASE MOLDING MUST BE PAINTED EXTRA WHITE THROUGHOUT.

MOLDING PLAN KEY NOTES

- MD 1. FILL AREA OF BETWEEN WALL DEMOLITION WITH CROWN AND BASE MOLDING TO MATCH EXISTING.
- MD 2. COORDINATE BASE MOLDING WITH EXISTING MILLWORK.

MOLDING FINISH LEGEND

- (M1) WOOD CROWN, 1 1/2" FLAT PROFILE CROWN MOLDING, 1/2" POPLAR/BASSWOOD, EXTRA WHITE SW7006
- (M2) WOOD BASE, 5 1/2" FLAT PROFILE BASE MOLDING, 1/6" POPLAR/BASSWOOD, EXTRA WHITE SW7006
- (M3) JOHNSONITE RUBBER BASE, 1/8" THICK, 4" HIGH, COVERED PROFILE, #32 PEBBLE
- (M4) WOOD CROWN, PROFILE TO MATCH EXISTING ADJACENT CROWN MOLDING, USE SALVAGE CROWN, NEW PAINT EXTRA WHITE SW7006
- (M5) WOOD BASE, PROFILE TO MATCH EXISTING ADJACENT BASE MOLDING, USE SALVAGE CROWN, NEW PAINT EXTRA WHITE SW7006
- (M6) PLINTH, 4" WIDE PLINTH TO SEPARATE ELEVATION CHANGE IN MOLDING, 1/6" POPLAR/BASSWOOD, EXTRA WHITE SW7006

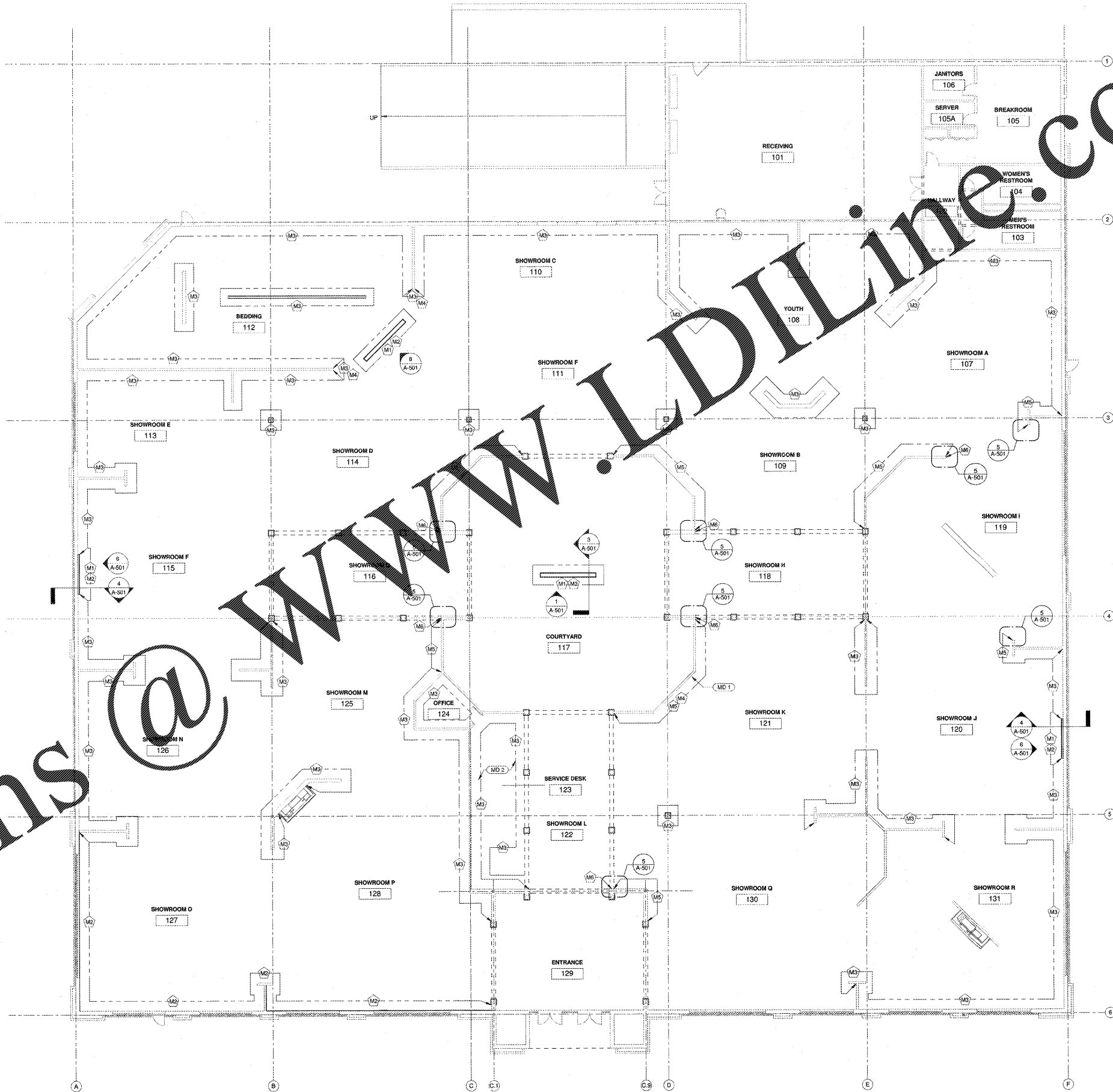

1 WALL FINISHES FLOOR PLAN - MOLDING
A-105 3/32" = 1'-0"

ROBERTSON DODIA ROOF ARCHITECTS ENGINEERS
3460 Preston Ridge Dr. Suite 275-A Marietta, GA 30065
770.674.2600 / www.rde.com



ASHLEY HOMESTORE
2475 MARKETPLACE BLVD
Cumming, GA 30040
FOR **ASHLEY HOMESTORE**
Arcadia, WI 54612

REVISIONS

NO.	DESCRIPTION

SHEET TITLE
WALL FINISHES FLOOR PLAN - MOLDING

DATE
10-29-2018

PROJECT NUMBER
18-303

SHEET NUMBER
A-105

Order Plans @