

ASHLEY FURNITURE HOMESTORE FLOORING SCHEDULE					
CODE	PRODUCT	MANUFACTURER/SUPPLIER	STYLE/COLOR	LOCATION	NOTES
CONCRETE					
(B1)	POLISHED CONCRETE	RETRO PLATE SYSTEM	CLASS B, LEVEL 3 SEMI-POLISH (UP TO 800 GRIT)	SHOWROOM	USE CRETE FILL PRO 85 JOINT FILLER AND SPALL REPAIR AS NEEDED TO MATCH.
CARPET					
(C1)	CARPET	SHAW CONTRACT GROUP	STYLE: LAYER 54182, COLOR: ZINC 83515	BEDDING	BROADLOOM
(C2)	CARPET	J+J INVISION	PASSAGES 7037 - AVENUE 2040	OFFICE AND BEHIND DESK	MODULAR 24" x 24" CARPET TILE
GROUT					
(G1)	GROUT	CUSTOM BUILDING PRODUCTS	396 OYSTER GRAY (TO MATCH EXISTING)	SHOWROOM	1/8" GROUT LINE
FLOOR TILE					
(T1)	FLOOR TILE	DALTILE	FINAL SPEC TBD DESIGNER SIMILAR DALTILE VERANDA SOLIDS - DUNE	SHOWROOM	20" X 20" UNPOLISHED STRAIGHT INSTALL, QUARTER TURN PATTERN, USE GROUT G-1
(T2)	FLOOR TILE	DALTILE	FINAL SPEC TBD DESIGNER TO MATCH DALTILE PETRE VEZICHE P162	SHOWROOM	20" X 20" UNPOLISHED STRAIGHT INSTALL, QUARTER TURN PATTERN, USE GROUT G-1
TRANSITION STRIPS					
(TS1)	TRANSITION STRIPS	CTC	1132 BCT17FRANZ 1132 - LIGHT BRONZE	CARPET TO CONCRETE	11/32" HEIGHT
(TS2)	TRANSITION STRIPS	CTC	CTC 99 REDUCER - LIGHT BRONZE	VINYL TO CONCRETE	1/8" HEIGHT
(TS3)	TRANSITION STRIPS	CTC	CTC RAMP XLK - LIGHT BRONZE	TILE TO CONCRETE	3/8" HEIGHT - CONTRACTOR MUST VERIFY CTC TRANSITION STRIPS IS APPROPRIATE FOR FLOOR CONDITIONS WITH ASHLEY PROJECT INTERIOR DESIGNER. IF NOT THEN NEW SPEC MUST BE SUBMITTED TO AND APPROVED BY THE ASHLEY PROJECT INTERIOR DESIGNER.
VINYL TILE					
(V1)	LUXURY VINYL TILE	SHAW CONTRACT GROUP	STYLE: GRAY DIRECT OLIVE 0502V COLOR: 84740	BEDDING ENTRANCE	7" X 48" NOMINAL

GENERAL FLOORING NOTES

- A. CONTRACTOR SHALL SUBMIT THE PLANS AS REQUIRED FOR REQUIRED BUILDING PERMITS.
- B. CONTRACTOR TO PROTECT ALL ADJACENT SURFACES FROM DAMAGE. IF DAMAGE DOES OCCURE, THE CONTRACTOR WILL BE RESPONSIBLE FOR REPAIR/REPLACEMENT.
- C. ALL WORK TO BE SCHEDULED AND COORDINATED WITH THE STORE MANAGER AND CONSTRUCTION MANAGER. STORE PERSONNEL WILL MOVE DISPLAY FURNITURE AS REQUIRED TO COMPLETE THIS WORK. ALL FURNITURE MOVES MUST BE COORDINATED WITH THE STORE MANAGER.
- D. FLOORING REMOVAL AND INSTALLATION SHALL BE COORDINATED SO NO AREAS ARE LEFT INACCESSIBLE TO NON-CONSTRUCTN PERSONNEL OR HAZARDOUS.
- E. CONTRACTOR TO CLEN WORK AREAS AS NEEDED AT THE END OF EACH WORKDAY.
- F. REMOVAL: REMOVE EXISTING FLOORING AS NOTED ON PLAN AND DISPOSE OF PROPERLY. REMOVE ALL BOND BREAKERS, WAX, GREASES/OILS, OLD ADHESIVE, AND OTHER RESIDUE/DEBRIS.
- G. INSTALLATION: INSTALL PER FLOORING PLAN
 - a. PATCH LEVEL, AND/OR SKIM ALL DAMAGED, LOOSE OR UNEVEN AREAS.
 - b. PREP FLOOR ACCORDING TO MANUFACTURER'S INSTRUCTIONS.
 - c. ALL TRANSITION STRIPS TO BE LOCATED IN THE MIDDLE OF DOOR/OPENING UNLESS NOTED OTHERWISE.
 - d. ALL TRANSITION STRIPS TO BE JHONSONITE PEBBLE UNLESS NOTED OTHERWISE.
- H. ALL FLOORING ANGLES TO BE 90 DEGREE AND/OR 45 DEGREE ANGLES UNLESS NOTED OTHERWISE.
- I. J+J INVISION CARPET TO BE INSTALLED ACCORDING TO THE MANUFACTURER'S INSTRUCTIONS.
- J. SHAW CARPET AND LUXURY VINYL TILE TO BE INSTALLED ACCORDING TO THE MANUFACTURER'S REQUIREMENTS.
- K. TILE TO BE INSTALLED ACCORDING TO THE LATEST TCNA HANDBOOK FOR CERAMIC, GLASS AND STONE TILE INSTALLATION. ALL TILE OVER 12 INCHES WIDE TO BE SET IN A MEDIUM BED MORTAR.
- L. TILE PATCHING IN THE ENTRANCE AREA INCLUDES CHIPPING OUT ALL PARTIAL TILES AFFECTED BY DEMOLITION OR NEW CONSTRUCTION. TYPICALLY TAKING OUT TILES IN A RECTANGULAR SHAPE AND REPLACING TILES IN THEIR REPLACEMENT IS IDEAL.
- M. TILE PATCHING IN COURTYARD INCLUDES CHIPPING OUT ALL PARTIAL TILES AFFECTED BY DEMOLITION AS WELL AS FULL TILES TO CREATE DIAMOND SHAPE.
- N. ALL GROUT IN AREAS WHERE THE EXISTING TILE IS TO REMAIN IS TO BE REPAIRED AND/OR REPLACED AS NEEDED. GENERAL CONTRACTOR TO EXAMINE ALL TILE AREAS AND MATCH EXISTING GROUT COLOR.
- O. ALL FLOORING QUANTITIES TO BE MEASURED AND VERIFIED BY THE OWNER AND/OR THE FLOORING CONTRACTOR PRIOR TO INSTALLATION.
- P. LEVEL FLOOR UNDER NEW CARPET TO PROVIDE A SMOOTH TRANSITION FROM CARPET TO EXISTING TILE.
- H. CONTACTS:
 - a. CTC: CONTACT LOCAL DEALER
 - b. J+J INVISION: CARRIE PERCY 800-241-4586 EXT. 6616
 - c. DALTILE: HOPE AISLRIN DACHEL 414-406-5198
 - d. SHAW CONTRACT GROUP: BRAD RYAN 800-345-4149
- I. IF EXISTING TILE IS DAMAGED DURING DEMOLITION IT MUST BE REPLACED WITH EQUAL SPECIFICATION SUBMITTED TO AND APPROVED BY ASHLEY PROJECT INTERIOR DESIGNER.

MATERIAL FLOORING LEGEND

- (B) CONCRETE
- (C1) CARPET
- (C2) CARPET TILE
- EXISTING TILE/VCT
- EXISTING PLANK TILE
- (T1) TILE
- (V1) LUXURY VINYL COMPOSITION TILE
- (TS) TRANSITION STRIPS

FLOOR FINISH PLAN KEY NOTES

FF 1	REPLACE ALL CRACKED TILE IN THESE AREAS WITH TILES. APPROXIMATELY 10 TILES TO BE REPLACED.
FF 2	REPLACE APPROXIMATELY 88 FLOOR TILES AROUND GROUT LINES TO CREATE RECTANGULAR SHAPES AROUND NEW WALL. REFER TO FINISH PLAN WITH ASHLEY DESIGNER.

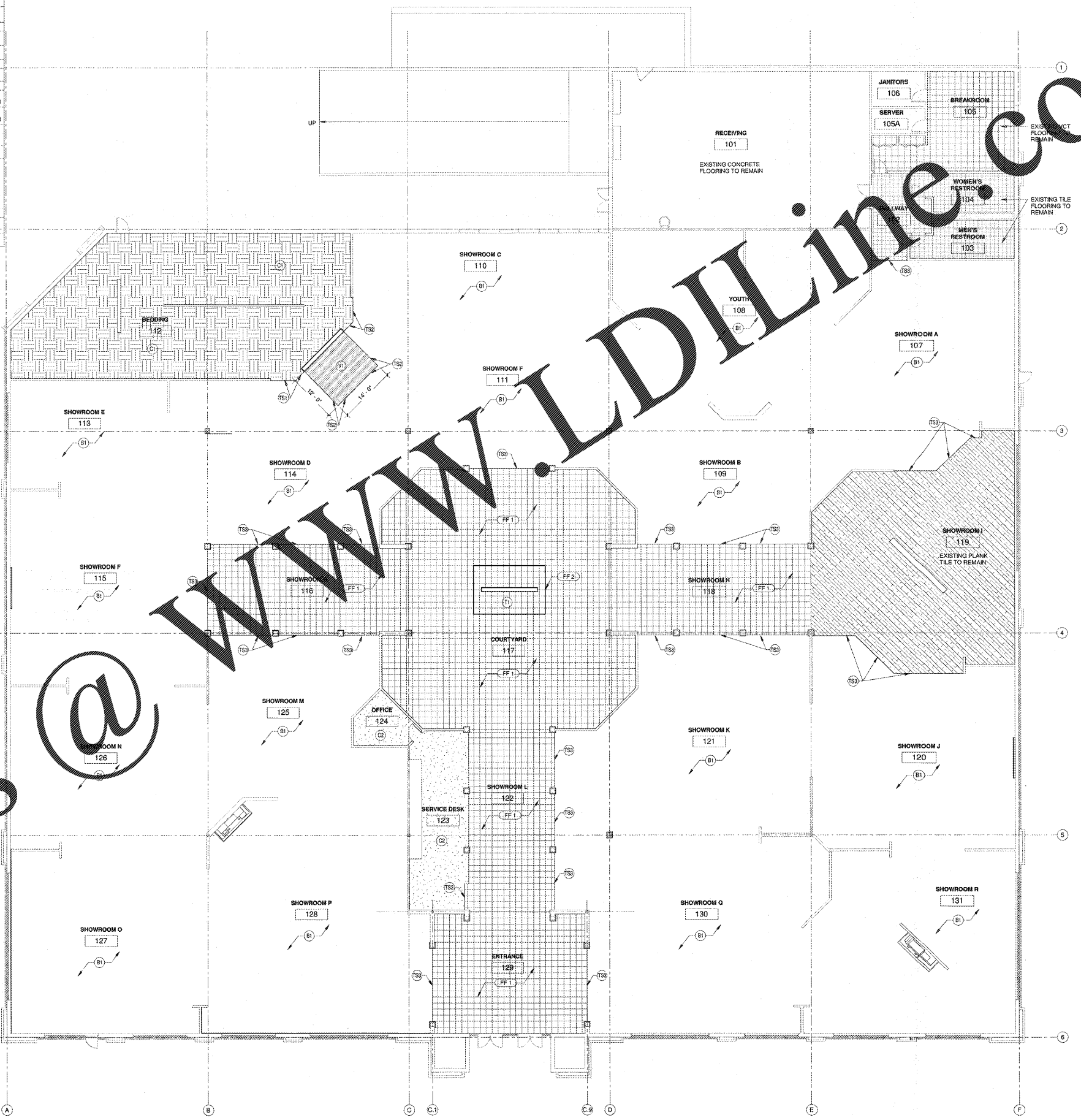

1 FLOOR FINISH PLAN
3/32" = 1'-0"

ROBERTSON INDIA ROOF ARCHITECTS ENGINEERS
3400 Preston Ridge Road, Suite 275 - Alpharetta, GA 30005
770.674.1300 / www.rind.com

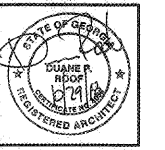

ASHLEY HOMESTORE
2475 MARKETPLACE BLVD
Cumming, GA 30040
FOR **ASHLEY HOMESTORE**
One Ashley Way
Arcadia, WI 54612

REVISIONS

NO.	DESCRIPTION

SHEET TITLE
FLOOR FINISH PLAN

DATE
10-29-2018

PROJECT NUMBER
18-303

SHEET NUMBER
A-104

Order Plans