

GENERAL NOTES

- A. INTERIOR WALLS 15'-0" OR BELOW ARE TYPICAL 3/8" AT 16" ON CENTER STEEL STUD CONSTRUCTION UNLESS NOTED OTHERWISE. INTERIOR WALLS HIGHER THAN 15'-0" ARE 6" STEEL STUD CONSTRUCTION. CONTRACTOR TO SUPPORT ALL WALLS FROM CEILING WITH STUDS AS NEEDED.
- B. ALL NEW INTERIOR WALLS TO BE AS NOTED ON PLANS WITH BASE AND CROWN MOLDING APPLIED UNLESS NOTED OTHERWISE. WALLS MUST BE DRYWALLED, TAPED, MUDGED, PRIMED AND PAINTED PER PLAN. ALL GYPSUM BOARD TO BE 5/8" UNLESS NOTED OTHERWISE. GYPSUM BOARD FINISH TO BE LEVEL 4.
- C. ALL OUTSIDE CORNERS OF INTERIOR WALLS TO HAVE 3/4" RADIUS BULLNOSE CORNER TRM. USE WHITE CAULK TO FILL VOID WHERE BULLNOSE CORNER AND WOOD MOLDING MEET. USE MOLDED CORNER TO JOIN BULLNOSE AT INSIDE OF OPENINGS (TRIM-TEX #003).
- D. ALL FIRE EXTINGUISHER ARE TO REMAIN IN EXISTING LOCATIONS OR RELOCATED AS NEEDED IN ORDER TO COMPLY WITH LOCAL CODE. ALL FIRE EXTINGUISHER TO BE LOCATED AS NOTED ON PLAN UNLESS RESTRICTED BY CODE. IF LOCATIONS ARE REQUIRED TO BE MOVED, CONTACT ASHLEY DESIGNER TO VERIFY NEW LOCATION.
- E. ALL AREAS OF BASE MOLDING DEMO MUST BE FILLED AND PATCHED FLUSH WITH WALL FACE AS NEEDED TO PREPARE FOR NEW OR REUSED BASE MOLDING. PATCH, SAND AND REFINISH GYP. BOARD TO NEW LEVEL 4 FINISH.

FLOOR PLAN KEY NOTES

- FP 1 1 1/2" THICK DOUBLE STUDDED WALL END STUDS TO BE RUN FROM FLOOR TO BAR JOIST OR CEILING DECK TO SUPPORT NEW WALL AS NEEDED. REFER TO DETAIL 204-102. PAINT STUDS TO MATCH CEILING SW6108 LATTICE. FLAT FINISH.
- FP 2 FACE OF MOMENT WALL TO BE BUILT OUT FROM FLOOR TO 12'-0" AFF. USING 3 5/8" STUDS AND DRYWALLED ON THE FACE AND SIDES.
- FP 3 TOP OF GYP. BOARD TO BE LEVEL, CLEAN, AND SMOOTH.
- FP 4 1/2" PLYWOOD BACKING TO BE INSTALLED IN BETWEEN STUDS AND FLUSH WITH STUD FACE ON THE ENTIRE WIDTH OF THE WALL FROM 4'-6" TO 8'-6" AFF TO SUPPORT TV ON WALL.
- FP 5 REPLACE UPPER TRANSACTION, BACK CREDENZA AND PENINSULA COUNTERTOPS WITH NEW. SEE DETAILS ON PAGE A-502 FOR NEW LAMINATE FINISHES.
- FP 6 FILL AND PATCH WINDOW SILL DAMAGED AREAS TO BE FLUSH WITH ADJACENT WALL/SILL FACE. PATCH, SAND, AND REFINISH GYP. BOARD TO NEW LEVEL 4 FINISH.
- FP 7 INSTALL NEW "GEN NOW" (SG-2) SIGN IN AREA. FINAL LOCATION TBD ASHLEY DESIGNER AND STORE MANAGER.
- FP 8 FILL AND PATCH WALL AROUND DEMOLITION TO BE FLUSH WITH ADJACENT WALL FACE. PATCH, SAND, AND REFINISH GYP. BOARD TO NEW LEVEL 4 FINISH.
- FP 9 MINIMUM 4'-0" x 4'-0" x 1/2" PLYWOOD BACKING TO BE INSTALLED IN BETWEEN STUDS AND FLUSH WITH STUD FACE FROM 3'-6" TO 7'-6" AFF TO SUPPORT TV ON WALL.
- FP 10 1/2" PLYWOOD BACKING TO BE INSTALLED IN BETWEEN STUDS AND FLUSH WITH STUD FACE ON THE ENTIRE WIDTH OF THE WALL TO SUPPORT SHELVES AND CABINETS ON THE WALL.
- FP 11 EDGE PROTECTION (EP-1) TO BE INSTALLED TO CONCEAL EXPOSED WALLCOVERING EDGE. MUD TO WALL TO ENSURE PROPER WALLCOVERING ADHESION. COORDINATE WITH DETAILS ON PAGE A-501.
- FP 12 FAUX CREAM BRICK (WA-1) TO BE INSTALLED OVER FINISHED GYPSUM BOARD PER MANUFACTURER'S INSTALLATION INSTRUCTIONS. MITER AND CONCEAL EXPOSED EDGES. TOUCH-UP AS NEEDED.
- FP 13 SHIP LAP (WA-2) TO BE INSTALLED OVER FINISH GYP. BOARD PER MANUFACTURER'S INSTALLATION INSTRUCTIONS. MITER OUTSIDE CORNERS AND CONCEAL EXPOSED EDGES. TOUCH-UP AS NEEDED.
- FP 14 NEW DOCK SEAL BY RITE-HITE, MODEL PDSC-ASH, 22' PROJECTION WITH A FIB 24" HEAD CUSHION, 22 OZ. BLACK VINYL BASE 43 OZ. ARMORED PLEATS WITH 8' EXPOSURE. CONTRACTOR SHALL CONFIRM THE 1% SLOPE FOR THE FIRST 50' OF THE DOCK APPROACH TO DETERMINE THE PROPER TAPER OF SEAL.

CORNER RADIUS DETAIL

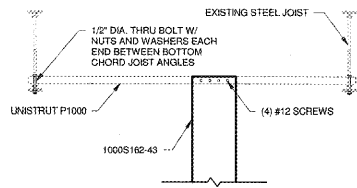
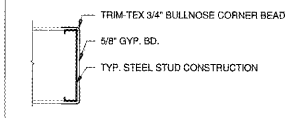

WALL BRACING DETAIL

2 A-102 3/4" = 1'-0"

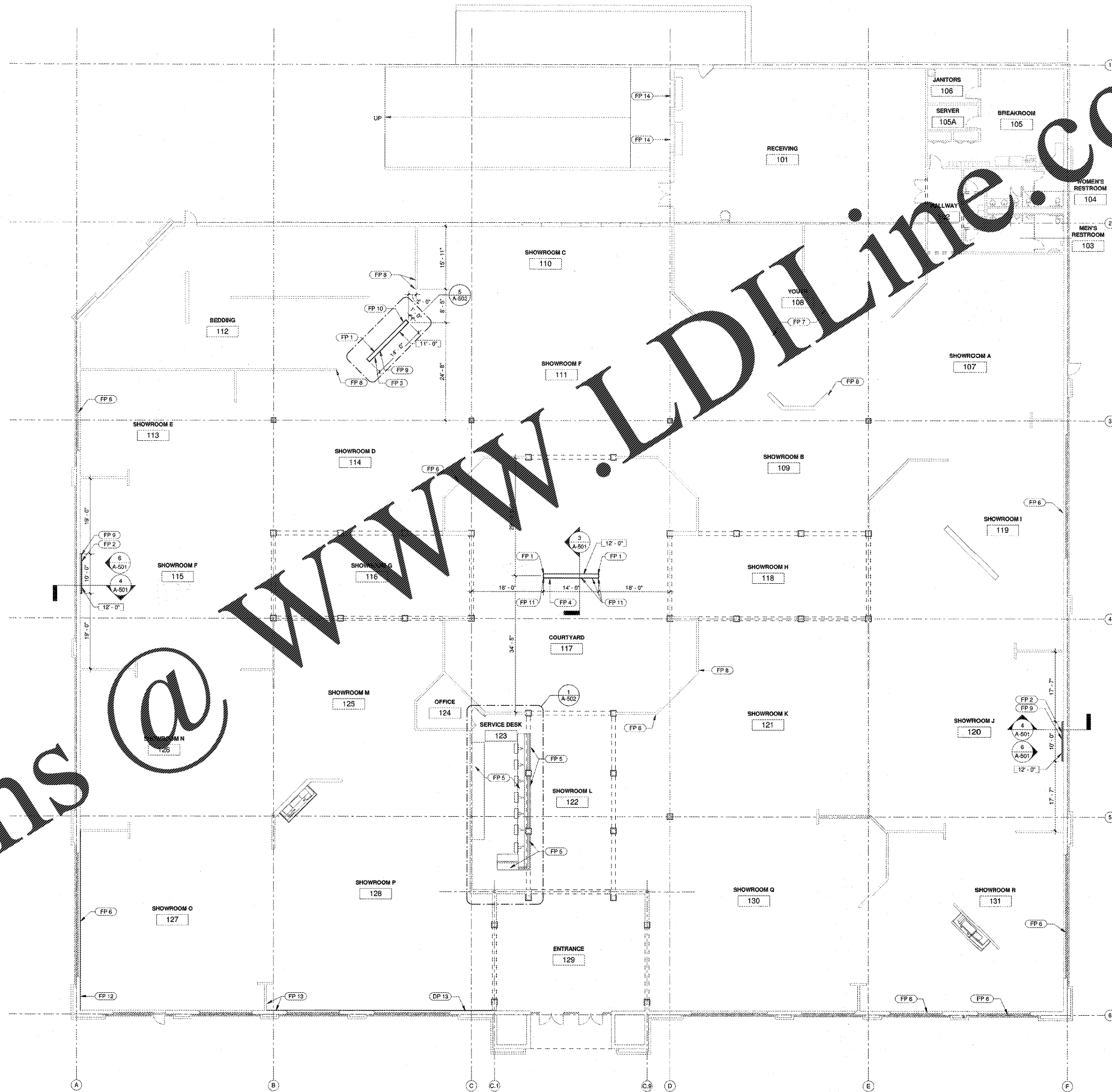

FLOOR PLAN
3/32" = 1'-0"

ROBERTSON INDIA ROOF ARCHITECTS ENGINEERS
3460 Preston Ridge Rd., Suite 275, Marietta, GA 30066
770.674.2600 / www.rif.com

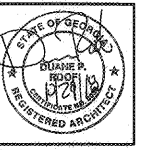

ASHLEY HOMESTORE
2475 MARKETPLACE BLVD
Cumming, GA 30040
FOR **ASHLEY HOMESTORE**
Arcadia, WI 54612

REVISIONS

SHEET TITLE
FLOOR PLAN

DATE
10-29-2018

PROJECT NUMBER
18-303

SHEET NUMBER
A-102

Order Plans @