

GENERAL REFLECTED CEILING DEMOLITION NOTES

- A. GENERAL CONTRACTOR SHALL BECOME FAMILIAR WITH THE BUILDING AND SHALL VERIFY ALL ITEMS TO BE REMOVED. THIS DRAWING IS PROVIDED FOR REFERENCE ONLY. IT IS THE GENERAL CONTRACTOR'S RESPONSIBILITY TO VERIFY AND ACHIEVE THE FULL EXTENT OF DEMOLITION REQUIRED FOR NEW CONSTRUCTION AND REMODELING.
- B. GENERAL CONTRACTOR SHALL REMOVE CEILINGS, CEILING ELEMENTS, AND LIGHT FIXTURES AS SHOWN ON PLANS. ANY UNUSED OR NON-FUNCTIONAL CEILING GRID, SUPPORTS, CONDUIT, WIRING, AND/OR MECHANICAL EQUIPMENT SHOULD ALSO BE REMOVED. VERIFY EXISTING SPRINKLER HEAD LOCATIONS AND USE CAUTION DURING CEILING REMOVAL. VERIFY LIMITS OF EXISTING CEILINGS ON JOBSITE.
- C. GENERAL CONTRACTOR SHALL SAVE AND STORE ITEMS INDICATED TO BE REMOVED IN AN ON-SITE OWNER-DESIGNATED LOCATION TO PREVENT DAMAGE.
- D. GENERAL CONTRACTOR SHALL DISPOSE OF ITEMS DESIGNATED HEREIN FOR SALVAGE BY THE OWNER THAT OWNER-IN-FACT DECIDES NOT TO RETAIN.
- E. GENERAL CONTRACTOR SHALL BE RESPONSIBLE FOR EXTENT OF EXISTING MECHANICAL AND ELECTRICAL DEMOLITION WORK AND ALL WORK REQUIRED TO MAINTAIN THE BUILDING'S OPERATION.
- F. GENERAL CONTRACTOR SHALL PREPARE EXISTING SURFACES FOR NEW FINISHES AT LOCATIONS OF ALL DEMOLITION, FINISH REMOVAL, AND PRODUCT REMOVAL. ALL ROUGH, PROTRUDING, OR UNEVEN SURFACES SHALL BE LEVELED TO MATCH SURROUNDING CONDITIONS.
- G. GENERAL CONTRACTOR TO FIELD VERIFY ALL QUANTITIES AND MEASUREMENTS PRIOR TO BIDDING.

REFLECTED CEILING DEMOLITION KEY NOTES

RCD 01	REMOVE EXISTING FABRIC CIRCLES. VERIFY SPRINKLER HEAD LOCATIONS AND USE CAUTION DURING REMOVAL.
RCD 02	REMOVE SUSPENDED YOUTH SIGN. VERIFY SPRINKLER HEAD LOCATIONS AND USE CAUTION DURING REMOVAL.
RCD 03	REMOVE ALL BEDDING COLUMNS AND RAFTERS, WALLS, COLUMNS, AND BUILT IN SHELVINGS AS SHOWN ON SHEET A-100.

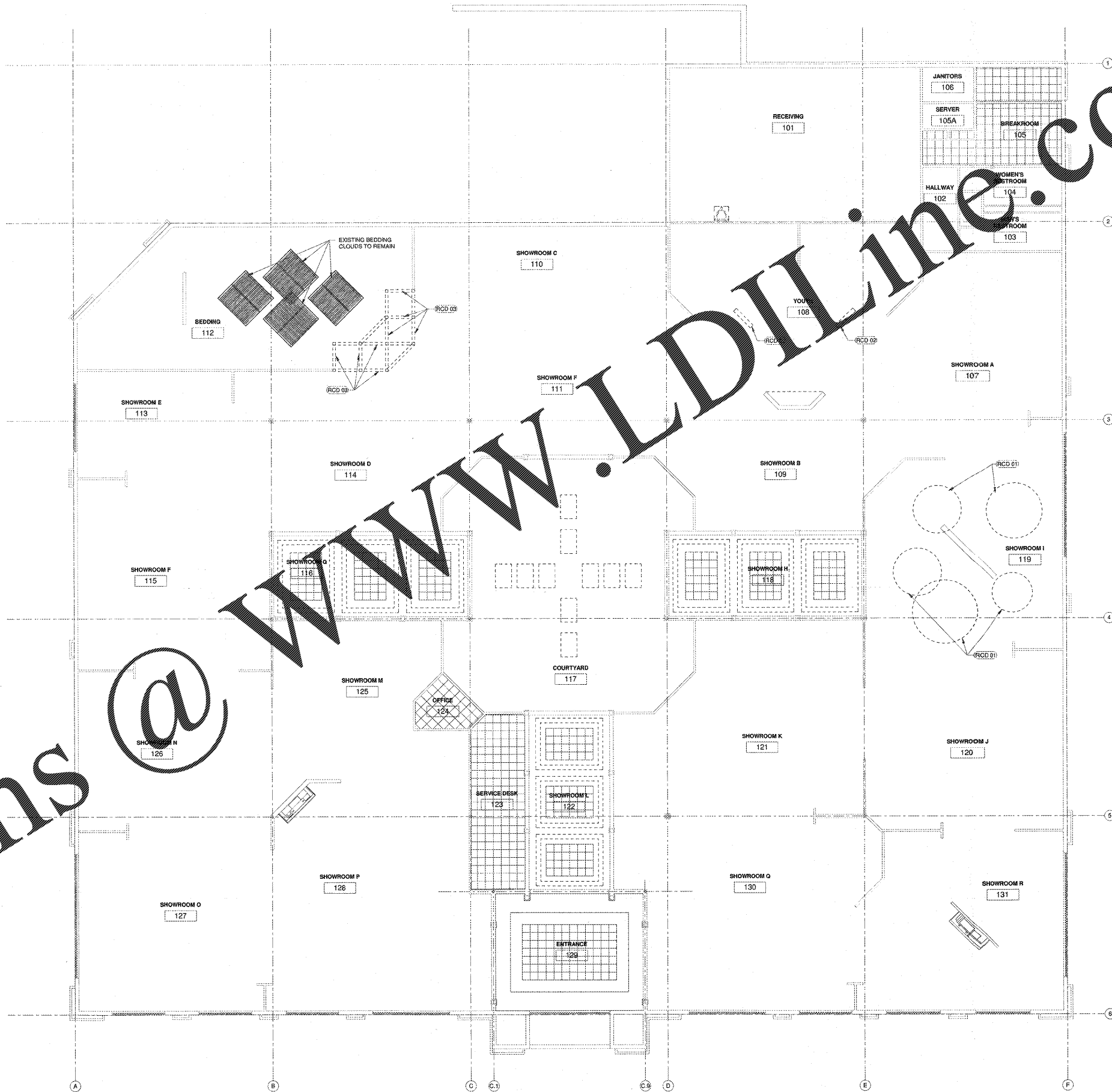

Order Plans @

WWW.LDILine.com

**ROBERTSON DIXIA ROOF ARCHITECTS ENGINEERS**  
 3460 Preston Ridge Rd.  
 Suite 275 - A  
 Marietta, GA 30065  
 770.974.5800 / www.rde.com

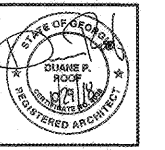

**ASHLEY HOMESTORE**  
 2475 MARKETPLACE BLVD  
 Cumming, GA 30040  
**ASHLEY HOMESTORE**  
 One Ashley Way  
 Arcadia, WI 54612

REVISIONS

SHEET TITLE  
**REFLECTED CEILING DEMOLITION PLAN**

DATE  
 10-29-2018

PROJECT NUMBER  
 18-303

SHEET NUMBER  
**A-101**