

GENERAL DEMOLITION NOTES

- A. GENERAL CONTRACTOR SHALL BECOME FAMILIAR WITH THE BUILDING AND SHALL VERIFY ALL ITEMS TO BE REMOVED. THIS DRAWING IS PROVIDED FOR REFERENCE ONLY. IT IS THE GENERAL CONTRACTOR'S RESPONSIBILITY TO VERIFY AND ACHIEVE THE FULL EXTENT OF DEMOLITION REQUIRED FOR NEW CONSTRUCTION AND REMODELING.
- B. GENERAL CONTRACTOR SHALL SAVE AND STORE ITEMS INDICATED TO BE SALVAGE IN AN ON-SITE OWNER-DESIGNATED LOCATION TO PREVENT DAMAGE. GENERAL CONTRACTOR SHALL DISPOSE OF ITEMS INDICATED BY REMOVED UNLESS NOTED OTHERWISE.
- C. GENERAL CONTRACTOR SHALL REMOVE ALL EXISTING FLOORING AS NOTED ON PLAN AND DISPOSE OF PROPERLY. REMOVE BOND BREAKERS, WAX, GREASE/OILS, OLD ADHESIVE, AND OTHER RESIDUE/DEBRIS. REMOVE ALL MISCELLANEOUS OBSTRUCTIONS.
- D. GENERAL CONTRACTOR SHALL DISPOSE OF ITEMS DESIGNATED HEREIN FOR SALVAGE BY THE OWNER THAT OWNER-IN-FACT DECIDES NOT TO RETAIN.
- E. GENERAL CONTRACTOR SHALL BE RESPONSIBLE FOR EXTENT OF EXISTING MECHANICAL AND ELECTRICAL DEMOLITION WORK AND ALL WORK REQUIRED TO MAINTAIN THE BUILDING'S OPERATION.
- F. GENERAL CONTRACTOR SHALL PREPARE EXISTING SURFACES FOR NEW FINISHES AT LOCATIONS OF ALL DEMOLITION. FINISH REMOVAL AND PRODUCT REMOVAL. ALL ROUGH, PROTRUSING, OR UNEVEN SURFACES SHALL BE LEVELED TO MATCH SURROUNDING CONDITIONS.
- G. GENERAL CONTRACTOR SHALL REMOVE ALL DAMAGED, STAINED OR DISCOLORED ACOUSTIC CEILING TILES AND REPLACE WITH EQUAL. VERIFY EXISTING SPRINKLER HEAD LOCATIONS AND USE CAUTION DURING CEILING REMOVAL. VERIFY LIMITS OF EXISTING CEILING ON JOBSITE.
- H. GENERAL CONTRACTOR TO FIELD VERIFY ALL QUANTITIES AND MEASUREMENTS PRIOR TO BIDDING.
- I. GENERAL CONTRACTOR SHALL REMOVE 10 CRACKED TILES AND REPLACE WITH NEW. SEE FLOORING PLAN ON PAGE A-104.

DEMOLITION PLAN KEY NOTES

DP 1	REMOVE EXISTING CARPETING AS NOTED ON PLAN. REMOVE EXISTING BASE MOLDING UNLESS NOTED OTHERWISE.
DP 2	REMOVE EXISTING VINYL TILE/PLANK AS NOTED ON PLAN. REMOVE EXISTING BASE MOLDING.
DP 3	REMOVE EXISTING FOUNTAIN AND ALL OF ITS COMPONENTS INCLUDING THE TILE SURROUNDING. TERMINATE POWER AND CAP PLUMBING BELOW FLOOR AS INDICATED BY LOCAL CODE. PATCH FLOOR AS NEEDED TO PREPARE FOR NEW TILE.
DP 4	REMOVE SURROUNDING WHOLE 20" FLOOR TILE ALONG THE GROUT LINE. DEMOLISHED TILE AREA TO BE APPROX. 86 TILES. COORDINATE FINAL AREA WITH FLOORING PLAN ON SHEET A-104.
DP 5	REMOVE EXISTING 8 FT HIGH NONSTRUCTURAL WALL. TERMINATE POWER AS DIRECTED BY LOCAL CODE.
DP 6	REMOVE DECORATIVE WALL SCONES. TERMINATE POWER AS DIRECTED BY LOCAL CODE. INSTALL NEW COVERPLATE OVER J-BOX. ALMOND COLOR.
DP 7	REMOVE 4 FT HIGH WALLS. DEMOLITION TO END AT HIGHER WALLS. PATCH SURFACES WHERE DEMOLITION OCCURS TO NEW CONDITION. TERMINATE POWER AS DIRECTED BY LOCAL CODE.
DP 8	REMOVE WORK COUNTER TO PREPARE FOR NEW. SEE DETAIL ON PAGE A-502.
DP 9	REMOVE UPPER TRANSACTION COUNTER AND UNDER COUNTER LIGHTING ALONG FRONT OF SERVICE DESK TO PREPARE FOR NEW COUNTER. TERMINATE POWER AND DATA AS DICTATED BY LOCAL CODE. SEE DETAIL ON PAGE A-502.
DP 10	REMOVE EXISTING LAMP WALL AND LIGHTING. TERMINATE POWER AS DICTATED BY LOCAL CODE. PATCH FLOOR AS NEEDED TO PREPARE FOR NEW POLISHED CONCRETE.
DP 11	REMOVE EXISTING WALL SHELVING AND COUNTER AND ALL EXISTING COMPONENTS. TERMINATE POWER AS DICTATED BY LOCAL CODE. PATCH AND PREPARE WALL FOR NEW PAINT.
DP 12	REMOVE EXISTING CARPETED SEATING AREA AND ALL OF ITS COMPONENTS. PATCH FLOOR AS NEEDED TO PREPARE FOR NEW CARPET.
DP 13	REMOVE EXISTING PLAY CABINETS AND ALL OF ITS COMPONENTS INCLUDING THE TVS AND WALL SCONES. TERMINATE POWER AS DICTATED BY LOCAL CODE. PATCH FLOOR AS NEEDED TO PREPARE FOR NEW CARPET.
DP 14	REMOVE ALL BEDDING ENTRY WALLS, COLUMNS, BUILT IN SHELVING, AND RAPTERS ABOVE. RAPTERS SHOWN ON SHEET A-101. TERMINATE POWER AS DICTATED BY LOCAL CODE. PATCH FLOOR AS NEEDED TO PREPARE FOR NEW CARPET.
DP 15	REMOVE CRACKED FLOOR TILES IN EXISTING TILED AREA. APPROXIMATELY 10 TILES IN TOTAL TO BE REPLACED.
DP 16	NOT USED.
DP 17	REMOVE SECTION OF EXISTING FLG MOLDING AND CAP ENDS. TERMINATE POWER AS DICTATED BY LOCAL CODE. PATCH WALLS AS NEEDED TO PREPARE FOR NEW PAINT.
DP 18	REMOVE MIDDLE MOLDING AT APPROX 8 FT HIGH ON EXISTING BEDDING AREA WALLS. PATCH WALL AS NEEDED TO PREPARE FOR NEW PAINT.
DP 19	REMOVE EXISTING 12 FT HIGH NONSTRUCTURAL WALL. TERMINATE POWER AS DICTATED BY LOCAL CODE. SALVAGE DOUBLE CROWN MOLDING TO BE USED TO PATCH GAP ON ADJOINING WALL. SEE MOLDING PLAN ON SHEET A-105.

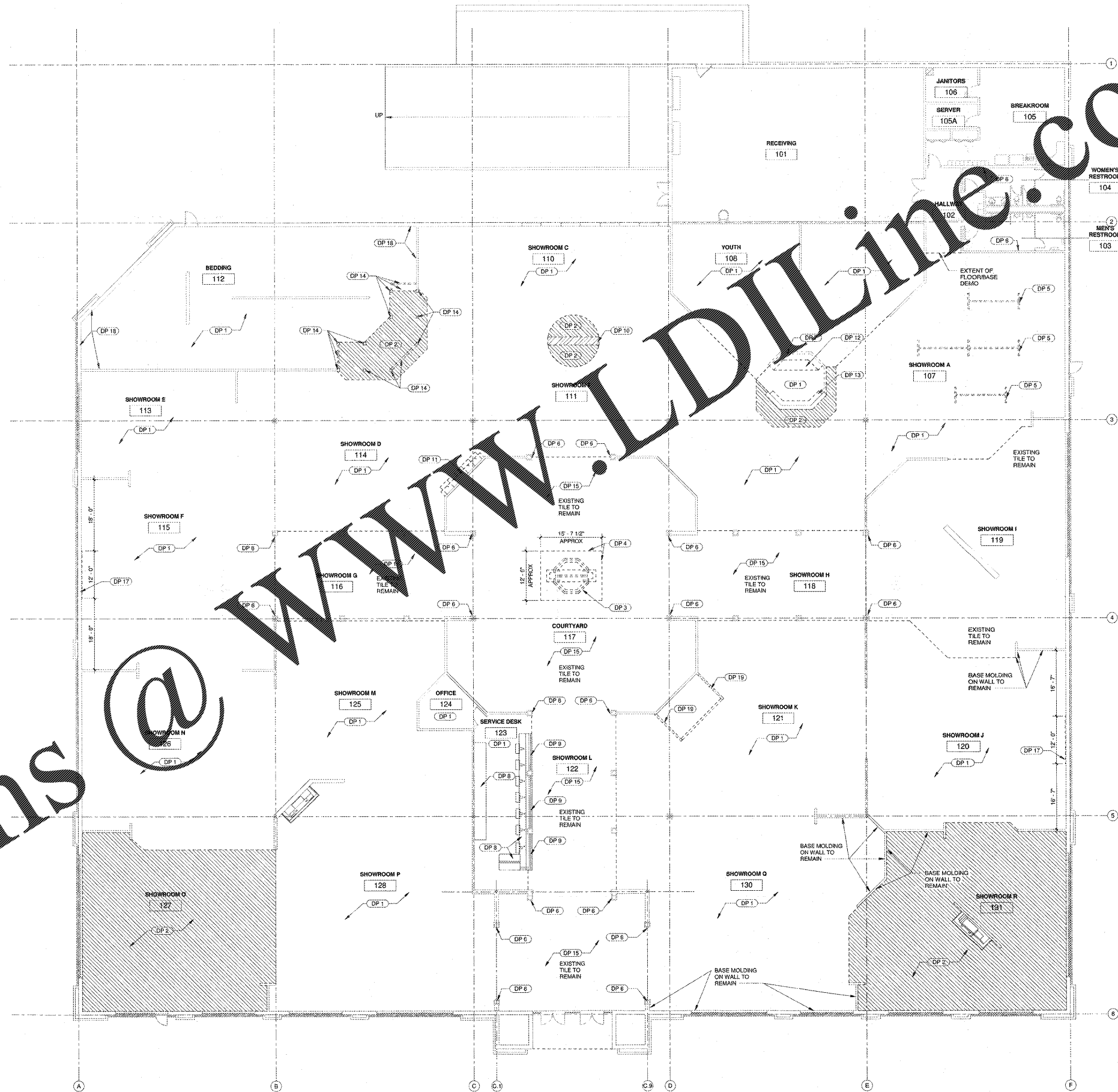

Order Plans

ROBERTSON DIA ROOF ARCHITECTS ENGINEERS
3400 Preston Ridge Road, Suite 275 - Alpharetta, GA 30005
 770.674.5000 / www.rdia.com

ASHLEY HOMESTORE
 2475 MARKETPLACE BLVD
 Cumming, GA 30040
 One Ashley Way
 Arcadia, WI 54612

DEMOLITION FLOOR PLAN

DATE: 10-29-2018
 PROJECT NUMBER: 18-303
 SHEET NUMBER: A-100

DEMOLITION FLOOR PLAN
 3/32" = 1'-0"