

DRAWING ISSUE RECORD		
DATE:	REVISIONS:	NO.
11-1-08	ISSUE TO BID	



HARMONY LELAND-CLOVER SCHOOL
 REPLACEMENT ELEMENTARY SCHOOL
 63246 FACTORY SHOALS RD. S.W.
 HABLETON, GA 30226
 FOR COBB COUNTY SCHOOL DISTRICT
 CCAD PROJECT NO. 00867 / DOE FACILITY SIDE #188

cunningham forhand matthews moore
 cunningham, forhand, matthews & moore, architects, inc. - 2011 manchester street, n.e. - atlanta, georgia 30324 - phone (404) 873-2152
 DATE: JUL 16, 2010
 JOB NO: SHL-1502-10
 DRAWN BY: AK

A8.1

5 TYPICAL STAIR RISER/TREAD DETAIL
 (A8.1) 11'-10"

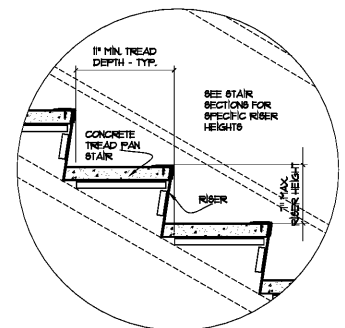

6 TYPICAL HANDRAIL RETURN DETAIL
 (A8.1) 3'-10"

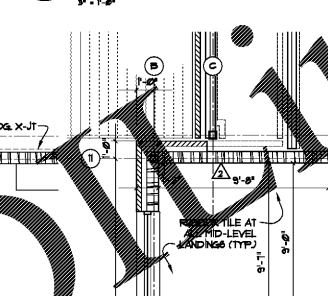

7 TYPICAL CLOSURE TRIM ALONG STAIR STRINGERS
 (A8.1) 1'-0"

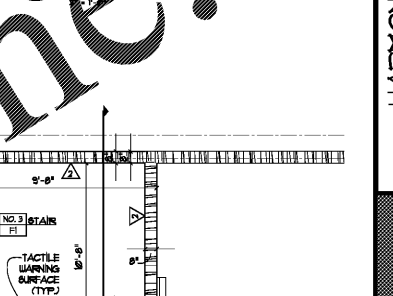

2 STAIR #3 MAIN LEVEL PLAN
 (A8.1) 14'-0"

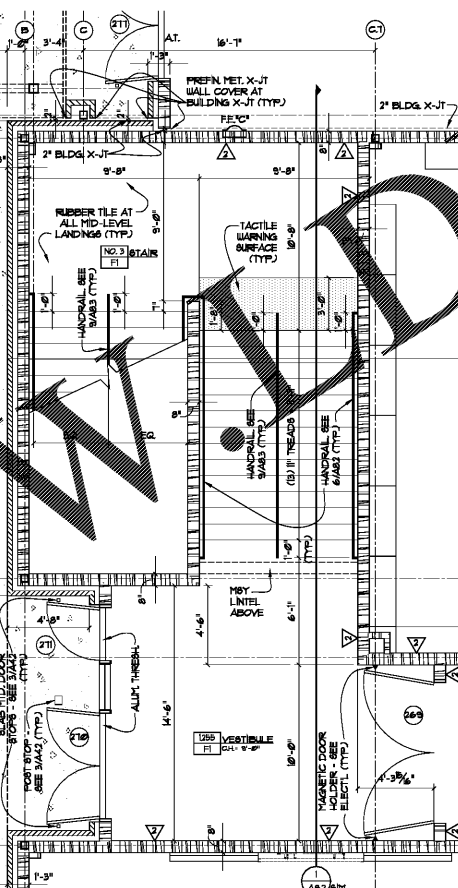

3 STAIR #3 UPPER LEVEL PLAN
 (A8.1) 14'-0"

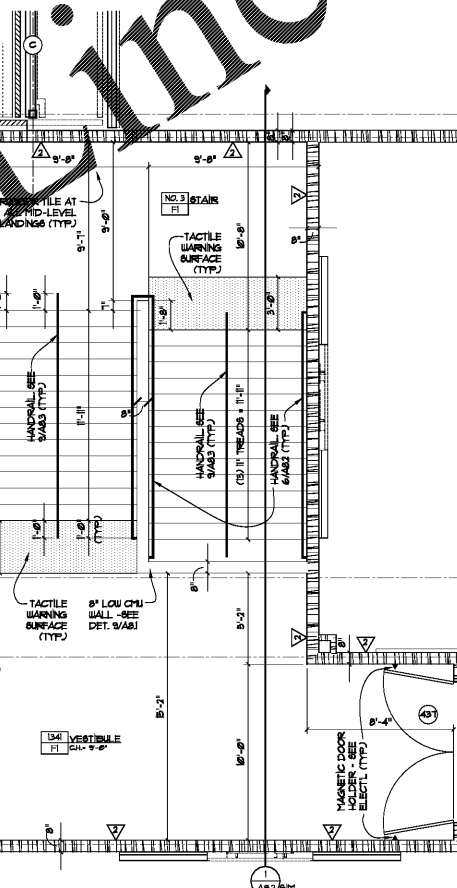

1 SECTION THRU STAIR
 (A8.1) 12'-0"

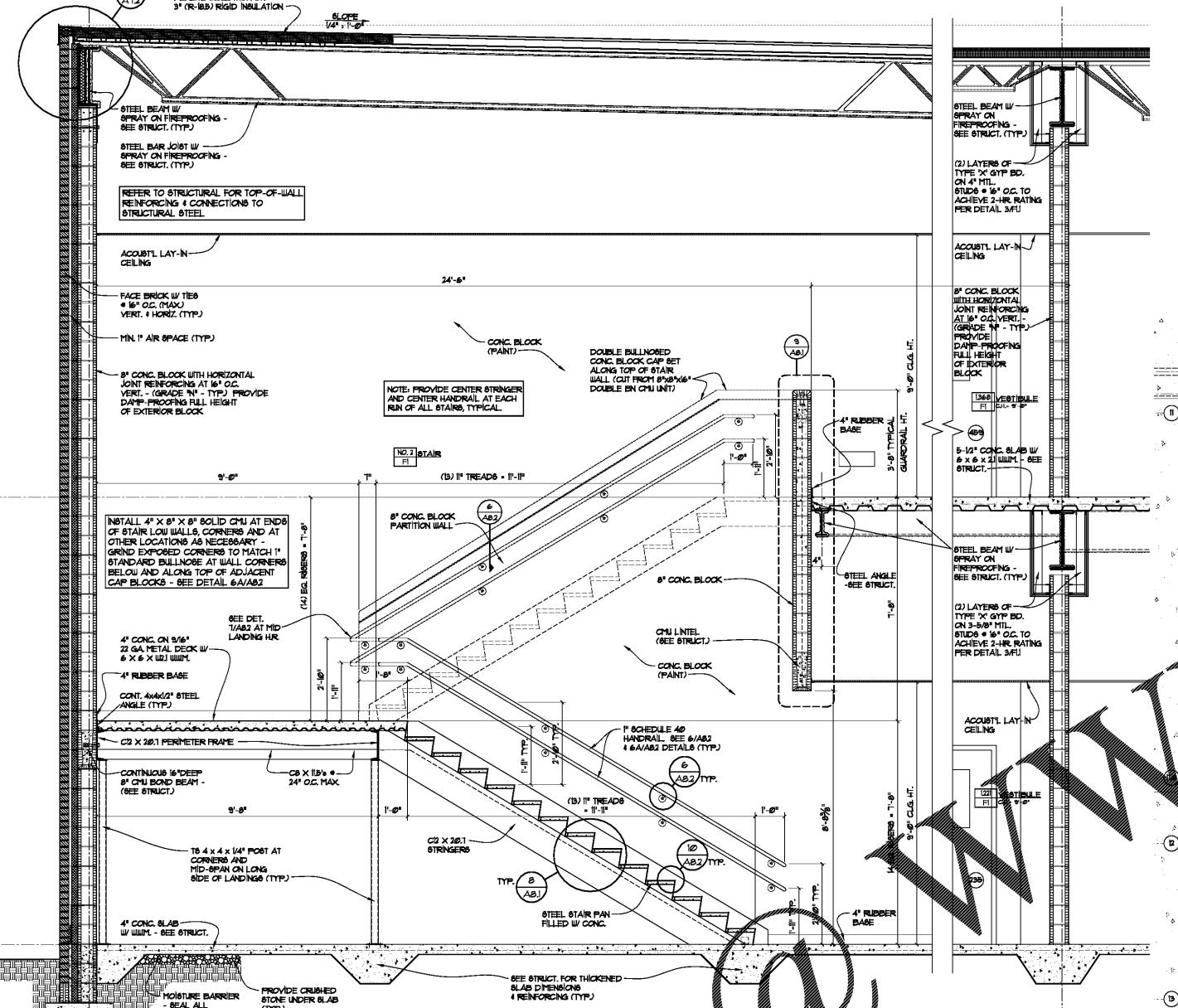

4 STAIR #2 MAIN LEVEL PLAN
 (A8.1) 14'-0"

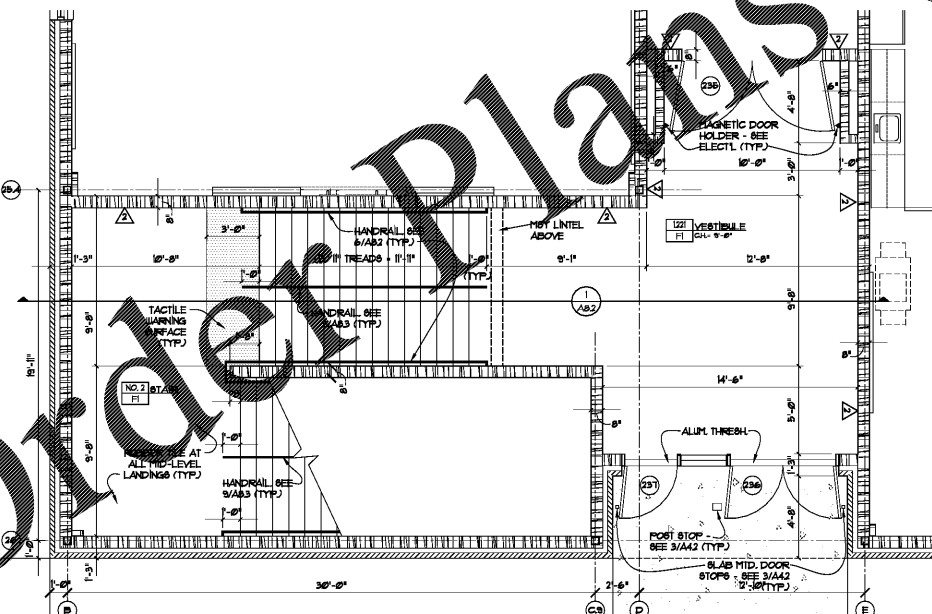

3 STAIR #2 UPPER LEVEL PLAN
 (A8.1) 14'-0"

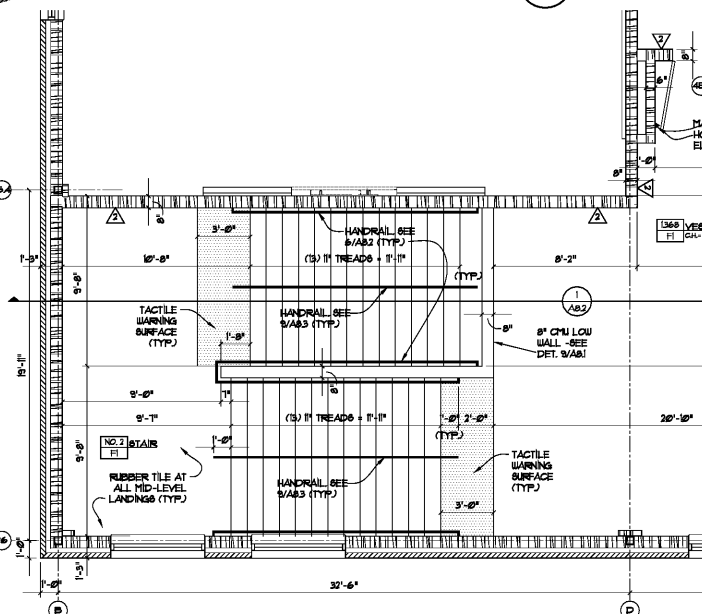

9 TYPICAL CMU BALCONY RAIL WALL AND CMU FUR-DOWN
 (A8.1) 1'-0"

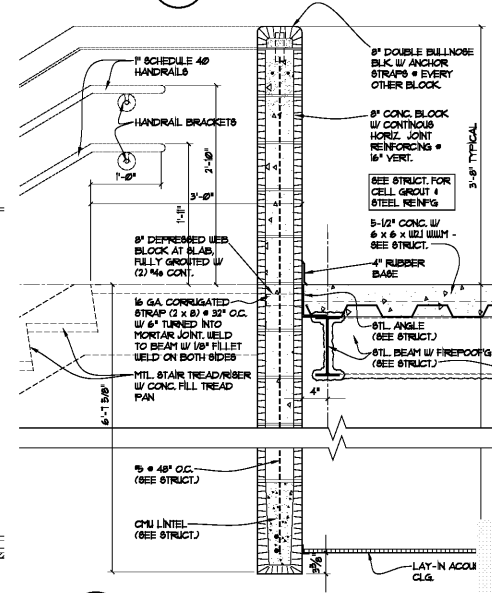

DO NOT DUPLICATE
 WITHOUT PERMISSION

