

DRAWING ISSUE RECORD		
DATE	REVISIONS	NO.
11-1-18	ISSUE TO BID	

HARMONY LELAND ELEMENTARY SCHOOL
 REPLACEMENT ELEMENTARY SCHOOL
 6398 FACTORY SHOALS RD. SU
 HABLETON, GA 30128
 FOR COBB COUNTY SCHOOL DISTRICT
 COBB COUNTY, GA
 CCSD PROJECT No. A6884 / DOE FACILITY CODE

TREE REMOVAL PLAN

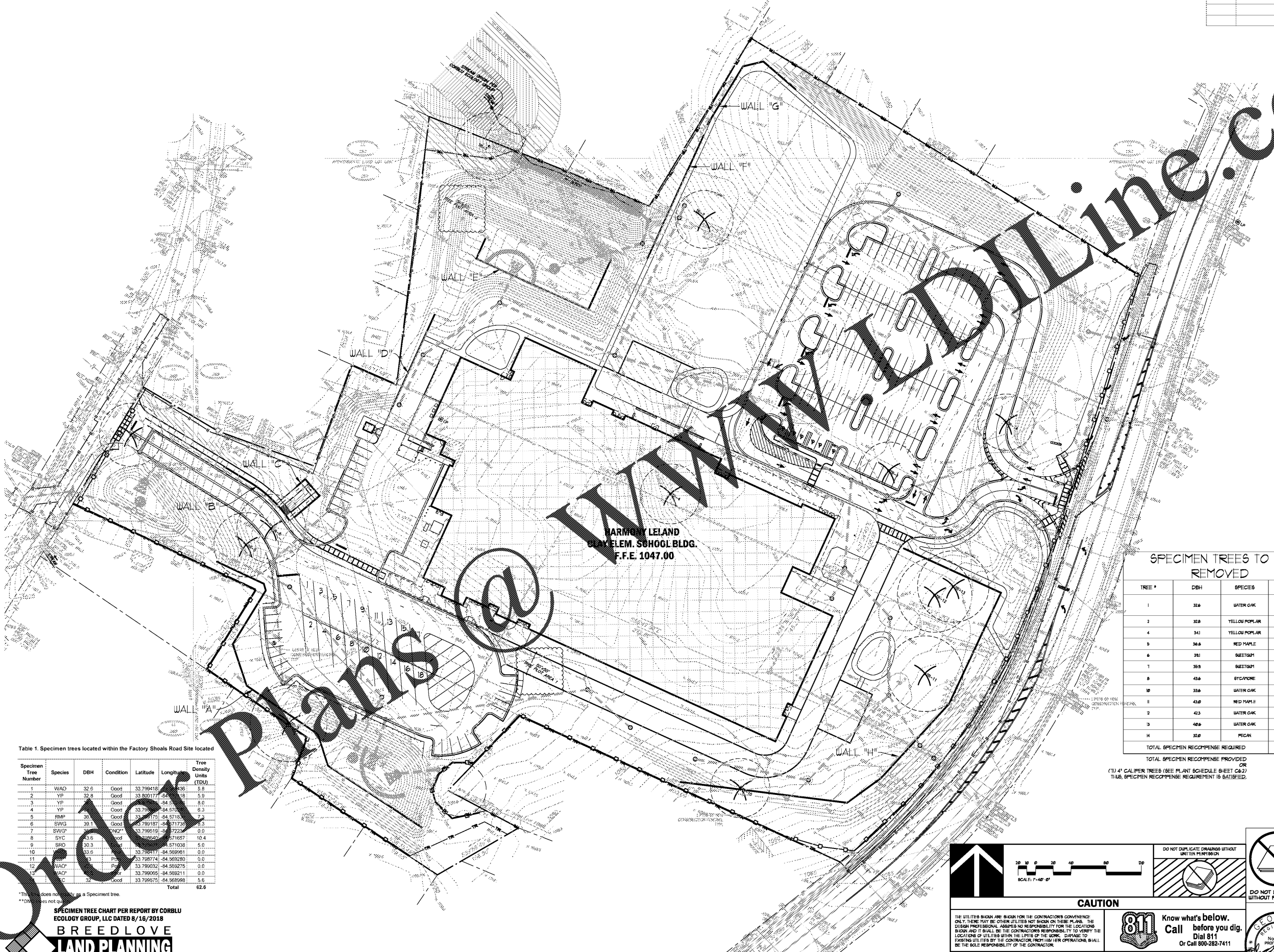

HARMONY LELAND
 ELEM. SCHOOL BLDG.
 F.F.E. 1047.00

SPECIMEN TREES TO BE REMOVED

TREE #	DBH	SPECIES	UNIT VALUE
1	32.6	WATER OAK	5.8
2	32.8	YELLOW POPLAR	5.5
4	34.1	YELLOW POPLAR	6.3
5	36.6	RED MAPLE	13
6	39.1	BEECH	8.3
7	35.5	BEECH	6.0
8	43.6	SPYGLASS	10.4
10	33.6	WATER OAK	6.0
11	43.0	RED MAPLE	6.0
12	42.3	WATER OAK	6.0
13	40.6	WATER OAK	6.0
14	32.0	PISACAN	5.6
TOTAL SPECIMEN RECOMPENSE REQUIRED			45.6
TOTAL SPECIMEN RECOMPENSE PROVIDED			45.6

(11) 4" CALIBER TREES (SEE PLANT SCHEDULE SHEET C6-2)
 THIS SPECIMEN RECOMPENSE IS SATISFIED.

Table 1. Specimen trees located within the Factory Shoals Road Site located

Specimen Tree Number	Species	DBH	Condition	Latitude	Longitude	Tree Density Units (TDU)
1	WAO	32.5	Good	33.799416	-84.57136	5.8
2	YP	32.8	Good	33.800777	-84.57138	5.5
3	YP	34.1	Good	33.799729	-84.57138	6.3
4	YP	36.6	Good	33.799729	-84.57138	13
5	RMP	39.1	Good	33.799175	-84.57183	8.3
6	SWG	35.5	Good	33.799187	-84.57173	6.0
7	SWG	35.5	Good	33.799519	-84.57223	6.0
8	SYG	43.6	Good	33.799247	-84.57187	10.4
9	SWO	33.6	Good	33.799108	-84.57108	6.0
10	SWO	33.0	Good	33.799111	-84.569961	6.0
11	WAO	33.6	Good	33.799774	-84.569280	6.0
12	WAO	33.6	Good	33.799032	-84.569275	6.0
13	WAO	33.6	Good	33.799055	-84.569211	6.0
14	PIS	32.0	Good	33.799575	-84.569598	5.6
Total						62.6

**This does not qualify as a Specimen tree.
 **DBH does not qualify.

SPECIMEN TREE CHART PER REPORT BY CORBLU
 ECOLOGY GROUP, LLC DATED 8/16/2018

BREEDLOVE LAND PLANNING
 Landscape Architects • Civil Engineers
 www.landplanning.net
 B.P. JOB 16414

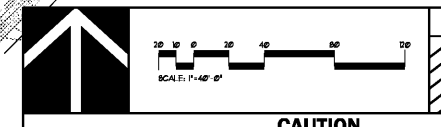

DO NOT DUPLICATE DRAWINGS WITHOUT WRITTEN PERMISSION

DO NOT DUPLICATE WITHOUT PERMISSION

CAUTION

THE UTILITIES SHOWN ARE SHOWN FOR THE CONTRACTOR'S CONVENIENCE ONLY. THERE MAY BE OTHER UTILITIES NOT SHOWN ON THESE PLANS. THE DESIGN PROFESSIONAL ASSUMES NO RESPONSIBILITY FOR THE LOCATIONS SHOWN AND IT SHALL BE THE CONTRACTOR'S RESPONSIBILITY TO VERIFY THE LOCATIONS OF UTILITIES WITHIN THE LIMITS OF THE WORK. DAMAGE TO EXISTING UTILITIES BY THE CONTRACTOR FROM HIS/HER OPERATIONS, SHALL BE THE SOLE RESPONSIBILITY OF THE CONTRACTOR.

811 Know what's below. Call before you dig. Dial 811
 Or Call 800-282-7411



CONTRACTOR SHALL BE RESPONSIBLE TO OBTAIN THE SERVICES OF A PRIVATE UTILITY LOCATOR PRIOR TO THE START OF CONSTRUCTION. CONTRACTOR SHALL PAY FOR SAID SERVICES. CONTRACTOR SHALL PREPARE AND BACKFILL BY LOCAL UTILITIES SUCH AS POWER, GAS, TELEPHONE, ETC. CONTRACTOR SHALL PROVIDE ADDITIONAL BACKFILL AND COMPACTION AS NECESSARY, IF SETTLEMENT OCCURS.

CONTRACTOR SHALL BE RESPONSIBLE FOR COMPACTION OF BACKFILL OF ALL UTILITY TRENCHES WITHIN SITE WORK LIMITS. THIS INCLUDES TRENCHES DUG AND BACKFILLED BY LOCAL UTILITIES SUCH AS POWER, GAS, TELEPHONE, ETC. CONTRACTOR SHALL PROVIDE ADDITIONAL BACKFILL AND COMPACTION AS NECESSARY, IF SETTLEMENT OCCURS.

cunningham forehand matthews moore

cunningham, forehand, matthews & moore, architects, inc. - 2011 manchester street, n.e. - atlanta, georgia 30324 - phone (404) 873-2152

C6.1