

SPILL CLEANUP & CONTROL PRACTICES 25

- LOCAL STATE & MANUFACTURER'S RECOMMENDED METHODS FOR SPILL CLEANUP WILL BE CLEARLY POSTED & PROCEDURES WILL BE MADE AVAILABLE TO SITE PERSONNEL.
MATERIAL & EQUIPMENT NECESSARY FOR SPILL CLEANUP WILL BE KEPT IN THE MATERIAL STORAGE AREA...

DISTURBANCE SUMMARY 6

TOTAL SITE AREA: 15.02 ACRES
ON-SITE DISTURBANCE: 14.9 ACRES
% OF SITE: 99%
DISTURBANCE W/IN R.W.: 0.5 ACRES
TOTAL PROJECT DISTURBANCE: 15.4 ACRES

INTERMEDIATE EROSION CONTROL PHASE "A" SUMMARY

THE CONTRACTOR SHALL MAINTAIN ALL BMPs INSTALLED DURING THE INITIAL PHASE AND REQUIRED DURING THE INTERMEDIATE PHASE OF EROSION CONTROL AS SHOWN UPON COMMENCING OF GRADING AND INSTALLATION OF THE STORM STRUCTURES...

STORMWATER POLLUTANT CONTROL NARRATIVE 26 27

CONSTRUCTION OF THE PROPOSED BUILDING, PARKING AREA, AND SITE IMPROVEMENTS WILL YIELD AN INCREASE IN PERVIOUS AREA (AND FLOW) COMPARED TO EXISTING CONDITIONS...

PAM FLOC / GEL BAR REQUIREMENT

CONTRACTOR SHALL INSTALL DRY FLOC GEL BARS IN THE INVERT OF EACH STORM STRUCTURE AS PART OF INITIAL BMP INSTALLATION

UNIFORM CODING SYSTEM 49

SEE SHEET C-2 FOR UNIFORM CODING SYSTEM FOR SOIL EROSION AND SEDIMENT CONTROL

SLOPE STABILIZATION NOTE

SLOPE STABILIZATION MATING (SM) SHALL BE APPLIED TO ALL SLOPES 3:1 & STEEPER

TO BE SHOWN ON THE EROSION, SEDIMENTATION AND POLLUTION CONTROL PLAN
When a FLAGGING SURFACE SKIRMER is used, show the following information along with each sediment point, trap or basin being used on the site:
1. Brand, trap or basin size, height (top and bottom) and depth
2. Time to Drain (hrs) = 3.699 OF 24-48 HOURS
3. Skimmer Dimensions (width and head size) 4 INCH SKIRMER, 1/2" DIA ORifice
4. Manufacturer's name, FARGLORE

ES&PC DESIGN PROFESSIONAL'S CERTIFICATION STATEMENT
I CERTIFY UNDER PENALTY OF LAW THAT THIS PLAN WAS PREPARED AFTER A SITE VISIT TO THE LOCATIONS DESCRIBED HEREIN BY MYSELF OR MY AUTHORIZED AGENT, UNDER MY SUPERVISION.
Signed: [Signature] DATE: 1-11-2018

DRAWING ISSUE RECORD
DATE: 1-11-18
REVISIONS:
ISSUE TO BID

- CONTRACTOR SHALL CONTACT THE DESIGN PROFESSIONAL WHO PREPARED THE ES&PC PLAN TO INSPECT THE INSTALLATION OF THE INITIAL SEDIMENT STORAGE REQUIREMENTS AND PERIMETER CONTROL BMPs WITHIN 7 DAYS AFTER INSTALLATION
NON-EXEMPT ACTIVITIES SHALL NOT BE CONDUCTED WITHIN THE 25 OR 50-FOOT UNDISTURBED STREAM BUFFERS AS MEASURED FROM THE POINT OF WRESTED VEGETATION WITHOUT FIRST ACQUIRING THE NECESSARY VARIANCES AND PERMITS

CONTRACTOR SHALL INSTALL HATCHABLE CHECKGATE AT END OF ANY SHORTCUT WHEN AFTER CONDITIONS FORECAST RAIN
EXISTING FENCE TO BE SAVED DELINEATES THE LIMITS OF DISTURBANCE, TYP.

CONTRACTOR SHALL MAINTAIN ALL BMPs INSTALLED DURING THE INITIAL PHASE AND REQUIRED DURING THE INTERMEDIATE PHASE OF EROSION CONTROL AS SHOWN UPON COMMENCING OF GRADING AND INSTALLATION OF THE STORM STRUCTURES...

CONTRACTOR SHALL MAINTAIN ALL BMPs INSTALLED DURING THE INITIAL PHASE AND REQUIRED DURING THE INTERMEDIATE PHASE OF EROSION CONTROL AS SHOWN UPON COMMENCING OF GRADING AND INSTALLATION OF THE STORM STRUCTURES...

CONTRACTOR SHALL MAINTAIN ALL BMPs INSTALLED DURING THE INITIAL PHASE AND REQUIRED DURING THE INTERMEDIATE PHASE OF EROSION CONTROL AS SHOWN UPON COMMENCING OF GRADING AND INSTALLATION OF THE STORM STRUCTURES...

TO BE SHOWN ON THE EROSION, SEDIMENTATION AND POLLUTION CONTROL PLAN
When a FLAGGING SURFACE SKIRMER is used, show the following information along with each sediment point, trap or basin being used on the site:

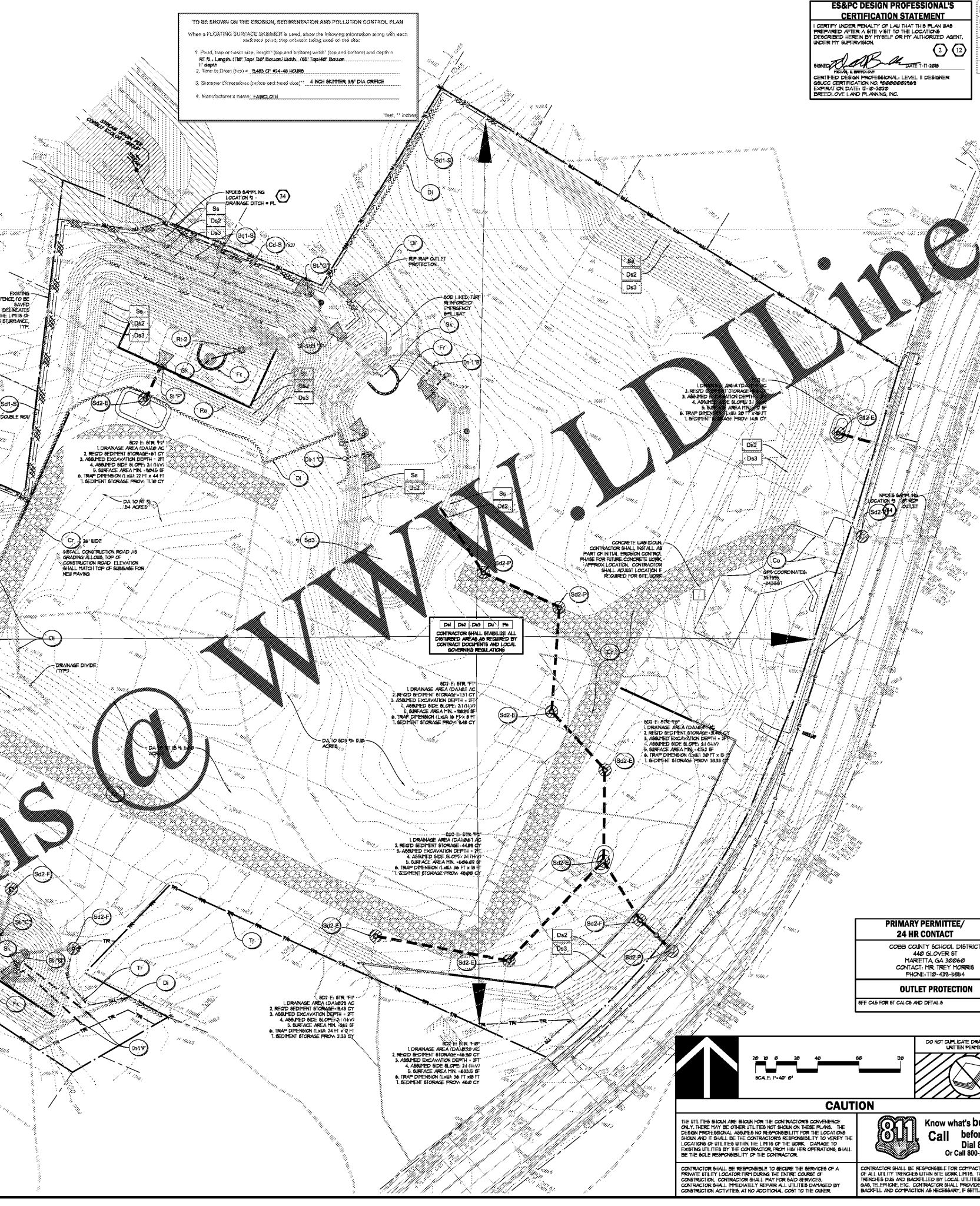

BREEDLOVE LAND PLANNING
Landscape Architects • Civil Engineers
www.landplanning.net
B.F. JOB 16014

Order Plans @ www.worldline.com

PRIMARY PERMITEE/ 24 HR CONTACT
COBBS COUNTY SCHOOL DISTRICT
440 GLOVER ST
MARIETTA, GA 30068
CONTACT: TREY MOORE
PHONE: 770-439-3864
OUTLET PROTECTION
SEE C&S FOR ST. CALCS AND DETAIL'S

CAUTION
THE UTILITIES SHOWN ARE SHOWN FOR THE CONTRACTOR'S CONVENIENCE ONLY. THERE MAY BE OTHER UTILITIES NOT SHOWN ON THESE PLANS. THE DESIGN PROFESSIONAL ASSUMES NO RESPONSIBILITY FOR THE LOCATIONS SHOWN AND IT SHALL BE THE CONTRACTOR'S RESPONSIBILITY TO VERIFY THE LOCATIONS OF UTILITIES WITHIN THE LIMITS OF THE WORK. DAMAGE TO EXISTING UTILITIES BY THE CONTRACTOR FROM HIS/HER OPERATIONS, SHALL BE THE SOLE RESPONSIBILITY OF THE CONTRACTOR.

811 Know what's below. Call before you dig. Dial 811. Or Call 800-282-7411
CONTRACTOR SHALL BE RESPONSIBLE FOR COMPACTING OF BACKFILL OF ALL UTILITY TRENCHES WITHIN 811 WORK LIMITS. THIS INCLUDES TRENCHES DUG AND BACKFILLED BY LOCAL UTILITIES, SUCH AS POWER, GAS, TELEPHONE, ETC. CONTRACTOR SHALL PROVIDE ADDITIONAL BACKFILL AND COMPACTATION AS NECESSARY, IF SETTLEMENT OCCURS.

DO NOT DUPLICATE DRAWINGS WITHOUT WRITTEN PERMISSION
DO NOT DUPLICATE WITHOUT PERMISSION
GEORGIA REGISTERED PROFESSIONAL ENGINEER
LAWRENCE W. BREEDLOVE

EROSION, SEDIMENTATION & POLLUTION PLAN- GRADING PHASE "A"
HARMONY LELAND-CRYSTAL REPLACEMENT ELEMENTARY SCHOOL
6390 HARTLEY ROAD, SUITE 200
MARIETTA, GA 30068
FOR COBBS COUNTY SCHOOL DISTRICT
COBBS COUNTY, GA
C&S PROJECT NO. 16014 17 DOE FACILITY CODE
CUMMINGHAM, forehand, matthews & moore, architects, inc. - 2011 manchester street, n.e. - atlanta, georgia 30324 - phone (404) 873-2152
DATE: 2018-08-01
JOB NO.: 16014-001-18
DWE. BY: KD

www.worldline.com

C4.2