

SPILL CLEANUP & CONTROL PRACTICES 25

LOCAL STATE & MANUFACTURER'S RECOMMENDED METHODS FOR SPILL CLEANUP WILL BE CLEARLY POSTED & PROCEDURES WILL BE MADE AVAILABLE TO SITE PERSONNEL. MATERIAL & EQUIPMENT NECESSARY FOR SPILL CLEANUP WILL BE KEPT IN THE MATERIAL STORAGE AREA...

DISTURBANCE SUMMARY 6

TOTAL SITE AREA: 15.02 ACRES
INITIAL DISTURBANCE: 2.9 ACRES
% OF SITE: 19.3 %

INITIAL EROSION CONTROL PHASE SUMMARY 35

THE CONTRACTOR SHALL INSTALL INITIAL PERIMETER CONTROL BMPs (BILT FENCE, TREE PROTECTION FENCE, CONSTRUCTION EXIT, SODS, INCLUDING STABILIZING EROSION SODS, INITIAL STORM PIPES IN EXISTING ROAD TO CONVEY WATER FROM SODS, AND ALL BMPs SHOWN ON THIS PLAN PRIOR TO BEGINNING INITIAL EROSION CONTROL...

PAM FLOC / GEL BAR REQUIREMENT

CONTRACTOR SHALL INSTALL DAILY FLOC/GEL BARS IN THE INLET OF EACH STORM STRUCTURE AS PART OF INITIAL BMP INSTALLATION.

UNIFORM CODING SYSTEM 49

SEE SHEET C42 FOR UNIFORM CODING SYSTEM FOR BOLT EROSION AND REDDENT CONTROL PRACTICES.

SLOPE STABILIZATION NOTE

SLOPE STABILIZATION MATTING (SM) SHALL BE APPLIED TO ALL SLOPES 3:1 & STEEPER.

- CONTRACTOR SHALL CONTACT THE DESIGN PROFESSIONAL WHO PREPARED THE ES&PC PLAN TO INSPECT THE INSTALLATION OF THE INITIAL SEDIMENT STORAGE REQUIREMENTS AND PERIMETER CONTROL BMPs WITHIN 7 DAYS AFTER INSTALLATION.
NON-EXEMPT ACTIVITIES SHALL NOT BE CONDUCTED WITHIN THE 25 OR 50-FOOT UNDISTURBED STREAM BUFFERS MEASURED FROM THE POINT OF WRESTED VEGETATION WITHOUT FIRST ACQUIRING THE NECESSARY VARIANCES AND PERMITS.

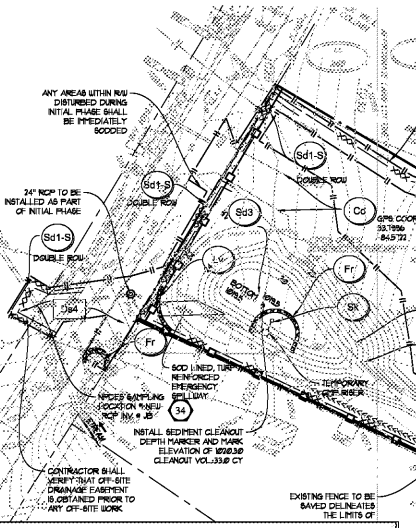

TO BE SHOWN ON THE EROSION, SEDIMENTATION AND POLLUTION CONTROL PLAN
When a FLOATING SURFACE SKIMMER is used, show the following information along with each sediment point: trap or basin being used on the site:
1. Point, trap or basin size, length (top and bottom width) (top and bottom) and depth =
Sd1-S Length: 120' Top: 36" Bottom: 36" 12" Top: 36" Bottom: 36"
2. Time to Drain (hrs) = 3966 CF @ 24.48 HOURS
3. Skimmer Dimensions (width and head size) = 28" INCH SKIMMER 28" DIA ORIFICE
4. Manufacturer's name: FARNCO, OH.

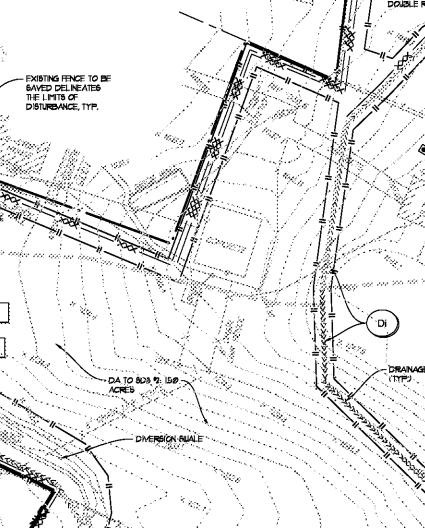

TO BE SHOWN ON THE EROSION, SEDIMENTATION AND POLLUTION CONTROL PLAN
When a FLOATING SURFACE SKIMMER is used, show the following information along with each sediment point: trap or basin being used on the site:
1. Point, trap or basin size, length (top and bottom width) (top and bottom) and depth =
Sd1-S Length: 120' Top: 36" Bottom: 36" 12" Top: 36" Bottom: 36"
2. Time to Drain (hrs) = 2796 CF @ 24.48 HOURS
3. Skimmer Dimensions (width and head size) = 28" INCH SKIMMER 28" DIA ORIFICE
4. Manufacturer's name: FARNCO, OH.

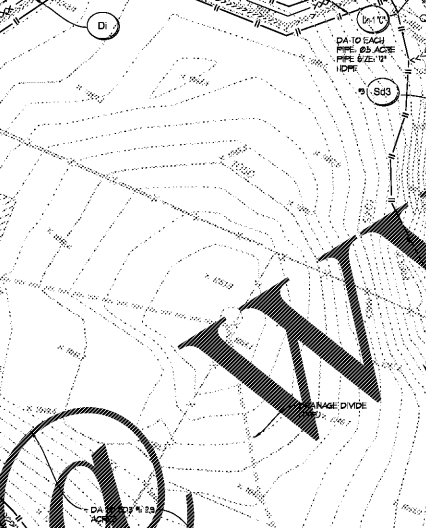

TO BE SHOWN ON THE EROSION, SEDIMENTATION AND POLLUTION CONTROL PLAN
When a FLOATING SURFACE SKIMMER is used, show the following information along with each sediment point: trap or basin being used on the site:
1. Point, trap or basin size, length (top and bottom width) (top and bottom) and depth =
Sd1-S Length: 120' Top: 36" Bottom: 36" 12" Top: 36" Bottom: 36"
2. Time to Drain (hrs) = 2796 CF @ 24.48 HOURS
3. Skimmer Dimensions (width and head size) = 28" INCH SKIMMER 28" DIA ORIFICE
4. Manufacturer's name: FARNCO, OH.

ES&PC DESIGN PROFESSIONAL'S CERTIFICATION STATEMENT
I CERTIFY UNDER PENALTY OF LAW THAT THIS PLAN WAS PREPARED AFTER A SITE VISIT TO THE LOCATIONS DESCRIBED HEREIN BY MYSELF OR MY AUTHORIZED AGENT, UNDER MY SUPERVISION.
DESIGNER: [Signature] DATE: 11-11-2018
CERTIFIED DESIGN PROFESSIONAL - LEVEL II - DESIGNER
65632C CERTIFICATION NO. 1000000029165
EXPIRES ON DATE: 12-31-2020
BREEDLOVE LAND PLANNING, INC.

DRAWING ISSUE RECORD
DATE: 11-11-18
REVISIONS:
ISSUE TO: BID

HARMONY LELAND-CLARK SCHOOL
REPLACEMENT ELEMENTARY SCHOOL
6330 HAVENLY SHALLOTTA DR.
MARIETTA, GA 30066
FOR COBB COUNTY SCHOOL DISTRICT
Cobb County, GA
CSD PROJECT NO. 160817 / DOE FACILITY CODE
JOB NO. 2018-09-01
DATE 2018-09-01
DWN. BY: KD

erosion, sedimentation & pollution plan - initial phase
cunningham, forehand, matthews & moore, architects, inc. - atlanta, georgia 30324 - phone (404) 873-2152
C4.1

www.dline.com

BREEDLOVE LAND PLANNING
Landscape Architects • Civil Engineers
www.landplanning.net
B.L.P. JOB 16014

Primary Permittee/ 24 HR CONTACT
COBB COUNTY SCHOOL DISTRICT
440 GLOVER ST
MARIETTA, GA 30066
CONTACT: TRACY MORRIS
PHONE: 770-435-5884
OUTLET PROTECTION
SEE GAS FOR 81 CALLS AND DETAILS

CAUTION
THE UTILITIES SHOWN ARE SHOWN FOR THE CONTRACTOR'S CONVENIENCE ONLY. THERE MAY BE OTHER UTILITIES NOT SHOWN ON THESE PLANS. THE DESIGN PROFESSIONAL ASSUMES NO RESPONSIBILITY TO VERIFY THE LOCATION OF UTILITIES WITHIN THE LIMITS OF THE WORK. DAMAGE TO EXISTING UTILITIES BY THE CONTRACTOR FROM HIS/HER OPERATIONS, SHALL BE THE SOLE RESPONSIBILITY OF THE CONTRACTOR.
CONTRACTOR SHALL BE RESPONSIBLE TO SECURE THE SERVICES OF A PRIVATE UTILITY LOCATOR PRIOR TO ANY CONSTRUCTION. THIS INCLUDES CONTRACTOR SHALL PAY FOR SAID SERVICES. CONTRACTOR SHALL IMMEDIATELY REPAIR ALL UTILITIES DAMAGED BY CONSTRUCTION ACTIVITIES, AT NO ADDITIONAL COST TO THE OWNER.

811 Know what's below. Call before you dig. Dial 811. Or Call 800-282-7411

GEORGIA REGISTERED PROFESSIONAL SEAL W. BREEDLOVE

DO NOT DUPLICATE DRAWINGS WITHOUT WRITTEN PERMISSION.
DO NOT DUPLICATE WITHOUT PERMISSION.