

Order Plans

WAWA ONLINE

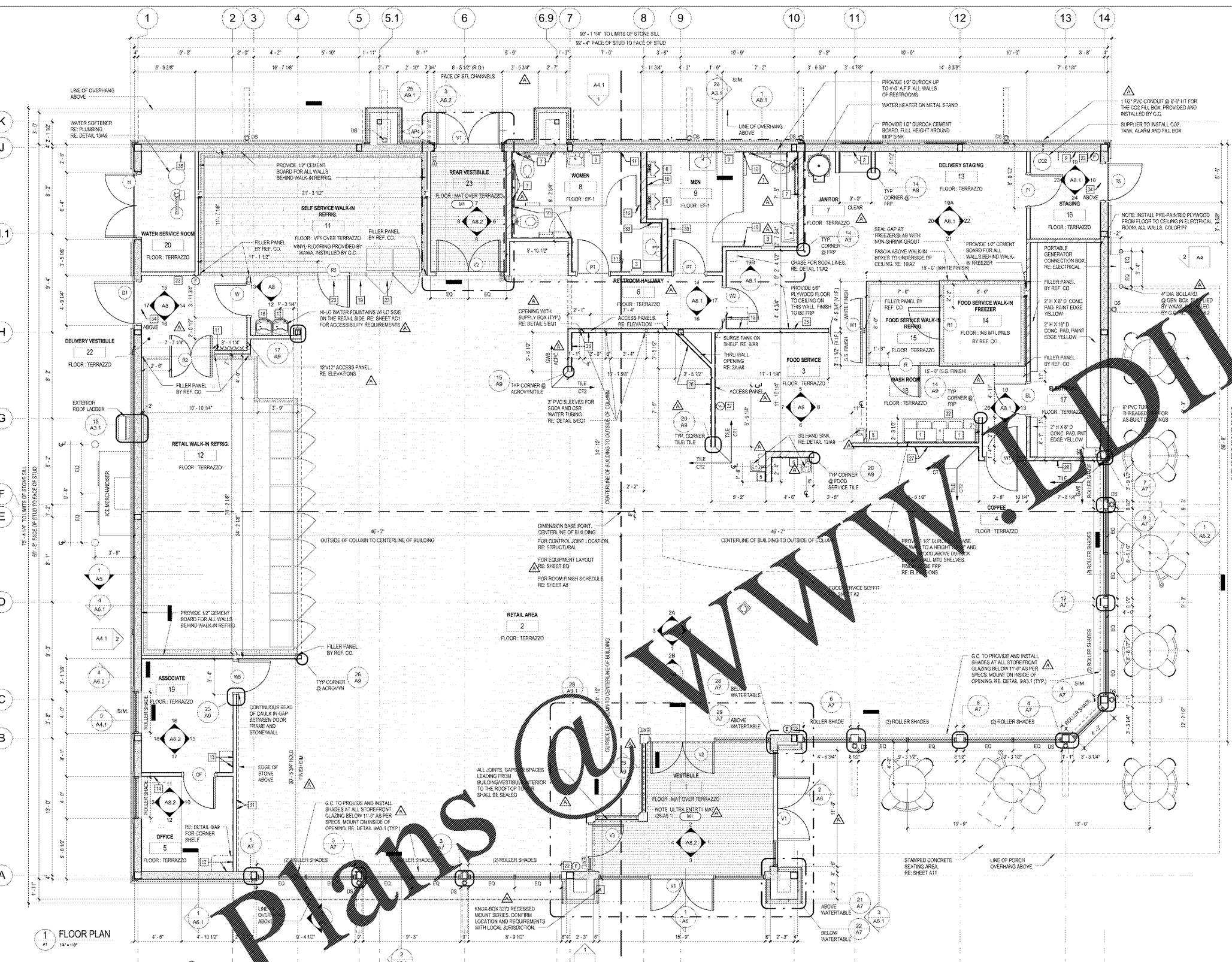
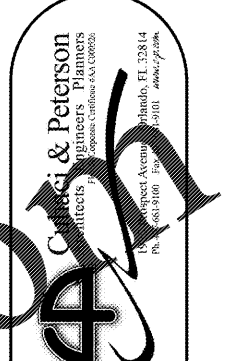

GENERAL NOTES

- BUILDING SHALL HAVE PRE-CONSTRUCTION TREATMENT PROTECTION AGAINST SUBTERRANEAN TERMITES IN ACCORDANCE WITH THE RULES AND LAWS ESTABLISHED BY THE FLORIDA DEPARTMENT OF AGRICULTURE AND CONSUMER SERVICES. A CERTIFICATE OF COMPLIANCE SHALL BE SUBMITTED TO THE BUILDING DEPARTMENT BY THE LICENSED PEST CONTROL COMPANY PERFORMING THE TREATMENT IN ACCORDANCE WITH FBC 1818.1.
- SOIL TREATMENT FOR TERMITES CONTROL SHALL BE PER SPECIFICATION SECTION 02322 SOIL TREATMENT.
- REFER TO FLORIDA PRODUCT APPROVAL SCHEDULE ON COVER SHEET FOR OPERABLE STOREFRONT SPEC. IMPACT GLASS MAY BE REQUIRED.
- RE DETAIL 23 AND 2149 FOR CORNER CONDITIONS AT WALL TILE IN THE FOOD SERVICE AREA AND RESTROOMS.
- ALL INTERIOR WALLS SHALL BE 1/2" G.W.B. U.O.
- ALL INTERIOR G.W.B. CEILING TO BE 5/8" U.O.

LARGE MISSILE IMPACT RATED STOREFRONT AND GLAZING ARE REQUIRED FOR THIS LOCATION. REFER TO SPECS.

EQUIPMENT BLOCKING NOTES

#	ITEM	BLK MATL	LOCATION AND REMARKS
1	SHRELVING W/ COMP SINK	1/2" PLYWOOD	IN LIEU OF G.W.B. SEE ELEVATION
2	MOF HOLDER	2" X 4"	5'-8"
3	HAND DRYER	2" X 6"	3'-3" AND 4'-0"
4	HAND WASH SINK	2" X 6"	3'-5"
5	URINAL	AS PER MANUF.	AS PER MANUF.
6	URINAL	AS PER MANUF.	2'-10" 1/2" VERTICAL
7	TRASH BAG HOLDER	2" X 6"	4'-0" AND 4'-0"
8	TOILET PARTITION	AS PER MANUF.	3'-0"
9	COAT HOOKS	2" X 12"	3'-0"
10	OFFICE SECURITY SHELF	2" X 10"	4'-0" SEE DETAIL ON 6M6
11	LOCKERS	2" X 10"	5'-6"
12	FUEL TANK MONITOR	2" X 12"	9'-6"
13	URGENT TASK SHELF	2" X 12"	7'-6"
14	WATER FOUNTAIN LOW	2" X 6"	7'-6"
15	WATER FOUNTAIN HIGH	2" X 6"	3'-0"
16	BEER COOLER SIGN	2" X 8"	11'-0" SEE SHEET G1
17	FIRE EXTINGUISHER	2" X 8"	3'-0" SEE DETAIL 4B9
18	BEER COOLER SIDE CABINETS	2" X 8"	15'-0" SEE SHEET G1
19	CSR UNIT	5/8" PLYWD	IN LIEU OF G.W.B. FLR TO CLG
20	SELF SERVICE DRINK AREA	1/2" PLYWOOD	SHEATH WALL 5 FLOOR TO CEILING SEE NOTE AND DETAIL 1301 & 1301A
21	FULL SERVICE CURBY	2" X 8" & 2" X 10"	SEE DETAIL 1A1
22	COFFEE AREA CURBY	2" X 8" & 2" X 10"	SEE DETAIL 1A1
23	DOORS LOGO SIGN	2" X 8"	1'-0" & 10'-0" SEE ELEVATION
24	DOOR COMPARTMENT SIGN	2" X 12"	2'-0" SEE ELEVATION
25	TRASH RECEPTACLE	2" X 6"	3'-0"
26	AIR CURTAIN	2" X 12"	ABOVE DOOR. SEE 10M6
27	BOOSTER PUMP SHELF	UNSTRUT	RE DETAIL 20A6 VERIFY EXACT LOCATION IN FIELD

DOOR NOTES

DOOR FRAMES: ALL DOOR FRAMES, INTERIOR AND EXTERIOR TO BE FULLY WELDED. NO KNOCK-DOWN FRAMES. WOOD BLOCKING AT JAMB AND HEAD OF ALL INTERIOR DOORS AS REQUIRED.

- DOOR SHOWN IN DOOR SCHEDULE AND SPECIFICATIONS. VERIFY QUANTITIES AND WHICH DOORS ARE REQUIRED AS INDICATED IN FLOOR PLAN.
- SEE SCHEDULE FOR MANUFACTURER SPECIFICATIONS FOR VESTIBULE DOORS AND HARDWARE. DOORS ARE TO BE PROVIDED WITH HAMB LATCH AND CLUSER AT ALL DOORS.
- ALL EXTERIOR HOLLOW METAL DOORS SHALL BE INSULATED DOORS.
- RUN CONTINUOUS BEAD OF CLEAR SILICONE CALK AROUND ALL DOOR FRAMES.
- EXIT DOOR LOCKS: IF PROVIDED ON EXGRESS DOORS, SHALL NOT REQUIRE THE USE OF A KEY. SPECIFIC KNOWLEDGE OF OPERATION FROM THE EXGRESS SIDE IN ACCORDANCE WITH SECTION 14.5.2.3 OF FPFC AND SECTION 1010.1.8 OF FBC UNLESS SPECIFICALLY ALLOWED BY CODE.
- A LATCH OR OTHER FASTENING DEVICE ON AN EXGRESS DOOR SHALL BE PROVIDED WITH A KNOB, HANDLE, PANIC BAR OR OTHER SIMPLE TYPE OF RELEASING DEVICE HAVING AN OBVIOUS METHOD OF OPERATION UNDER ALL LIGHTING CONDITIONS. DOORS SHALL BE OPERABLE WITH NO MORE THAN ONE RELEASING OPERATION PER FBC 14.5.1.10.
- ALL DOORS SERVING SPACES REQUIRED TO BE ACCESSIBLE SHALL BE PROVIDED WITH OPERABLE PARTS THAT SHALL BE OPERABLE WITH ONE HAND AND SHALL NOT REQUIRE TIGHT GRASPING, PINCHING, OR TWISTING OF THE WRIST. THE FORCE REQUIRED TO ACTIVATE OPERABLE PARTS SHALL BE 5 POUNDS MAXIMUM (FBC 409.4).
- OPERABLE PARTS OF HARDWARE SHALL BE 5 INCHES MINIMUM AND 4 INCHES MAXIMUM ABOVE THE FINISH FLOOR OR GROUND (FBC 409.4.7).
- REFER TO HARDWARE SCHEDULE IN THE SPECIFICATION MANUAL.
- THRESHOLD IS NOT TO EXCEED 1/2" HIGH.
- DOOR TO REQUIRE HOLE IN SLAB FOR BOLT.
- VISION PANEL DIMENSIONS CORRESPOND TO VISIBLE LIGHT DIMENSIONS. CONTRACTOR TO COORDINATE REQUIRED GLASS SIZE AND ROUGH OPENING WITH DOOR MANUFACTURER.

EQUIPMENT BLOCKING NOTES

#	ITEM	BLK MATL	LOCATION AND REMARKS
1	SHRELVING W/ COMP SINK	1/2" PLYWOOD	IN LIEU OF G.W.B. SEE ELEVATION
2	MOF HOLDER	2" X 4"	5'-8"
3	HAND DRYER	2" X 6"	3'-3" AND 4'-0"
4	HAND WASH SINK	2" X 6"	3'-5"
5	URINAL	AS PER MANUF.	AS PER MANUF.
6	URINAL	AS PER MANUF.	2'-10" 1/2" VERTICAL
7	TRASH BAG HOLDER	2" X 6"	4'-0" AND 4'-0"
8	TOILET PARTITION	AS PER MANUF.	3'-0"
9	COAT HOOKS	2" X 12"	3'-0"
10	OFFICE SECURITY SHELF	2" X 10"	4'-0" SEE DETAIL ON 6M6
11	LOCKERS	2" X 10"	5'-6"
12	FUEL TANK MONITOR	2" X 12"	9'-6"
13	URGENT TASK SHELF	2" X 12"	7'-6"
14	WATER FOUNTAIN LOW	2" X 6"	7'-6"
15	WATER FOUNTAIN HIGH	2" X 6"	3'-0"
16	BEER COOLER SIGN	2" X 8"	11'-0" SEE SHEET G1
17	FIRE EXTINGUISHER	2" X 8"	3'-0" SEE DETAIL 4B9
18	BEER COOLER SIDE CABINETS	2" X 8"	15'-0" SEE SHEET G1
19	CSR UNIT	5/8" PLYWD	IN LIEU OF G.W.B. FLR TO CLG
20	SELF SERVICE DRINK AREA	1/2" PLYWOOD	SHEATH WALL 5 FLOOR TO CEILING SEE NOTE AND DETAIL 1301 & 1301A
21	FULL SERVICE CURBY	2" X 8" & 2" X 10"	SEE DETAIL 1A1
22	COFFEE AREA CURBY	2" X 8" & 2" X 10"	SEE DETAIL 1A1
23	DOORS LOGO SIGN	2" X 8"	1'-0" & 10'-0" SEE ELEVATION
24	DOOR COMPARTMENT SIGN	2" X 12"	2'-0" SEE ELEVATION
25	TRASH RECEPTACLE	2" X 6"	3'-0"
26	AIR CURTAIN	2" X 12"	ABOVE DOOR. SEE 10M6
27	BOOSTER PUMP SHELF	UNSTRUT	RE DETAIL 20A6 VERIFY EXACT LOCATION IN FIELD

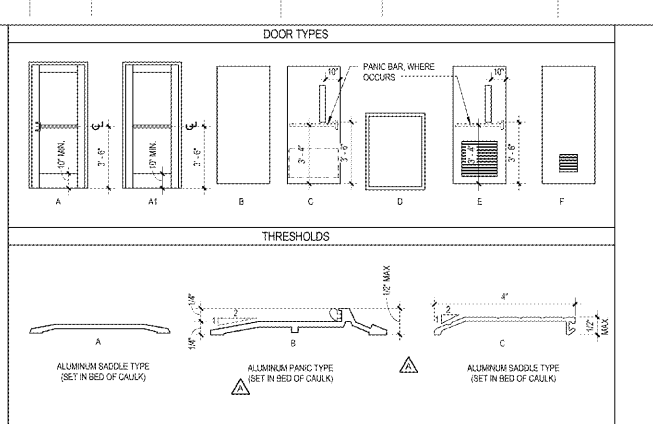

DOOR SCHEDULE

#	W	H	TH	TYPE	MATL	FRM	THRD	HW	SET	COMMENTS	PUSH	HW	PULL
AP1	2'-0"	7'-0"	0'-10"	C	HM	HM	A	HW 10		4" X 20" LAMINATED GLASS VISION PANEL. SEE 2S & 26A7 FOR HEAD & JAMB.	PANIC BAR	38" X 48"	
U1	4'-0"	7'-0"	0'-10"	C	HM	HM	A	HW 10		4" X 20" GLASS VISION PANEL AND 2" X 1" LOUVER. PUSH BUTTON LOCK ON FULL SIDE. SEE DETAIL 22A9.	PANIC BAR		
EL	3'-0"	6'-0"	0'-10"	E	HM	HM	A	HW 13		4" X 20" GLASS VISION PANEL AND 2" X 1" LOUVER. PUSH BUTTON LOCK ON FULL SIDE. SEE DETAIL 22A9.			
H	3'-0"	7'-0"	0'-10"	BF	HM	HM	B	HW 6		ONE LEAF W/ 12" X 18" LOUVER DOUBLE DOOR. SEE 2S & 26A7 FOR HEAD & JAMB. SEE 07A7 FOR BILL.			
OF	3'-0"	6'-0"	0'-10"	C	HM	HM	A	HW 12		4" X 20" ONE WAY VISION PANEL. SEE DETAIL 22A9.	LOCKSET	18" X 34"	18" X 35"
P1	3'-0"	6'-0"	0'-10"	B	WD	HM	A	HW 7		UNDERCUT DOOR 1". SEE DETAIL 22A9.	LOCKSET	24" X 24"	18" X 34"
R	3'-0"	6'-0"	0'-10"	REF						BY REFRIGERATION COMPANY.			
R1	3'-0"	6'-0"	0'-10"	REF						BY REFRIGERATION COMPANY.			
R2	4'-0"	6'-0"	0'-2"	REF						BY REFRIGERATION COMPANY (DOUBLE DOORS) W/ 6" X 14" LITE.			
R3	3'-0"	6'-0"	0'-2"	REF						BY REFRIGERATION COMPANY (GLAZED).			
R4	3'-0"	6'-0"	0'-10"	C	HM	HM	A	HW 11		4" X 20" GLASS VISION PANEL. SEE DETAIL 22A9.	PASSAGE SET	18" X 34"	18" X 38"
T5	3'-0"	7'-0"	0'-10"	C	HM	HM	B	HW 10		4" X 20" LAMINATED GLASS VISION PANEL. SEE 2S & 26A7 FOR HEAD & JAMB. SEE 07A7 FOR BILL.	LOCKSET	38" X 41"	
TH	3'-0"	4'-0"	0'-2 1/2"	D	ALUM	ALUM	A	HW 19		TOWER ACCESS WITH 3/8" MIN. SERIES INSULATED ACCESS PANEL. PROVIDE RAIN SHIELD. SEE 1A8.			
V1	3'-0"	7'-0"	0'-10"	A	ALUM	ALUM	C			(2) 3'-0" DBL GLASS DOOR. NO HOLD OPENS. SEE SPECS FOR HARDWARE.	PUSH BAR		
V2	3'-0"	7'-0"	0'-10"	A	ALUM	ALUM	C			(2) 3'-0" DBL GLASS DOOR. NO HOLD OPENS. SEE SPECS FOR HARDWARE.	PUSH BAR		
V3	3'-0"	7'-0"	0'-10"	A1	ALUM	ALUM	C			NO HOLD OPENS. PUSH ONLY. SEE SPECS FOR HARDWARE.	PUSH BAR		
W	3'-0"	6'-0"	0'-10"	C	HM	HM	A	HW 11		4" X 20" GLASS VISION PANEL. SEE DETAIL 22A9.			
W1	3'-0"	6'-0"	0'-10"	C	WD	HM	A	HW 3		DOUBLE ACTING W/ 4" X 20" GLASS VISION PANEL. SEE DETAIL 22A9.			
W2	3'-0"	6'-0"	0'-10"	C	WD	HM	A	HW 3		4" X 20" ONE WAY VISION GLASS. TRUMB LATCH. SEE DETAIL 22A9.			
W3	3'-0"	6'-0"	0'-10"	C	WD	HM	A	HW 3		4" X 20" ONE WAY VISION PANEL. PROVIDE JAMB EXTENSION ON THE RETAIL SIDE. SEE DETAIL 22A9.			

CLIENT NAME WAWA
PROJECT NAME WAWA F85FB 2018.01 STORE #5275-LIT
9021 STATE ROAD 52
HUDSON, FL 34689

DATE 03-27-2017
PROJECT COMMENTS 08/22/2017
PREPARED BY JESSE WILSON
DRAWN BY JESSE WILSON
CHECKED BY JESSE WILSON

2101052
DATE 03-27-2017
PROJECT WAWA F85FB
DRAWN BY JESSE WILSON
CHECKED BY JESSE WILSON

PROJECT NO. 2101052
DATE 03-27-2017
PROJECT WAWA F85FB
DRAWN BY JESSE WILSON
CHECKED BY JESSE WILSON

2101052
DATE 03-27-2017
PROJECT WAWA F85FB
DRAWN BY JESSE WILSON
CHECKED BY JESSE WILSON