

WAWA GENERAL LANDSCAPE NOTES:

- NO REFERENCE TO ENGINEERING SHOULD BE MADE FROM THIS PLAN SET. SHEET(S) ARE FOR LANDSCAPE REFERENCE ONLY.
- ALL CONSTRUCTION SHALL BE IN ACCORDANCE WITH THE PLANS AND WRITTEN SPECIFICATIONS. NO SUBSTITUTIONS SHALL BE MADE WITHOUT WRITTEN APPROVAL BY THE OWNER'S REP.
- THE PLANTING PLAN SHALL BE INSTALLED IN COMPLIANCE WITH EXISTING CODES AND APPLICABLE DEED RESTRICTIONS OR REQUIREMENTS.
- NUISANCE, EXOTIC PLANT SPECIES REMOVAL SHALL BE COMPLETED IN ACCORDANCE WITH SECTIONS OF THE MUNICIPAL REGULATIONS, GUIDELINES AND STANDARDS.
- CONTRACTOR IS RESPONSIBLE FOR VERIFYING ALL PLANT MATERIAL QUANTITIES PRIOR TO BIDDING. NOTIFY OWNER'S REP OF ANY QUANTITY DISCREPANCIES PRIOR TO CONSTRUCTION.
- ANY DEVIATION FROM PLANT QUANTITY, SIZE, GRADE, ORIGIN, OR DROUGHT TOLERANCE MAY JEOPARDIZE THE CERTIFICATE OF OCCUPANCY.
- WRITTEN DIMENSIONS SHALL TAKE PRECEDENCE OVER SCALED DIMENSIONS. CONTRACTOR SHALL VERIFY AND BE RESPONSIBLE FOR ALL DIMENSIONS AND CONDITIONS ON THE JOB. OWNER'S REP SHALL BE NOTIFIED OF ANY VARIATION FROM THE DIMENSIONS AND CONDITIONS SHOWN ON THE PLANS.
- CONTRACTOR TO NOTIFY SUNSHINE STATE ONE CALL OF FLORIDA, INC AT 800-433-4770 TWO FULL BUSINESS DAYS PRIOR TO DIGGING FOR UNDERGROUND UTILITY LOCATIONS.
- THE HEALTHY, NEAT, AND ORDERLY APPEARANCE OF ALL REQUIRED LANDSCAPING MATERIALS IS THE CONTINUAL RESPONSIBILITY OF THE PROPERTY OWNER AFTER FINAL ACCEPTANCE.

WAWA GENERAL PLANTING NOTES:

- NUISANCE, EXOTIC PLANT SPECIES REMOVAL SHALL BE COMPLETED IN ACCORDANCE WITH SECTIONS OF THE MUNICIPAL REGULATIONS, GUIDELINES AND STANDARDS.
- ALL PLANT MATERIAL SHALL BE FLORIDA NO. 1 OR BETTER, AS SET FORTH BY THE LATEST EDITION OF FLORIDA GRADES AND STANDARDS.
- PLANT MATERIAL SHALL BE LOCAL, FLORIDA NURSERY STOCK AND ALSO GROWN IN COASTAL ENVIRONMENTS. ALL COCONUT PALMS SHALL BE JAMAICAN CERTIFIED.
- LANDSCAPE CONTRACTOR SHALL BE RESPONSIBLE FOR ALL SOIL ANALYSIS PRIOR TO INSTALLATION OF PLANT MATERIAL. THE LANDSCAPE CONTRACTOR SHALL NOTIFY THE OWNER OF ANY IMPROPER SOIL CONDITIONS (WEEDS, MUCK, DEBRIS, ETC.) PRIOR TO INSTALLATION. THE CONTRACTOR IS RESPONSIBLE FOR ALL SOIL AMENDMENTS AND/OR FERTILIZER REQUIRED TO PROMOTE HEALTHY, VIGOROUS PLANT GROWTH.
- ALL PLANT MATERIAL HOLES SHALL BE HAND DUG EXCEPT WHERE MACHINE DUG HOLES WILL NOT ADVERSELY AFFECT OR DAMAGE UTILITIES OR PROJECT IMPROVEMENTS.
- THE LANDSCAPE CONTRACTOR SHALL BE RESPONSIBLE FOR MAINTAINING ALL PLANTINGS UNTIL FINAL ACCEPTANCE BY THE OWNER'S REP. THIS MAINTENANCE SHALL INCLUDE BUT NOT BE LIMITED TO KEEPING BEDS FREE OF DEBRIS AND WEEDS, MANAGING ALL DISEASE OR INFESTATION, AND WATERING OF PLANT MATERIAL.
- ALL PLANT MATERIAL SHALL BE GUARANTEED FOR A PERIOD OF 90 DAYS FROM THE DATE OF FINAL ACCEPTANCE BY THE OWNER'S REP.
- PRIOR TO CONSTRUCTION, THE CONTRACTOR SHALL VERIFY AND STAKE ALL UTILITIES. A MINIMUM OF TEN FEET SEPARATION IS REQUIRED BETWEEN UTILITIES AND TREE PLANTINGS. IN ADDITION, ALL TREES SHALL BE LOCATED AT LEAST SIX FEET AWAY FROM THE FLOW LINE OF SWALES AND PROPOSED OR EXISTING STORMWATER WELLS.
- NEW PLANT MATERIAL TO BE INSTALLED WILL BE FIELD ADJUSTED TO ACCOMMODATE EXISTING PLANT MATERIAL SUCH AS OVERHEAD CANOPY TREES, UNDERSTORY TREES AND SHRUBS OR GROUND COVER. THIS WILL ENSURE EXISTING PLANT MATERIAL TO REMAIN IN ITS NATURAL STATE. THEREFORE, NO EXISTING PLANT MATERIAL WILL BE ALTERED BY REMOVING, CUTTING, TRIMMING OR DESTROYING IN ORDER TO INSTALL NEW PLANT MATERIAL.
- ALL PLANT MATERIALS TO BE CONTAINER GROWN UNLESS OTHERWISE SPECIFIED. BAG GROWN PLANTS ARE NOT ACCEPTABLE.
- ALL PLANTING BEDS TO HAVE 6" OF DARK, FRABLE TOP SOIL OR BED MIXED CHURNED INTO EXISTING SOIL.
- THE TOPSOIL USED IN THE PLANTING OPERATION SHALL BE A NATURAL, FRABLE, FINE-LOAM SOIL. IT SHALL BE CERTIFIED TO BE FREE OF WEED SEEDS AND PATHOGENS. IT SHALL ALSO BE FREE OF LITTER, SOD, CLAY, STONES, ROOTS AND STUMPS. IT SHALL HAVE A PH OF 6.5 TO 7.5.
- BED PREPARATION: LOOSEN SOIL TO A MINIMUM DEPTH OF TWELVE INCHES AND REMOVE ALL DEBRIS. RE-GRADE THE BED TO ITS PREPLANTING SUBGRADE. DIG PLANTING PITS AT 1.5 TIMES THE DIAMETER OF THE POT. FILL PLANT PIT WITH SPECIFIED PLANTING MIX AND COMPACT SO THAT THE TOP OF ROOT BALL WILL SETTLE 1/8" DEPTH OF THE ROOT BALL ABOVE FINISH GRADE. SET PLANT AND FILL REMAINDER OF HOLE WITH PLANTING MIX. FERTILIZE EACH PLANT WITH THE RECOMMENDED RATE BASED ON SOIL ANALYSIS AND RECOMMENDATION FOR ORNAMENTAL PLANTING. WATER IN THOROUGHLY. RESEED ANY PLANTS THAT SETTLE TOO DEEP. REMOVE SPOIL SOIL AND RAKE THE BED TO ITS FINISH GRADE. COVER ALL BED AREAS WITH A 3" DEPTH OF APPROVED ORGANIC MULCH. ENSURE MULCH OVER ROOT BALLS DOES NOT EXCEED A DEPTH OF ONE INCH. REMOVE ALL DEBRIS FROM THE MULCH. WATER BED THOROUGHLY.
- PARKING LOT ISLANDS MUST BE EXCAVATED TO A DEPTH OF TWENTY FOUR INCHES FROM TOP OF CURB AND HAVE ALL COMPACTED MATERIAL REPLACED WITH TWENTY FOUR INCHES OF AMENDED TOPSOIL.
- ALL PROPOSED PLANTING AREAS SHALL RECEIVE A THREE INCH LAYER OF MULCH. ALL TREES NOT LOCATED WITHIN A PLANTING BED SHALL RECEIVE A FOUR FEET DIAMETER MULCH RING. SEE PLANT SCHEDULE FOR MULCH SPECIFICATIONS.
- THE LANDSCAPE CONTRACTOR SHALL BE RESPONSIBLE FOR HOLDING THE FINE GRADING OF PLANTING AREAS TO ENSURE AT LEAST THREE PERCENT POSITIVE DRAINAGE AWAY FROM BUILDINGS AND INTO TURF AREAS, PONDS, STREETS OR OTHER DRAINAGE WAYS. IN ADDITION, THE FINISH MULCH ELEVATION AT THE BUILDINGS SHALL BE AT LEAST SIX INCHES BELOW FINISH FLOOR OF THE ADJACENT BUILDING. PARKING LOT ISLANDS SHALL SLOPE AT THREE PERCENT FROM CENTER. TURF AND PLANTING BEDS SHALL MEET SIDEWALKS AND FLOWWORK AT TWO INCHES BELOW THE FLOWWORK.
- SLOPES GREATER THAN 4:1 SHALL REQUIRE SODDING FOR STABILIZATION.
- ANY AREAS SUBJECT TO EROSION MUST BE ADEQUATELY STABILIZED WITH VEGETATIVE MATERIAL THAT WILL, WITHIN A REASONABLE TIME FRAME, DETER SOIL DISTURBANCE. SODDING, PLUGGING, SPRIGGING OR SEEDING IS ACCEPTABLE FOR STABILIZATION; HOWEVER, SODDING MAY BE REQUIRED IN AREAS OF EROSION-PRONE SOILS OR WHERE SLOPES ARE GREATER THAN 5:1. VEGETATION OTHER THAN GRASS IS ACCEPTABLE AND MAY BE UTILIZED AT THE OWNERS DISCRETION.
- IF ALTERNATIVE VEGETATION IS UTILIZED (I.E. MATCHING AND/OR EXTENDING EXISTING SHRUB BED, THE INSTALLED MATERIAL MUST BE HEALTHY, VIGOROUS MATERIAL, FREE OF PESTS AND DISEASES. ALL PLANT MATERIAL SHALL BE IN FULL AND STRICT ACCORDANCE TO FLORIDA NO. 1 GRADE, ACCORDING TO THE "GRADES AND STANDARDS FOR NURSERY PLANTS", PUBLISHED BY THE FLORIDA DEPARTMENT OF AGRICULTURE AND CONSUMER SERVICES. MATERIAL IN SOME INSTANCES SHALL EXCEED NO. 1 GRADE, IN ORDER TO MEET THE MINIMUM REQUIREMENTS OF THIS PROJECT.
- SOD TO BE INSTALLED IN ALL DISTURBED AREAS THAT ARE NOT LANDSCAPED OR HARDSCAPED. CONTRACTOR SHALL VERIFY SOD QUANTITY.
- THE LANDSCAPE CONTRACTOR SHALL REPAIR AND/OR REPLACE ADJACENT LAND AREA DISTURBED BY CONSTRUCTION.
- LANDSCAPE CONTRACTOR SHALL REPAIR, RELOCATE AND/OR REPLACE ANY DAMAGED OR REMOVED LANDSCAPE AFFECTED BY CONSTRUCTION AND NOT DELINEATED ON THE DEMOLITION PLANS. CONTRACTOR SHALL OBTAIN APPROVAL FROM OWNER'S REP. PRIOR TO ANY REMEDIATION LANDSCAPE EFFORTS.
- ALL LANDSCAPED AREAS TO BE IRRIGATED WITH A FULLY AUTOMATED IRRIGATION SYSTEM. SEE IRRIGATION PLAN FOR NOTES PRIOR TO CONSTRUCTION.

WAWA TREE PLANTING NOTES:

- ALL TREES MUST BE HEALTHY, VIGOROUS MATERIAL, FREE OF PESTS AND DISEASES. ALL TREES SHALL BE IN FULL AND STRICT ACCORDANCE TO FLORIDA NO. 1 GRADE, ACCORDING TO THE "GRADES AND STANDARDS FOR NURSERY PLANTS", PUBLISHED BY THE FLORIDA DEPARTMENT OF AGRICULTURE AND CONSUMER SERVICES. TREES IN SOME INSTANCES SHALL EXCEED NO. 1 GRADE, IN ORDER TO MEET THE MINIMUM REQUIREMENTS OF THIS PROJECT. ALL PALMS SHALL BE SUN GROWN.
- ALL TREES SHALL BE GUARANTEED FOR ONE YEAR FROM DATE OF MUNICIPAL ACCEPTANCE.
- EACH TREE SHALL RECEIVE SIX "AGRIFORM" 21 GRAIN TABLETS PER MANUFACTURER'S DIRECTIONS.
- APPLY A THREE INCH LAYER OF MULCH LAYER TO ALL PROPOSED TREE, SHRUB, GROUND COVER AND VINE PLANTINGS. TREES NOT LOCATED WITHIN A SHRUB BED SHALL RECEIVE A FOUR FEET DIAMETER MULCH RING. SEE PLANT SCHEDULE FOR MULCH SPECIFICATION.
- FLEXIBILITY SHALL BE GIVEN TO THE PLACEMENT OF TREES TO ACCOMMODATE IMPROVEMENTS SUCH AS DRIVEWAYS, UTILITIES, LIGHTING, ETC.
- ALL TREES SHALL BE INSTALLED WITH A MINIMUM SEPARATION OF FIFTEEN FEET FROM STREET LIGHTS. IN ADDITION TREES SHALL NOT BE INSTALLED WITHIN 10 FEET OF UNDERGROUND GROUNDWORK WITHOUT THE USE OF ROOT BARRIER.
- ALL TREES INSTALLED ADJACENT TO OR UNDERNEATH ANY OVERHEAD UTILITY SHALL BE REQUIRED TO MEET THE MINIMUM SPACING REQUIREMENTS SET FORTH BY THE TREE SPECIES. TREE REPLACEMENT STANDARDS SET FORTH BY FLORIDA POWER AND LIGHT.
- ALL TREE PLANTINGS IN "COMMON AREAS" TO BE INSTALLED PRIOR TO AS-BUILT INSPECTION.
- ALL TREES TO BE UNDERTAKEN ON TREES PROTECTED BY THE PROVISIONS OF THE LAND DEVELOPMENT CODE SHALL BE IN ACCORDANCE WITH THE AMERICAN NATIONAL STANDARD INSTITUTE (ANSI) A-300 PRUNING STANDARDS.

WAWA GENERAL IRRIGATION NOTES:

- AN IRRIGATION SYSTEM SHALL BE DESIGNED IN ACCORDANCE WITH THE PASCO COUNTY LAND DEVELOPMENT CODE AND WILL BE SUBMITTED FOR APPROVAL PRIOR TO CONSTRUCTION.
- WHERE AVAILABLE, RECLAIMED WASTEWATER SHALL BE USED FOR LANDSCAPE IRRIGATION. IF UNAVAILABLE, THE SYSTEM SHALL BE DESIGNED TO THE LOWEST WATER QUALITY FEASIBLE.
- ALL IRRIGATION SYSTEMS SHALL BE DESIGNED TO AVOID OVER SPRAY, RUNOFF, OR OTHER SIMILAR CONDITIONS WHERE WATER FLOWS ONTO OR OVER ADJACENT PROPERTY, NON-IRRIGATED AREAS, WALKWAYS, ROADWAYS, STRUCTURES, OR WATER FEATURES. NARROW AREAS (FOUR (4) FEET WIDE OR LESS) SHALL NOT BE IRRIGATED UNLESS MICRO-IRRIGATION IS UTILIZED.
- IRRIGATION CONTROL EQUIPMENT SHALL INCLUDE AN OPERABLE AND FUNCTIONING AUTOMATIC IRRIGATION CONTROLLER HAVING PROGRAM FLEXIBILITY SUCH AS REPEAT CYCLES AND MULTIPLE PROGRAM CAPABILITIES. AUTOMATIC IRRIGATION CONTROLLER(S) SHALL HAVE BATTERY BACKUP TO RETAIN THE IRRIGATION PROGRAM(S). AUTOMATIC CONTROL SYSTEMS SHALL BE EQUIPPED WITH AN OPERABLE AND FUNCTIONING RAIN-SENSOR DEVICE. THE RAIN-SENSOR DEVICE SHALL BE PLACED WHERE IT IS EXPOSED TO UNOBSTRUCTED NATURAL RAINFALL.
- A RAIN SENSING SHUTOFF DEVICE SHALL BE REQUIRED ON ALL AUTOMATIC IRRIGATION SYSTEMS TO AVOID IRRIGATION DURING PERIODS OF SUFFICIENT RAINFALL. SAID EQUIPMENT SHALL CONSIST OF AN AUTOMATIC SENSING DEVICE OR SWITCH WHICH WILL OVERTHIDE THE IRRIGATION CYCLE OF THE SPRINKLER SYSTEM WHEN ADEQUATE RAINFALL HAS OCCURRED. IT MUST BE PLACED WHERE IT IS EXPOSED TO UNOBSTRUCTED NATURAL RAINFALL.
- THE IRRIGATION SYSTEM SHALL BE DESIGNED TO ACCOMMODATE SEPARATE LANDSCAPE PLANT ZONES BASED ON DIFFERING WATER REQUIREMENTS. TURF AREAS SHALL BE ON SEPARATE IRRIGATION ZONES FROM OTHER LANDSCAPE PLANT ZONES.
- A MAXIMUM OF FIFTY (50) PERCENT OF THE GREEN SPACE SHALL BE ALLOWED TO UTILIZE A CONVENTIONAL IRRIGATION SYSTEM UNLESS A SOIL MOISTURE SENSOR IS USED, IN WHICH CASE SIXTY-FIVE (65) PERCENT MAY USE CONVENTIONAL IRRIGATION.
- SPRINKLER SPACING SHALL NOT EXCEED FIFTY-FIVE (55) PERCENT OF THE SPRINKLERS' DIAMETER OF COVERAGE.
- SPRAYS AND ROTORS SHALL HAVE MATCHING APPLICATION RATES WITH EACH IRRIGATION ZONE. SPRAYS AND ROTORS SHALL NOT BE COMBINED ON THE SAME IRRIGATION ZONE.
- LANDSCAPE CONTRACTOR TO CREATE AS-BUILT DRAWINGS OF IRRIGATION SYSTEM TO SUBMIT AS REQUIRED BY PASCO COUNTY.

PASCO COUNTY LANDSCAPE NOTES:

- MAINTENANCE RESPONSIBILITY. THE COUNTY IS NOT RESPONSIBLE FOR MAINTENANCE OF ANY LANDSCAPING UNLESS APPROVED THROUGH A COUNTY MAINTENANCE AGREEMENT. (LDC 905.2-C.1.A)
- CLEAR-SIGHT TRIANGLE. WHERE A DRIVEWAY/ACCESSWAY INTERSECTS A ROAD RIGHT-OF-WAY OR WHERE TWO (2) ROAD RIGHTS-OF-WAY INTERSECT, VEGETATION, STRUCTURES, AND NON-VEGETATIVE VISUAL SCREENS SHALL NOT BE LOCATED SO AS TO INTERFERE WITH THE CLEAR-SIGHT TRIANGLE AS DEFINED IN THIS CODE OR THE FLORIDA DEPARTMENT OF TRANSPORTATION, MANUAL OF UNIFORM MINIMUM STANDARDS, MOST RECENT EDITION (GREEN BOOK), WHICHEVER IS MORE RESTRICTIVE. (LDC 905.2-C.1.B)
- SUSTAINABLE PRACTICES. LANDSCAPING SHALL BE INSTALLED SO THAT LANDSCAPING MATERIALS MEET THE CONCEPT OF RIGHT MATERIAL/RIGHT PLACE. INSTALLED TREES AND PLANTS SHALL BE GROUPED INTO ZONES ACCORDING TO WATER, SOIL, CLIMATE, AND LIGHT REQUIREMENTS. PLANT GROUPINGS BASED ON WATER REQUIREMENTS ARE DROUGHT TOLERANT, NATURAL, AND OASIS. (LDC 905.2-C.1.C)
- DIVERSITY. A MAXIMUM OF 50 PERCENT OF THE PLANT MATERIALS USED, OTHER THAN TREES, MAY BE NON-DROUGHT TOLERANT. A MINIMUM OF 30 PERCENT OF THE PLANT MATERIALS, OTHER THAN TREES AND TURFGRASS, USED TO FULFILL THE REQUIREMENTS OF THIS SUBSECTION SHALL BE NATIVE FLORIDIAN SPECIES, SUITABLE FOR GROWTH IN THE COUNTY. (LDC 905.2-C.1.D)
- DIVERSITY. NO ONE PLANT SPECIES OF SHRUBS OR GROUND COVER PLANTS, EXCLUDING TURFGRASS, SHALL CONSTITUTE MORE THAN 25 PERCENT COVERAGE OF THE OVERALL LANDSCAPE AREA. (LDC 905.2-C.1.D.5)
- QUALITY. ALL PLANT MATERIALS SHALL BE FLORIDA NO. 1 GRADE PER "GRADES AND STANDARDS FOR NURSERY PLANTS," FLORIDA DEPARTMENT OF AGRICULTURE AND CONSUMER SERVICES (FDACS), WHICH IS INCORPORATED HEREIN BY REFERENCE. (LDC 905.2-C.2.A)
- AVOID EASEMENTS. TREES SHALL NOT BE PLANTED WITHIN ANY EASEMENT SO AS TO INTERFERE WITH THE USE OF THAT EASEMENT, NOR UNDER ANY PRESENT OR PLANNED OVERHEAD UTILITY, NOR IN ANY RIGHTS-OF-WAY WITHOUT COUNTY APPROVAL THROUGH THE ASSOCIATED REVIEW PROCESS. (LDC 905.2-C.3.C)
- MULCH SHALL BE USED IN CONJUNCTION WITH LIVING PLANT MATERIALS SO AS TO COVER EXPOSED SOIL. MULCH SHALL BE INSTALLED TO A MINIMUM DEPTH OF THREE (3) INCHES. THE MULCH SHOULD NOT BE PLACED DIRECTLY AGAINST THE PLANT STEM OR TREE TRUNK. MULCH SHALL NOT BE REQUIRED FOR ANNUAL BEDS. STONE OR GRAVEL MAY BE USED TO COVER A MAXIMUM OF 20 PERCENT OF THE LANDSCAPED AREA. (LDC 905.2-C.3.D)
- QUALITY PRACTICES. ALL LANDSCAPING SHALL BE INSTALLED IN ACCORDANCE WITH STANDARDS AND PRACTICES OF THE FLORIDA NURSERY, GROWERS, AND LANDSCAPE ASSOCIATION AND THE FLORIDA CHAPTER OF THE INTERNATIONAL SOCIETY OF ARBORICULTURE. (LDC 905.2-C.3.E)
- ALL PORTIONS OF A LOT UPON WHICH DEVELOPMENT HAS COMMENCED, BUT NOT CONTINUED FOR A PERIOD OF 30 DAYS, SHALL BE PLANTED WITH A GRASS SPECIES OR GROUND COVER TO PREVENT EROSION AND ENCOURAGE SOIL STABILIZATION. ADEQUATE COVERAGE, SO AS TO SUPPRESS FUGITIVE DUST, SHALL BE ACHIEVED WITHIN 45 DAYS. (LDC 905.2-C.3.G)
- ALL REQUIRED LANDSCAPING SHALL BE MAINTAINED IN A HEALTHY CONDITION IN PERPETUITY IN ACCORDANCE WITH THIS (LDC 905.2-C.2)
- ONGOING MAINTENANCE TO PREVENT THE ESTABLISHMENT OF PROHIBITED EXOTIC SPECIES IS REQUIRED. (LDC 905.2-C.4)
- ANY PLANT MATERIALS OF WHATSOEVER TYPE AND KIND REQUIRE BY THE REGULATIONS SHALL BE REPLACED WITHIN THIRTY (30) DAYS OF THEIR DEMISE AND/OR REMOVAL.
- TREE BANKS OF DRY RETENTION AREAS SHALL BE SODDED TO THE POND BOTTOM. WET RETENTION AREAS SHALL BE SODDED TO THE SEASONAL HIGH WATER LINE. SEE CIVIL PLANS FOR ALL ELEVATIONS.

WALMART PARCEL PLANTING NOTES:

- ALL LANDSCAPED AREAS ARE TO RECEIVE A MINIMUM OF 4" OF TOPSOIL. SEE 02900 SPECIFICATION.
- ALL PLANT MATERIAL SHALL BE HEALTHY, VIGOROUS, AND FREE OF PESTS AND DISEASE.
- ALL PLANT MATERIAL SHALL BE CONTAINER GROWN OR BALLED AND/OR LAPPED AS INDICATED IN THE PLANT LIST.
- ALL TREES SHALL HAVE A STRAIGHT TRUNK AND FULL HEAD AND MEET ALL REQUIREMENTS SPECIFIED.
- ALL MATERIALS ARE SUBJECT TO THE REVIEW OF THE LANDSCAPE ARCHITECT BEFORE, DURING, AND AFTER INSTALLATION.
- ALL TREES MUST BE CHECKED AND STAKED AS SHOWN IN THE DETAILS.
- ALL PLANTING AREAS SHALL BE COMPLETELY STAKED AS SPECIFIED.
- PRIOR TO CONSTRUCTION, THE CONTRACTOR SHALL BE RESPONSIBLE FOR LOCATING ALL UNDERGROUND UTILITIES AND SHALL PROVIDE DATA TO ALL UTILITIES DURING THE COURSE OF THE WORK. LOCATIONS OF EXISTING BURIED UTILITY LINES SHOWN ON "PLANTING AREAS" SHALL BE VERIFIED THROUGH THE COURSE OF THE WORK. IT SHALL BE THE RESPONSIBILITY OF THE CONTRACTOR TO VERIFY THE LOCATIONS OF UTILITY LINES AND ADJACENT TO THE WORK AREA TO PROTECT ALL UTILITY LINES DURING THE CONSTRUCTION PERIOD TO REPAIR ANY AND ALL DAMAGE TO UTILITIES, STRUCTURES, SERVICES, MAINTENANCES, ETC. WHICH OCCURS AS A RESULT OF THE CONSTRUCTION.
- THE CONTRACTOR SHALL BE RESPONSIBLE FOR VERIFYING ALL QUANTITIES SHOWN ON THESE PLANS BEFORE PRICING THE WORK.
- CONTRACTOR SHALL BE RESPONSIBLE FOR DELIVERY SCHEDULE AND PROTECTION BETWEEN DELIVERY AND PLANTING PER SPECIFICATIONS TO MAINTAIN HEALTHY PLANT CONDITIONS.
- THE CONTRACTOR SHALL BE RESPONSIBLE FOR FULLY MAINTAINING (INCLUDING BUT NOT LIMITED TO: WATERING, SPRAYING, MULCHING, FERTILIZING, ETC.) ALL OF THE PLANT MATERIALS AND LAWN FOR THE PERIOD OF TIME SHOWN IN THE 02900 SPEC.
- ANY PLANT MATERIAL WHICH IS DISEASED, DISTRESSED, DEAD, OR REJECTED (PRIOR TO SUBSTANTIAL COMPLETION) SHALL BE PROMPTLY REMOVED FROM THE SITE AND REPLACED WITH MATERIAL OF THE SAME SPECIES, QUANTITY, AND SIZE AND MEETING ALL PLANT LIST SPECIFICATIONS.
- THE CONTRACTOR SHALL COMPLETELY GUARANTEE ALL PLANT MATERIAL FOR A PERIOD DEFINED IN THE 02900 SPEC. THE CONTRACTOR SHALL PROMPTLY MAKE ALL REPLACEMENTS DURING THE NORMAL PLANTING SEASON.
- AFTER BEING DUG AT THE NURSERY SOURCE, ALL TREES IN LEAF SHALL BE ACCLIMATED FOR TWO (2) WEEKS UNDER A MIST SYSTEM PRIOR TO INSTALLATION.
- STANDARDS SET FORTH IN "AMERICAN STANDARD FOR NURSERY STOCK" REPRESENT GUIDELINE SPECIFICATIONS ONLY AND SHALL CONSTITUTE MINIMUM QUALITY REQUIREMENTS FOR PLANT MATERIAL.
- WHERE SHOWN ON THE PLANS AND DETAILS, PLANTING BEDS ARE TO BE COMPLETELY COVERED WITH A HARDWOOD MULCH FROM A LOCAL SOURCE HARVESTED IN A SUSTAINABLE MANNER TO A MINIMUM DEPTH OF FOUR INCHES.
- REFER TO WALMART SPECIFICATIONS FOR INFORMATION NEEDED FOR IMPLEMENTATION OF PLANTING PLANS.
- WEED MAT IS REQUIRED IN LANDSCAPED ISLANDS AS SPECIFIED.
- ALL PLANT MATERIAL QUANTITIES SHOWN ARE APPROXIMATE. CONTRACTOR SHALL BE RESPONSIBLE FOR COMPLETE COVERAGE OF ALL PLANTING BEDS AT SPACING SHOWN.
- THIS PLAN IS TO BE IMPLEMENTED COOPERATIVELY WITH SWPPP PLAN, AS NEEDED, TO MAXIMIZE THE EFFECTIVENESS OF THE SWPPP PLAN FOR THIS SITE.
- THE CONTRACTOR IS ENCOURAGED TO COMPLETE TEMPORARY OR PERMANENT SEEDING OR SODDING IN STAGES FOR SOIL STABILIZATION AS AREAS ARE COMPLETED AFTER GRADING.
- THIS PLAN DOES NOT PRESENT ANY TEMPORARY STABILIZATION REQUIRED AS PART OF SWPPP PLAN.

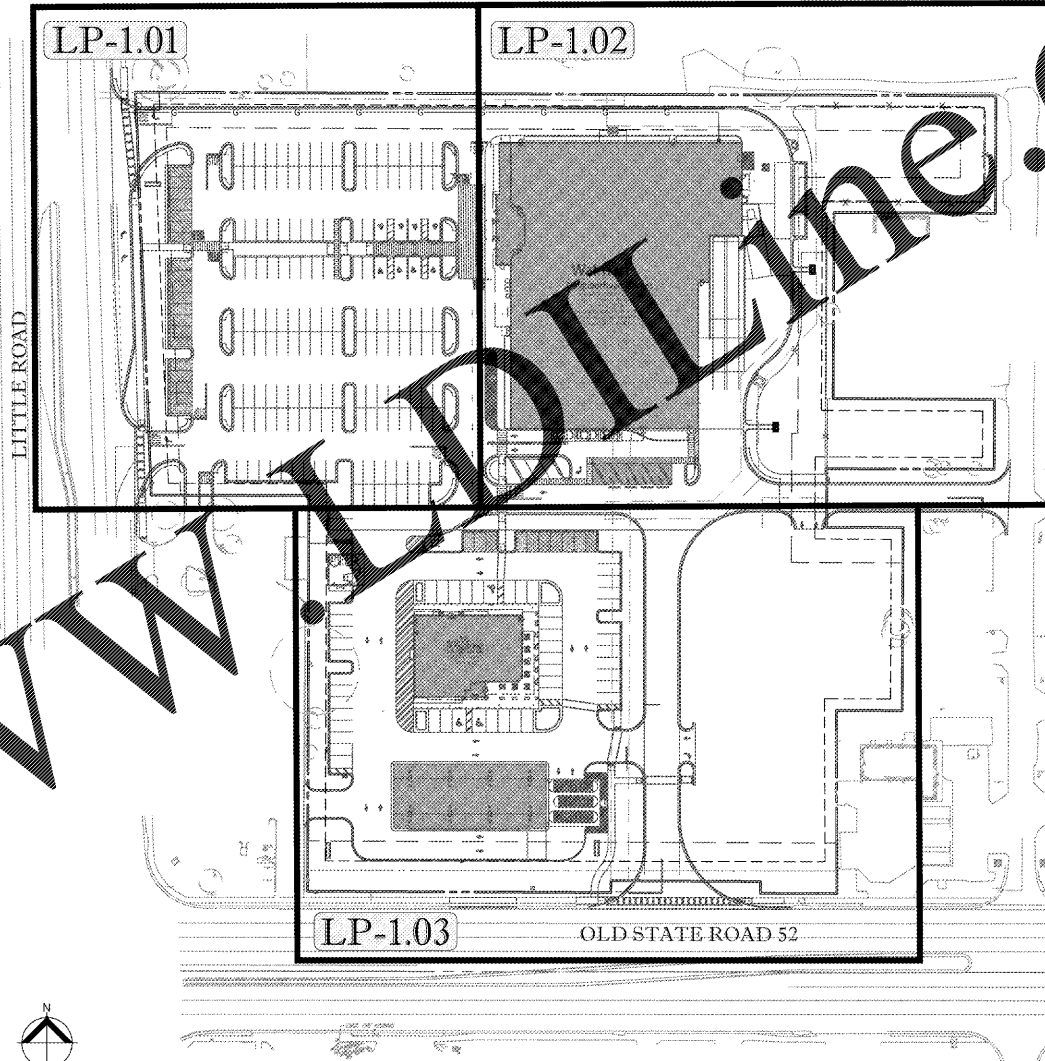

REFERENCE PLAN
SCALE: N.T.S.

WALMART PARCEL NOTES TO CONTRACTOR:

- 18" WIDE MULCH STRIP IS REQUIRED BEHIND ALL CONCRETE CURBS/BUFFERS WHERE TURF GRASS WILL BE ESTABLISHED ADJACENT TO CONCRETE CURBS/BUFFERS. EITHER A 16" OR 24" (DEPENDENT ON AVAILABILITY) WIDE SOD STRIP IS REQUIRED.
- CONTRACTOR IS CAUTIONED THAT STORMWATER CONVEYANCES AND POND BANKS AND BOTTOM CAN BE DAMAGED IF MACHINE MOVED WHILE THESE SOILS ARE WET. ANY ASSOCIATED DAMAGES ARE THE RESPONSIBILITY OF THE CONTRACTOR TO REPAIR AT NO EXPENSE TO OWNER.

BOHLER ENGINEERING

SITE CIVIL AND LANDSCAPE ARCHITECTURE
LANDSCAPING, IRRIGATION, AND UTILITY DESIGN
SUSTAINABLE DESIGN, HYDROLOGICAL ANALYSIS, AND
HYDROLOGICAL MODELING

OFFICES:
 • TAMPA, FLORIDA
 • MIAMI, FLORIDA
 • JACKSONVILLE, FLORIDA
 • ORLANDO, FLORIDA
 • DAYTONA BEACH, FLORIDA
 • SEASIDE, CALIFORNIA
 • CHARLOTTE, NORTH CAROLINA
 • RICHMOND, VIRGINIA
 • WASHINGTON, D.C.
 • NEW YORK, NEW YORK
 • PHILADELPHIA, PENNSYLVANIA
 • PITTSBURGH, PENNSYLVANIA
 • HOUSTON, TEXAS
 • DENVER, COLORADO
 • BOULDER, COLORADO
 • BOULDER, COLORADO

REVISIONS

REV	DATE	COMMENT	BY
1	6/9/17	PER COUNTY COMMENTS	KS
2	7/26/17	PER COMMENTS	KS
3	09/09/17	PER COUNTY COMMENTS	KS

811

KNOW WHAT'S BELOW
ALWAYS CALL 811
BEFORE YOU DIG

It's fast. It's free. It's the law.

NOT APPROVED FOR CONSTRUCTION

PROJECT No.: FL1700078
 DRAWN BY: KS
 CHECKED BY: KS
 DATE: 11/03/2016
 SCALE: AS NOTED
 CAD ID: LP1

PROJECT: **SITE CONSTRUCTION PLANS FOR RMC PROPERTY GROUP**

LOCATION OF SITE
SR 52 & LITTLE RD
HUDSON, FLORIDA
PASCO COUNTY

BOHLER ENGINEERING

3820 NORTHALE BLVD., SUITE 300B
 TAMPA, FLORIDA 33624
 Phone: (813) 812-4100
 Fax: (813) 812-4101
 FLORIDA BUSINESS CERT. OF AUTH. NO. 9076
 LICENSE NO. 00000778-00000000-00000000

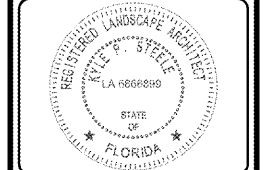

SHEET TITLE:
PLANTING NOTES & REFERENCE PLAN

SHEET NUMBER:
LP-1.00