

WAWA PLANTER DETAILS

REV. JULY 28, 2016

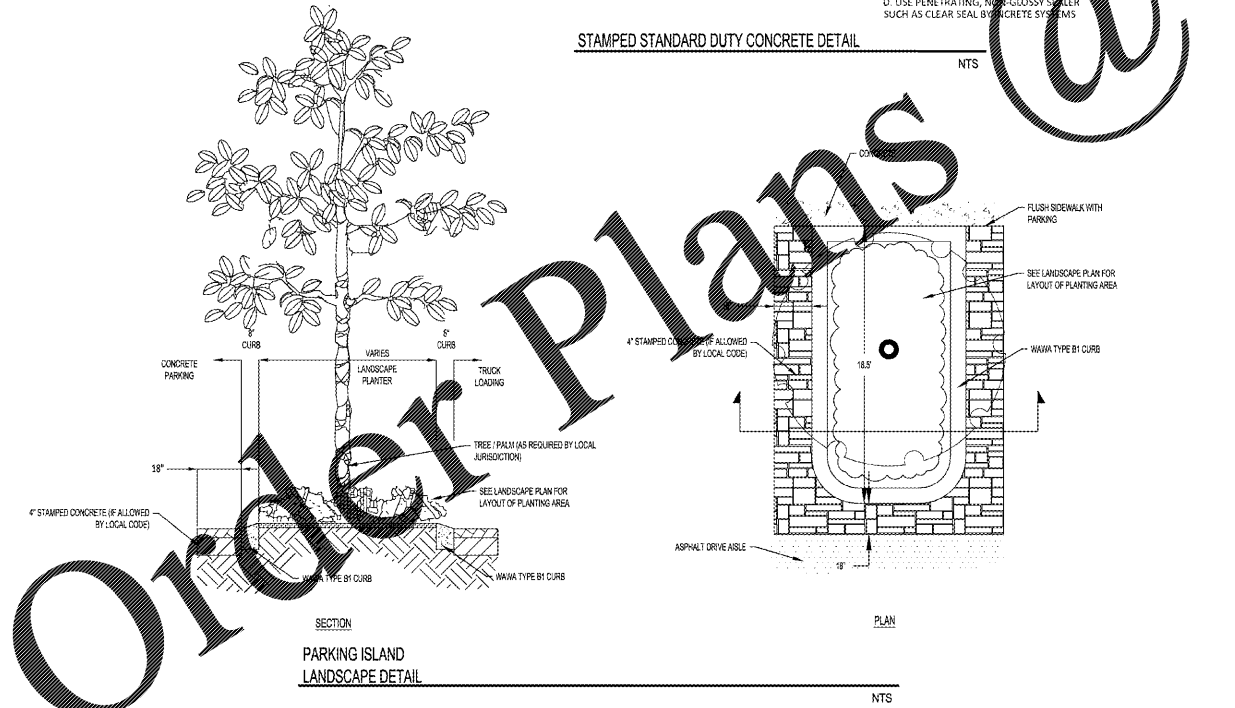
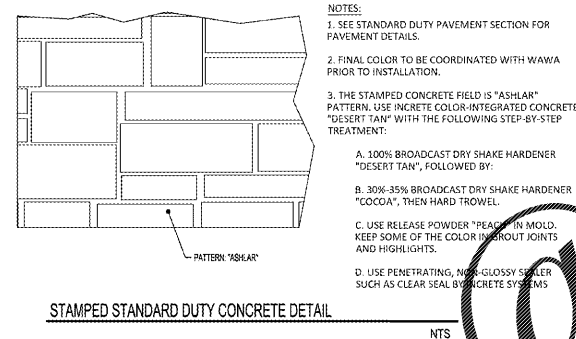
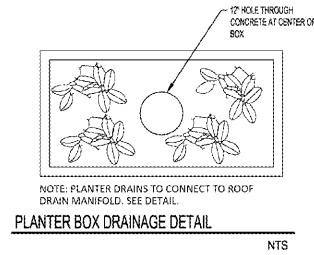
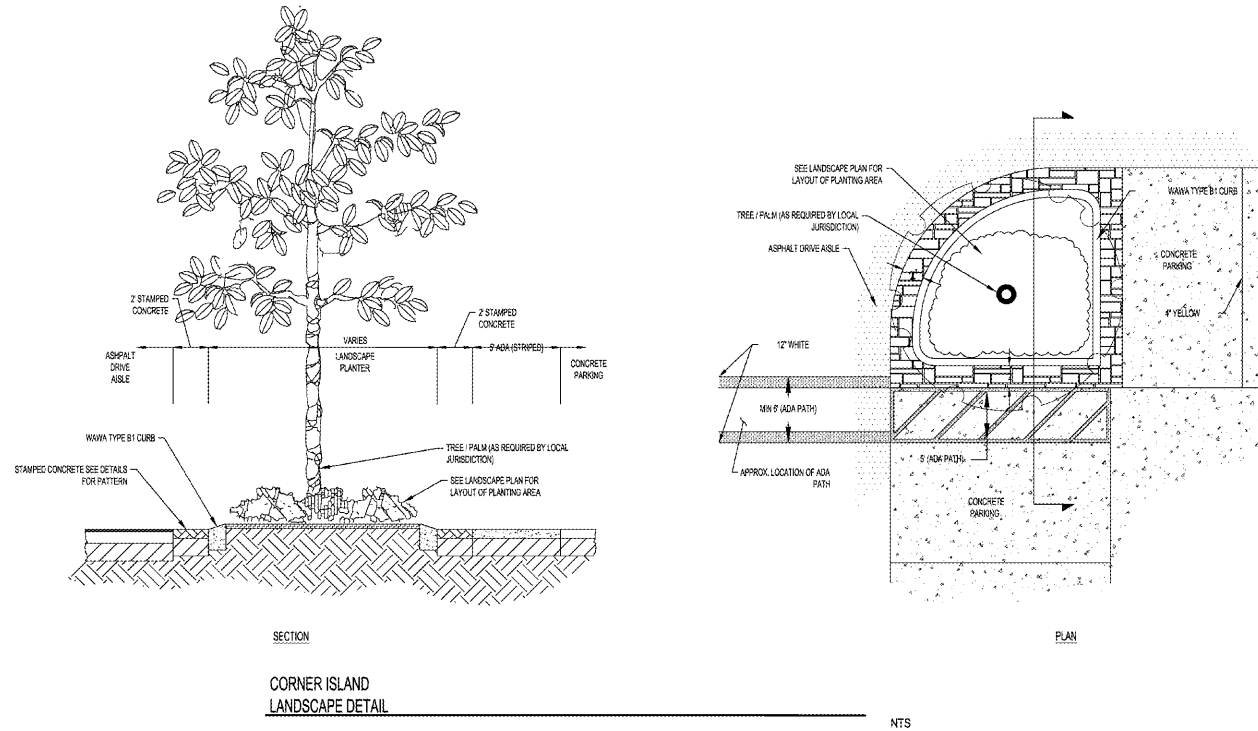

WAWA PAVEMENT DETAILS

REV. JULY 28, 2016

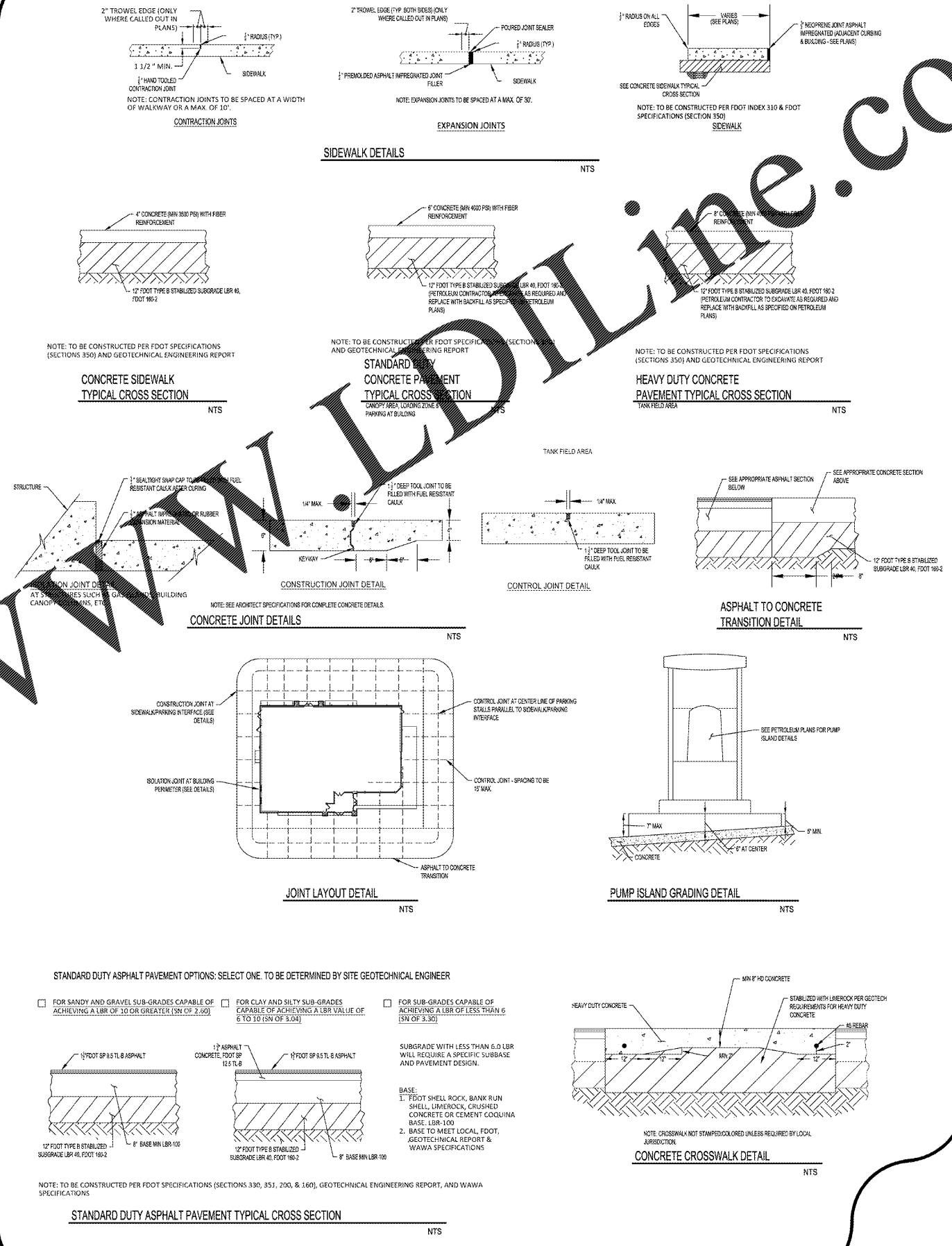

BOHLER ENGINEERING

REGISTERED PROFESSIONAL ENGINEERS
FLORIDA LICENSE NO. 12578
REGISTERED PROFESSIONAL ENGINEERS
FLORIDA LICENSE NO. 12578

OFFICES:
• TAMPA, FLORIDA
• MIAMI, FLORIDA
• JACKSONVILLE, FLORIDA
• ORLANDO, FLORIDA
• GAITHERSBURG, MARYLAND
• CHARLOTTE, NORTH CAROLINA
• RICHMOND, VIRGINIA
• WASHINGTON, DC
• NEW YORK, NEW YORK
• PHILADELPHIA, PENNSYLVANIA
• PITTSBURGH, PENNSYLVANIA
• WASHINGTON STATE
• CALIFORNIA

REVISIONS

REV	DATE	COMMENT	BY
1	2017-07-11	PER COUNTY, SWYMOG & FOOT COMMENTS	JDP
2	2017-10-13	PER COUNTY COMMENTS	JDP
3	2017-11-30	PER COUNTY UTILITY COMMENTS	JDP
4	2018-01-25	PER COUNTY & FOOT COMMENTS	JDP
5	2018-02-06	PER COUNTY COMMENTS	JDP
6	2018-02-06	PER COUNTY COMMENTS	JDP
7	2018-02-06	PER COUNTY COMMENTS	JDP
8	2018-02-06	PER COUNTY COMMENTS	JDP
9	2018-02-06	PER COUNTY COMMENTS	JDP
10	2018-09-07	WAWA BID SET	JDP
11	2018-10-03	PER ROW COMMENTS	SKK

811 KNOW WHAT'S BELOW ALWAYS CALL 811 BEFORE YOU DIG

www.callsunshine.com

PERMIT SET

PROJECT NO. FLT160978
DRAWN BY: JDP
CHECKED BY: KSM
DATE: 11/03/2016
SCALE: N.T.S.
CAD L.D.: SDD

WAWA SR 52 & LITTLE RD

FOR **RMC PROPERTY GROUP**

LOCATION OF SITE
9021 STATE ROAD 52
HUDSON, FLORIDA 34669
PASCO COUNTY

BOHLER ENGINEERING

3829 NORTHDALE BLVD., SUITE 300B
TAMPA, FLORIDA 33624
PHONE: (813) 912-4100
FAX: (813) 912-4101
FLORIDA BUSINESS CERT. OF AUTH. NO. 37919
LICENSED PROFESSIONAL ENGINEER IN FLORIDA

10/5/2018

SHEET TITLE:
WAWA STANDARD DETAILS

SHEET NUMBER:
D-3