



EAOC
ARCHITECTS
115 WESTBURY DR. PKWY
ATLANTA, GEORGIA 30328
404.214.5203 PHONE
404.214.5208 FAX

GENERAL NOTES :

- ALL INTERIOR FINISHES ARE IN COMPLIANCE WITH LIFE SAFETY CODE 39-3.3
 - ALL INTERIOR HOLLOW METAL FRAMES TO BE PAINTED P-2 UNLESS NOTED OTHERWISE
 - SOLID CORE INTERIOR WOOD DOORS TO BE ROTARY CUT BIRCH VENEER WITH CLEAR FINISH; REFERENCE THE DOOR SCHEDULE AND SPECIFICATIONS
 - ALL WET AREA WALLS AND CEILING TO BE WITH PAINTED WITH EPOXY PAINT, INCLUDING BUT NOT LIMITED TO BATHROOMS, SHOWER ROOMS & JANITOR CLOSET.
 - ALL MILLWORK TO BE PLASTIC LAMINATE PL-1 ON VERTICAL SURFACES AND PL-2 ON ALL COUNTERTOPS AND BACKSPLASHES UNLESS NOTED OTHERWISE.
 - REFER TO REFLECTED CEILING PLAN FOR ACT SPECIFICATIONS
 - ALL GWB CEILING TO BE PAINTED P-5; FLAT FINISH, UNLESS NOTED OTHERWISE.
 - ARCHITECTURAL PLYWOOD CEILING INDICATED ON THE REFLECTED CEILING PLAN TO MATCH THE SCHEDULED DOOR FINISH; ROTARY CUT BIRCH VENEER WITH CLEAR FINISH; SUBMIT SAMPLE FOR APPROVAL. APPROVED SAMPLE TO BE USED AS CONTROL SAMPLE THROUGHOUT PROJECT.
- REFERENCE THE FINISH SCHEDULE FOR ACCENT PAINT INFORMATION AND THE PLAN FOR LOCATIONS AND EXTENTS.
- PROVIDE SCHLUTER SCHEME, OR EQUIVALENT, TRANSITION STRIP BETWEEN LVT AND CARPET OF SAME OR SIMILAR THICKNESS; BRUSHED ALUMINUM/ STAINLESS STEEL FINISH

FINISH LEGEND

FLOORING

CARPET TILE

- C-1 SHAW CONTRACT "DIFFUSE TILE", OR EQUIVALENT, 24" X 24" COLOR: #5969 FLAYWAY; ECOWORK TILE BACKING; INSTALLATION METHOD: RANDOM. GSA CONTRACT # GS-03P-048AA; SALES CONTACT: ALLISON MAIR ADAMS, 404.210.3776, allison.mair@shawinc.com
- C-2 SHAW CONTRACT "COLOR FRAME", OR EQUIVALENT, 24" X 24" COLOR: #81588 CLOUDED; ECOWORK TILE BACKING; INSTALLATION METHOD: RANDOM. GSA CONTRACT # GS-03P-048AA; SALES CONTACT: ALLISON MAIR ADAMS, 404.210.3776, allison.mair@shawinc.com

LUXURY VINYL TILE

- LVT-1 PATCRAFT "METALLIC RECTANGULAR", OR EQUIVALENT, 12" X 24" RESILIENT TILE; ACCENT COLOR: ALUMINUM; 40 MIL WEAR LAYER; INSTALLATION METHOD: ASHLAR PATTERN. GSA CONTRACT # GS-03P-048AA; SALES CONTACT: TRACY ROAN, 404.316.4031, tracy.roan@patcraft.com
- LVT-2 PATCRAFT "METALLIC RECTANGULAR", OR EQUIVALENT, 12" X 24" RESILIENT TILE; ACCENT COLOR: GREEN; 40 MIL WEAR LAYER; INSTALLATION METHOD: ASHLAR PATTERN. GSA CONTRACT # GS-03P-048AA; SALES CONTACT: TRACY ROAN, 404.316.4031, tracy.roan@patcraft.com

PORCELAIN CERAMIC TILE

- TL-1 TRINITY SALES "SIMPPLICITY" FLAT TILE, 12" X 24", OR EQUIVALENT; FINISH: MATTE; INSTALLATION METHOD: ASHLAR PATTERN; INSTALL WITH MARIENKAPOLY EPOXY GROUT, OR EQUIVALENT; COLOR: 02 PEWTER. TRINITY SALES CONTACT: TRACY BELOTE, 404.625.7996, tracybelote@trinitysales.com
- TL-2 TRINITY SALES "ARGONITE" PORCELAIN MOSAIC TILE, 2" ON 12"x12" MESH, OR EQUIVALENT; COLOR: GREY MATTE; INSTALLATION METHOD: THREESTAT SHOWER FLOOR; SLOPE TO DRAIN. INSTALL WITH MARIENKAPOLY EPOXY GROUT, OR EQUIVALENT; COLOR: 02 PEWTER. TRINITY SALES CONTACT: TRACY BELOTE, 404.625.7996, tracybelote@trinitysales.com

FITNESS FLOORING

- FF-1 ROPPE "RECOL" RUBBER SHEET FITNESS FLOORING, OR EQUIVALENT; ROLL GOODS; 1/2" THICKNESS FOR SOUND & SHOCK ABSORPTION WITH FIBRE WEIGHT USE; 40" WIDE ROLLS; SMOOTH TEXTURE FINISH; COLOR: #378 COBALT; LT. GRAY. SALES CONTACT: MICHELE MUSGROVE, 404.940.0241, mmusgrove@roppe.com

WALL BASE

- B-1 RUBBER BASE; ROPPE 4" HT. "SIMPLICITY BASE #00", OR EQUIVALENT; COLOR #178 PEWTER; CONTOURED BASE PROFILE; ROLLS ONLY WITH MITERED INSIDE/OUTSIDE CORNERS. SALES CONTACT: MICHELE MUSGROVE, 404.640.0241, mmusgrove@roppe.com
- B-2 CERAMIC BASE TO MATCH SPECIFIED WALL TILE; SPECIALTY TILE PRODUCTS "SOBU" 4" X 10" BASE; COLOR: MATCH WALL TILE; EPOXY GROUT TO MATCH FLOOR GROUT. SALES CONTACT: HEATHER CALLENDER, 404.512.2646, hcallender@specialtytile.com

TRANSITION STRIP

- TR RESILIENT TRANSITION STRIP, AS SPECIFIED

DIRECTION OF FLOORING INSTALLATION

- ARROW INDICATES DIRECTION OF FLOORING INSTALLATION

WALLS

PAINT

- MINIMUM ONE (1) PRIMER COAT AND TWO (2) FINISH COATS AS RECOMMENDED BY MANUFACTURER.
- P-1 SHERWIN WILLIAMS #597646 FIRST STAR; EGGSHELL FINISH; FIELD PAINT
- P-2 SHERWIN WILLIAMS #6517 REGATTA; SEMI-GLOSS FINISH; TRIM PAINT
- P-3 SHERWIN WILLIAMS #7018 DOVETAIL; EGGSHELL FINISH; ACCENT PAINT
- P-4 BENJAMIN MOORE #HC-115 GEORGIAN GREEN; SEMI-GLOSS FINISH; ACCENT PAINT
- P-5 SHERWIN WILLIAMS #S5W704 SNOWBOUND; FLAT FINISH; GWB CEILING PAINT

GLAZED CERAMIC WALL TILE

- TL-3 GLAZED CERAMIC WALL TILE; SPECIALTY TILE PRODUCTS "SOBU" 4" X 10" SUBWAY TILE; COLOR: BIRCH GLOSS; EPOXY GROUT; COLOR TBD. SALES CONTACT: HEATHER CALLENDER, 404.512.2646, hcallender@specialtytile.com

MISCELLANEOUS FINISHES

PLASTIC LAMINATE

- PL-1 WILSONART #7964K-12 "SKYLINE WALNUT - SOFTGRAN FINISH; SHALL BE APPLIED TO ALL VERTICAL SURFACES UNLESS OTHERWISE NOTED. SALES CONTACT: DAVID MAY, 770.527.2466, rmay@wilsonart.com
- PL-2 FORMICA #821-58 "DOGBONE WHITE", MATTE FINISH; SHALL BE APPLIED TO ALL HORIZONTAL SURFACES UNLESS OTHERWISE NOTED. SALES CONTACT: LESLIE GALIFIANAKIS, 404.312.7633, leslie.galifianakis@formica.com

SOLID SURFACE

- SS-1 WILSONART SOLID SURFACE #9070M ARTIC MELANGE, OR EQUIVALENT, FOR FABRICATION OF BATHROOM VANITY COUNTERS, SPLASHES & APRON. SALES CONTACT: DAVID MAY, 770.527.2466, rmay@wilsonart.com

WALL PROTECTION

- WP-1 WALL PROTECTION PANELS; INPRO PFC PANELS, OR EQUIVALENT, 4'-0" HT. X FULL WIDTH OF INDICATED WALL; #0238 FEATHER WITH ALUMINUM FINISH TOP TRIM; VERTICAL DIVIDER BARS TO MATCH PANEL COLOR; INSTALL PER MANUFACTURER'S RECOMMENDATIONS FOR SUBSTRATE; PROVIDE SUBMITTAL AND SHOP DRAWINGS FOR APPROVAL.

SEALED CONCRETE

- SC-1 H&C CLARISHIELD CONCRETE SEALER, OR EQUIVALENT, WITH "SHARK GRIP" SLIP-RESISTANT ADDITIVE

FINISH SCHEDULE								
ROOM NUMBER	ROOM NAME	FLOOR	BASE	WALL FINISH NORTH	WALL FINISH SOUTH	WALL FINISH EAST	WALL FINISH WEST	REMARKS
100	CORRIDOR	LVT-1/LVT-2	B-1	P-1	P-1/P-3	P-1	P-1	1, 2
100A	IT SERVER	LVT-2	B-1	P-1	P-1	P-1	P-1	4
101	TRAINING ROOM	C-1/C-2	B-1	P-4	P-1/WP-1	P-1/WP-1	P-1	1,2,3
102	STORAGE	C-1	B-1	P-1	P-1	P-1	P-1	
103	WOMEN'S LOCKER RM	TL-1	B-2	P-1	P-1	P-1	P-1	5
104	WOMEN'S	TL-1	B-2	P-1	TL-3	TL-3	P-1	6
104A	VEST.	LVT-2	B-1	P-1	P-1	P-1	P-1	
105	JAN	TL-1	B-2	P-1	P-1	P-1	P-1	3
106	MEN'S	TL-1	B-2	P-1	TL-3	P-1	P-1	6
106A	VESTIBULE	LVT-2	B-1	P-1	P-1	P-1	P-1	
107	MEN'S LOCKER RM	TL-1	B-2	P-1	P-1	P-1	P-1	5
108	ELEC.	SC-1	---	P-1	P-1	P-1	P-1	
109	BREAK / WORK AREA	LVT-1	B-1	P-1	P-3	P-1	P-1	
110	OFFICE	C-1	B-1	P-1	P-1	P-1	P-1	
111	DIRECTOR'S OFFICE	C-1	B-1	P-1	P-1	P-1	P-1	
112	OFFICE	C-1	B-1	P-1	P-1	P-1	P-1	
113	OFFICE	C-1	B-1	P-1	P-1	P-1	P-1	
114	AMMO.	SC-1	---	P-1	P-1	P-1	P-1	
115	MECH.	SC-1	---	P-1	P-1	P-1	P-1	
116	WEIGHT ROOM	FF-1	B-1	P-3	P-1	P-1	P-1	

FINISH REMARKS

- EXPOSED STRUCTURAL MEMBERS TO BE "DRY POG" PAINTED P-4 UNLESS NOTED OTHERWISE
- REFERENCE PLAN FOR TRANSITION LOCATION OF ACCENT FLOORING
- PROVIDE CORNER WALL PROTECTION AT SERVICE SINK LOCATION; INSTALL TL-3 TO 7'-0" AFF AND WIDTHS EQUAL TO SERVICE SINK SIDES; PROVIDE REQUIRED TRIM PIECES FOR A COMPLETE INSTALLATION.
- PAINT IT BACKER BOARD TO MATCH WALL
- SHOWERS TO BE FINISHED WITH TL-2 FLOORING AND TL-3 WALLS; FULL HEIGHT AND CONTINUOUS AROUND SHOWER COMPARTMENT. PROVIDE ALL TRIM PIECES REQUIRED FOR A COMPLETE INSTALLATION. REFERENCE THE TOILET ACCESSORY SCHEDULE FOR ADDITIONAL INFORMATION.
- WALL TILE TO RUN FULL HEIGHT AND WIDTH OF SCHEDULED WALL; BRICK PATTERN TO START AT CENTERLINE OF EACH WALL. REFERENCE TILE BASE SPECIFICATION; BASE IS PART OF WALL TILE INSTALLATION.

FINISH KEY NOTES

- WHERE SCHEDULED FLOORING IS THE SAME THICKNESS, NO TRANSITION STRIPS ARE REQUIRED UNLESS NOTED OTHERWISE. BUTT JOINT FLOORING AND SEAM PER MANUFACTURER'S RECOMMENDATIONS
- DASHED LINES INDICATE THE OUTLINE OF THE METAL BUILDING STRUCTURE, WHERE EXPOSED TO VIEW, PAINT IN ACCENT P-4, REFERENCE SCHEDULE.
- GWB SOFFITS TO BE P-3; FLAT FINISH, UNLESS NOTED OTHERWISE
- PROVIDE SOLAR SHADES FOR STAFF AREA WINDOWS ONLY; BASIS OF DESIGN: MERMET'S SCREEN, OR EQUIVALENT; LIGHT FILTERING TRANSPARENT FABRIC WITH 3% OPENNESS; FABRIC COMPOSITION: 35% FIBERGLASS/ 65% VINYL. 02.20 WHITE/LINEN COLOR SELECTION (TO BE VERIFIED); INSIDE MOUNT; FIELD VERIFY DIMENSIONS; NO VALANCE; STANDARD CONTROLS

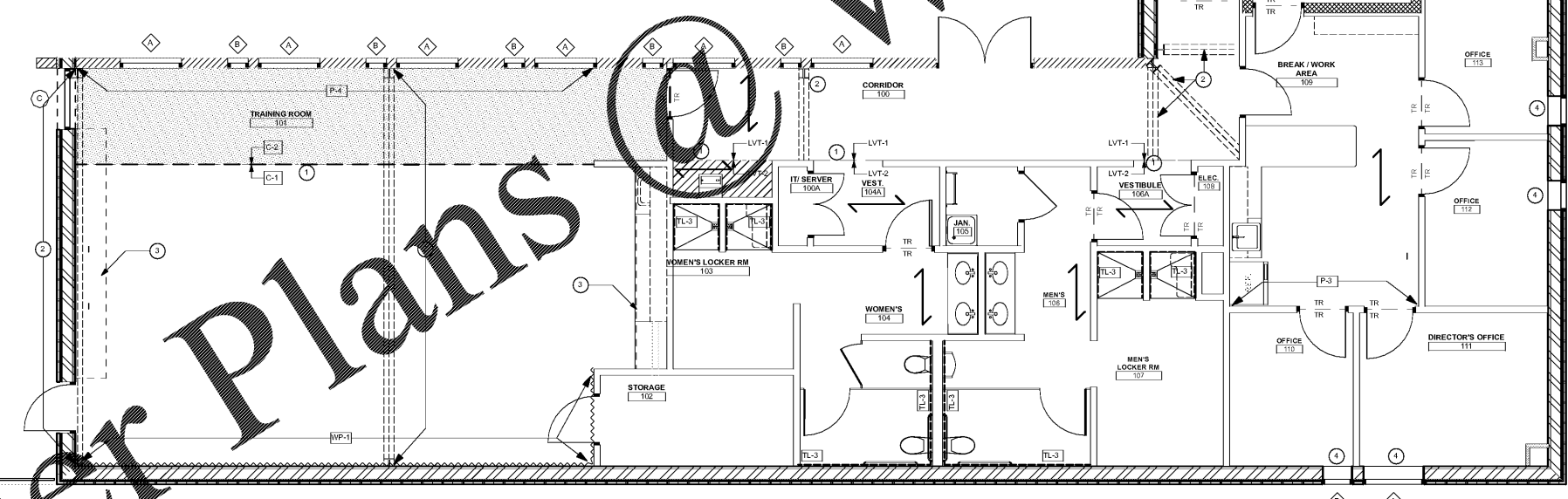

1 FINISH PLAN
A3.60 SCALE: 1/4" = 1'-0"

RELOCATED TRAINING CENTER
FOR
THE FLOYD COUNTY JAIL
2526 NEW CALHOUN HIGHWAY N.E.
ROME, GEORGIA 30161

DATE	REVISION

PROJECT NO:
420.03.01
DATE:
JULY 17, 2018
DRAWING TITLE:
FINISH PLAN

A3.60

THIS DRAWING AND ANY REPRODUCTIONS THEREOF ARE THE PROPERTY OF EAOC ARCHITECTS, INC. AND MAY NOT BE REPRODUCED OR TRANSMITTED IN ANY FORM OR BY ANY MEANS WITHOUT THE EXPRESS WRITTEN PERMISSION OF EAOC ARCHITECTS, INC.