



PEACOCK ARCHITECTS  
 255 WESTBURY DR. PKWY  
 ATLANTA, GEORGIA 30328  
 404-251-5200 PHONE  
 404-214-5208 FAX

- GENERAL NOTES**
- FIRE ALARM SUBCONTRACTOR TO PROVIDE LAYOUT AND APPROPRIATE NUMBER/TYPE OF FIXTURES TO MEET NFPA 72 AND AS REQUIRED BY LOCAL JURISDICTION.
  - THIS IS A FULLY SPRINKLERED BUILDING. THIS PROJECT IS TO BE FULLY SPRINKLERED. SPRINKLER CONTRACTOR TO PROVIDE HEAD LAYOUT (RECESSED HEADS IN ACT, CONCEALED HEADS IN GIP BD.) AND SYSTEM COMPONENTS AS REQUIRED BY CODE. PROVIDE A FULLY ENGINEERED SYSTEM AS REQUIRED.
  - SPRINKLER HEADS SHALL BE CENTERED IN ACOUSTICAL CEILING TILE THROUGHOUT PROJECT.
  - REFER TO THE ELECTRICAL DRAWINGS FOR INFORMATION REGARDING ALL FIRE ALARM RELATED DEVICES, LOCATIONS, QUANTITIES, AND SPECIFICATIONS. THE LAYOUT SHOWN ON THIS DRAWING IS FOR GENERAL INFORMATION ONLY AND IS NOT THE FINAL DESIGN.
  - REFER TO THE ELECTRICAL DRAWINGS FOR INFORMATION REGARDING EMERGENCY LIGHTING.
  - AUDIBLE/VISUAL SIGNAL APPLIANCES COMPLYING WITH THE REQUIREMENTS OF RULE 120-3-20-.39 OF THE GEORGIA ACCESSIBILITY CODE AND NFPA 72-2013 EDITION SHALL BE PROVIDED.
  - SMOKE DETECTORS SHALL BE INSTALLED PER THE REQUIREMENTS OF THE OCCUPANCY CHAPTER OF NFPA 101 LIFE SAFETY CODE, 2012 EDITION.
  - AN ANNUAL FIRE ALARM SYSTEM TEST CERTIFICATE IS TO BE PROVIDED AT THE TIME OF FINAL INSPECTION.

- CODIFICATION**
- INTERNATIONAL BUILDING CODE (I.B.C.)
  - LIFE SAFETY CODE
  - INTERNATIONAL GAS CODE
  - INTERNATIONAL MECHANICAL CODE
  - INTERNATIONAL FIRE MARSHAL CODE
  - NATIONAL ELECTRICAL CODE
  - GREEN ACCESSIBILITY CODE
  - INTERNATIONAL FIRE CODE
  - INTERNATIONAL ENERGY CONSERVATION CODE
  - INTERNATIONAL RESIDENTIAL CODE
  - INTERNATIONAL TIME BUILDING CODE
  - INTERNATIONAL PROPERTY MAINTENANCE CODE
  - NATIONAL GREEN BUILDING STANDARD
  - GEORGIA EROSION AND SEDIMENTATION ACT OF 1975
  - NFPA CODES AND STANDARDS

**OCCUPANT LOAD CALCULATIONS (PER NFPA 101 2012)**

GROSS AREA	OCCUPANT LOAD
3,886.75	ASSEMBLY A3 TRAINING ROOM- 961 N.S.F. /15 = 65.4
	ASSEMBLY A3 EXERCISE WEIGHITS- 548 N.S.F. / 50 = 10.9
	BUSINESS (ADMIN. AND LOCKERS)- 2,553.5 N.S.F. /100 = 25.64
3,886.75	TOTAL
	110.04

USING ASSEMBLY A3 15 N.S.F. FOR BUILDING-3,886.75  
 DIVIDED BY 15 N.S.F. (ASSEMBLY A3) = 259.12

**EGRESS WIDTH CALCULATIONS (PER NFPA 101 2012)**

REQUIRED: 259.12 OCCUPANTS X 0.2" PER OCCUPANT = 51.8" OR 52" OF EGRESS WIDTH  
 PROVIDED: (1) EXIT X 72" EGRESS WIDTH = 72" OF EGRESS WIDTH  
 PROVIDED: (2) EXITS X 36" EGRESS WIDTH PER EXIT = 72" OF EGRESS WIDTH  
 TOTAL = 144" OF EGRESS WIDTH

REQUIRED: MINIMUM CORRIDOR WIDTH = 52"  
 PROVIDED: MINIMUM CORRIDOR WIDTH = 60"

**EXIT DISTANCES (PER NFPA 101 2012)**

MINIMUM DISTANCE PERMITTED BETWEEN EXITS = 1/2 \* DIAGONAL (117'-0") = 58'-0"  
 ACTUAL DISTANCE BETWEEN EXITS = DISTANCE BETWEEN EXITS A AND B = 79'-0"  
 ACTUAL DISTANCE BETWEEN EXITS A AND C, TAKING EXCEPTION 7.5.1.3.4 NFPA 101. (TRAVEL PATH METHOD) = 73'-0"  
 COMMON PATH OF TRAVEL = LONGEST BETWEEN TRAINING ROOM AND EXIT A = 17'-5"  
 MAXIMUM PERMITTED = 20'-0"  
 TOTAL TRAVEL DISTANCE = LONGEST BETWEEN TRAINING ROOM AND EXIT A = 79'-3"  
 MAXIMUM PERMITTED = 200'-0"

**LIFE SAFETY PLAN LEGEND**

- 1HR-1HR-1HR- NEW 1 HOUR RATED FIRE PARTITION
- 1HR-1HR-1HR- EXISTING 1 HOUR RATED FIRE PARTITION
- 20 MIN. RATED OPENING
- 45 MIN. RATED OPENING
- 90 MIN. RATED OPENING
- FIRE EXTINGUISHER - SEMI-RECESSED IN WALL
- FIRE ALARM PULL STATION
- FIRE ALARM HORN/STROBE LIGHT
- FIRE ALARM STROBE LIGHT
- EXIT
- EXIT SIGN
- SMOKE DETECTOR
- HEAT DETECTOR

**FIRE EXTINGUISHER MOUNTING HEIGHTS**

NOT TO SCALE

40 LBS: 4'-0" F.E.C. 10 LBS: 4'-6" F.E.B.

TYPICAL FIRE EXTINGUISHER RATING: 10LB. 4A:50BC

FIRE EXTINGUISHERS SHALL BE PROVIDED PER THE REQUIREMENTS OF NFPA 10 FOR THE OCCUPANCY OF THE BUILDING. THE SIZE SHALL BE A MINIMUM OF 2A:10BC, AND SHALL BE INSTALLED AT A MAXIMUM OF 4'-0" ABOVE THE FINISHED FLOOR TO THE TOP OF THE HANDLE.

RELOCATED TRAINING CENTER  
 FOR  
 THE FLOYD COUNTY JAIL  
 2526 NEW CALHOUN HIGHWAY N.E.  
 ROME, GEORGIA 30161

DATE	REVISION

PROJECT NO: 420.03.01  
 DATE: JULY 17, 2018  
 DRAWING TITLE: LIFE SAFETY PLANS

A1.10

THIS DRAWING AND ANY REPRODUCTIONS THEREOF ARE THE PROPERTY OF PEACOCK ARCHITECTS, INC. AND MAY NOT BE REPRODUCED OR TRANSMITTED IN ANY FORM OR BY ANY MEANS WITHOUT THE EXPRESS WRITTEN PERMISSION OF PEACOCK ARCHITECTS, INC.

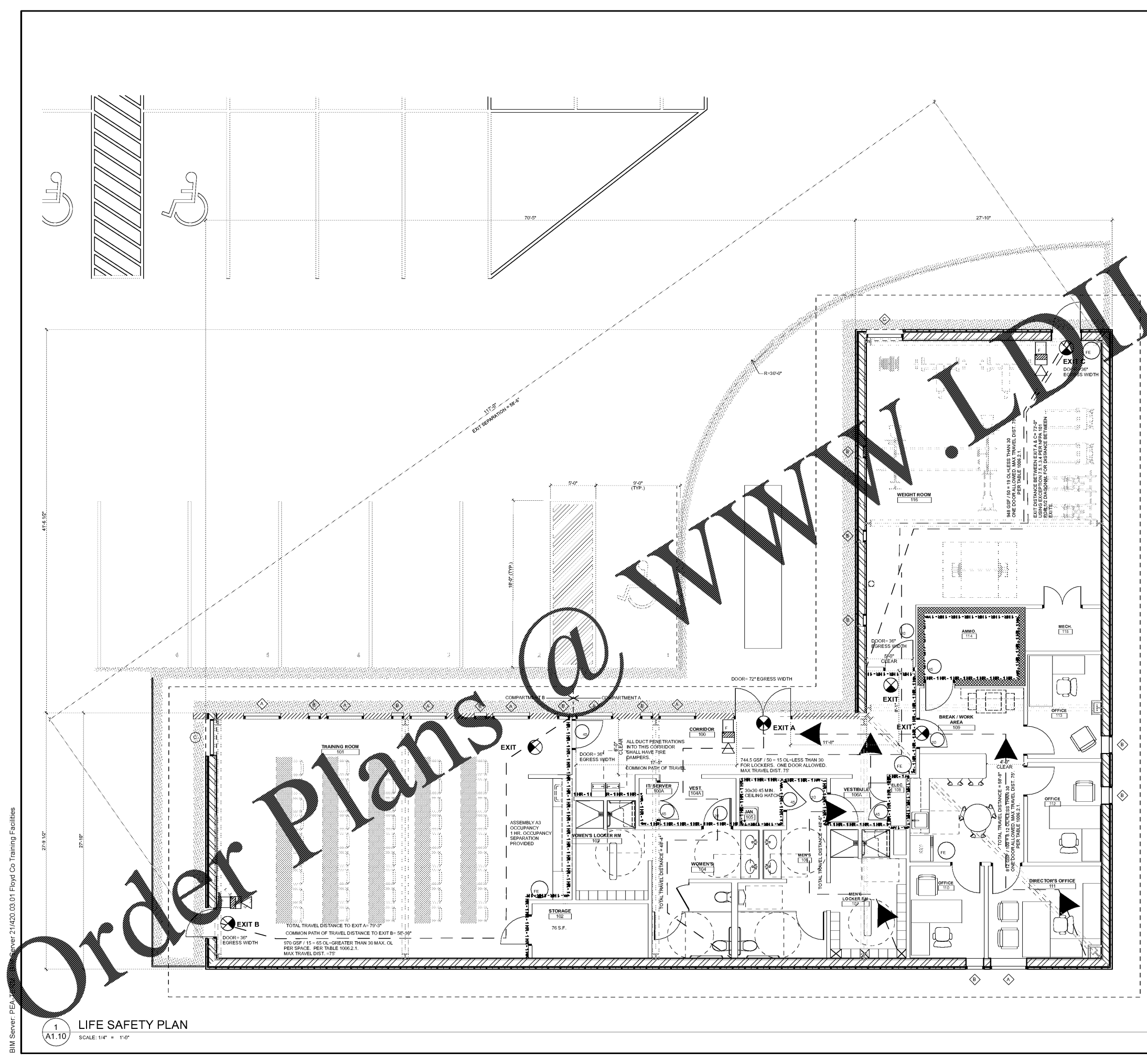

BIM Server: PEACOCK ARCHITECTS 2/14/20 03.01 Floyd Co Training Facilities

**1 LIFE SAFETY PLAN**  
 SCALE: 1/4" = 1'-0"

Order Plans @ [www.dline.com](http://www.dline.com)