

ARCH. DRAWING ABBREVIATIONS

A	AND	F.C.	FLOOR DRAIN	F.D.	FOUNDATION	F.E.	FIRE EXTINGUISHER	F.E.C.	FIRE EXTINGUISHER CABINET	F.N.	FIXTURE	F.L.	FLOOR	F.L.A.S.H.	FLASHING	F.O.	FACE OF FINISH	F.O.C.	FACE OF CONCRETE	F.O.F.	FACE OF FINISH	F.M.	FACE OF MASONRY	F.S.	FACE OF STUDS	F.R.T.	FIRE-RETARDANT TREATED	FT.	FOOT OR FEET	FTG.	FOOTING	F.T.G.	FINE TABLETOPS & GIFTWARE	FURR.	FURRING	GA.	GAUGE	GALV.	GALVANIZED	GL.	GLASS	GR.	GRADE	GYP.	GYP. WALLBOARD	GYP.BD.	GYP.BD.	HAC.	HEATING AND COOLING	H.B.	HOSE BIBB	H.B.C.	HEALTH & BEAUTY CARE	H.C.	HOLLOW CORE	H.C.	HEAVY DUTY	H.D.	HARDWOOD	H.D.W.	HARDWARE	H.M.	HOLLOW METAL	HORIZ.	HORIZONTAL	HR.	HOUR	HGT.	HEIGHT	HSS.	HOLLOW STEEL SECTION	I.D.	INSIDE DIMENSION	I.G.	INSULATING GLASS	INFO.	INFORMATION	INSUL.	INSULATION	INT.	INTERIOR	I.S.A.	INTERNATIONAL SYMBOL OF ACCESSIBILITY	JAN.	JANITOR	JT.	JOINT	KIT.	KITCHEN	L.	LENGTH	L.A.M.	LAMINATE	L.V.	LAVATORY	LGT.	LIGHT	MAS.	MASONRY	MAX.	MAXIMUM	MECH.	MECHANICAL	MED.	MEDIUM	MEMB.	MEMBRANE	MET.	METAL	MFR.	MANUFACTURER	MIN.	MINIMUM	MISC.	MISCELLANEOUS	M.O.	MASONRY OPENING	M.R.	MOISTURE RESISTANT	MTD.	MOUNTED	MTG.	MOUNTING	N.	NORTH	N.C.	NOT IN CONTRACT	NO.	NUMBER	NOM.	NOMINAL	N.T.S.	NOT TO SCALE	O.A.	OVERALL	OBSC.	OBSCURE	O.C.	ON CENTER	O.D.	OUTSIDE DIMENSION	OPNG.	OPENING	OPP.	OPPOSITE	O.H.	OVERHANG	D	DEPTH	DBL.	DOUBLE	D.B.R.	DELUXE BRIDAL REGISTRY	DEPT.	DEPARTMENT	D.F.	DRINKING FOUNTAIN	DET.	DETAIL	DIAM.	DIAMETER	DIM.	DIMENSION	DISP.	DISPENSER	DN.	DOWN	D.O.	DOOR OPENING	DR.	DOOR	DWR.	DRAWER	D.S.	DOWNSPOUT	DWG.	DRAWING	E.	EAST	E.A.	EACH	E.I.F.S.	EXT. INSUL. & FINISH SYSTEM	E.J.	EXPANSION JOINT	EL.	ELEVATION	ELEC.	ELECTRICAL	EMER.	EMERGENCY	ENCL.	ENCLOSURE	EQ.	EQUAL	EQT.	EQUIPMENT	E.W.C.	ELECTRIC WATER COOLER	EXP.	EXPANSION	EXPO.	EXPOSED	EXT.	EXISTING	EXT.	EXTERIOR
---	-----	------	-------------	------	------------	------	-------------------	--------	---------------------------	------	---------	------	-------	------------	----------	------	----------------	--------	------------------	--------	----------------	------	-----------------	------	---------------	--------	------------------------	-----	--------------	------	---------	--------	---------------------------	-------	---------	-----	-------	-------	------------	-----	-------	-----	-------	------	----------------	---------	---------	------	---------------------	------	-----------	--------	----------------------	------	-------------	------	------------	------	----------	--------	----------	------	--------------	--------	------------	-----	------	------	--------	------	----------------------	------	------------------	------	------------------	-------	-------------	--------	------------	------	----------	--------	---------------------------------------	------	---------	-----	-------	------	---------	----	--------	--------	----------	------	----------	------	-------	------	---------	------	---------	-------	------------	------	--------	-------	----------	------	-------	------	--------------	------	---------	-------	---------------	------	-----------------	------	--------------------	------	---------	------	----------	----	-------	------	-----------------	-----	--------	------	---------	--------	--------------	------	---------	-------	---------	------	-----------	------	-------------------	-------	---------	------	----------	------	----------	---	-------	------	--------	--------	------------------------	-------	------------	------	-------------------	------	--------	-------	----------	------	-----------	-------	-----------	-----	------	------	--------------	-----	------	------	--------	------	-----------	------	---------	----	------	------	------	----------	-----------------------------	------	-----------------	-----	-----------	-------	------------	-------	-----------	-------	-----------	-----	-------	------	-----------	--------	-----------------------	------	-----------	-------	---------	------	----------	------	----------

SYMBOLS LEGEND

(A)	COLUMN LINE	XXX-#	FINISH TYPE
(AS.2)	DETAIL/DWG.	SF-##	STOREFRONT TYPE
(AS.2)	ELEVATION/DWG. OR BLDG. SECTION/DWG.	NAME XXX	ROOM NAME & NUMBER
(AS.2)	WALL SECTION/DWG. OR DETAIL/DWG.	[Symbol]	FIRE EXTING. CABINET
[Symbol]	INTERIOR ELEVATIONS	[Symbol]	REVISION - ADDENDUM/CONSTRUCTION BULLETIN
[Symbol]	SPOT ELEVATION	[Symbol]	SOUTH
[Symbol]	DATUM	[Symbol]	S.S.T. STAINLESS STEEL

VICINITY MAP

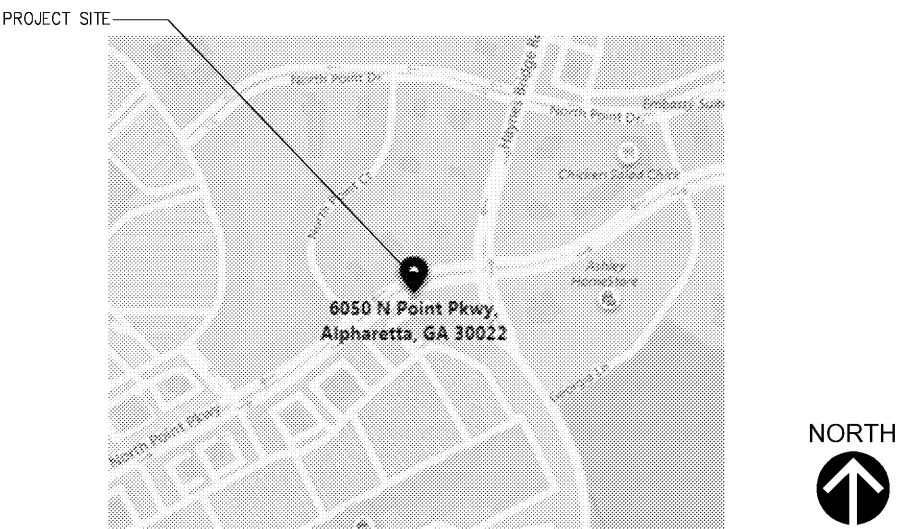

BED BATH & BEYOND

TENANT IMPROVEMENT FOR AN EXISTING BED BATH & BEYOND STORE
#103 ALPHARETTA, GA
 6050 NORTH POINT PARKWAY, ALPHARETTA, GA 30022

CURRENT ISSUE DRAWINGS

ARCHITECTURAL PLANS	SHEET	DRAWING TITLE	APR REVIEW	MAY REVIEW	PERMIT SET
A0.1	CURRENT SHEET		X	X	
A1.1	OVERALL FLOOR PLAN AND DETAILS		X	X	
A1.1	BANNER LOCATION FLOOR PLANS AND DETAILS		X	X	
A2.1	ENLARGED FLOOR PLAN AND DETAILS (HBC, TABLETOP & BEV. DEPT.)		X	X	
A2.2	ENLARGED FLOOR PLAN AND DETAILS (BEVERAGE DEPARTMENT)		X	X	
A2.3	ENLARGED RUG WALL FLOOR PLAN AND ELEVATION		X	X	
A2.4	INTERIOR ELEVATION (FRONT WALL) AND DETAILS		X	X	
A2.5	ENLARGED FOOD PREP ROOM FLOOR PLANS, ELEVATIONS AND DETAILS		X	X	
A2.7	ENLARGED BREAK ROOM FLOOR PLAN, ELEVATIONS AND DETAILS		X	X	
A3.1	FLOOR FINISH PLAN AND FINISH LEGEND		X	X	
A3.2	INTERIOR ELEVATIONS, FINISH DETAILS & ROOM FINISH SCHED.		X	X	
A6.0	OVERALL HIGH PILE STORAGE PLAN		X	X	
A8.1	HUB DESK & QUEUE LINE MILLWORK		X	X	
A8.2	BEVERAGE/CONDIMENT MILLWORK DETAILS		X	X	

STRUCTURAL DRAWINGS	SHEET	DRAWING TITLE	APR REVIEW	MAY REVIEW	PERMIT SET
S1.0	GENERAL NOTES		X	X	
S2.0	CHAIR/RUG/LIGHTING WALL FRAMING PLAN & ELEVATION		X	X	
S3.0	SECTIONS & DETAILS		X	X	

ELECTRICAL PLANS	SHEET	DRAWING TITLE	APR REVIEW	MAY REVIEW	PERMIT SET
E3.0	POWER PLAN		X	X	
E3.1	ENLARGED ARCH POWER/LIGHTING PLAN (FRONT END)		X	X	
E3.2	ENLARGED POWER PLAN (HBC & BEDDING)		X	X	
E4.0	LIGHTING PLAN		X	X	
E5.0	RISER DIAGRAM AND NOTES		X	X	
E6.0	PANEL SCHEDULES		X	X	
ED.1	DEMO/RELOCATION LIGHTING PLAN		X	X	

MECHANICAL/PLUMBING PLANS	SHEET	DRAWING TITLE	APR REVIEW	MAY REVIEW	PERMIT SET
M1.1	MECHANICAL FLOOR PLAN		X	X	
MP.1	FLOOR PLAN MECHANICAL AND PLUMBING		X	X	
P1.1	SCHEDULES, SYMBOLS AND NOTES		X	X	
P2.1	ENLARGED PARTIAL PLUMBING PLANS		X	X	
P2.2	PARTIAL PLUMBING PLAN, NOTES AND DIAGRAMS		X	X	
P3.1	PLUMBING DETAILS		X	X	

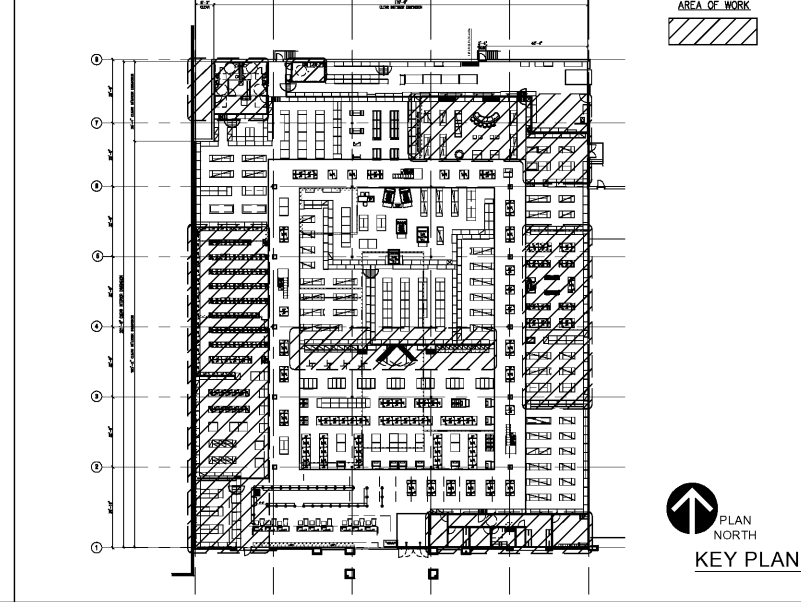

PROJECT TEAM

OWNER:
 BED BATH & BEYOND
 650 LIBERTY AVE.
 UNION, NJ 07083
 (908) 855-4275 PHONE NUMBER
 (908) 888-0295 FAX NUMBER
 JOHN HOLDEN, ARCHITECTURAL PROJECT MANAGER
 John.Holder@bedbath.com
 (908) 855-2033 FAX: (704) 556-0481
 TODD WASHOWICH, CONSTRUCTION PROJECT MANAGER
 Todd.Washowich@bedbath.com

ARCHITECT: - TI WORK
 ARCHITECTURAL GROUP INTERNATIONAL
 15 WEST SEVENTH STREET
 COVINGTON, KY 41011
 859-281-5400 PHONE NUMBER
 859-281-5530 FAX NUMBER
 CHUCK HUNTER
 chunter@ti-work.com

MEP ENGINEERS:
 PRECISION ENGINEERING GROUP, LLC
 5800 E. SKELLY DR. SUITE 1100
 TULSA, OK 74135
 918-749-3000 PHONE NUMBER
 918-749-3003 FAX NUMBER
 GREG WILEY
 gwiley@precisiongroup.net

RESPONSIBILITY SCHEDULE

ITEM DESCRIPTION:	FURNISHED BY:		INSTALLED BY:		NOTES:
	G.C.	BBB	G.C.	BBB	
COMPUTER/P.O.S. WIRING		■		■	CONDUIT & PULL-STRING BY ELECTRICIAN - AS SHOWN ON DWGS.
REGISTER BAYS (CASH-WRAPPS) & REMOTE SERVICE DESKS		■		■	CONTRACTOR TO OFF-LOAD, PROVIDE SECURED STORAGE, INSTALL & MAKE FINAL ELECTRICAL CONNECTIONS.
STORE SALES FIXTURES & STORAGE FIXTURES		■		■	CONTRACTOR TO MAKE FINAL ELECTRICAL CONNECTIONS.
EXTERIOR BANNERS		■		■	GENERAL CONTRACTOR TO COORDINATE BANNER LOCATION WITH CPM
NEW BREAK ROOM		■		■	GENERAL CONTRACTOR TO PURCHASE NEW BREAK ROOM FURNITURE CONTACT: Jamie Hooper; Everson Best; jhooper@eversonbest.com; 663-2762

APPLICABLE BUILDING CODES

BUILDING CODE: 2012 INTERNATIONAL BUILDING CODE WITH GEORGIA AMENDMENTS
 PLUMBING CODE: 2012 INTERNATIONAL PLUMBING CODE WITH GEORGIA AMENDMENTS
 MECHANICAL CODE: 2012 INTERNATIONAL MECHANICAL CODE WITH GEORGIA AMENDMENTS
 ELECTRICAL CODE: 2017 NATIONAL ELECTRICAL CODE WITH GEORGIA AMENDMENTS
 STRUCTURAL CODE: 2012 INTERNATIONAL BUILDING CODE WITH GEORGIA AMENDMENTS
 ENERGY CODE: 2009 INTERNATIONAL ENERGY CONSERVATION CODE WITH GEORGIA AMENDMENTS, ASHRAE/IESNA STANDARD 90.1 - 2004 WITH GEORGIA AMENDMENTS
 FIRE CODE: 2012 STANDARD FIRE PREVENTION CODE W/ GEORGIA AMENDMENTS
 ACCESSIBILITY: 2012 LIFE SAFETY CODE, CITY SPRINKLER CODE - ORD. NO. 220
 SCOPE OF WORK: GSFG RULES AND REQUIREMENTS 120-3-20

- CODE DATA**
- USE GROUP: M - MERCANTILE
 - TYPE OF CONSTRUCTION (TABLE 601 PER FIRE RESISTANCE RATING REQUIREMENTS FOR BUILDING ELEMENTS): TYPE II-B, FULLY SPRINKLERED
 - EXIT ACCESS TRAVEL DISTANCE (SECTION 1016.2): USE GROUP M (WITH SPRINKLER SYSTEM) = 250 FEET MAX.
 - SALES FLOOR AREA = 33,516 S.F.
 OFFICES = 853 S.F.
 STOCK = 4,851 S.F.
 ASSEMBLY = 258 S.F.
 PREP KITCHEN = 143 S.F.
 TOTAL = 39,621 S.F.
 - MINIMUM 44" AISLES WIDTH PROVIDED.
 OCCUPANT CONTENT (TABLE 1004.1.2):
 [GROSS AREA / SF PER PERSON = # PERSONS]
 MERCANTILE (RETAIL) 33,516 SF/60 = 559 OCC.
 BUSINESS (MEZZ. OFF'S) 853 SF/100 = 9 OCC.
 STOCK AREA (PRE-SALES) 4,851 SF/300 = 16 OCC.
 BREAK ROOM 258 SF/15 = 17 OCC.
 PREP KITCHEN 143 SF/200 = 1 OCC.
 TOTAL OCCUPANT LOAD 602 OCC.
 - EGRESS WIDTH (SECTION 1005.3.2):
 EGRESS WIDTH PROVIDED = 326" (NO CHANGES)
 EGRESS WIDTH REQUIRED = 176"
 - NO. OF EXITS (SECTION 1015.1.1): REQUIRED 4 PROVIDED 5 (NO CHANGES)
 - PLUMBING FIXTURE -NO CHANGES ANTICIPATED (TABLE "403.1" IPC): (EXISTING COUNT MEETS REQUIREMENTS)
 - NOTES:
 1. ALL GYP. BD. SHALL BE 5/8" UNLESS OTHERWISE NOTED.
 2. BASED ON OCCUPANT CONTENT, THIS BUILDING PROVIDES THE MINIMUM REQUIRED PLUMBING FIXTURES.
 3. ALL OVERHEAD OBSTRUCTIONS SHALL BE A MIN. 16'-6" A.F.F. G.C. SHALL COORDINATE ALL TRADES.

SPECIAL INSPECTIONS

CONTRACTOR SHALL VERIFY REQUIREMENTS FOR SPECIAL INSPECTIONS OF STEEL FABRICATION AND INSTALLATION AS WELL AS ANY OTHER SPECIAL INSPECTIONS.

FIELD VERIFICATION NOTE

CONTRACTOR(S) SHALL VERIFY EXISTING CONDITIONS AND CORRELATE DIMENSIONS PRIOR TO PROVIDING THE WORK DETAILED IN THESE DRAWINGS, AND SHALL PROMPTLY NOTIFY THE ARCHITECT OF ANY DISCREPANCIES.

GENERAL NOTES

- PEDESTRIANS SHALL BE PROTECTED DURING CONSTRUCTION, REMODELING AND DEMOLITION ACTIVITIES
- THERE SHALL BE NO STORING OF MATERIALS ON CONCRETE IN AREAS TO RECEIVE THE CONCRETE FINISH TREATMENT.
- ALL LIFTS TO BE DIAPERED (TO PREVENT LEAKING FLUIDS FROM REACHING THE FLOOR) AND USE NON-MARKING TIRES.

● CONTRACTOR(S) SHALL VERIFY EXISTING CONDITIONS AND CORRELATE DIMENSIONS PRIOR TO PROVIDING THE WORK DETAILED IN THESE DRAWINGS, AND SHALL PROMPTLY NOTIFY THE ARCHITECT OF ANY DISCREPANCIES.



BBBY REVISION TRACKER

DD'S	PERMIT SET

BED BATH & BEYOND
 Beyond any store of its kind.
 PROJECT NAME & LOCATION:
103 ALPHARETTA, GA
 6050 NORTH POINT PARKWAY
 ALPHARETTA, GA 30022

DISTRIBUTION	DATE
OWNER REVIEW	09/13/16
PERMIT SET	09/25/16

DRAWING TITLE:
COVER SHEET
A0.1