

**BARTON & SUMMER  
ENGINEERING, LLC**

3213 MIDTOWN PARK SOUTH  
MOBILE, AL 36606  
PHONE: 251-219-4942

**FOUNDATION PLAN  
MULHERIN CUSTODIAL HOME**

2496 HALLS MILL ROAD  
MOBILE, ALABAMA

LOCATION:

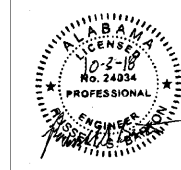

FOR PERMIT

REVISIONS:

DRAWN BY: DRB

DESIGNED BY: CHE

DATE:

03 OCT 2018

SHEET

S1.0

18262

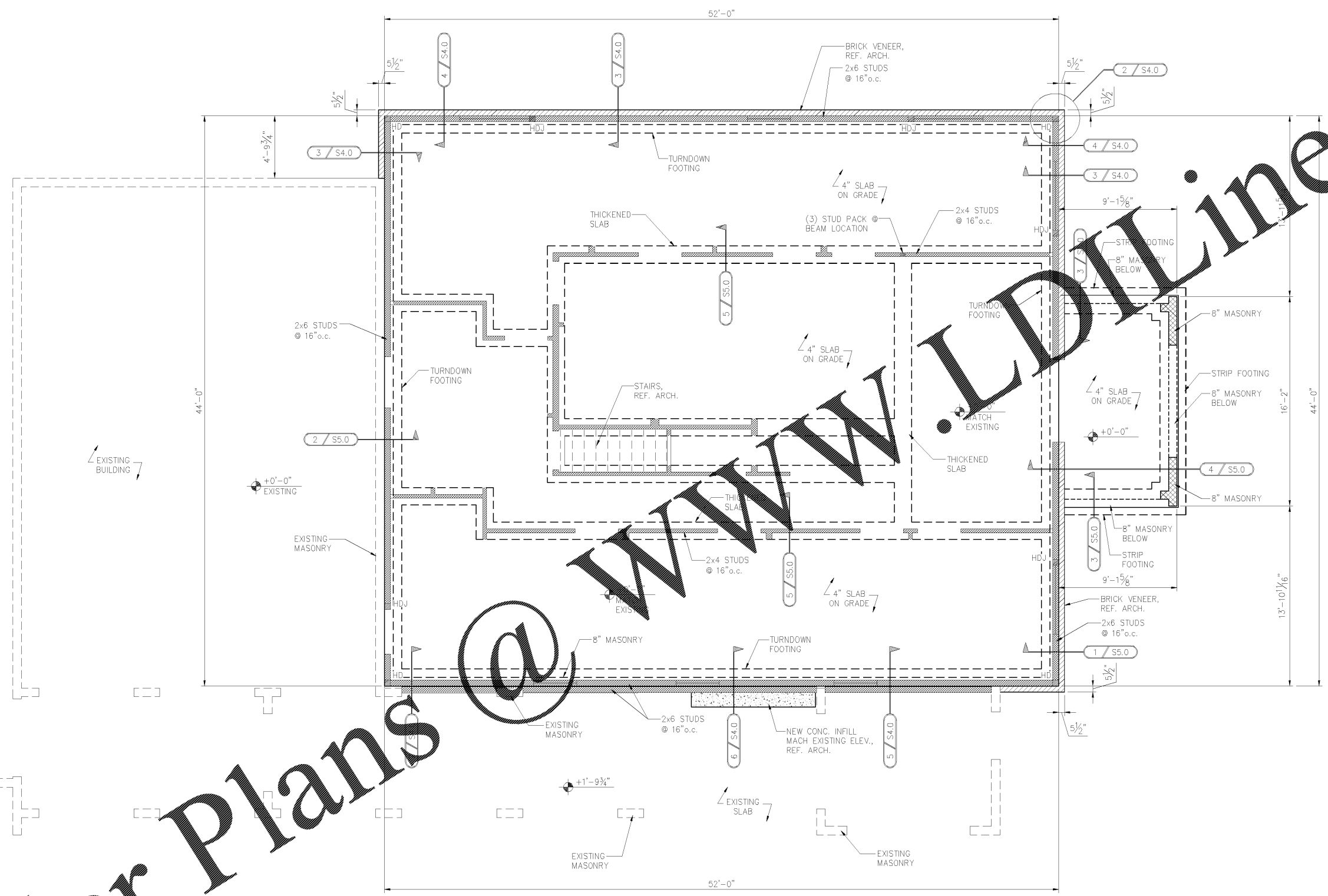

- NOTES:**
1. VERIFY ALL DIMENSIONS & FINISH ELEVATIONS WITH ARCHITECTURAL PRIOR TO STARTING CONSTRUCTION.
  2. ALL DIMENSIONS ARE TO THE INSIDE FACE OF SLAB OR FACE OF SLAB.

**SLAB ON-GRADE CONSTRUCTION**

4" CONCRETE SLAB REINFORCED WITH 6X6-W1.4XW1.4 WWF FLAT SHEETS PLACED ON BRICKS/CHAIRS. PLACE OVER VAPOR BARRIER AND COMPACTED STRUCTURAL FILL MATERIAL. FILL TO BE PLACED IN 8" LIFTS AND COMPACTED TO 95% STANDARD PROCTOR DENSITY.

**NOTE:**  
ALL EXPOSED TIES AND STRAPS TO BE STAINLESS STEEL OR TRIPLE ZINC

**FOUNDATION PLAN**  
SCALE: 1/4"=1'-0"  
FINISH FLOOR = +0'-0" U.N.O.

**LEGEND**

⊕ +0'-0"	FINISHED FLOOR ELEVATION
■ HD	HDU4-SDS2.5 HOLDDOWN BY SIMPSON
■ HDJ	HDU4-SDS2.5 HOLDDOWN @ JAMB
FOB	FACE OF BRICK

