

**NewBrick®** NewBrick Cutaways

NOTE:  
1. CUTAWAYS FOR TYPICAL INTERLOCKING JOINTS.  
2. CUTAWAYS FOR TYPICAL INTERLOCKING JOINTS WITH ANCHORING SYSTEM.  
3. THE ANCHORING SYSTEM IS A REGISTERED TRADEMARK OF ROY WILLIAMS ARCHITECT, INC.  
4. ALL DIMENSIONS ARE IN INCHES UNLESS OTHERWISE SPECIFIED.

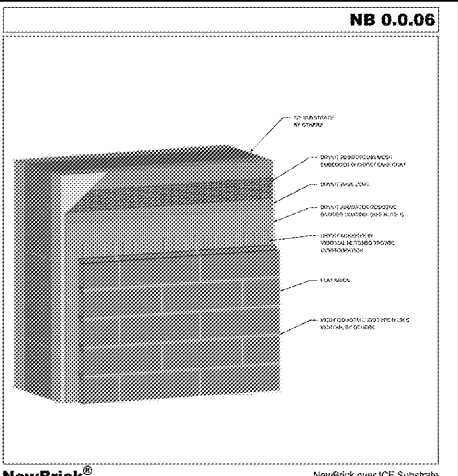

**NewBrick®** NewBrick over ICF Substrate

NOTE:  
1. CUTAWAYS FOR TYPICAL INTERLOCKING JOINTS.  
2. CUTAWAYS FOR TYPICAL INTERLOCKING JOINTS WITH ANCHORING SYSTEM.  
3. THE ANCHORING SYSTEM IS A REGISTERED TRADEMARK OF ROY WILLIAMS ARCHITECT, INC.  
4. ALL DIMENSIONS ARE IN INCHES UNLESS OTHERWISE SPECIFIED.

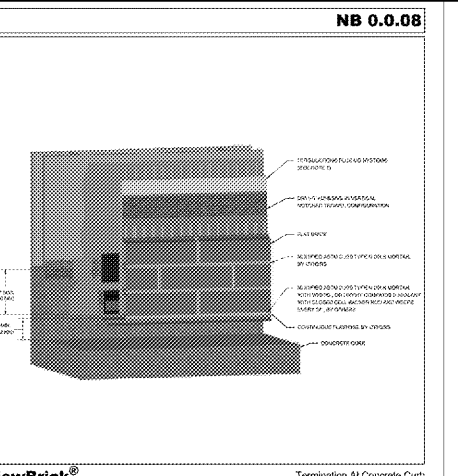

**NewBrick®** Termination At Concrete Curt

NOTE:  
1. CUTAWAYS FOR TYPICAL INTERLOCKING JOINTS.  
2. CUTAWAYS FOR TYPICAL INTERLOCKING JOINTS WITH ANCHORING SYSTEM.  
3. THE ANCHORING SYSTEM IS A REGISTERED TRADEMARK OF ROY WILLIAMS ARCHITECT, INC.  
4. ALL DIMENSIONS ARE IN INCHES UNLESS OTHERWISE SPECIFIED.

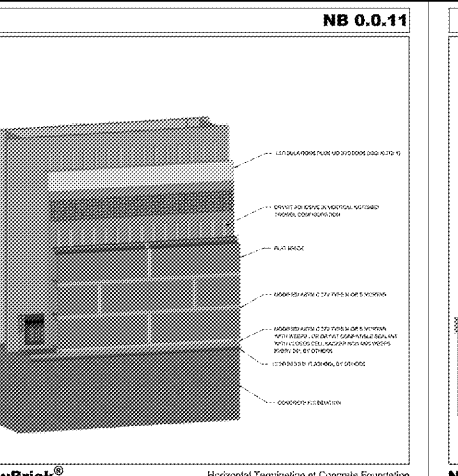

**NewBrick®** Horizontal Termination at Concrete Foundation

NOTE:  
1. CUTAWAYS FOR TYPICAL INTERLOCKING JOINTS.  
2. CUTAWAYS FOR TYPICAL INTERLOCKING JOINTS WITH ANCHORING SYSTEM.  
3. THE ANCHORING SYSTEM IS A REGISTERED TRADEMARK OF ROY WILLIAMS ARCHITECT, INC.  
4. ALL DIMENSIONS ARE IN INCHES UNLESS OTHERWISE SPECIFIED.

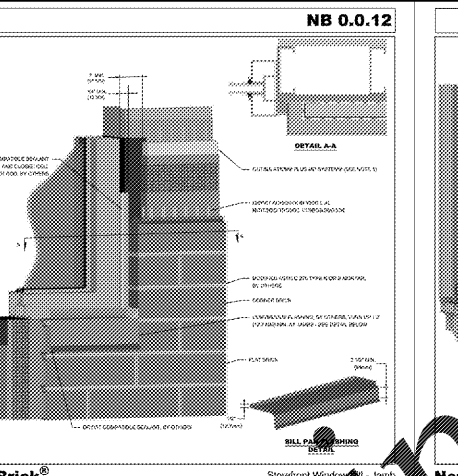

**NewBrick®** Storefront Windows - Jamb

NOTE:  
1. CUTAWAYS FOR TYPICAL INTERLOCKING JOINTS.  
2. CUTAWAYS FOR TYPICAL INTERLOCKING JOINTS WITH ANCHORING SYSTEM.  
3. THE ANCHORING SYSTEM IS A REGISTERED TRADEMARK OF ROY WILLIAMS ARCHITECT, INC.  
4. ALL DIMENSIONS ARE IN INCHES UNLESS OTHERWISE SPECIFIED.

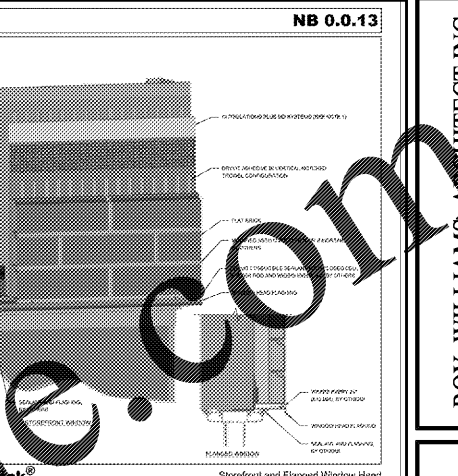

**NewBrick®** Storefront and Flanged Window Head

NOTE:  
1. CUTAWAYS FOR TYPICAL INTERLOCKING JOINTS.  
2. CUTAWAYS FOR TYPICAL INTERLOCKING JOINTS WITH ANCHORING SYSTEM.  
3. THE ANCHORING SYSTEM IS A REGISTERED TRADEMARK OF ROY WILLIAMS ARCHITECT, INC.  
4. ALL DIMENSIONS ARE IN INCHES UNLESS OTHERWISE SPECIFIED.

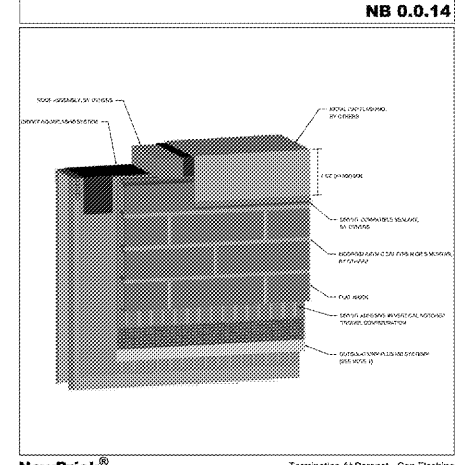

**NewBrick®** Termination At Parapet - Cap Flashing

NOTE:  
1. CUTAWAYS FOR TYPICAL INTERLOCKING JOINTS.  
2. CUTAWAYS FOR TYPICAL INTERLOCKING JOINTS WITH ANCHORING SYSTEM.  
3. THE ANCHORING SYSTEM IS A REGISTERED TRADEMARK OF ROY WILLIAMS ARCHITECT, INC.  
4. ALL DIMENSIONS ARE IN INCHES UNLESS OTHERWISE SPECIFIED.

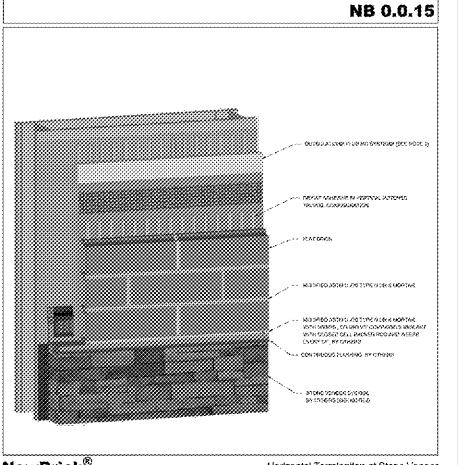

**NewBrick®** Horizontal Termination at Stone Veneer

NOTE:  
1. CUTAWAYS FOR TYPICAL INTERLOCKING JOINTS.  
2. CUTAWAYS FOR TYPICAL INTERLOCKING JOINTS WITH ANCHORING SYSTEM.  
3. THE ANCHORING SYSTEM IS A REGISTERED TRADEMARK OF ROY WILLIAMS ARCHITECT, INC.  
4. ALL DIMENSIONS ARE IN INCHES UNLESS OTHERWISE SPECIFIED.

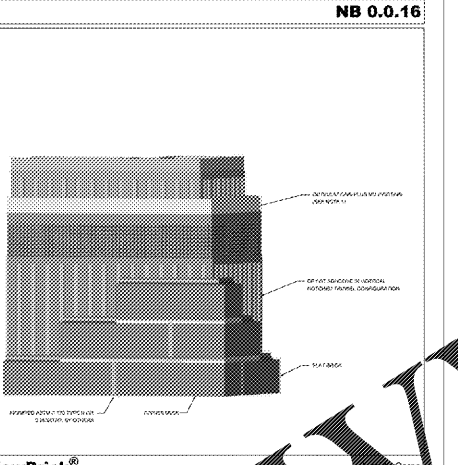

**NewBrick®** Horizontal Termination at Cornice

NOTE:  
1. CUTAWAYS FOR TYPICAL INTERLOCKING JOINTS.  
2. CUTAWAYS FOR TYPICAL INTERLOCKING JOINTS WITH ANCHORING SYSTEM.  
3. THE ANCHORING SYSTEM IS A REGISTERED TRADEMARK OF ROY WILLIAMS ARCHITECT, INC.  
4. ALL DIMENSIONS ARE IN INCHES UNLESS OTHERWISE SPECIFIED.

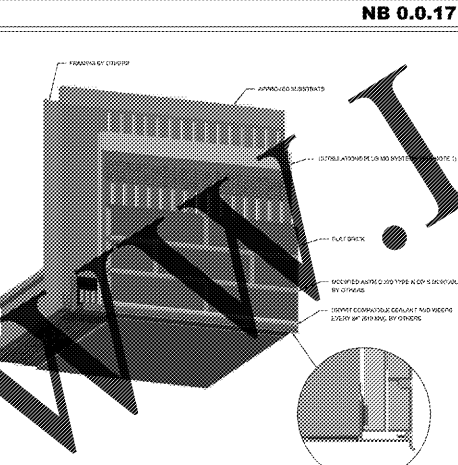

**NewBrick®** Fascia/Uninsulated Soffit Transition

NOTE:  
1. CUTAWAYS FOR TYPICAL INTERLOCKING JOINTS.  
2. CUTAWAYS FOR TYPICAL INTERLOCKING JOINTS WITH ANCHORING SYSTEM.  
3. THE ANCHORING SYSTEM IS A REGISTERED TRADEMARK OF ROY WILLIAMS ARCHITECT, INC.  
4. ALL DIMENSIONS ARE IN INCHES UNLESS OTHERWISE SPECIFIED.

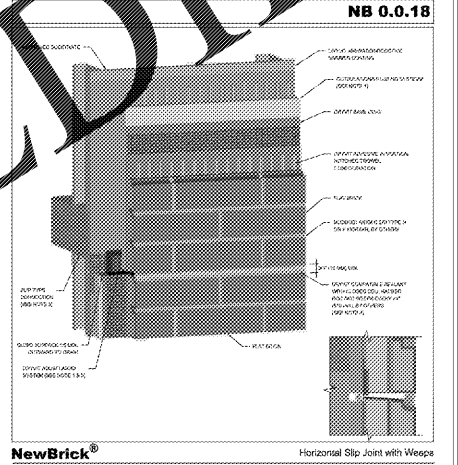

**NewBrick®** Horizontal Slip Joint with Weeps

NOTE:  
1. CUTAWAYS FOR TYPICAL INTERLOCKING JOINTS.  
2. CUTAWAYS FOR TYPICAL INTERLOCKING JOINTS WITH ANCHORING SYSTEM.  
3. THE ANCHORING SYSTEM IS A REGISTERED TRADEMARK OF ROY WILLIAMS ARCHITECT, INC.  
4. ALL DIMENSIONS ARE IN INCHES UNLESS OTHERWISE SPECIFIED.

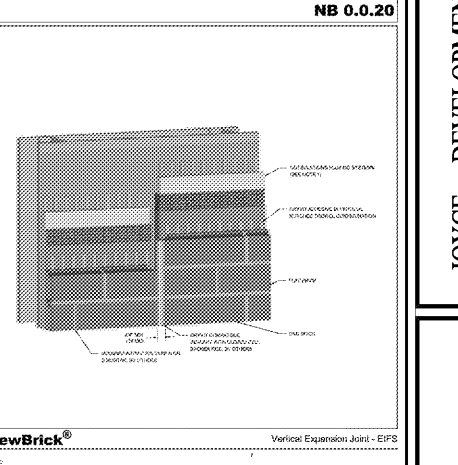

**NewBrick®** Vertical Expansion Joint - EPS

NOTE:  
1. CUTAWAYS FOR TYPICAL INTERLOCKING JOINTS.  
2. CUTAWAYS FOR TYPICAL INTERLOCKING JOINTS WITH ANCHORING SYSTEM.  
3. THE ANCHORING SYSTEM IS A REGISTERED TRADEMARK OF ROY WILLIAMS ARCHITECT, INC.  
4. ALL DIMENSIONS ARE IN INCHES UNLESS OTHERWISE SPECIFIED.

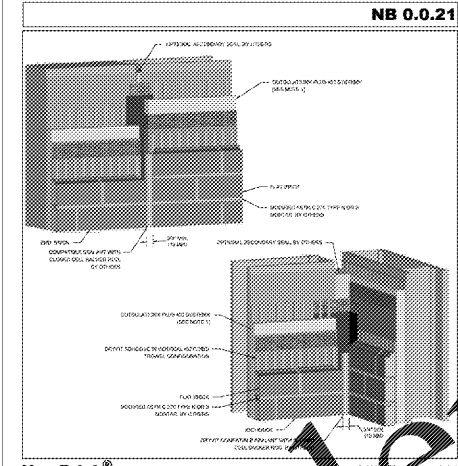

**NewBrick®** Rough-Work Transition Joint

NOTE:  
1. CUTAWAYS FOR TYPICAL INTERLOCKING JOINTS.  
2. CUTAWAYS FOR TYPICAL INTERLOCKING JOINTS WITH ANCHORING SYSTEM.  
3. THE ANCHORING SYSTEM IS A REGISTERED TRADEMARK OF ROY WILLIAMS ARCHITECT, INC.  
4. ALL DIMENSIONS ARE IN INCHES UNLESS OTHERWISE SPECIFIED.

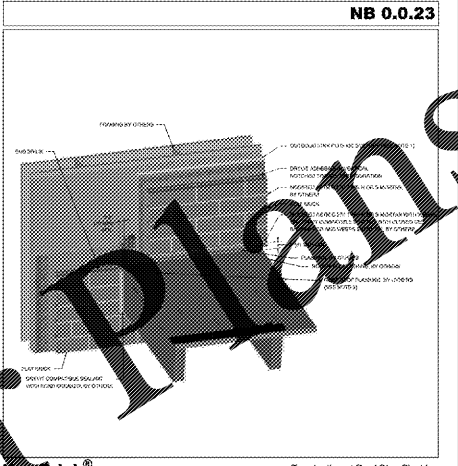

**NewBrick®** Termination at Roof Step Flashing

NOTE:  
1. CUTAWAYS FOR TYPICAL INTERLOCKING JOINTS.  
2. CUTAWAYS FOR TYPICAL INTERLOCKING JOINTS WITH ANCHORING SYSTEM.  
3. THE ANCHORING SYSTEM IS A REGISTERED TRADEMARK OF ROY WILLIAMS ARCHITECT, INC.  
4. ALL DIMENSIONS ARE IN INCHES UNLESS OTHERWISE SPECIFIED.

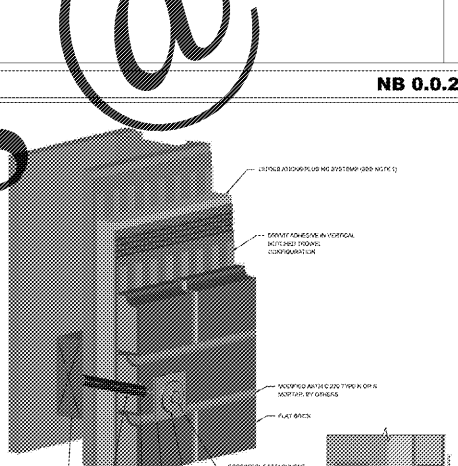

**NewBrick®** Sign Attachment

NOTE:  
1. CUTAWAYS FOR TYPICAL INTERLOCKING JOINTS.  
2. CUTAWAYS FOR TYPICAL INTERLOCKING JOINTS WITH ANCHORING SYSTEM.  
3. THE ANCHORING SYSTEM IS A REGISTERED TRADEMARK OF ROY WILLIAMS ARCHITECT, INC.  
4. ALL DIMENSIONS ARE IN INCHES UNLESS OTHERWISE SPECIFIED.

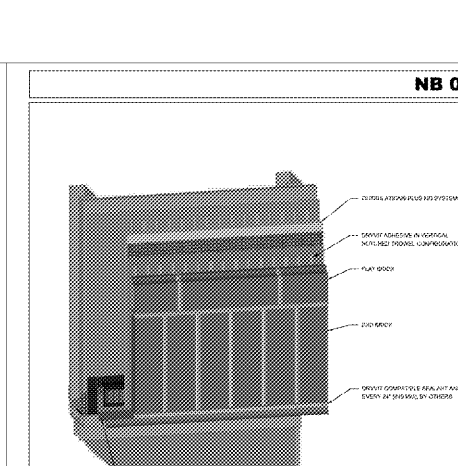

**NewBrick®** Soldier Course at Window Head

NOTE:  
1. CUTAWAYS FOR TYPICAL INTERLOCKING JOINTS.  
2. CUTAWAYS FOR TYPICAL INTERLOCKING JOINTS WITH ANCHORING SYSTEM.  
3. THE ANCHORING SYSTEM IS A REGISTERED TRADEMARK OF ROY WILLIAMS ARCHITECT, INC.  
4. ALL DIMENSIONS ARE IN INCHES UNLESS OTHERWISE SPECIFIED.

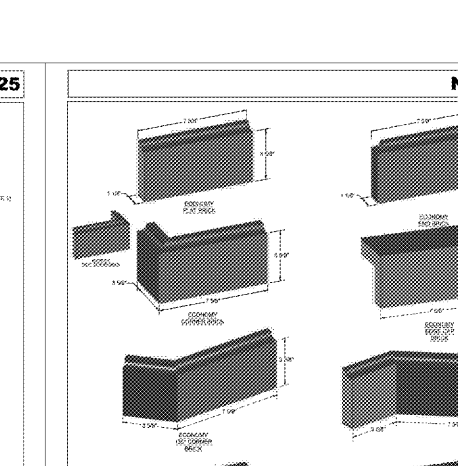

**NewBrick®** NewBrick Economy Dimensions

NOTE:  
1. CUTAWAYS FOR TYPICAL INTERLOCKING JOINTS.  
2. CUTAWAYS FOR TYPICAL INTERLOCKING JOINTS WITH ANCHORING SYSTEM.  
3. THE ANCHORING SYSTEM IS A REGISTERED TRADEMARK OF ROY WILLIAMS ARCHITECT, INC.  
4. ALL DIMENSIONS ARE IN INCHES UNLESS OTHERWISE SPECIFIED.

ROY WILLIAMS ARCHITECT, INC.  
ARCHITECTURE \* LAND PLANNING \* GRAPHICS  
2465 US-1, SUITE 84, ST AUGUSTINE, FL 32086  
904-422-8888 \* RWARCHITECTUREGROUP@GMAIL.COM

JOYCE DEVELOPMENT GROUP

BRANAN FIELD WALK  
MIDDLEBURG, FLORIDA  
MISCELLANEOUS DETAILS

DATE:	SCALE:
RELEASED FOR PERMIT:	3/16" = 1'-0"
RELEASED FOR CONSTRUCTION:	
NO.:	REVISIONS:
DATE:	

Date:  
Scale: 3/16" = 1'-0"  
Drawn:  
Checked:  
Sheet No:  
**A-10**  
- OF -

Order Plans @

WWW.LDILLINE.COM