

Order Plans @

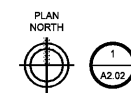
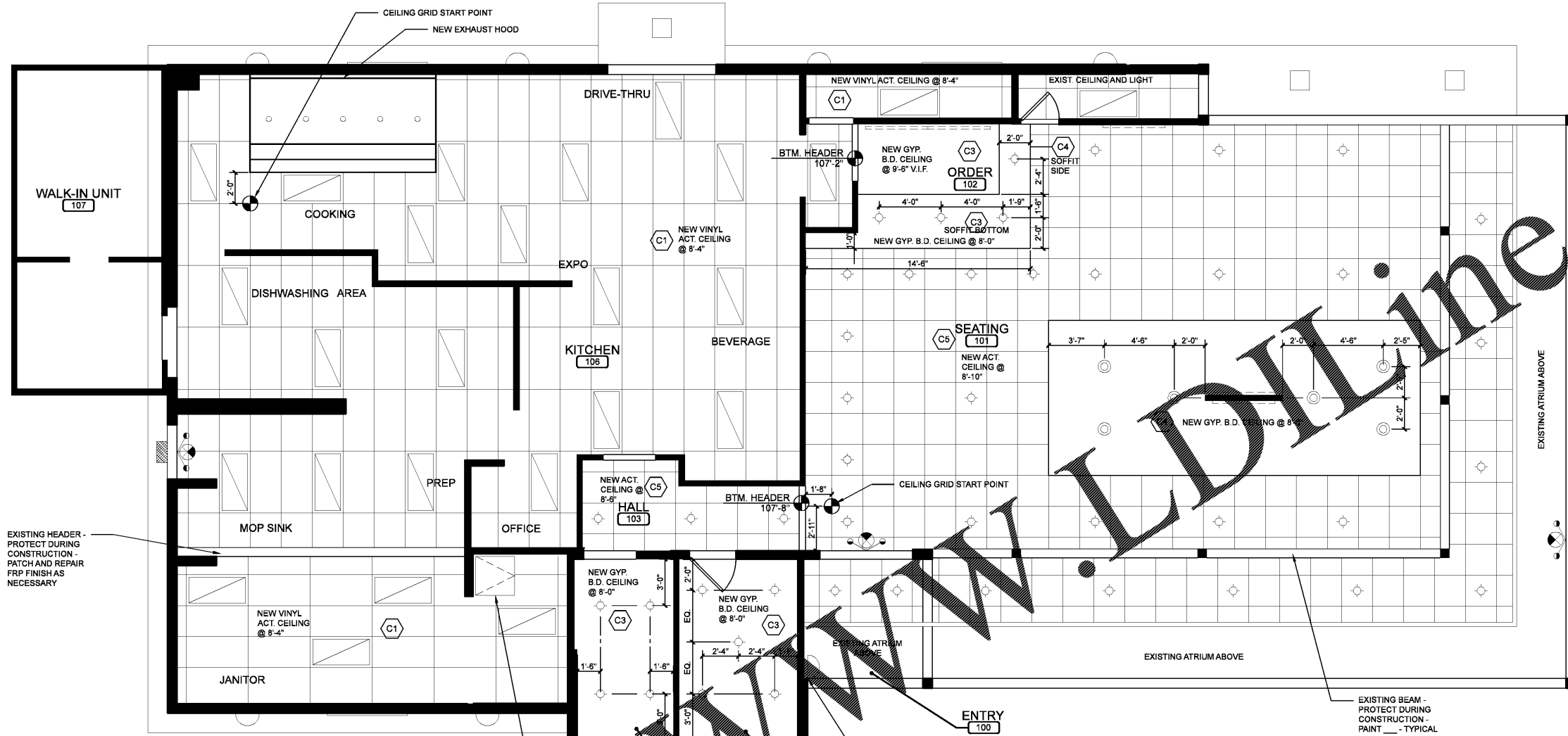

REFLECTED CEILING PLAN  
1/4" = 1'-0"

CEILING PLAN FINISH SCHEDULE

SYMBOL	NOT USED	DESCRIPTION	MANUFACTURER	MODEL NUMBER	REMARKS
C1		2'-0" X 4'-0" VINYL-FACED GYPSUM, LAY-IN PANELS	USG	SHEETROCK, CLIMA PLUS, WHITE	MATCHING GRID
C3		GYPSUM BOARD - PAINT (RESTROOM & VESTIBULE)	SHERWIN WILLIAMS	SW#7008 EXTRA WHITE	SMOOTH, EGG-SHELL
C4		GYPSUM BOARD - PAINT (BULKHEAD) - STANDARD SCHEME	SHERWIN WILLIAMS	SW#6888 REAL RED	SMOOTH, EGG-SHELL
C5		2'-0" X 2'-0" ACOUSTICAL LAY-IN PANELS	USG	FROST CLIMA PLUS, CHARCOAL #534	STANDARD MATCHING GRID

LIGHTING KEY



CONSULTANT:  
**WILKUS ARCHITECTS**  
15 North Avenue North, Hopkino, MN 55343  
Phone: 952.841.8600 www.wilcusarch.com

CLIENT:  
**SONIC**  
Associated Drive-Ins®  
JOHN COVE, LLC.  
7790 ABBEY OAKS COURT  
MANASSAS, VA 20112

PROJECT INFORMATION:  
**SONIC**  
SONIC DRIVE-IN RESTAURANT  
10850 PROMENADE LANE  
MANASSAS, VA 20109  
STORE #6711

SEAL:  
**MICHAEL J. WILKUS**  
Lic. No. 7582  
ARCHITECT  
MICHAEL J. WILKUS, ARCHITECT  
LICENSE NUMBER: 7582  
EXPIRATION DATE: 12-31-19  
07-27-18  
DATE

PROJECT NO.: 2018-0231  
DRAWN BY: J.A.K.  
CHECKED BY: M.J.W.

ISSUE: DATE:  
PERMIT SET 07-27-18

REVISION: DATE:

PROJECT LOCATION:  
MANASSAS, VA  
#6711

SHEET NUMBER / TITLE:  
**A2.02**  
REFLECTED CEILING PLAN