

Order Plans @ www.LDOnline.com

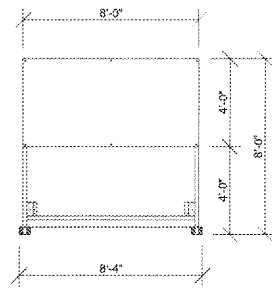

FRONT

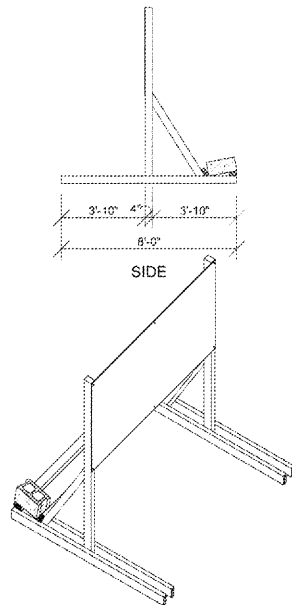

SIDE

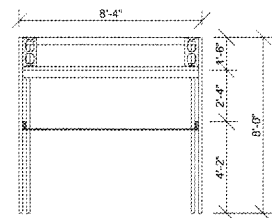

TOP

1 COMING SOON TEMPORARY CONSTRUCTION SIGN
SG1.2 SCALE: 1/4" = 1'-0"

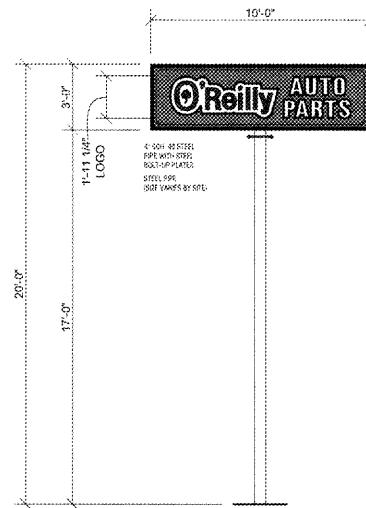

O'Reilly Canal Logo with "AP" channel letters on 7/16" x 1" (6) wireways. Wireways paint to: OAP RED
O'Reilly Canal Logo is formed polycarb with double embossment with 2nd surface painted graphics. Paint color to: Green (PMS 342C), Black and White.
AP to have formed polycarb caps with 1/4" letter "bump". Black 1" aluminum coil returns. 2nd surface Black and White paint. WHITE LED illumination.

2 GROUND SIGN ELEVATION
SG1.2 SCALE: 1/4" = 1'-0"

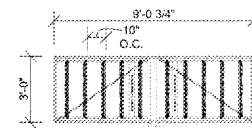

- Ⓐ 14-1/2" deep extruded cabinet with support structure and 2 1/4" retainers
- Ⓑ Internal 4" Sch. 40 steel pipe with external 14" x 14" x 1/2" steel bolt-up plates.
- Ⓒ GE-Tetra Power/Strip DS White LED's. Part #GEWHDSP56 (71000) 6 LED's per module (3 LED's per side) on GE-Tetra Mounting Rails. Part #GEOSRL66. Rails on 10" centers. 42 total modules.
- Ⓓ GE-Tetra Power Supplies. Part #GEPS24180U 24 Vol 90-305VAC 50/60 HZ Load capacity: 28 modules per power supply. Total of two (2) per display.
- Ⓔ Fabricated aluminum internal power supply wireway.

- Ⓐ Faces are formed out of lean with 2" draw. *O'Reilly* graphics are double embossed. *Auto Parts* copy is single embossed with painted graphics on 2nd surface. Graphics to match PMS 200c Red, PMS 342c Green Black and White.
- Ⓑ Extruded cabinet with 2 1/4" retainers. Internal 4" Sch. 40 steel pipe with external steel bolt-up plates.
- Ⓒ Vertical GE (SEWHDSP56) White DS LED illumination. Paint cabinet to: Gloss Black, internal pipe/cabinet exposure calculation: CB8
- Ⓓ Cabinet to be installed with 14" x 14" x 1/2" bolt-up plates. Paint to: Gloss Black

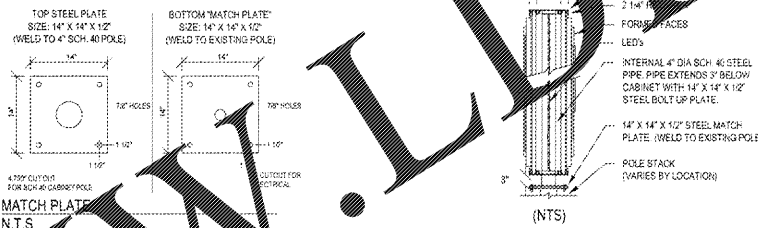

GENERAL NOTES

- Ⓐ REFER TO PROJECT MANUAL FOR ADDITIONAL REQUIREMENTS
- Ⓑ CONTACT OWNER'S OR TENANT'S DESIGNATED PROJECT ADMINISTRATOR FOR QUESTIONS OR CLARIFICATIONS.
- Ⓒ PERMANENT SIGNAGE OWNER FURNISHED AND INSTALLED. (REFER TO SCOPE OF WORK SCHEDULE). SIGNAGE GRAPHICS PROVIDED FOR REFERENCE ONLY (N.I.C.) AND CONTRACTOR'S OBLIGATION WITH SPECIFIC PROJECT CONSTRUCTION CONDITIONS.
- Ⓓ SITE SIGN FOUNDATIONS AND ROUGH-IN ELECTRICAL TO BE PROVIDED BY CONTRACTOR.
- Ⓔ REQUIRED GOVERNMENTAL PERMITS FOR PERMANENT SIGNAGE TO BE PROVIDED BY SIGN COMPANY PER OWNER'S DIRECTION (N.I.C.).
- Ⓕ *COMING SOON* TEMPORARY CONSTRUCTION SIGN TO BE PROVIDED BY GENERAL CONTRACTOR. APPLIED SIGNAGE GRAPHICS TO BE OWNER FURNISHED AND GENERAL CONTRACTOR INSTALLED. *TEMPORARY CONSTRUCTION SIGN ON SITE SO AS TO BE VISIBLE TO PUBLIC FROM RIGHT-OF-WAY.

SITE SIGN SCHEDULE

TEMPORARY CONSTRUCTION SIGN:
TYPE: COMING SOON
DETAIL: REFER TO 1/SG1.2

SITE SIGN:
TYPE: POLE (7'H X 21"W X 35" H.)
DETAIL: REFER TO 2/SG1.2

NOTE:
REFER TO SHEET SG1.3 FOR FOUNDATION SYSTEM STRUCTURAL REQUIREMENTS.



CRAIG A. SCHNEIDER, AIA
ARCHITECT

1736 East Sunshine, Suite 417
Springfield, Missouri 65804
417-862-8538
Fax: 417-862-3265
e-mail: architect@esteryschneider.com

PROJECT:
NEW O'REILLY AUTO PARTS STORE
NC STATE HWY 211
SEVEN LAKES, NC
SITE SIGNAGE DETAILS

O'Reilly AUTO PARTS
CORPORATE OFFICES
233 SOUTH PATTERSON
SPRINGFIELD, MISSOURI 65802
(417) 862-2674 TELEPHONE

COMM # 4155
DATE: 3-23-18
REVISION
DATE: