

INTERIOR FINISH SCHEDULE			
NO.	MATERIAL	DESCRIPTION	REMARKS (SUPPLIED/INSTALLED BY G.C., U.N.O.)
P-1	PAINT (WALLS)	BENJAMIN MOORE - 254, EGGSHELL FINISH	NOTE: SUPPLY SAMPLE FOR OWNER APPROVAL PRIOR TO APPLICATION. REFER TO PAINT NOTES BELOW.
P-2	PAINT (WALL ACCENT)	PAINT (P-2A): BENJAMIN MOORE - 258, EGGSHELL FINISH. COLOR: ACCORD SQUASH. PAINT (P-2B): BENJAMIN MOORE, EGGSHELL FINISH. COLOR: #1010 NORTH CREEK BROWN. PAINT (P-2C): BENJAMIN MOORE, EGGSHELL FINISH. COLOR: #1010 NORTH CREEK BROWN.	NOTE: SUPPLY SAMPLE FOR OWNER APPROVAL PRIOR TO APPLICATION. REFER TO PAINT NOTES BELOW.
P-3	PAINT (WOOD OR METALS)	BENJAMIN MOORE - AURA P 2114-10. COLOR: INTERMEDIATE CHOCOLATE. FINISH: WOOD-SATIN. METAL: SEMI-GLOSS.	NOTE: SUPPLY SAMPLE FOR OWNER APPROVAL PRIOR TO APPLICATION. REFER TO PAINT NOTES BELOW.
P-4	PAINT (CEILING)	BENJAMIN MOORE, EGGSHELL FINISH. COLOR: #1010 NORTH CREEK BROWN.	NOTE: SUPPLY SAMPLE FOR OWNER APPROVAL PRIOR TO APPLICATION. REFER TO PAINT NOTES BELOW.
P-5	PAINT (CEILING)	BENJAMIN MOORE, EGGSHELL FINISH. COLOR: #9C-28 MONROE BGDUE.	NOTE: SUPPLY SAMPLE FOR OWNER APPROVAL PRIOR TO APPLICATION. REFER TO PAINT NOTES BELOW.
P-6	PAINT (TRIMMING)	PITTSBURGH PAINTS BREAK-THROUGH 250, SATIN UD BASE. COLOR: FRENCH TOAST. #PPG15-54.	NOTE: SUPPLY SAMPLE FOR OWNER APPROVAL PRIOR TO APPLICATION. REFER TO PAINT NOTES BELOW.
11F	SOLID SURFACE	1 1/2\"/>	
120	F-1	SPECIALTY TILE BY RANGEO - 8\"/>	
121	NOT USED		
122	NOT USED		
123	NOT USED		
124	WALK OFF MAT	PANOL ACCORWAYE-PATTERNED LOOP PILE CARPET. 24\"/>	
125	CARPET TILE	ISLAND CARPET. NAME: 501 SOUND OFF. DIMENSIONS: 30\"/>	
126	BOARDING	MASLAND M... 1/4\"/>	
127	RODEC-STEP	RODEC-STEP R8130AG839. FINISH: BRIGHT COPPER / BRONZE ANODIZED.	FURNISHED & INSTALLED BY G.C.
128	STRIP	STRIP. NAME: 501 SOUND OFF. DIMENSIONS: 30\"/>	
129	STRIP	STRIP. NAME: 501 SOUND OFF. DIMENSIONS: 30\"/>	
130	STRIP	STRIP. NAME: 501 SOUND OFF. DIMENSIONS: 30\"/>	
131	H.P. LAMINATE	FORMICA #7481-58 NATURAL BRCH.	MILLWORK LAMINATE. CUSTOM TRILLS.
132	H.P. LAMINATE	WILSONART #73436-07 COLUMBIAN WADDER.	MILLWORK LAMINATE.
WT-1	SOLAR SHADES	WINDOW INTERIORS - SOLAR SHADES. FINISH: HEAVY - FINER 2390. CUSTOR. 5% OPENNESS.	PROVIDED BY MILLWORK. WINDOW & INSTALLED BY GENERAL CONTRACTOR.
WT-2	CUSTOM TRIM	2\"/>	
WT-3	NOT USED		

**INTERIOR PAINT SPECIFICATIONS:**  
 UNLESS OTHERWISE NOTED, BENJAMIN MOORE PAINT SHALL BE USED ON ALL WALL SURFACES THAT ARE CURRENTLY PAINTED. CALL 1-800-236-6667 FOR LOCAL BEN MOORE DISTRIBUTOR INFORMATION. PAINT ORDER LINE: 877-693-8484. CONTACT NAME: AURA HODGES AT 4694 94A-111 E. SOUTH HIGHLAND BLVD. CHICKASAW, OKLA. 73009. CONTRACTOR SHOULD MENTION THAT PRODUCTS ARE BEING PURCHASED TO PAINT AN OLIVE GARDEN RESTAURANT IN OKLAHOMA TO RECEIVE A NATIONAL DISCOUNT.  
 FOR ALL GLAZED FINISH WALLS: PRIME ALL SURFACES WITH 1 COAT AURA MATE PAINT PRIOR TO APPLYING 2 COATS OF AURA PAINT PRODUCTS.  
 FOR ALL OTHER WALLS, APPLY 2 COATS OF AURA PAINT PRODUCTS.  
 PLASTIC CORNER GUARDS & OTHER SIMILAR SURFACES - PRIME WITH XIM PRODUCTS FLASH BOND PRIMER #400.

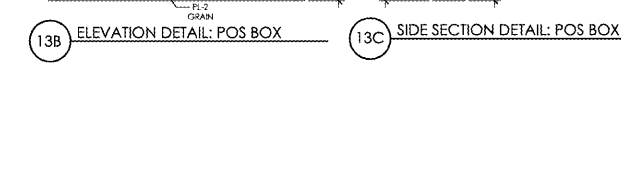
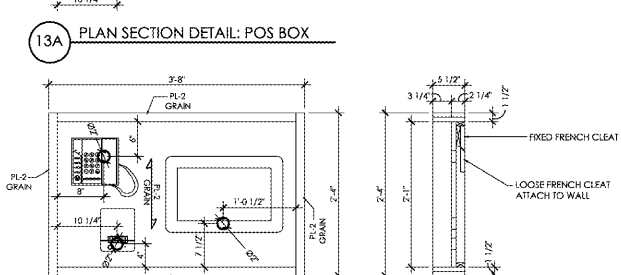
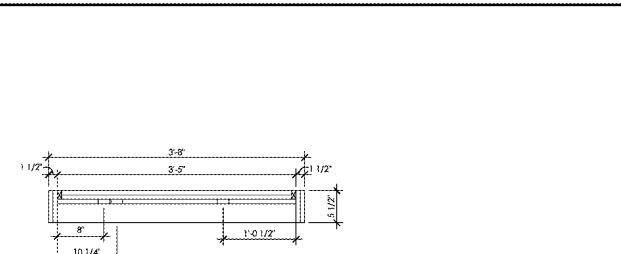

**Oliver Garden**  
 ITALIAN RESTAURANT

Issue Date: 04-19-2018

REVISION INFORMATION

1	
2	
3	
4	
5	
6	
7	
8	

Restaurant #: 1343

P1B (MEDIUM)  
 2782 WILMA RUODOLPH BLVD.  
 CLARKSVILLE, TN

Drawing  
**DETAILS/ FINISH SCHEDULE**  
**A8.1**