

PLOT DATE:

August 21 2018

No.	Description	Date

STORE NUMBER

1687

Tattersall Park

US 280 & Highway 19
Hoover
Shelby Co., AL

48.10

SIENNA LITE

PERMIT SET DATE 8/29/2018 11:32:44 AM

REFRIG. PIPING PLAN - DX LOOP (LOW TEMP)

1/8" = 1'-0"

R1.2

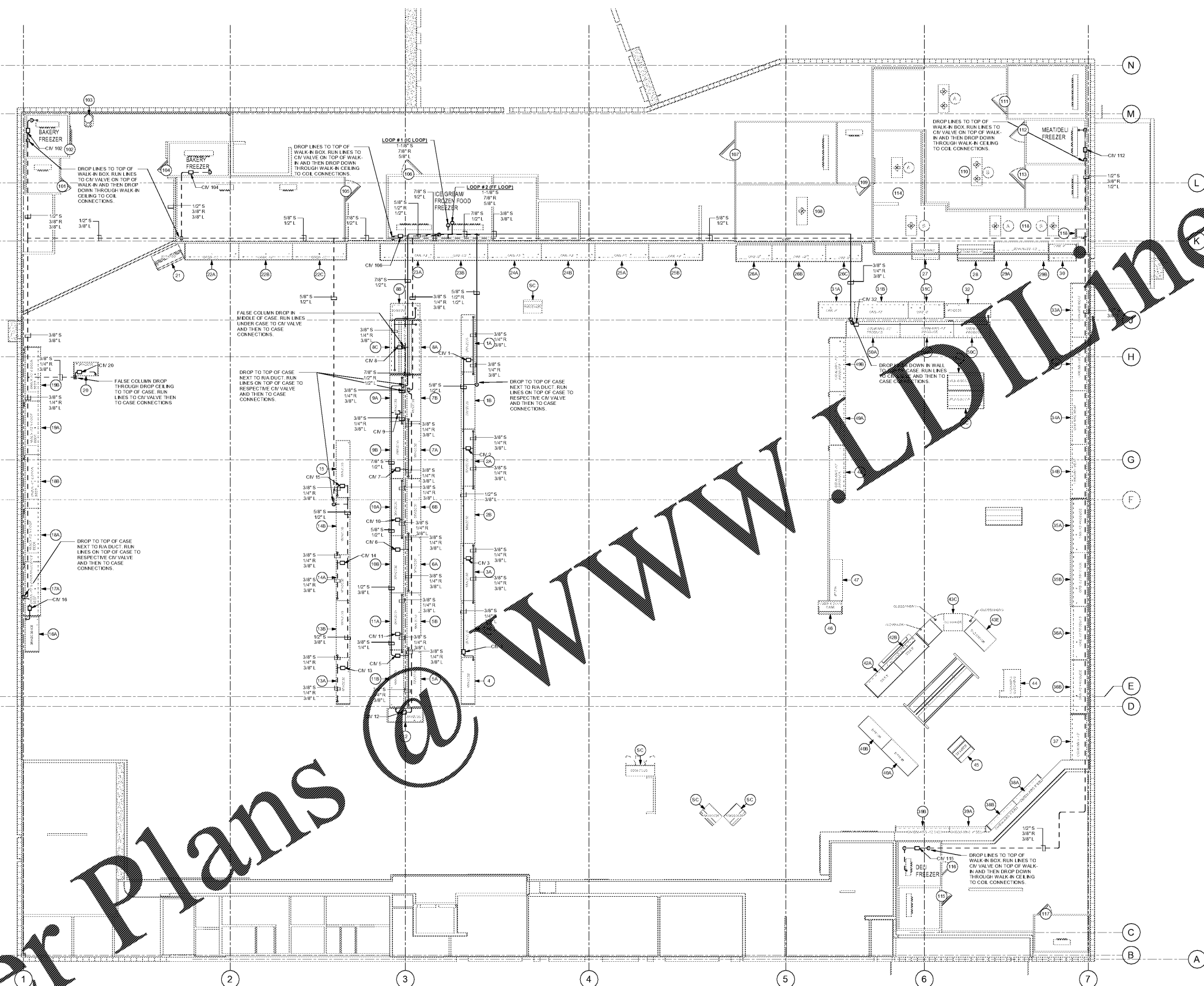

1 STANDARD MARKET - REFRIGERATION PIPING PLAN (LT)
SCALE: 1/8" = 1'-0"

CO₂ INSULATION TABLE

WIND CONDITIONS	NORMAL CONDITIONS	SEVERE CONDITIONS
50% DRY BULB 50% RH, 0 FPM	80° DRY BULB 70% RH, 0 FPM	90° DRY BULB 80% RH, 0 FPM
3/8"	1"	1 1/2"
1/2"	1"	1 1/2"
5/8"	1"	1 1/2"
7/8"	1"	1 1/2"
1 1/8"	1"	1 1/2"
1 3/8"	1"	1 1/2"
1 5/8"	1"	1 1/2"

- CONTRACTOR NOTES:**
- REFRIGERATION CONTRACTOR SHALL SET AND START ALL SELF-CONTAINED EQUIPMENT, INCLUDING ICE MACHINES. REFRIGERATION CONTRACTOR SHALL INSTALL ALL PROBES AND FREEZERS. PROBES ARE FURNISHED BY PUBLIX.
 - ALL WALK-IN COOLERS AND FREEZERS ARE FURNISHED BY PUBLIX AND INSTALLED BY THE MANUFACTURER. REFRIGERATION CONTRACTOR SHALL INSTALL AND PIPE ALL EVAPORATOR COILS AND HAND VALVES IN COOLERS AND FREEZERS.
 - FOR ALL OVERHEAD REFRIGERATION PIPING ABOVE THE SALES AREA, THE REFRIGERATION INSTALLATION CONTRACTOR SHALL PROVIDE AND INSTALL A DRAIN PAN AS PER TYPICAL DETAIL 71-R-3.1.
 - REFRIGERATION CONTRACTOR SHALL SET REFRIGERANT VALVES TO MAINTAIN 150° AT HEAT RECLAIM TANKS. CUT IN 142° F, CUT OUT AT 148° F. SET AUXILIARY ELEMENTS IN HEAT RECLAIM TANKS TO 130° F. HILL PHENIX SHALL SET ELEMENT IN ELECTRIC WATER HEATER TO 160° F.
 - REFRIGERATION CONTRACTOR SHALL MOUNT MANUFACTURER SUPPLIED OR SENSOR UNDERNEATH REFRIGERATION CONDENSER TO AVOID DIRECT CONTACT WITH SUNLIGHT. OR SENSOR AND WIRING PROVIDED BY MECHANICAL CENTER MANUFACTURER.
 - REFRIGERATION CONTRACTOR TO COORDINATE REFRIGERATION PIPING WITH DUCTWORK INSTALLER. REFRIGERATION CONTRACTOR AND PLUMBING CONTRACTOR SHALL ALSO COORDINATE REFRIGERATION DROPS AND VENT PIPES TO RUN BUNDLED TOGETHER.

- PIPING NOTES**
- ALL OVERHEAD REFRIGERATION PIPING AT BACKROOM NEEDS TO STAY A MINIMUM 3/4" OFF OF THE BACK WALL OF THE SALES LOOK AREA WHICH IS THE WALL BEHIND THE DAIRY LINE UP.
 - UTILIZE THE STACKING OF REFRIGERATION LINES WHERE SPACE IS LIMITED.
 - OVERHEAD REFRIGERATION PIPING TO BE HELD TIGHT TO THE BOTTOM OF THE JOISTS.

- AREAS OF HORIZONTAL RUNS BY TRADES**
- ELECTRICAL:** TOP OF STEEL GIRDER AND JOIST TO 32 IN. BELOW TOP OF STEEL WHERE EXPOSED IN PROTOTYPE. IMMEDIATELY BENEATH TOP OF JOIST MEMBER AND PASSING BETWEEN STEEL JOIST WEBS. THE INSTALLATION SHALL BE IN COMPLIANCE WITH NEC 300.4(E).
- REFRIGERATION:** 32 IN. TO 36 IN. BELOW ROOF DECK, EXPOSED IN PROTOTYPE. IMMEDIATELY BELOW BOTTOM CHORD OF STEEL JOIST GIRDERS AND JOISTS.
- FIRE SPRINKLER:** 8 IN. ABOVE CEILING, WHERE EXPOSED IN PROTOTYPE, 8 IN. ABOVE BOTTOM CHORD OF STEEL GIRDER JOISTS AND JOISTS.
- AIR CONDITIONING:** 36 IN. BELOW ROOF DECK TO 10 IN. ABOVE CEILING, WHERE EXPOSED IN PROTOTYPE, HANG AS CLOSE UNDER BOTTOM CHORD OF STEEL JOIST GIRDERS AND JOISTS AS POSSIBLE WHILE LEAVING ROOM FOR REFRIGERATION LINES.
- IF DEVIATION FROM THESE AREAS IS INDICATED, SUCH DEVIATION MUST BE AGREED UPON BY JOB SUPERINTENDENT AND PUBLIX REPRESENTATIVE.

- LEGEND**
- LT LOOP #1 - ICE CREAM LOOP (25°)
 - LT LOOP #2 - FROZEN FOOD LOOP (7°)
 - CM (CIRCUIT ISOLATION VALVE) SEE DETAIL 1CM-R-3.3
 - REFRIGERATION SYSTEM NUMBER
 - SELF-CONTAINED CASE
 - FALSE COLUMN DROP

Order Plans

WWW.LDLINE.COM