

**PUBLIX FACILITIES
DESIGN DEPARTMENT**

- DAVID M. BEE, PE
ARCHITECT FL REG. 11577
GA REG. 11577
AL REG. 6234
TN REG. 103497
VA REG. 12432
IA REG. 8401817097
- JOHN W. KITCHENS, PE
CIVIL/STRUCTURAL FL REG. 45277
GA REG. 50251
SC REG. 16340
TN REG. 26582
TN REG. 101507
- PAUL C. HARMAN, PE
STRUCTURAL FL REG. 51909
GA REG. 27740
SC REG. 21754
AL REG. 24905
TN REG. 101962
NC REG. 39873
VA REG. 040205922
- JOHN J. CARAMALIS, PE
MECHANICAL FL REG. 43889
GA REG. 621248
SC REG. 16221
TN REG. 106507
VA REG. 0402055478
- ANTHONY CLEMENTI, PE
MECHANICAL FL REG. 54781
GA REG. 31862
SC REG. 25591
AL REG. 28489
TN REG. 111362
NC REG. 039064
VA REG. 040205937
- RAYMOND J. SIRIANNI, PE
ELECTRICAL FL REG. 54085
GA REG. 620508
SC REG. 19743
AL REG. 23905
TN REG. 108038
NC REG. 039963
VA REG. 040205379

© COPYRIGHT 2018
PUBLIX SUPER MARKETS, INC.
THESE CONSTRUCTION DOCUMENTS ARE THE
PROPERTY OF PUBLIX SUPER MARKETS, INC. AND
ARE NOT TO BE COPIED OR REPRODUCED FOR ANY
SPECIFIC BUILDING WITHOUT WRITTEN PERMISSION.
THESE DRAWINGS SHALL NOT BE DISSEMINATED
WITHOUT PRIOR WRITTEN PERMISSION OF PUBLIX
SUPER MARKETS, INC.

THE DESIGN INDICATED IN THESE CONSTRUCTION
DOCUMENTS DOES TO THE BEST OF MY
KNOWLEDGE, INFORMATION, AND BELIEF, COMPLY
WITH THE APPLICABLE MINIMUM BUILDING CODES

PLOT DATE:
August 21 2018

No.	Description	Date

STORE NUMBER
1687
Tattersall Park
US 280 & Highway 19
Hoover
Shelby Co., AL

48.10
VIENNA LITE

ELECTRICAL
TRACK
LIGHTING
AIMING GUIDE

1/8" = 1'-0"

E1.1b

PERMIT SET DATE: 8/29/2018 11:18:37 AM

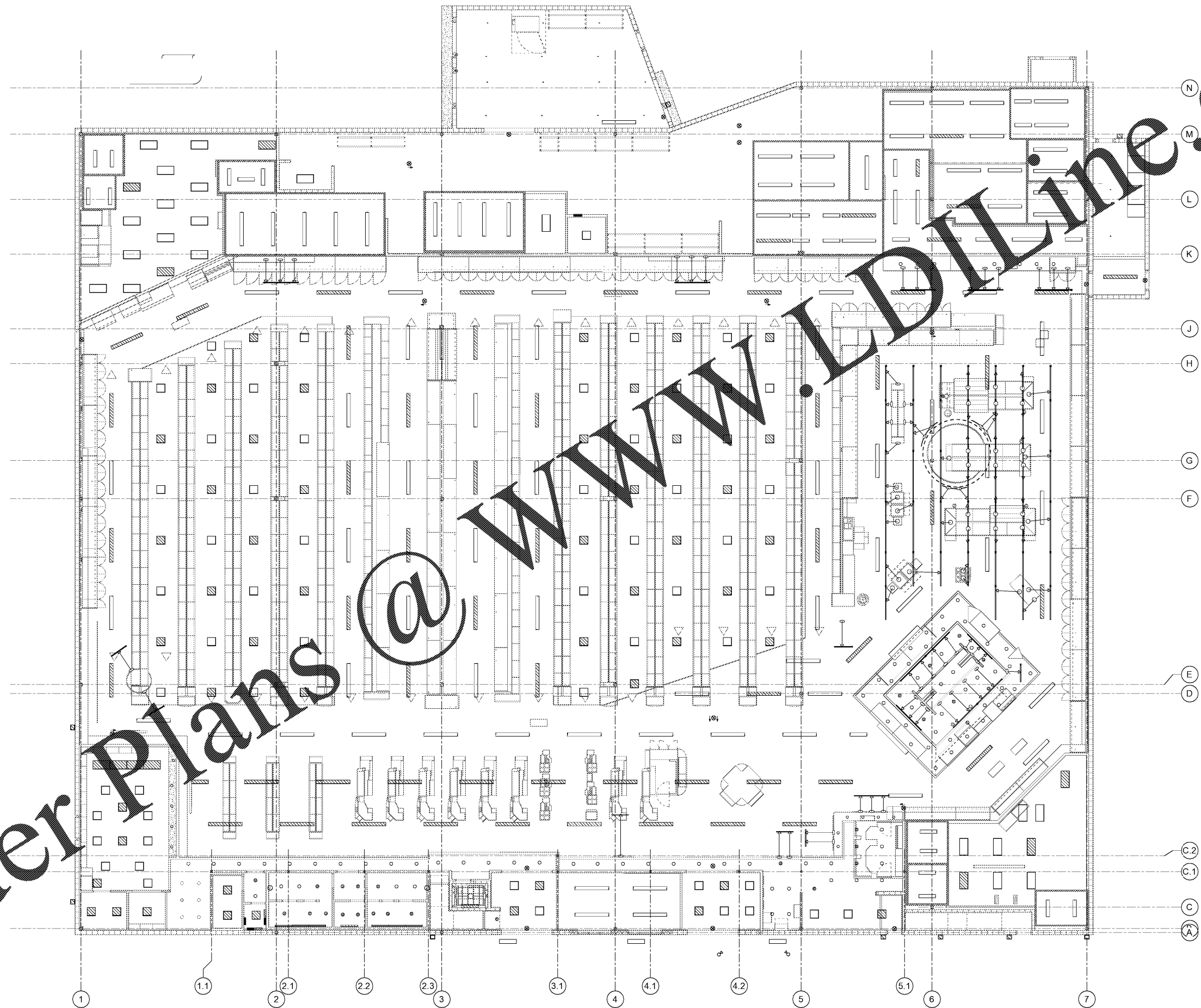

1 ELEC. FINISH FLOOR - RCP TRACK AIM
E1.1b
SCALE: 1/8" = 1'-0"

Order Plans @