

No.	Description	Date

STORE NUMBER
1687
Tattersall Park
US 280 & Highway 19
Floerwer
Shelby Co., AL
48.10
V1814.2018
SIENNA LITE

REFLECTED
CEILING PLAN

1/8" = 1'-0"

A3.1

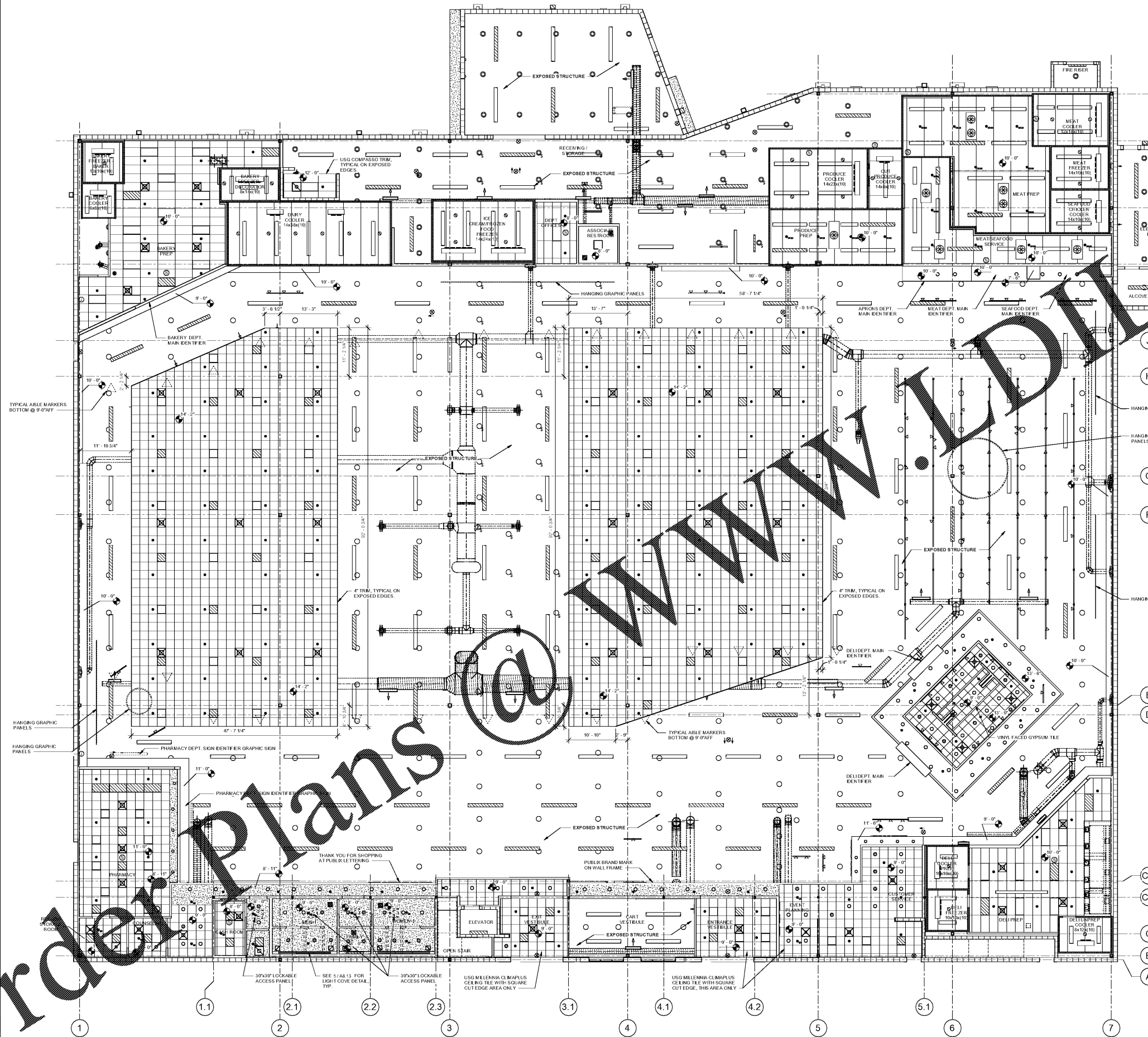

LEGEND

- (SS) SOUND TURE
- (S) SPEAKER (CEILING)
- (SC) SPEAKER (CEILING) w/ VOLUME CONTROL
- (V) VOLUME CONTROL (WALL MTD)
- (B) BAFFLE (12'-0" AFF, UNO)
- (BV) BAFFLE (12'-0" AFF, UNO) w/ VOLUME CONTROL
- (CB) COOLER BAFFLE
- (ELECTRICAL LIGHT FIXTURES)
- (EMERGENCY LIGHTING)
- (EXIT LIGHTS (DIRECTION AS INDICATED))
- (GYPSUM BOARD CEILING)
- (LAY-IN CEILING SYSTEM)
- (FIRE PROTECTION SPRINKLERS)
- (AC REGISTERS, GRILLES & DIFFUSERS)

DRAWING NOTES

1. ALL LAY-IN CEILING MUST BE INSTALLED PER BC LOCAL SEIMIC CATEGORY REQUIREMENTS.
2. ALL FOOD PREPARATION AREAS GET VINYL FACED CEILING TIE. SEE A2.1 FOR ROOM FINISH SCHEDULE.
3. REFER TO SOFFIT PLAN, AND/OR WALL SECTIONS FOR WALL HEIGHTS.

1 REFLECTED CEILING PLAN
A3.1 SCALE: 1/8" = 1'-0"