

TATTERSALL BOULEVARD  
TO BE BUILT BY OTHERS

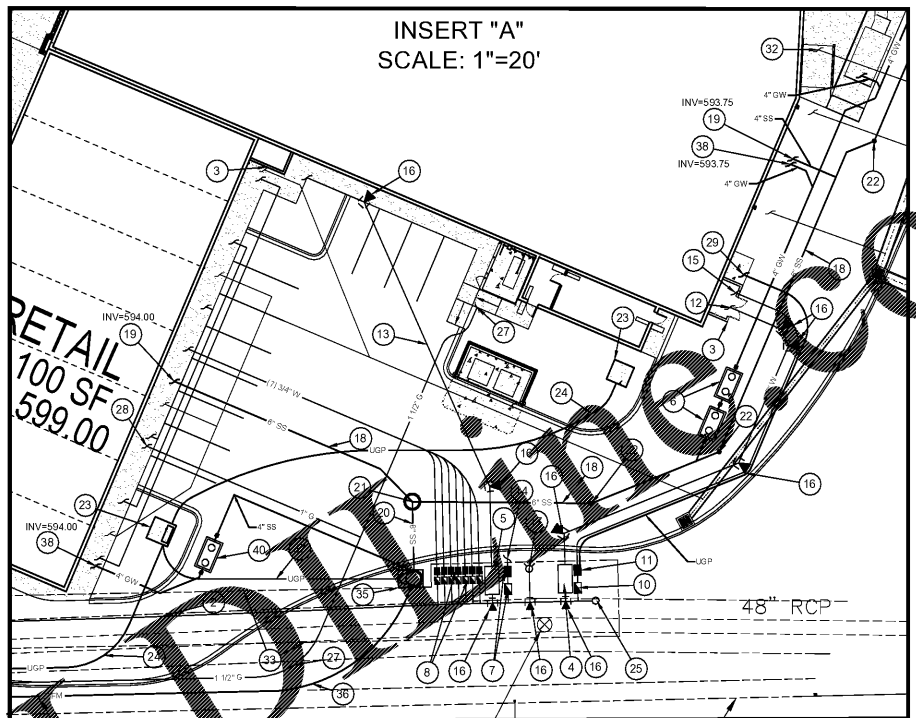
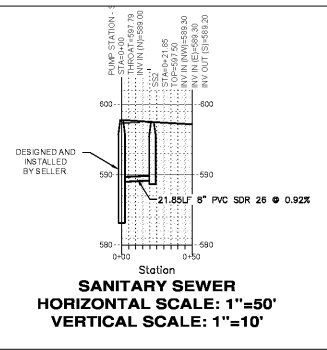
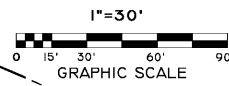

GROCERY STORE  
48.10 PROTOTYPE  
± 7.29 ACRES  
± 291 SPACES  
FFE: 599.00

PARCEL 1  
PORTION OF PARCEL  
03-9-32-0-001-006.000  
317,646 Sq. Feet  
7.29 Acres

RETAIL  
100 SF  
FFE: 599.00

**UTILITY LEGEND**

- 12" WATER MAIN PER SHELBY COUNTY WATER SERVICES SPECIFICATIONS
- 8" WATER MAIN PER SHELBY COUNTY WATER SERVICES STANDARDS
- BUILDING MOUNTED ELECTRICAL PLANS FOR ADDITIONAL DETAILS
- 8" FIRE SERVICE ASSEMBLY DETECTOR CHECK BACKFLOW PREVENTER ASSEMBLY IN VALVE ROOM PER SHELBY COUNTY WATER SERVICES STANDARDS
- 1" FIRE SERVICE ASSEMBLY DETECTOR CHECK BACKFLOW PREVENTER ASSEMBLY IN VALVE ROOM PER SHELBY COUNTY WATER SERVICES STANDARDS
- 2" FLOOR DRAIN GREASE TRAP WITH CLEANOUTS AND SAMPLING POINT RECD. SEE DETAIL
- IRRIGATION WATER METER WITH 100" BACKFLOW PREVENTER RECD. PER SHELBY COUNTY WATER SERVICES STANDARDS AND SECONDARY LOCKING VALVE REQUIRED PER SOUTHWEST WATER COMPANY
- 1.5" DOMESTIC WATER METER, BACKFLOW PREVENTER PER SHELBY COUNTY WATER SERVICES STANDARDS AND SECONDARY LOCKING VALVE REQUIRED PER SOUTHWEST WATER COMPANY. CONTRACTOR SHALL COORDINATE WITH SHELBY COUNTY WATER SERVICES
- GATE VALVE RECD.
- 1" DOWN TO WATER METER IN TRAFFIC TYPE METER BOX BY WATER COMPANY AND SECONDARY LOCKING VALVE REQUIRED PER SOUTHWEST WATER COMPANY
- 2 1/2" HPZ BACKFLOW PREVENTER RECD. PER WATER COMPANY SPECIFICATIONS
- SAFE-COOLER HEATED BACKFLOW PREVENTER ENCLOSURE RECD. CONTRACTOR SHALL PROVIDE CONDUIT AND ELECTRICAL TO HEATED COVER
- 8" FIRE PROTECTION WATER SERVICE RECD. SEE ARCHITECTURAL PLANS FOR CONTINUATION INTO BUILDING
- 8" FIRE PROTECTION WATER SERVICE RECD. SEE ARCHITECTURAL PLANS FOR CONTINUATION INTO BUILDING
- 2" HYDRANT ASSEMBLY RECD. PER WATER COMPANY SPECIFICATIONS. HYDRANT SHALL BE INSTALLED PER NFPA 24 AND PAINTED PER HOOPER FIRE REQUIREMENTS. SEE DETAIL
- 8" SANITARY SEWER LATERAL AT MINIMUM 1.0% SLOPE RECD. SEE PLAN FOR INVERT AT BUILDING
- 8" SANITARY SEWER LATERAL AT MINIMUM 2.0% SLOPE RECD. SEE PLAN FOR INVERT AT BUILDING
- 8" PVC SANITARY SEWER PIPE AT MINIMUM 0.5% SLOPE RECD.
- SANITARY SEWER MANHOLE RECD. SEE DETAIL
- CONCRETE TRANSFORMER PAD RECD. PER POWER COMPANY SPECIFICATIONS. CONTRACTOR SHALL VERIFY EXACT LOCATION AND SIZE WITH POWER COMPANY PRIOR TO INSTALLATION. CONTRACTOR SHALL BE RESPONSIBLE FOR INSTALLATION OF CONCRETE PAD, CONDUIT, AND PIPE BOLLARDS AS REQUIRED BY POWER COMPANY. CONTRACTOR SHALL COORDINATE S&D WORK WITH POWER COMPANY.
- 2" TOPS OF EXISTING MANHOLES SHALL BE RAISED OR LOWERED AS NECESSARY TO BE FLUSH WITH PROPOSED PAVEMENT ELEVATIONS, AND TO BE ONE FOOT ABOVE FINISHED GROUND ELEVATIONS WITH WATER SERVICE LINES
- ALL CONCRETE FOR ENCASEMENTS SHALL HAVE A MINIMUM 28-DAY COMPRESSION STRENGTH THAT EXCEEDS 3000 PSI
- EXISTING UTILITIES SHALL BE VERIFIED IN FIELD PRIOR TO INSTALLATION OF ANY NEW LINES
- REFER TO INTERIOR PLUMBING DRAWINGS FOR TRENCHING OF ALL UTILITIES
- CONTRACTOR IS RESPONSIBLE FOR COMPLYING TO THE SPECIFICATIONS OF THE LOCAL AUTHORITIES WITH REGARD TO MATERIALS AND INSTALLATION OF THE WATER AND SEWER LINES
- THE CONTRACTOR'S SPECIALTY CONTRACTOR IS CAUTIONED THAT THE LOCATION AND ELEVATION OF EXISTING UTILITIES AS SHOWN ON THESE PLANS IS BASED ON RECORDS OF THE VARIOUS UTILITY COMPANIES AND WHEREAS THE CONTRACTOR IS CAUTIONED THAT THE INFORMATION IS NOT TO BE RELIED ON AS BEING EXACT OR COMPLETE. THE CONTRACTOR MUST CALL THE APPROPRIATE UTILITY COMPANIES AT LEAST 72 HOURS BEFORE ANY EXCAVATION TO LOCATE EXACT FIELD LOCATION OF UTILITIES. IT SHALL BE THE RESPONSIBILITY OF THE CONTRACTOR TO RELOCATE ALL EXISTING UTILITIES WHICH CONFLICT WITH THE PROPOSED IMPROVEMENTS SHOWN ON THE PLANS
- CONTRACTOR IS RESPONSIBLE FOR ALL NECESSARY INSPECTIONS AND/OR CERTIFICATIONS REQUIRED BY CODES AND/OR UTILITY SERVICE COMPANIES. THIS AND THE FINAL CONNECTIONS OF THE SERVICE SHALL BE COMPLETED 30 DAYS PRIOR TO STORE POSSESSION
- CONTRACTOR SHALL COORDINATE WITH ALL UTILITY COMPANIES FOR INSTALLATION REQUIREMENTS AND SPECIFICATIONS
- REFER TO BUILDING PLANS FOR SITE LIGHTING ELECTRICAL PLAN
- ALL VALVES CONTROLLING THE WATER SUPPLY FOR AUTOMATIC SPRINKLER SYSTEMS, PUMPS,

**UTILITY NOTES**

1. ALL FILL MATERIAL IS TO BE IN PLACE AND COMPACTED BEFORE INSTALLATION OF PROPOSED UTILITIES
- CONTRACTOR SHALL NOTIFY THE UTILITY AUTHORITIES INSPECTORS 72 HOURS BEFORE CONNECTING TO ANY EXISTING LINE
- SANITARY SEWER SHALL BE AS FOLLOWS:
  - 3.1 8" MAIN SHALL BE PVC SDR 26 PVC PIPE
  - 3.2 4" MAIN SHALL BE PVC SDR 26 PVC PIPE
  - 3.3 2" MAIN SHALL BE PVC SDR 26 PVC PIPE
- WATER LINES SHALL BE AS FOLLOWS PER SHELBY COUNTY WATER SERVICES STANDARDS
- MINIMUM TRENCH WIDTH SHALL BE 2 FEET
- ALL WATER LINES SHALL BE PER SHELBY COUNTY WATER SERVICES SPECIFICATIONS
- ALL UTILITIES SHOULD BE KEPT TEN FEET (10') APART (SMALLEST) WHEN CROSSING. 18" VERTICAL CLEARANCE (OUTSIDE EDGE OF PIPE TO OUTSIDE EDGE OF PIPE)
- CONTRACTOR SHALL MAINTAIN COVER ON ALL WATER LINES PER SHELBY COUNTY WATER SERVICES SPECIFICATIONS
- CONTRACTOR SHALL MAINTAIN A MINIMUM OF 3" COVER ON ALL SANITARY SEWER LINES
- IN THE EVENT OF A VERTICAL CONFLICT BETWEEN WATER LINES, SANITARY LINES, STORM LINES, AND GAS LINES EXISTING AND PROPOSED, THE SANITARY LINE SHALL BE DUCTILE IRON PIPE WITH MECHANICAL JOINTS AT LEAST 10 FEET ON BOTH SIDES OF CROSSING, THE WATER LINE SHALL HAVE MECHANICAL JOINTS WITH APPROPRIATE THURST BLOCKING AS REQUIRED TO PROVIDE A MINIMUM OF 18" CLEARANCE, MEETING REQUIREMENTS OF ANSI A21.10 OR ANSI 21.1 (AWWA C-151) (CLASS 50)
11. LINES UNDERGROUND SHALL BE INSTALLED, INSPECTED, AND APPROVED BEFORE BACKFILLING.

**SHELBY COUNTY WATER SERVICES NOTES**

- Water main construction shall be in accordance with Shelby County regulations and practices
- Nately Shans Lovell or Robert Barban with Shelby County Water Services (205-670-6543) 48 hours in advance of beginning water main construction or when returning to work following a break in construction activities or water main test days
- All water pipe shall be ductile iron, minimum class 350 in accordance with AWWA Standards, and 8" minimum diameter unless noted otherwise. All fittings and valves shall be restrained joint with either Mega-Lug or One-Bolt type manholes
- All carrier pipe used in casing shall be restrained joint pipe. Restraint gaskets (Field-Lok-Fit-Grip) shall not be used for this type of installation. Pipe shall be equivalent to "Flex-Ring" pipe as manufactured by American Cast Iron Pipe Company or "FR Flex" pipe as manufactured by US Pipe and Foundry Company
- Restrainted joint pipe and fittings are required in all areas unless approved otherwise by Shelby County. Restrainted (Field-Lok-Fit-Grip) gaskets may be used for this installation. No pipe shall be laid in 5' without consulting with Shelby County Water Services
- Three-way and 4-way wyeing is required at each pipe intersection
- Where water mains cross other utilities, either over or under, the trench shall be completely backfilled with compacted ALDOT #5910
- In accordance with Alabama Department of Environmental Management (ADEM) regulations, there shall be a minimum 5' horizontal separation between water mains and sewer lines. There shall also be a minimum 1' vertical separation between water mains and other utilities. Sewer lines must be installed below water mains, especially sewer transformers
- Mega-Lug or One-Bolt type gaskets are required on fittings in all areas around out-die-ast
- Tapping sleeves for 4" tops and larger shall be a full body, cast-iron or ductile iron sleeves as manufactured by Tyler Union or Mueller. Tapping sleeves used to tap 24" Ductile Iron water mains and larger may be JCM Model #414 Fabricated Mechanical Joint Tapping Sleeve. Gaskets used between the flange joints shall be full faced, red rubber gaskets
- For all taps 2" in diameter to 12" in diameter, the Contractor shall be responsible for all excavation and backfill work area for tap. Excavation size shall be determined by Shelby County Water Services. Contractor shall install and test the tapping sleeve prior to the tap being performed. Shelby County shall tap the water main. Contractor shall be responsible for all taps larger than 12"
- A 1" copper service in a 2" PVC casing shall be installed for each long side water service. The PVC casing shall extend two feet outside of the curb. After the water main has been tested and with the approval of Shelby County Water Services, the contractor shall make all taps as shown on drawings. The contractor shall show all taps to the inspecting Shelby County prior to backfill.
- A standard Shelby County 2 inch foot valve assembly is required at the end of each dead end line
- All ties to an existing PVC water main shall have MJ Sleeves as the last fitting used to transition between PVC and Ductile Iron Pipe
- There shall be no sidewalks installed within the areas shown on these plans unless they are specifically shown
- All Built Drawings are required. No water service from Shelby County water will be permitted until complete As-Built drawings are received and approved by Shelby County. Drawings shall show all connections to the system, storm sewer locations, streets, lot lines, all dimensions, grades, elevations, and other utilities such as gas, electrical, telephone, sewer and all other pertinent information on an appropriate scale. Built drawings shall be sealed by a registered engineer and shall contain the following statement:  
"I, the undersigned professional engineer in the State of Alabama certify that I have personally examined and am familiar with the information submitted on this drawing and based on my inquiry of those individuals directly responsible for obtaining the information, I believe the information is true, accurate, and complete. Signed \_\_\_\_\_ PE No. \_\_\_\_\_"
- The Developer shall provide a complete design and construction cost summary of the water facilities installed prior to and as a condition of acceptance by Shelby County
- Easements for Shelby County water lines, if not previously dedicated, are hereby dedicated exclusively to Shelby County, its successors and assigns for construction and access in the installation, operation, replacement, and maintenance of water lines and their appurtenances
- Plans are approved for a period of 180 days, plans are void and new plans must be submitted and approved. If there are any variations after approval, plans shall be resubmitted to the Shelby County Water Services
- An 18" diameter wet-trench concrete pipe (min. 4" thick) shall be placed around all valve boxes in non-paved areas
- For any new meter (including irrigation meters) required in common areas, the Developer will be responsible for installing the tap and water service lines. Shelby County Water Services will install the meter after the tap and water service lines have been provided

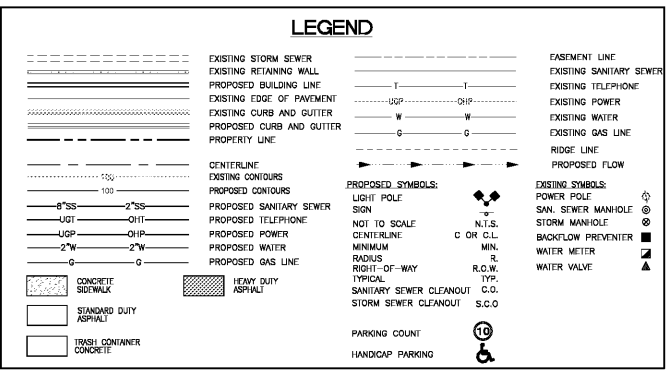

Order Plans  
811

Know what's below  
Call before you dig

NO.	REVISION	DESCRIPTION
1	ISSUED FOR APPROVAL	
2	CITY COMMENT	
3	PUBLIC COMMENTS	

**SITE UTILITY PLAN**  
GROCERY STORE & SHOPS AT TATTERSALL PARK  
TATTERSALL PARK  
BOULEVARD  
GREYSTONE WAY, LLC  
CREATED BY: CLAYTON/ATL  
SCALE: SEE PLANS  
DRAWN BY: A. WILSON  
DATE:

**GONZALEZ & ASSOCIATES, INC.**  
CIVIL ENGINEERING, LAND SURVEYING, PLANNING, TRAFFIC & TRANSPORTATION  
5176 PARKWAY LAKE DRIVE  
TALLAHASSEE, FL 32310  
PHONE: (904) 942-2484  
FAX: (904) 942-3033  
www.Gonzalez-Strength.com  
© Copyright 2016



DWG NO. CB-R2  
PROJECT 17WHDD02