



SHEET NOTES

- A. FOR EQUIPMENT TO BE DEMOLISHED, DISCONNECT POWER AND REMOVE ALL ASSOCIATED ELECTRICAL EQUIPMENT (INCLUDING SEPARATELY ENCLOSED STARTERS, SEPARATELY ENCLOSED BREAKERS, DISCONNECT SWITCHES, CONTROLLERS, GUTTERS, AND OUTLETS) WIRING BACK TO SOURCE PANEL. EXISTING ASSOCIATED BREAKERS IN PANELS SHALL BE RELAYED TO PANEL.
1. DISCONNECT POWER TO BOILER AND DEMO ALL ASSOCIATED ELECTRICAL EQUIPMENT. CONDUIT AND WIRING BACK TO SOURCE PANEL.
2. DISCONNECT POWER TO CONTROL PANEL AND DEMO ALL ASSOCIATED ELECTRICAL EQUIPMENT. CONDUIT AND WIRING BACK TO SOURCE PANEL.
3. DISCONNECT POWER TO OIL PUMPS SYSTEM AND DEMO ALL ASSOCIATED ELECTRICAL EQUIPMENT, CONDUITS AND WIRING BACK TO SOURCE PANEL.
4. DISCONNECT POWER TO WATER TREATMENT SYSTEM AND DEMO ALL ASSOCIATED ELECTRICAL EQUIPMENT, CONDUIT AND WIRING BACK TO SOURCE PANEL.
5. DISCONNECT POWER TO BOILER FEED PUMP AND DEMO ALL ASSOCIATED ELECTRICAL EQUIPMENT. CONDUIT AND WIRING BACK TO SOURCE PANEL. CONDENSATE TRANSFER PUMPS WILL BE REPLACED. DISCONNECT POWER. EXTEND CONDUIT AND WIRING AS NECESSARY TO RECONNECT NEW PUMPS TO EXISTING CIRCUIT.
7. APPROXIMATE LOCATION OF EXISTING PANEL NP-1A (SOURCE OF P-10 AND P-17).
8. APPROXIMATE LOCATION OF EXISTING PANEL PBOCC (SOURCE OF P-9, P-11, P-20, 21, P-16, AND P-19).
9. CONDENSATE TRANSFER PUMP MOTOR STARTERS. REMOVE EXISTING OVERLOAD HEATERS IN ASSOCIATED MOTOR STARTERS AND REPLACE WITH NEW. DEMO BOILER FEED PUMP MOTOR STARTERS.

SHEET NOTES

1. DISCONNECT POWER TO BOILER AND DEMO ALL ASSOCIATED ELECTRICAL EQUIPMENT. CONDUIT AND WIRING BACK TO SOURCE PANEL.
2. DISCONNECT POWER TO CONTROL PANEL AND DEMO ALL ASSOCIATED ELECTRICAL EQUIPMENT. CONDUIT AND WIRING BACK TO SOURCE PANEL.
3. DISCONNECT POWER TO OIL PUMPS SYSTEM AND DEMO ALL ASSOCIATED ELECTRICAL EQUIPMENT, CONDUITS AND WIRING BACK TO SOURCE PANEL.
4. DISCONNECT POWER TO WATER TREATMENT SYSTEM AND DEMO ALL ASSOCIATED ELECTRICAL EQUIPMENT, CONDUIT AND WIRING BACK TO SOURCE PANEL.
5. DISCONNECT POWER TO BOILER FEED PUMP AND DEMO ALL ASSOCIATED ELECTRICAL EQUIPMENT. CONDUIT AND WIRING BACK TO SOURCE PANEL. CONDENSATE TRANSFER PUMPS WILL BE REPLACED. DISCONNECT POWER. EXTEND CONDUIT AND WIRING AS NECESSARY TO RECONNECT NEW PUMPS TO EXISTING CIRCUIT.
7. APPROXIMATE LOCATION OF EXISTING PANEL NP-1A (SOURCE OF P-10 AND P-17).
8. APPROXIMATE LOCATION OF EXISTING PANEL PBOCC (SOURCE OF P-9, P-11, P-20, 21, P-16, AND P-19).
9. CONDENSATE TRANSFER PUMP MOTOR STARTERS. REMOVE EXISTING OVERLOAD HEATERS IN ASSOCIATED MOTOR STARTERS AND REPLACE WITH NEW. DEMO BOILER FEED PUMP MOTOR STARTERS.

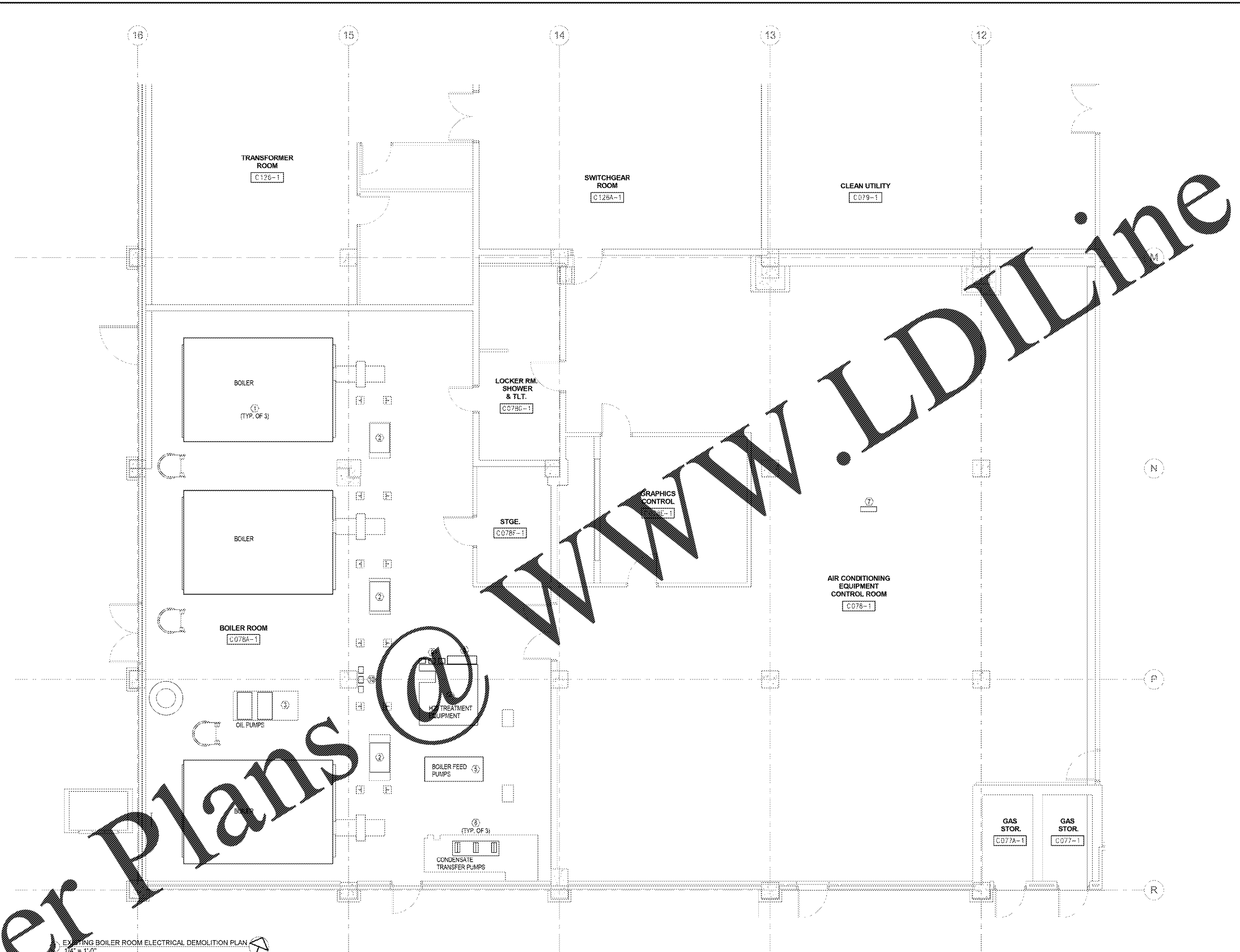

EXISTING BOILER ROOM ELECTRICAL DEMOLITION PLAN
1/4" = 1'-0"

FINAL DESIGN
APPROVED FOR CONSTRUCTION

Revisions: Date	CONSULTANTS:		ARCHITECT/ENGINEERS: AKEA INC. 3903 NW 98th Street, Suite B Gainesville, FL 32606 Phone: (352) 474-8124 Fax: (352) 553-4437 COA: FL #26683 AKEA Project No. 083-14		Drawing Title EXISTING BOILER ROOM DEMOLITION PLAN		Project Title REPLACE BOILERS - FCA D. ENERGY AT THE MALCOM RANDALL VAMC		Project Number 573-14-600		Office of Construction and Facilities Management Department of Veterans Affairs
	Approved: Project Director			Location GAINEVILLE, FLORIDA		Date MARCH 9, 2018		Checked CJF		Drawn KLL	
							Drawing Number ED101		102 OF 127		