

RECEIVED
APR 04 2008
MISSOURI STATE ARCHITECT

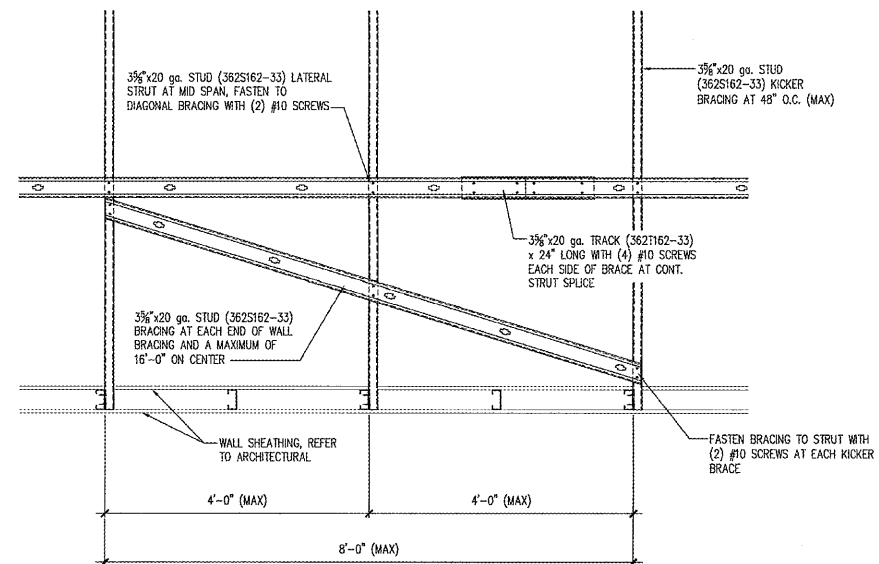

Order Plans

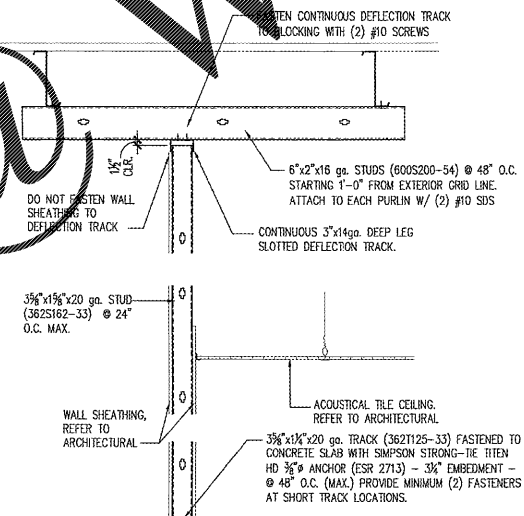
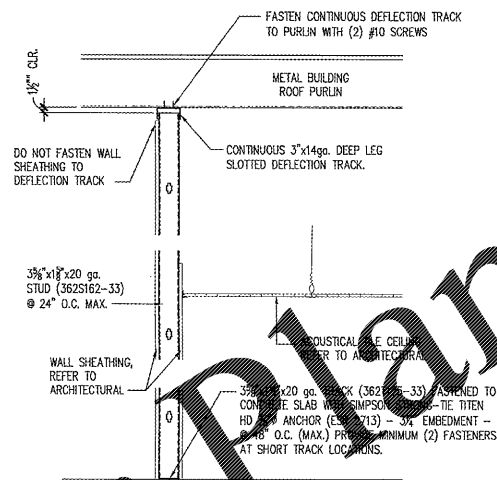
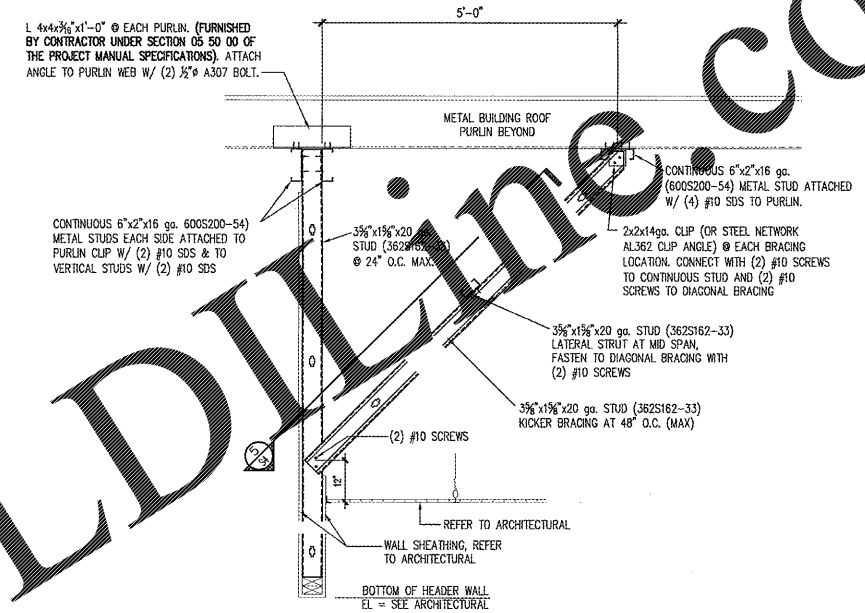
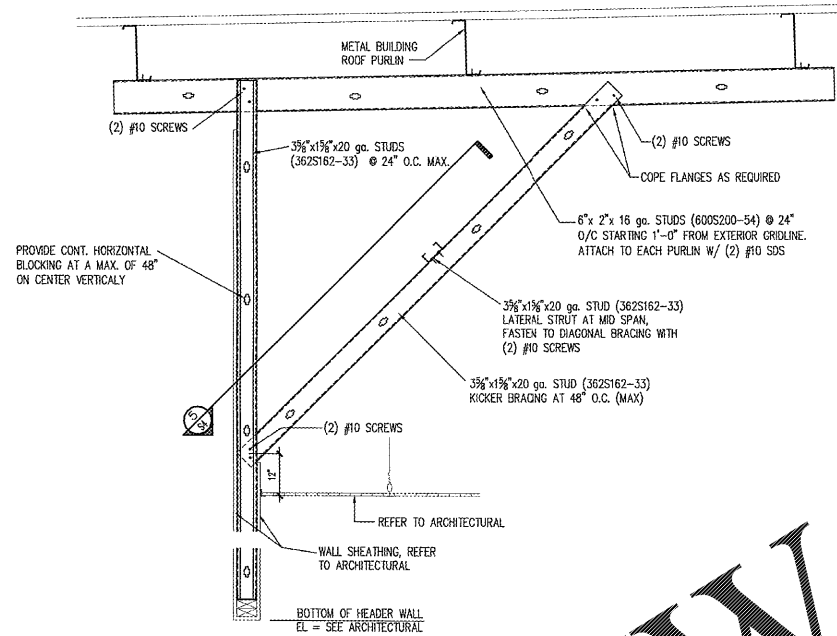
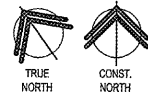
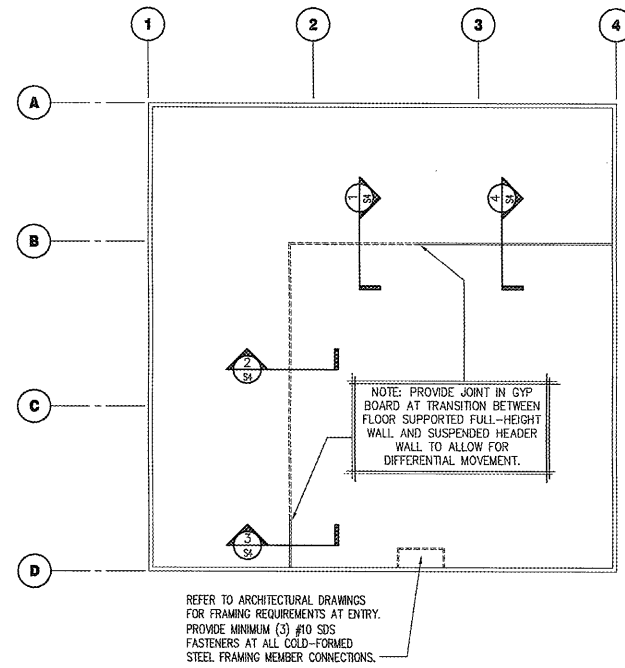

Craig A. Schneider, AIA
ARCHITECT
1736 East Sunshine, Suite 417
Springfield, Missouri 65804
Tel: 417.862.0558
Fax: 417.862.3265
e-mail: architect@esterjschneider.com

PROJECT:
NEW O'REILLY AUTO PARTS STORE
PRICEVILLE, AL
HWY 67
FRAMING DETAILS

O'Reilly AUTO PARTS
CORPORATE OFFICES
1000 N. W. 10TH ST.
SPRINGFIELD, MISSOURI 65802
(417) 862-2674 TELEPHONE

COMM # 4160
DATE: 4-6-18
REVISION
DATE:

JS Smith Consulting Engineers
Alabama State Certificate of Authorization CA-2283-E
Aaron D. Smith P.E. 24301
P.O. Box 8102 * JOPLIN, MISSOURI 64802
PHONE: 417-824-0444 * FAX: 417-824-0430