



**CRIG A. SCHNEIDER, AIA**  
 ARCHITECT  
 1736 East Sunshine, Suite 417  
 Springfield, Missouri 65804  
 417.862.0556  
 Fax: 417.862.3265  
 e-mail: architect@ostertschneider.com

PROJECT: **NEW O'REILLY AUTO PARTS STORE**  
**HWY 67**  
**PRICEVILLE, AL**  
**FOUNDATION PLAN**

**O'Reilly AUTO PARTS**  
 CORPORATE OFFICES  
 1101 N. GARDNER  
 SPRINGFIELD, MISSOURI 65802  
 (417) 862-2674 TELEPHONE

COMM # 4160  
 DATE: 4-6-18  
 REVISION  
 DATE:

**KEYNOTES**

- 1 SLAB HAIRPIN. SEE DETAIL 9/S3.1
- 2 PROVIDE #4x4'-0" DOWEL. TURN 45 DEGREES AT SLAB INSIDE CORNERS
- 3 CONTROL OR CONSTRUCTION JOINT SEE DETAILS 1 & 2/S2
- 4 SIDEWALK: PROVIDE 4" THICK CONCRETE REINFORCED W/ #3'S @ 18" O.C. EACH WAY (PLACED AT MID-HEIGHT OF SLAB) OVER COMPACTED SUB-BASE MATERIAL (AS DIRECTED BY THE GEOTECHNICAL REPORT OR ONSITE GEOTECHNICAL ENGINEER) PROPERLY PREPARED SUBGRADE. SEE CIVIL DRAWINGS FOR JOINT REQUIREMENTS, EXTENTS OF FLATWORK, AND TOP OF CONCRETE SPOT ELEVATIONS.
- 5 STEEL BOLLARD; SEE SITE DEVELOPMENT PLANS AND DETAILS. (WHERE APPLICABLE, ALIGN WITH CENTERLINE OF STOREFRONT MULLIONS AND JAMBS OF OVERHEAD DOOR.)
- 6 4'x4' (MIN.) DOORPAD: PROVIDE 4" THICK CONCRETE REINFORCED W/ #3'S @ 18" O.C. EACH WAY (PLACED AT MID-HEIGHT OF SLAB) OVER COMPACTED SUB-BASE MATERIAL (AS DIRECTED BY THE GEOTECHNICAL REPORT OR ONSITE GEOTECHNICAL ENGINEER) ON PROPERLY PREPARED SUBGRADE. CENTER PAD ON DOOR. SEE CIVIL DRAWINGS FOR TOP OF CONCRETE SPOT ELEVATIONS.
- 7 6" WIDE DOORPAD: PROVIDE 4" THICK CONCRETE REINFORCED W/ #3'S @ 18" O.C. EACH WAY (PLACED AT MID-HEIGHT OF SLAB) OVER COMPACTED SUB-BASE MATERIAL (AS DIRECTED BY THE GEOTECHNICAL REPORT OR ONSITE GEOTECHNICAL ENGINEER) ON PROPERLY PREPARED SUBGRADE. EXTEND CONCRETE 12" PAST DOOR JAMB. SEE CIVIL DRAWINGS FOR TOP OF CONCRETE SPOT ELEVATIONS.
- 8 ISOLATION JOINT. SEE DETAIL 3/S2 (SPACING NOT TO EXCEED 10'-0" O.C.)
- 9 DETECTABLE WARNING SURFACE (IF REQUIRED), REFER TO CIVIL DRAWINGS FOR ADDITIONAL INFORMATION.

**FOUNDATION SCHEDULE**

MARK	FOOTING SIZE (W x L)	FOOTING REINFORCEMENT		BOTTOM OF FOOTING ELEVATION	PILASTER SIZE	PILASTER REINFORCEMENT		TOP OF PILASTER ELEVATION	MARK
		LONG.	TRANS.			VERT.	TIES		
F1	3'-0"x3'-0"x1'-6"	(4) #5's	(4) #5's	97'-6"					F1
F2	3'-0"x3'-0"x1'-6"	(5) #5's	(5) #5's	97'-6"					F2
F3	6'-4"x6'-4"x1'-6"	(5) #4 EACH WAY TOP & BOT.		96'-0"	SEE 7/S3.2	(12) #6	SEE 8/S3.2	99'-4"	F3
F4	3'-0"x3'-0"x1'-6"	(4) #5's	(4) #5's	97'-6"					F4
F5	3'-0"x3'-0"x1'-6"	(4) #5's	(4) #5's	97'-6"					F5
F6	3'-0"x3'-0"x1'-6"	(5) #5's	(5) #5's	97'-6"					F6

- NOTES:
1. ALL ANCHOR BOLTS SHALL BE SIZE, QUANTITY AND SPACING AS SPECIFIED BY THE PRE-ENGINEERED METAL BUILDING MANUFACTURER. MAINTAIN 3" MINIMUM CONCRETE COVER AROUND BOLTS. TIES SHALL WRAP AROUND ANCHOR BOLTS.
  2. COLUMN BASE PLATES ARE TO REST ON TOP OF SLAB. PROVIDE LEVEL BEARING SURFACE FOR EVEN CONTACT.
  3. COLUMN FOOTING REINFORCEMENT TO BE INTEGRAL WITH CONTINUOUS FOUNDATION REINFORCEMENT (WHERE APPLICABLE).
  4. ALL SPREAD FOOTINGS ARE TO BE CENTERED BENEATH COLUMNS UNLESS NOTED OTHERWISE.
  5. PROVIDE ANCHOR BOLT TEMPLATES AT COLUMN.

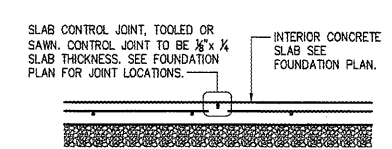

**1 TYP. CONTROL JOINT DETAIL**  
 S2 SCALE: 3/4" = 1'-0"

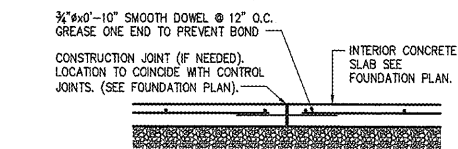

**2 TYP. CONSTR. JOINT DETAIL**  
 S2 SCALE: 3/4" = 1'-0"

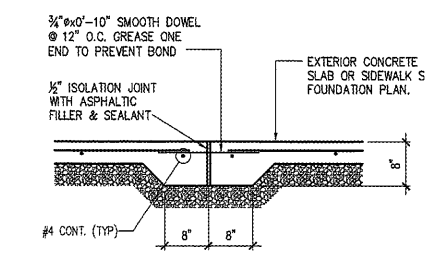

**3 SIDEWALK ISOLATION JOINT**  
 S2 SCALE: 3/4" = 1'-0"

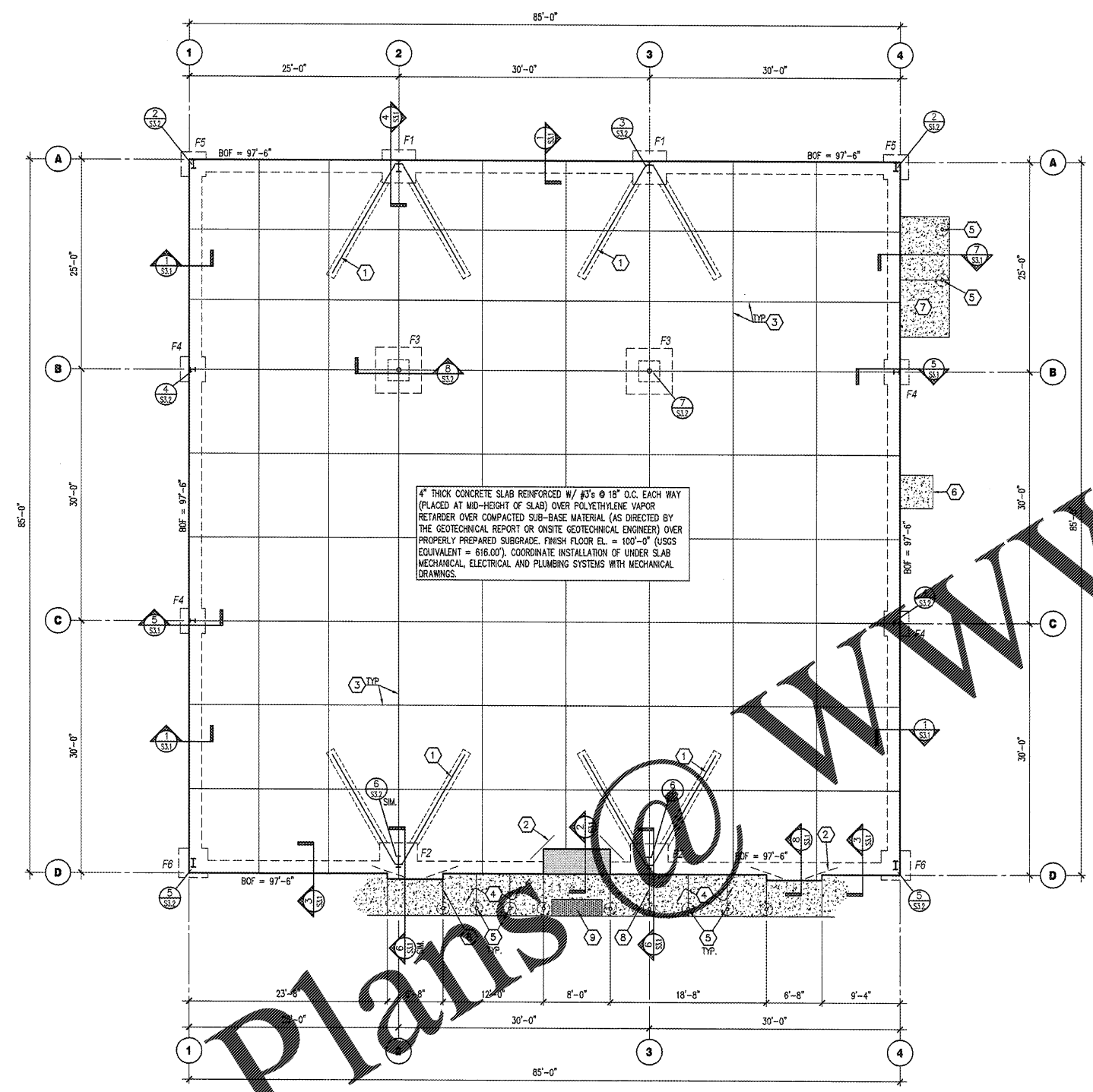

**FOUNDATION PLAN**  
 SCALE: 1/8" = 1'-0"  
 TRUE NORTH  
 CONST. NORTH

PRE-ENGINEERED METAL BUILDING JAMB POSTS AND SECONDARY POSTS NOT SHOWN. SEE PRE-ENGINEERED METAL BUILDING DRAWINGS FOR ADDITIONAL POST LOCATIONS. REFER TO DETAIL 1/S3.2 (SM) FOR ANCHORAGE.

Order Plans @ WWW.IDOLLING.COM

**JS Smith Consulting Engineers**  
 Alabama State Certificate of Authorization CA-2283-E  
 Aaron D. Smith P.E. 24301  
 P.O. Box 8102 \* JOPLIN, MISSOURI 64802  
 PHONE: 417-624-0444 \* FAX: 417-624-0430