

**FINISH NOTES**

- A. ALL GYP. BOARD TO BE 1/2" ABOVE FINISH FLOOR.
- B. WATER RESISTANT GYP. BOARD AT WET WALLS TO BE 4"-6" MIN. IN EACH DIRECTION.
- C. ALL UNDERSIDES OF GYP. BOARD SOFFITS AND HEADERS TO BE PAINTED "U-2" UNLESS OTHERWISE NOTED.
- D. ALL WALLS SHALL RECEIVE (1) COAT OF PRIMER PAINT AND (2) COATS OF SPECIFIED PAINT, UNCO. FINISH COAT TO BE APPLIED WITH A ROLLER.
- E. WALLS TO RECEIVE VINYL WALL COVERING SHALL RECEIVE (1) COAT OF WALLCOVERING PRIMER.
- F. TRANSITION OF FLOOR MATERIAL TO OCCUR UNDER DOORS WHEN POSSIBLE.
- G. SEE DOOR SCHEDULE SHEET A18 FOR DOOR HARDWARE INFORMATION.
- H. PROTECT ALL FINISHED FLOORING FROM DAMAGE THROUGHOUT CONSTRUCTION DURATION. COVER OR MASK SURFACES IN ACCORDANCE WITH SPECIFIC MANUFACTURER'S REQUIREMENTS.
- I. FLOORING CONTRACTOR TO REVIEW ALL INSTALLATION CONDITIONS WITH GENERAL CONTRACTOR BEFORE BEGINNING INSTALLATION.
- J. PREP FLOORS WITH THINSET AS REQUIRED TO CREATE A FLUSH TRANSITION BETWEEN FLOORING SURFACE MATERIALS. ALL THRESHOLDS TO MEET ADA REQUIREMENTS.
- K. ALL SUBSTITUTES MUST BE APPROVED BY ARCHITECT AND BE OF EQUAL QUALITY.
- L. ALL INTERIOR WALL AND CEILING FINISHES TO COMPLY WITH STATE AND LOCAL CODE REQUIREMENTS FOR FLAME SPREAD AND SMOKE DEVELOPMENT RATING.
- M. ALL EXPOSED TRAPS, WATER LINES AND OTHER MISCELLANEOUS PLUMBING EQUIPMENT UNDER LAVATORIES SHALL BE COVERED OR PROTECTED.
- N. ALL RESTROOM WALLS TO RECEIVE SEMI-GLOSS EPOXY PAINT WHERE NO OTHER FINISH EXISTS.
- O. PROVIDE FRP ON WALLS WHERE INDICATED ON FLOOR PLANS, ELEVATIONS AND DETAILS. CONTINUITY SEAL ALONG ALL JOINTS BETWEEN BASES AND PANELS. USE FRP ACCESSORIES FROM MANUFACTURER FOR COMPLETE INSTALLATION.
- P. INSTALL FRP FROM TOP OF WALL BASE TO 6" ABOVE CEILING.
- Q. PROVIDE STAINLESS STEEL SCHLUTER QUATEC EDGE PROTECTION STRIP AT ALL OUTSIDE CORNERS OF CERAMIC WALL TILE. REFER TO DECOR DRAWINGS.
- R. PROVIDE STAINLESS STEEL COVE BASE SCHLUTER DILEX AT FLOOR TILE TO WALL TILE TRANSITIONS IN DINING ROOM AND RESTROOM.
- S. ALL WALKING SURFACES TO HAVE SLIP RESISTANT SURFACE AND BE SECURELY ATTACHED TO SUB-FLOOR. CHANGES IN THE FLOOR ELEVATION SHALL NOT EXCEED 1/4". FLOOR FINISHES SHALL COMPLY WITH FBC SECTION 1003.4 AND ICC/ANSI 1111.
- T. ALL INTERIOR FINISHES SHALL COMPLY WITH FBC SECTION 803 AND TABLE 803.3.
- U. SEE DECOR PACKAGE FOR EXTENT OF FINISHES AND BUILT-IN ITEMS ALL FLOOR GROUT TO BE EPOXY TYPE.
- V. DECOR DRAWINGS THAT CONTAIN SPECIFIC FINISH INFORMATION WILL BE SUPPLIED BY THE OWNER/FRANCHISEE.
- W. FOR ARMSTRONGS STRATEGIC ACCOUNT PROGRAM PRICING, CONTACT LOUIS JOHN 811-216-1816, OPTION 8 EXTENSION 8926.
- X. PAINT EXPOSED SURFACES OF ALL BRICK LEDGES WHITE.
- Y. PROVIDE 1/2" FRT FLYWOOD ON WALLS TO RECEIVE FRP.

**FINISH SCHEDULE**

MARK	TYPE	MANUFACTURER/MODEL	SIZE/FINISH	NOTES
<b>FLOORING</b>				
FL-1	CERAMIC TILE	REFER TO DECOR DRAWINGS	---	---
FL-2	QUARRY TILE	SURE STEP RED Q-30	---	GROUT - CHARCOAL
<b>BASE</b>				
B-1	CERAMIC TILE	REFER TO DECOR DRAWINGS	---	---
B-2	QUARRY TILE	SURE STEP RED Q-30	---	GROUT - CHARCOAL
<b>WALLS</b>				
W-1	WALL COVERING	REFER TO DECOR DRAWINGS	---	---
W-2	PAINT	SHERWIN WILLIAMS WHITE 801009	EGGSHELL	---
W-3	FRP	REFER TO DECOR DRAWINGS	PEBBLED	INSTALL WITH FRP STANDARD ACCESSORIES AND TRIM
W-4	CERAMIC TILE	REFER TO DECOR DRAWINGS	---	---
<b>CEILING</b>				
C-1	ACOUSTIC CEILING TILE	REFER TO DECOR DRAWINGS	12" x 24"	GRID: B/A
C-2	VINYL FACED PANEL	GYPSUM VINYL FACED PANEL	24" x 48"	STIPPLE SHELL SQUARE EDGE
C-3	GYP. BOARD	PAN-1/2" FLAT FINISH	1/2" THICK	HANG ON SUSPENDED GRID SYSTEM
<b>DOORS AND PARTITIONS</b>				
FRAMES	HOLLOW METAL	PAINT	---	REFER TO DECOR DRAWINGS
DOORS	PLASTIC LAMINATE	REFER TO DECOR DRAWINGS	---	---

**SYMBOL LEGEND**

- (X) CODED NOTE
- FL-X FLOOR FINISH TAG (SEE SCHEDULE ON THIS SHEET)
- B-X BASE FINISH TAG (SEE SCHEDULE ON THIS SHEET)
- W-X WALL FINISH TAG (SEE SCHEDULE ON THIS SHEET)
- C-X CEILING FINISH TAG (SEE SCHEDULE ON THIS SHEET)

**KEYED NOTES**

- 1 STAINLESS STEEL END CAP.
- 2 STAINLESS STEEL CORNER GUARD.
- 3 PROVIDE CERAMIC TILE ON THIS WALL. REFER TO DECOR DRAWINGS FOR MATERIAL.
- 4 TRANSITION FLOOR FINISH UNDER DOOR.
- 5 TRANSITION FLOOR FINISH 12" UNDER PRODUCTION COUNTER.
- 6 PROVIDE STAINLESS STEEL SHEET ON WALL BEHIND HOOD. REFER TO FLOOR PLAN.
- 7 INSULATED PRE-FABRICATED FLOORS WITHIN THE COOLER AND FREEZER.
- 8 PROVIDE 48" TALL STAINLESS STEEL PANEL ON WALL AT MOP SINK.
- 9 PROVIDE CERAMIC TILE ON CUSTOMER SIDE OF PRODUCTION COUNTER. REFER TO DECOR DRAWINGS FOR MATERIAL.
- 10 PROVIDE CORIAN WINDOW SILLS. REFER TO DECOR DRAWINGS FOR MATERIAL.
- 11 EXTEND QUARRY TILE INTO COOLER VESTIBULE AREA.

**MILLWORK GENERAL NOTES**

- A. PREPARE AND SUBMIT G.C. APPROVED SHOP DRAWINGS FOR ALL ITEMS OF MILLWORK TO THE ARCHITECT FOR REVIEW.
- B. THE USE OF PARTICLE BOARD, HARDBOARD AND OTHER SIMILAR WOOD PRODUCTS IS PROHIBITED IN WET AREAS. USE 3/4" MARINE GRADE PLYWOOD IN THESE AREAS INSTEAD.
- C. ALL WOOD BLOCKING PROVIDED SHALL BE OF FIRE-RETARDANT TREATED WOOD.
- D. SPACING OF SUPPORT BRACKETS AND PROFILE FOR COUNTERTOPS SHALL BE INDICATED ON SHOP DRAWINGS FOR REVIEW PRIOR TO FABRICATION.
- E. ALL WALL MOUNTED ITEMS SHALL RECEIVE FIRE RETARDANT TREATED WOOD BLOCKING. COORDINATE LOCATIONS AND HEIGHTS PRIOR TO INSTALLATION.
- F. SUB-CONTRACTOR SHALL FIELD VERIFY REQUIRED DIMENSIONS PRIOR TO FABRICATION.
- G. INTERIOR ELEVATIONS AND DETAILS ARE FOR DESIGN INTENT ONLY. QUESTIONS CONCERNING DEVIATION FROM THE DESIGN INTENT SHALL BE PROVIDED TO THE ARCHITECT. SUB-CONTRACTOR SHALL PROVIDE SHOP DRAWINGS FOR REVIEW PRIOR TO FABRICATION.
- H. ALL CASEWORK TO RECEIVE PLASTIC LAMINATE ON ALL EXPOSED SURFACES. REFER TO DECOR DRAWINGS.
- I. PROVIDE 4" BACKSPLASH AT ALL COUNTERTOP-TO-WALL TRANSITIONS.
- J. WOOD BLOCKING FOR SHELVING SHALL BE STAGGERED BETWEEN EACH METAL STUD MIN. 4".
- K. ANY GROMMET HOLES SHALL BE DRILLED BY THE CASEWORK FABRICATOR ONLY. COORDINATE LOCATION WITH OWNER.
- L. SEAL ALL MILLWORK TO ADJACENT SURFACES.

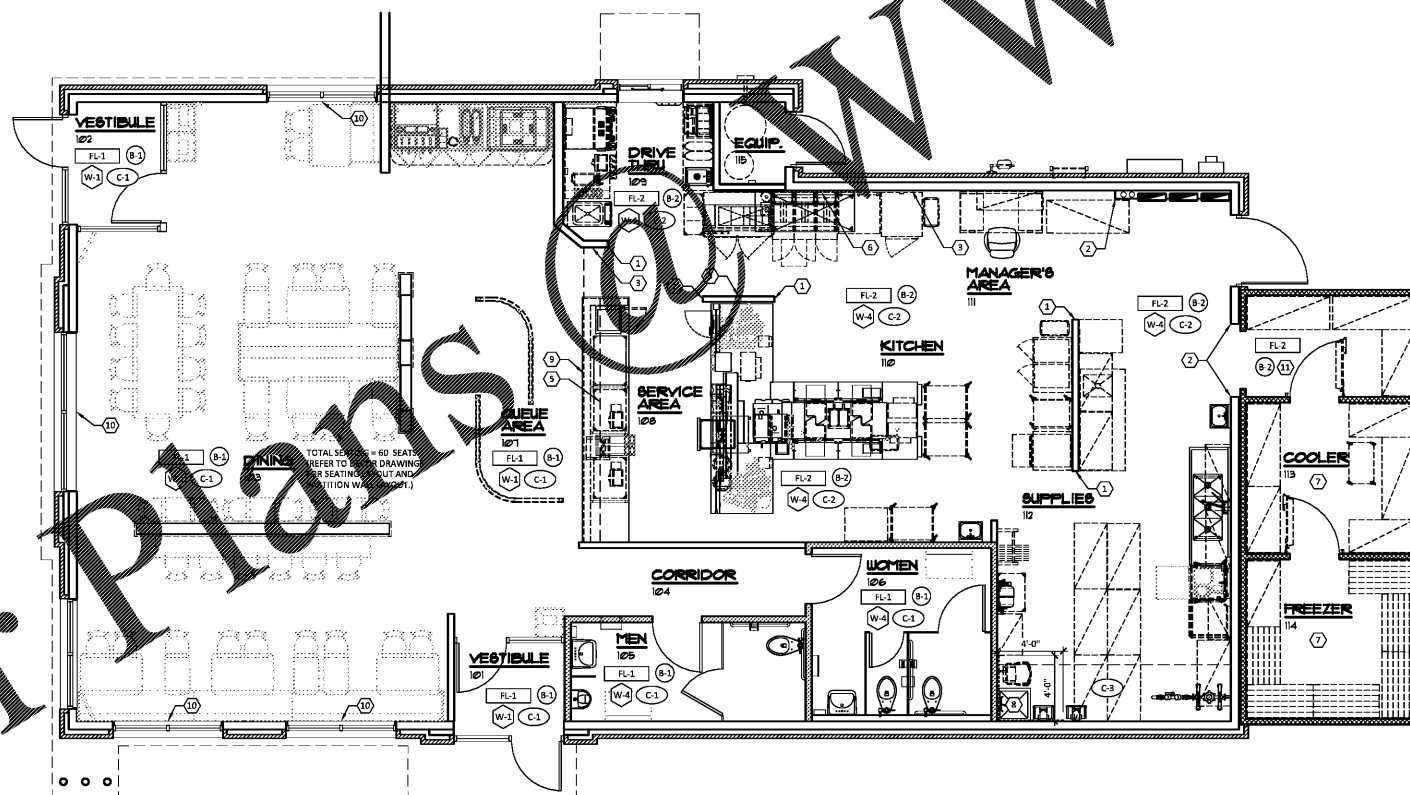

**FINISH FLOOR PLAN**  
SCALE: 3/16" = 1'-0"

REVISIONS	BY
AA 0002921 Member of the American Institute of Architects 32707 US Hwy. 19, Suite 1705, Palm Harbor, FL 34684 Phone: 727.943.4444 www.oliveriarchitects.com	
NOT FOR CONSTRUCTION	
Case No. 18-0000002 New Building for <b>ARBY'S</b> Store #8149 1058 Dunlawton Ave. Port Orange, Florida	
Date:	08.14.18
Project Mgr:	DM
Drawn:	JDS
Job:	18-082
Sheet	ID1

Order Plans