

Order Plans @

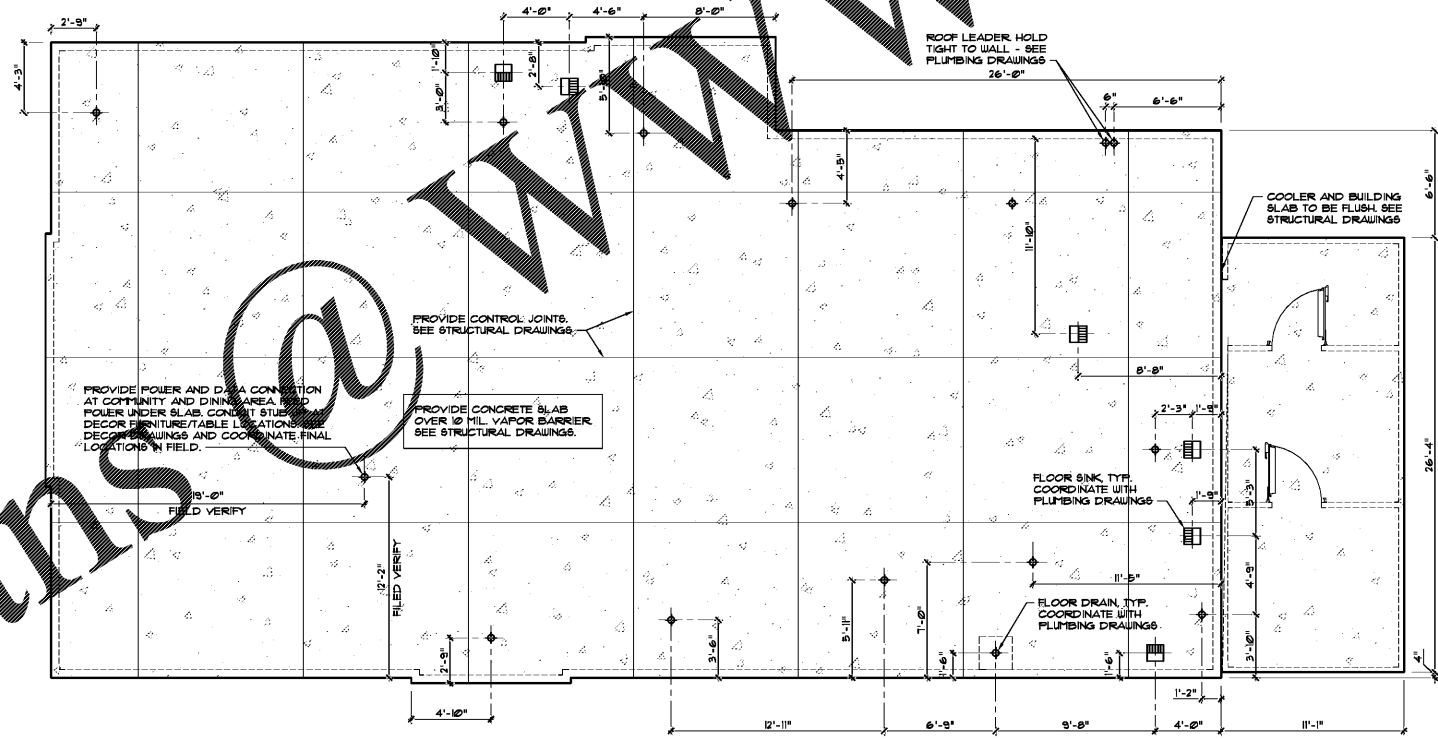

NOTE:  
GENERAL CONTRACTOR TO VERIFY AND  
COORDINATE ALL EQUIPMENT LOCATIONS,  
SIZES AND ELECTRICAL AND PLUMBING  
REQUIREMENTS WITH EQUIPMENT VENDOR  
PRIOR TO ROUGH-INS

GENERAL NOTES

1. VERIFY OVERALL INTERIOR DIMENSIONS AND EXTERIOR WALL PENETRATIONS IN FIELD AND NOTIFY ARCHITECT OF ANY DISCREPANCIES PRIOR TO COMMENCEMENT OF CONSTRUCTION.
2. ALL DIMENSIONS ARE TO THE INSIDE FACE OF EXTERIOR STUD WALLS, ON THIS SHEET ONLY.
3. ALL DIMENSIONS ARE TO THE CENTERLINE OF FIXTURE UNLESS OTHERWISE NOTED.
4. GC TO REVIEW ELECTRICAL PLANS FOR LIGHTING OR POWER STUD LOCATIONS PRIOR TO POURING SLAB.
5. GC TO REVIEW PLUMBING PLANS TO COORDINATE FLOOR SINK AND FLOOR DRAIN TYPE.
6. INSTALL PERIMETER FOUNDATION INSULATION PRIOR TO BACKFILL OF FOUNDATION WALL.
7. GENERAL CONTRACTOR TO REVIEW THE SOIL BEARING REPORT PRIOR TO INSTALLING BASE AND SLAB.
8. REFER TO STRUCTURAL DRAWINGS FOR SLAB ON GRADE INFORMATION.

REVISIONS	BY

OLIVERI ARCHITECTS  
AA 0002921  
Member of the American Institute of Architects  
32707 US Hwy. 19 S. Suite 100 Palm Harbor, FL 34684  
Phone: 727.943.8888 Fax: 727.943.8889  
www.oliveriarchitects.com

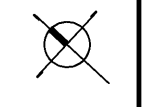
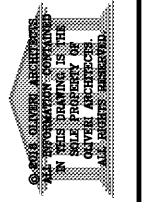

NOT FOR CONSTRUCTION

Case No. 18-0000002  
New Building for  
**ARBY'S**  
Store #8149  
1058 Dunlawton Ave.  
Port Orange, Florida

Date: 08.14.18

Project Mgr: DM

Drawn: JDS

Job: 18-082

Sheet

A1c

1 FLOOR DRAIN AND SLAB PLAN  
SCALE: 3/16" = 1'-0"