

K:\1174 Delaney Projects\117401.01 Nine Mile Road\DWG\L-100.dwg, Aug 02, 2018 - 2:59:19PM, toverton

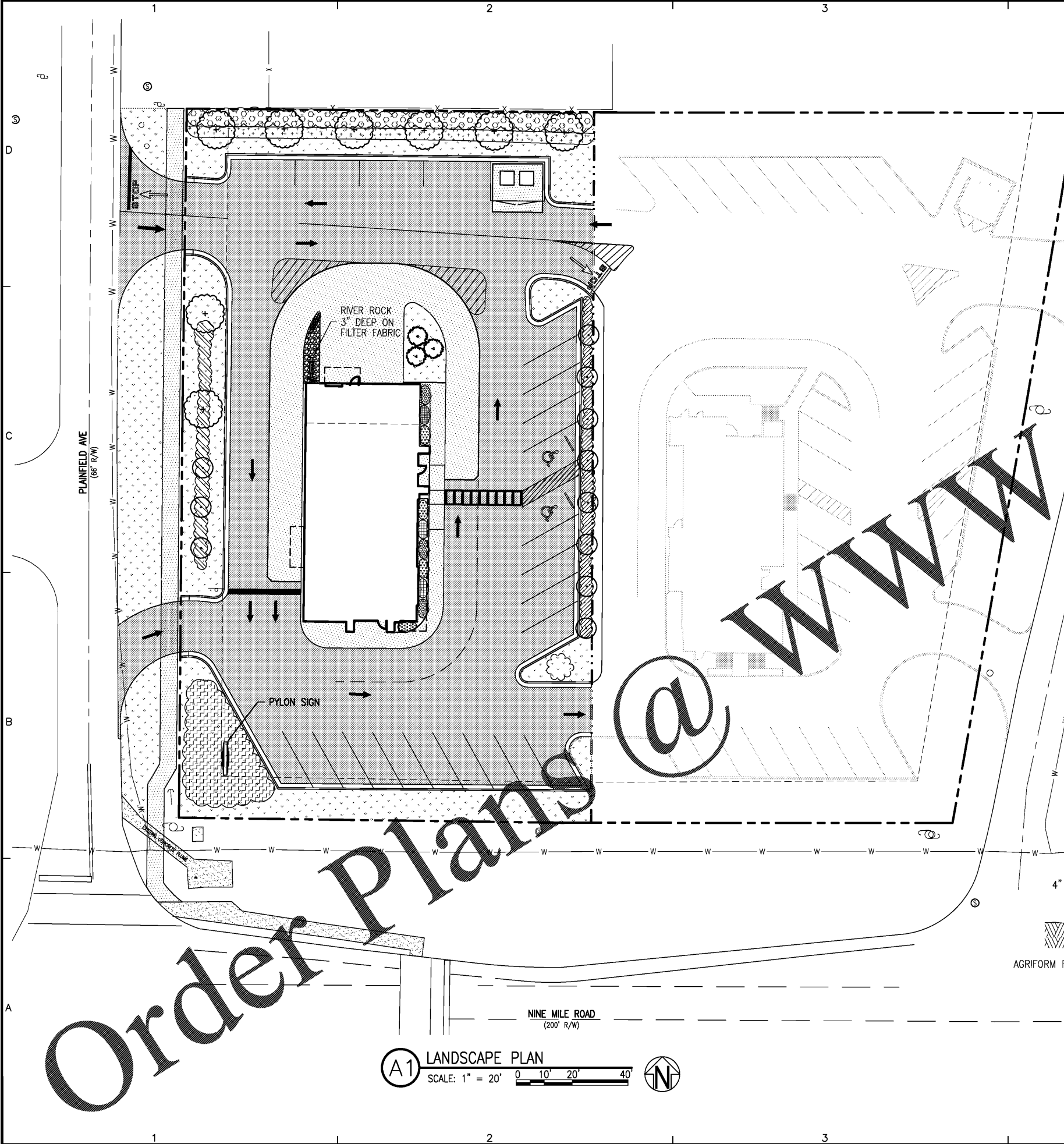

PLANTING SCHEDULE

QTY.	SYMBOL	COMMON NAME	BOTANICAL NAME	HEIGHT	ROOTS	COMMENTS
8		LIVE OAK	Quercus virginiana	16'	B&B	3" CAL.
3		CHASTE TREE	Vitex agnus-cactus	7'	CONTAINER	
8		GRAPE MYRTLE	Lagerstroemia indica	9'	B&B	'DELEA'
1		SWEETGUM	Liquidambar styraciflua	16'	CONTAINER	3" CAL.
28		HOLLY HEDGE	Ilex burbankii	5'	CONTAINER	
70		DWARF PITTOSPORUM	Pittosporum tobira		2 gal.	
40		LOROPETALUM	Loropetalum		3 gal.	
280		AZTEC GRASS	Liriope muscari		1 gal.	
		ZOYSIA SOD	Zoysia			ALL AREAS
40		BREEZE	Lomandra lonfolia		2 gal.	
24		DAYLILY	Hemerocallis		1 gal.	
15		HOSTA	Hosta		1 gal.	
65		GULF MUHLY GRASS	Muhlenbergia capillaris		3 gal.	

ALL PLANT MATERIAL TO BE GRADED 'FLORIDA FANCY'. TOTAL REPLACEMENT TREE MEASURE: 27 CALIPER INCHES.

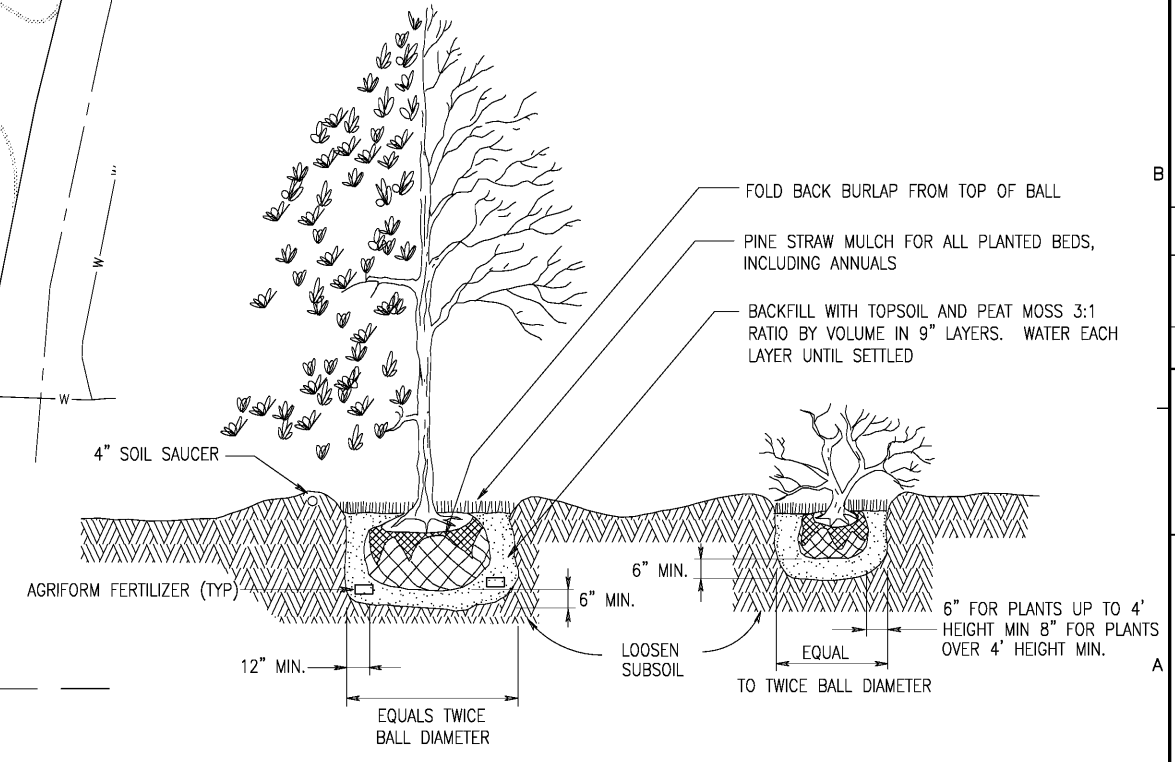

A3 TREE & SHRUB PLANTING DETAIL
SCALE: NOT TO SCALE

A1 LANDSCAPE PLAN
SCALE: 1" = 20'
0 10' 20' 40'

BASKERVILLE-DONOVAN, INC.
Innovative Infrastructure Solutions
449 W. MAIN ST., PENSACOLA, FL 32502 (850) 336-9861
ENGINEERING BUSINESS: EB-0000340

Pensacola - Panama City Beach - Tallahassee - Mobile - Brentwood County - Tampa
The drawing is the property of BASKERVILLE-DONOVAN, INC. and is not to be reproduced in whole or in part. It is not to be used on any other project and it is to be returned upon request.

DWID K. HEMPHILL
FL Reg. Landscape Architect
#LA0000502

KRISPY KREME
1730 E. NINE MILE ROAD

NO.	DATE	APPR.	REVISION/ACTION	TAKEN

PROJECT NO: 117401.01

DESIGNED BY: DKH

DRAWN BY: CAD

PROJ. MGR: DKH

DATE: JULY 2018

LANDSCAPE PLAN

NOT RELEASED FOR CONSTRUCTION BY _____ DATE _____

L-100