

K:\1174 Delcney Projects\117401.01 Nine Mile Road\DWG\C-100.dwg, Aug 06, 2018 - 1:19:41PM, toverton

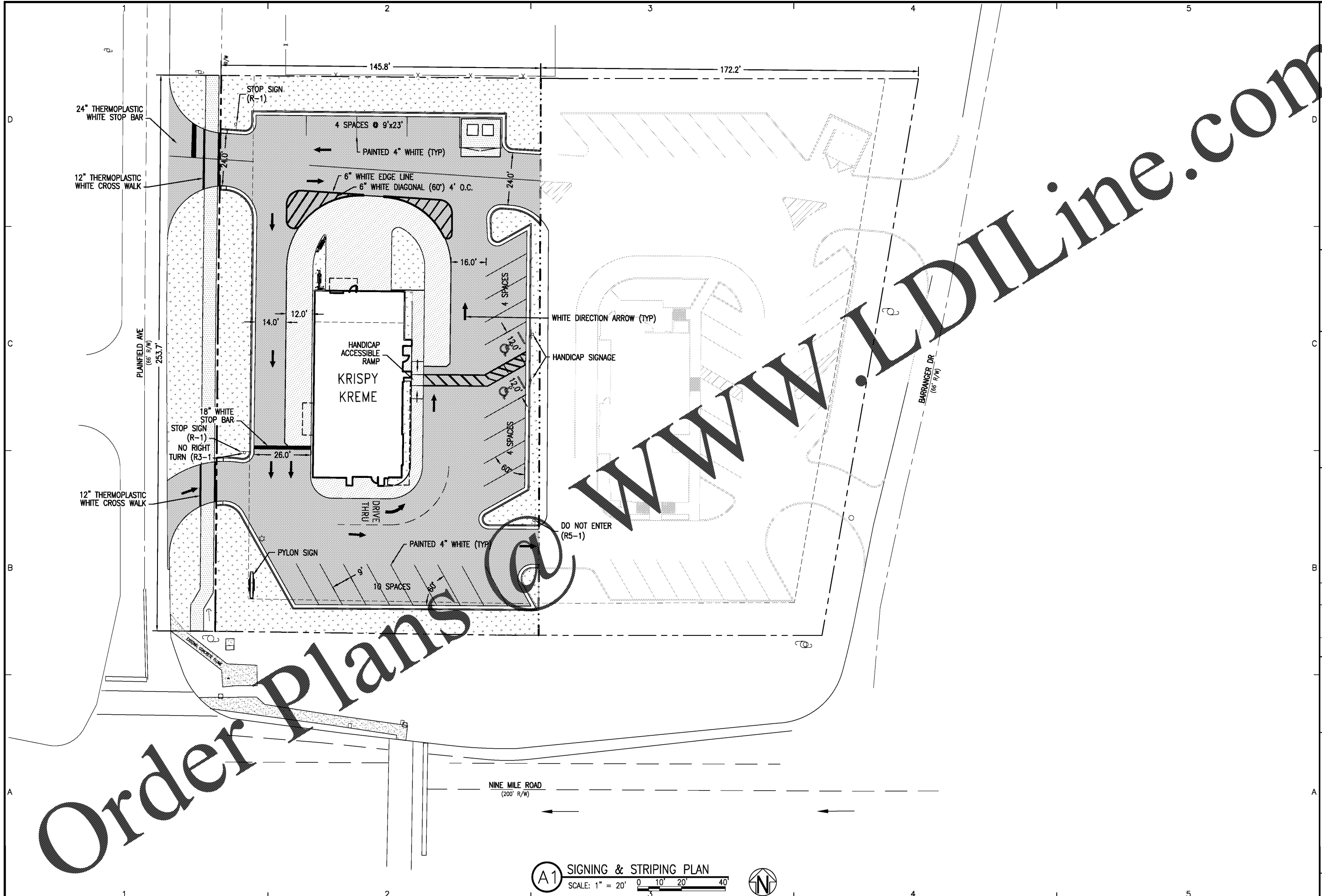

Order Plans @

**A1** SIGNING & STRIPING PLAN  
 SCALE: 1" = 20' 0 10 20 40



<b>BASKERVILLE-DONOVAN, INC.</b> Innovative Infrastructure Solutions 449 W. MAIN ST., PENSACOLA, FL 32502 (850) 396-9861 ENGINEERING BUSINESS: EB-0000340 Pensacola - Panama City Beach - Tallahassee - Mobile - Bay County - Tampa This drawing is the property of BASKERVILLE-DONOVAN, INC. and is not to be reproduced in whole or in part. It is not to be used on any other project and is to be returned upon request.	
KEITH P. GUTHRIE, P.E. FL. Reg. Engineer #47905	
KRISPY KREME 1730 E. NINE MILE ROAD	
PROJECT NO: 117401.01	REVISION/ACTION TAKEN
DESIGNED BY: DKH	
DRAWN BY: CAD	
CHECKED BY:	
PROJ. MGR: DKH	
DATE: JULY 2018	NOT RELEASED FOR CONSTRUCTION BY DATE
<b>SIGNING &amp; STRIPING PLAN</b>	
<b>C-106</b>	