

7/27/2018 9:05:58 AM  
 C:\2018\201837501\_Moes Prototype\04\_Constr\Docs\Revit (2017)\Arch1 - Arch Model

Order Plans @ www.dline.com

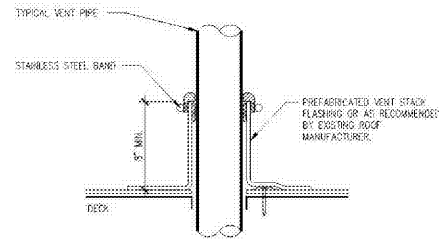

4 VTR PENETRATION DETAIL  
 3/4" = 1'-0"

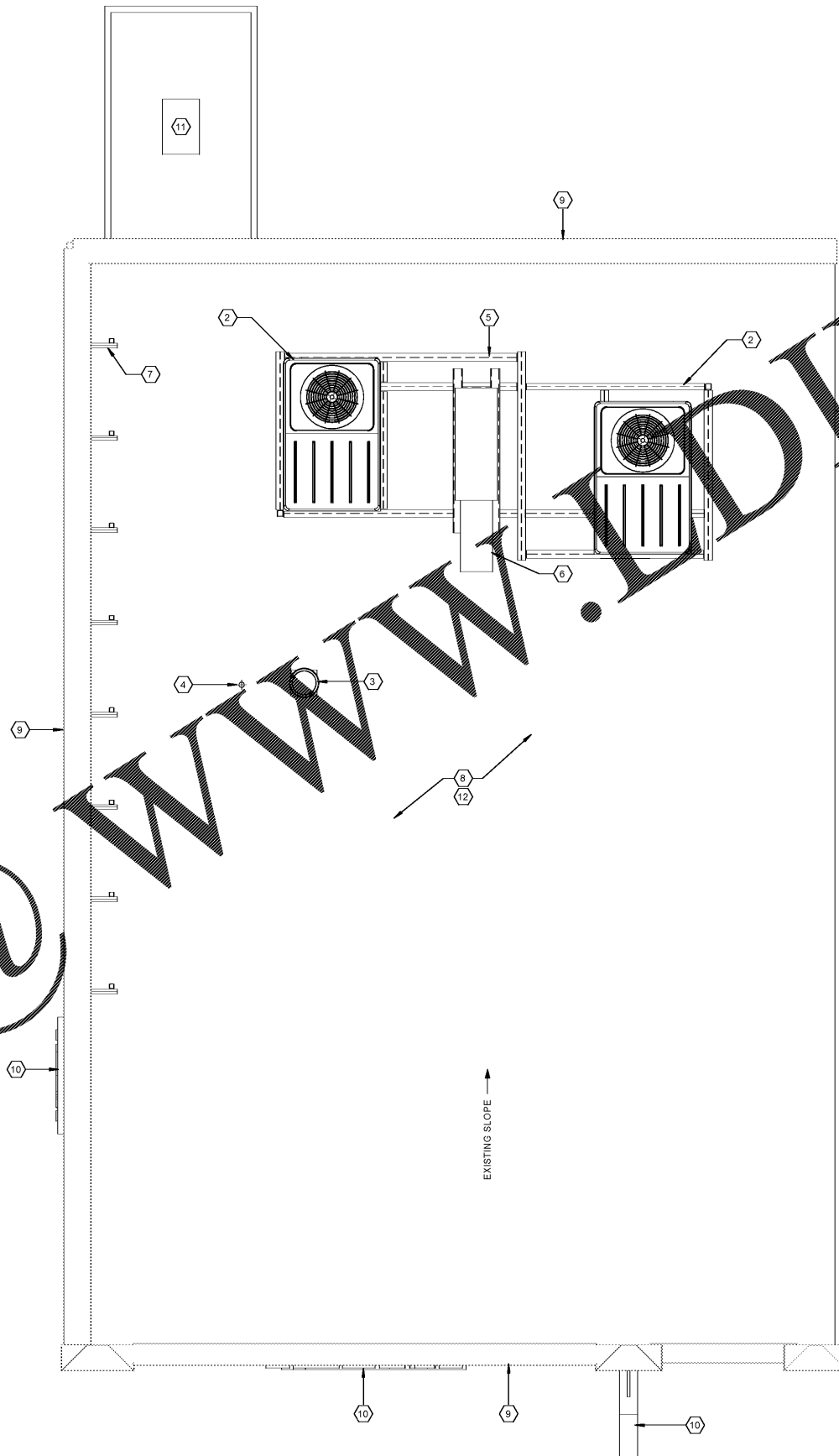

1 ROOF PLAN  
 1/4" = 1'-0"

ROOF PLAN KEY NOTES

1. LINE OF EXISTING TENANT DEMISING WALL BELOW TO BOTTOM OF ROOF DECK.
  2. NEW ROOFTOP UNIT. SEE MECHANICAL.
  3. NEW HOOD EXHAUST FAN. SEE MECHANICAL.
  4. NEW VENT THROUGH ROOF. SEE 4/A200.
  5. RTU STRUCTURAL FRAMING SUPPORT. SEE STRUCTURAL. SEE 4/A-200 FOR SIM FLASHING DETAIL AT ROOF PENETRATIONS.
  6. NEW MAKE-UP AIR UNIT FOR HOOD. SEE MEP DRAWINGS.
  7. EXISTING PARAPET STUB UP AND FRAMING TO REMAIN.
  8. EXISTING TPO ROOF SYSTEM. PROVIDE NEW PENETRATIONS AS REQUIRED TO ACCOMMODATE NEW WORK. COORDINATE WORK WITH ROOFING COMPANY TO MAINTAIN WARRANTY.
  9. EXISTING PARAPET WALL.
  10. NEW SIGNAGE UNDER SEPARATE PERMIT.
  11. CONDENSING UNIT FOR WALK-IN COOLER.
- FIELD VERIFY LOCATION OF WALKWAY PADS. PROVIDE NEW AS REQUIRED FOR NEW ROOFTOP EQUIPMENT.

GENERAL ROOF NOTES

1. ALL NEW ROOF PENETRATIONS SHALL BE PERFORMED BY A QUALIFIED ROOFING CONTRACTOR PRE-APPROVED BY THE EXISTING ROOF MANUFACTURER & BY THE LANDLORD. ALL WORK SHALL BE IN FULL COMPLIANCE W/ EXISTING ROOF MANUFACTURER'S STANDARD DETAILS, SPECIFICATIONS AND RECOMMENDATIONS, SUCH THAT ALL EXISTING WARRANTIES REMAIN IN FULL EFFECT. FIELD VERIFY EXISTING CONDITIONS, EXISTING ROOF MANUFACTURER AND EXISTING ROOF WARRANTY REQUIREMENTS PRIOR TO BIDDING AND CONSTRUCTION.
2. CONTRACTOR SHALL OBTAIN WRITTEN PERMISSION FROM THE LANDLORD PRIOR TO INSTALLATION OF ROOF TOP EQUIPMENT. ROOF TOP EQUIPMENT LOCATION & WEIGHTS SHALL BE PROVIDED TO THE LANDLORD TO ASSURE ADEQUACY OF ROOF DESIGN PRIOR TO INSTALLATION. DO NOT INSTALL NEW ROOFTOP EQUIPMENT ON EXISTING BAR JOISTS WHICH ARE NOT CAPABLE OF CARRYING THE IMPOSED LOADS. G.C. SHALL FIELD VERIFY EXISTING STRUCTURE AND REPORT FINDINGS IN WRITING TO LANDLORD AND ARCHITECT PRIOR TO COMMENCING NEW WORK. FIELD VERIFY LOCATION OF EXISTING ROOF TOP UNITS.

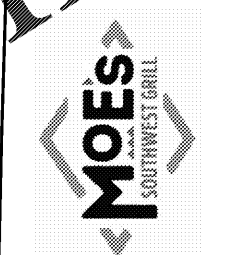

REV. NO.	DATE	ISSUE FOR PERMIT	DESCRIPTION
	07/27/18		

DRAFT

MOE'S SOUTHWEST GRILL  
 3732 US HWY 280  
 PHENIX CITY, AL 36867

ROOF PLAN

DATE:	
BRAND REVIEW	07/27/2018
PERMIT	07/27/2018
BID	--/------
CONSTRUCTION	--/------
RECORDED	--/------

PROJECT MANAGER	DESIGNER
JB	SC

JOB NO.  
 2018375.13

A-200