

7/17/2018 10:46:50 AM
 C:\2018\20181837501_Moes Prototype\04_ConstrDocs\Revit (2017)\Arch1_Arch Model

Order Plans @

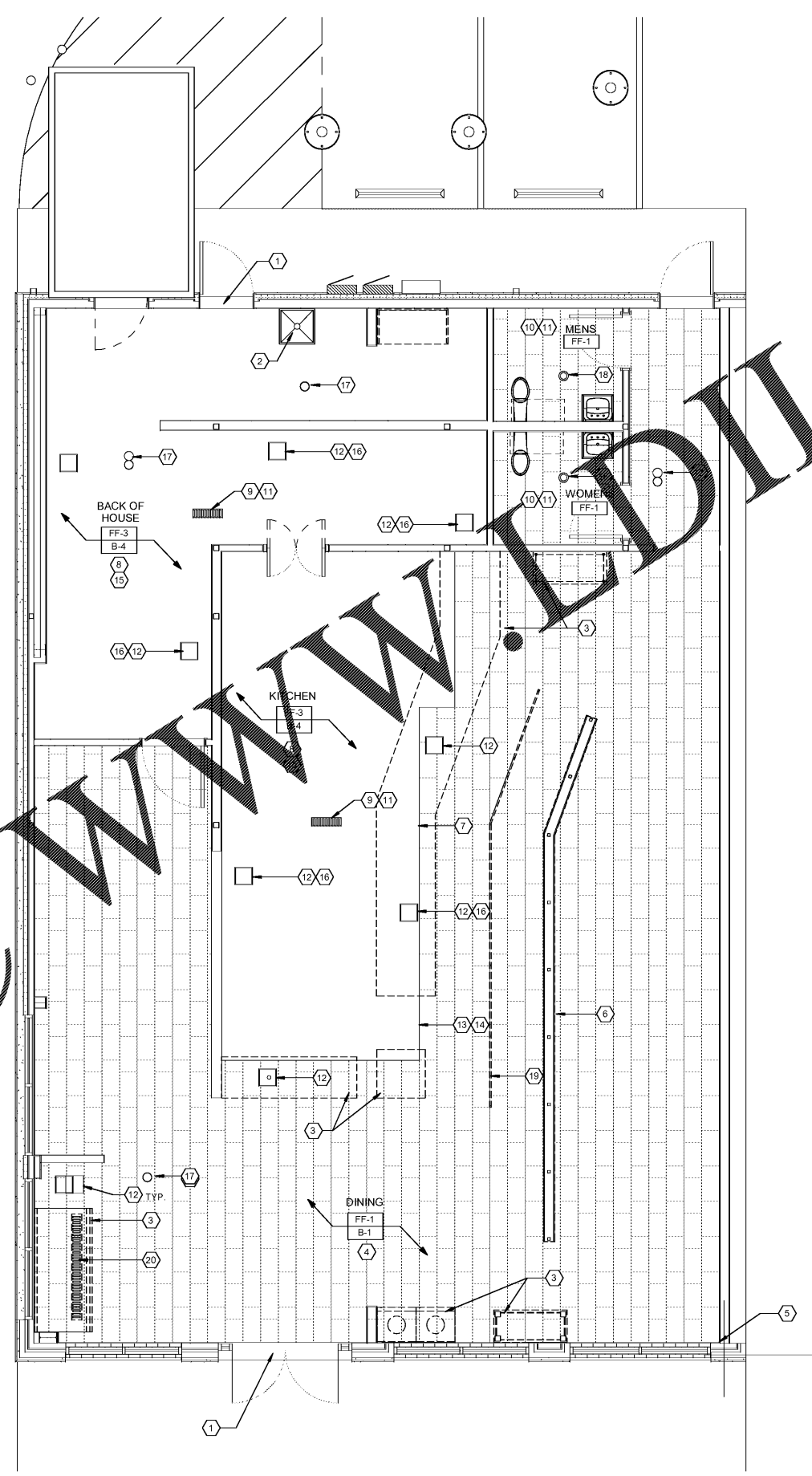

1 FLOOR FINISH PLAN
 1/4" = 1'-0"

FINISH PLAN KEY NOTES

- NEW DOOR THRESHOLD - COORDINATE TILE INSTALLATION W/ EXISTING CONDITIONS. SEE DOOR SCHEDULE.
- PRE-MANUFACTURED MOP SINK - SEE PLUMBING DRAWINGS.
- CABINET/COUNTER - SEE MILLWORK SCHEDULE & MILLWORK SHOP DRAWINGS. PROVIDE BASE @ ALL CASEWORK ITEMS AS APPLICABLE (V.I.F.)
- REFER TO 2/A-430 FOR DINING BASE B-1 DETAIL.
- START POINT FOR THE TILE FINISH (FIELD VERIFY).
- LINE OF KNEEWALL W/CORE DRILLED SUPPORTS.
- FLOOR FINISH TRANSITION SHALL OCCUR AT ALL CASEWORK. FIELD VERIFY EXACT LOCATION. CONTRA TO RECEIVE MANDATORY TEMPLATE FROM MILLWORK PROVIDER. TEMPLATE DESIGNED TO PROVIDE PROPER DIMENSION FOR SOFFIT PLACEMENT AND TILE TRANSITION.
- REFER TO 9/A-430 FOR DETAIL OF HOUSE AND BASE DETAIL.
- 20" X 6" FLOOR TRENCH DRAIN SEE DETAIL 10/A-430. ALSO SEE PLUMBING PLANS FOR FLOOR DRAINS. FOLLOW MANUFACTURER WRITTEN INSTRUCTIONS.
- REFER TO 12/A-430 FOR RESTROOM BASE DETAIL.
- PROVIDE POSITIVE SLOPE TO FLOOR DRAINS WHERE POSSIBLE. FIELD COORDINATE W/ EXISTING CONDITIONS. COORDINATE SLOPES W/ FLOORING CONTRACTOR TO ACHIEVE CLEAN, SMOOTH TRANSITION.
- FLOOR SINK. REFER TO PLUMBING DRAWINGS.
- ALIGN FLOOR TRANSITION W/ NEAREST FULL TILE. SEE KEY NOTE #5 FOR START POINT OF TILE.
- PROVIDE TRANSITION STRIP @ OPENING BETWEEN MAIN SERVICE COUNTER & WALL WHEN ALTRO FLOORING FF-3 IS USED. SEE DETAIL 12/A-430.
- NEW CONCRETE MUST CURE FOR APPROXIMATELY 90 DAYS BEFORE ALTRO FLOORING, FF-3, CAN BE INSTALLED. CONCRETE MUST BE TESTED TO ASTM F2170 AND HAVE LESS THAN 85% MOISTURE CONTENT. IF NOT POSSIBLE, THE CONCRETE MUST BE SEALED WITH ARDEX MOISTURE CONTROL SYSTEMS - CONTACT ANDY SMITH WITH ARDEX AT 704-322-9137 FOR MORE INFORMATION PRIOR TO ALTRO INSTALLATION.
- CLAMPING FLOOR SINK IN ALTRO FLOORING. REFER TO DETAIL 11/A-430. FOLLOW MANUFACTURER'S WRITTEN INSTRUCTIONS.
- CLEANOUT. REFER TO PLUMBING DRAWINGS.
- FLOOR DRAIN. REFER TO PLUMBING DRAWINGS.
- LINE OF CUSTOM RAILING WITH CORE DRILLED SUPPORTS.
- DRIP TROUGH IN BEVERAGE COUNTER. REFER TO PLUMBING DRAWINGS.

GENERAL FLOOR FINISH NOTES

- REFER TO PLUMBING PLANS FOR FLOOR DRAIN, FLOOR SINK, HUB DRAIN & CLEANOUT LOCATIONS. COORDINATE TILE INSTALLATION AROUND THESE ITEMS. PLUMBING CONTRACTOR TO ACHIEVE A CLEAN, FLUSH INSTALLATION.
- BASE NOT REQUIRED @ CONCEALED AREAS AND @ STOREFRONTS EXTENDING TO FLOOR.
- REFER ALSO TO INTERIOR ELEVATIONS ON SHEETS A-501, A-502 AND A-503 FOR EXTENT OF BASE & WALL FINISHES.
- WHEREVER POSSIBLE, ALIGN FLOOR TILE GROUT JOINTS @ DISIMILAR FLOOR TILE TRANSITIONS & W/BASE TILES AS APPLICABLE.
- PROVIDE POSITIVE SLOPE TO FLOOR DRAINS WHERE POSSIBLE. FIELD COORDINATE W/ EXISTING CONDITIONS. COORDINATE SLOPES W/ TILE CONTRACTOR TO ACHIEVE CLEAN, SMOOTH TRANSITION.

SYMBOLS KEY

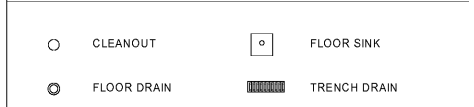

NOTE: VERIFY PLACEMENTS ON PLUMBING PLAN

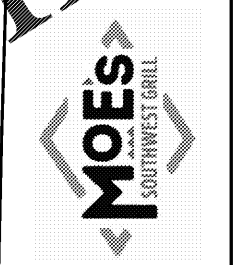

REV. NO.	DATE	DESCRIPTION
	07/27/2018	ISSUE FOR PERMIT

DRAFT

MOES SOUTHWEST GRILL
 3732 US HWY 280
 PHOENIX CITY, AL 36867

FLOOR FINISH PLAN

DATE:	
BRAND REVIEW	07/27/2018
PERMIT	07/27/2018
BID	--/------
CONSTRUCTION	--/------
RECORDED	--/------
PROJECT MANAGER	DESIGNER
JB	SC

JOB NO.
 2018375.13

A-130