

REFER TO A1.1 FOR COMPLETE SCOPE OF WORK.
 REFER TO G1.1 FOR PROJECT PHASING
 REFER TO A1.1 FOR GENERAL NOTES
 REFER TO AD1.1.1 FOR DEMOLITION KEY NOTES.
 REFER TO AD1.1.1 FOR DEMOLITION GENERAL NOTES.

① DEMOLITION KEY NOTES

- NOT ALL DEMOLITION NOTES ARE USED FOR ACTUAL SCOPE OF WORK. REFER TO NOTES GENERAL NOTES AND NOTES ON SHEET AD1.1 AS WELL AS GENERAL NOTES AND WORK SCOPE NOTES ON SHEET A1.1.
- 12. CEILING**
- 12A. REMOVE EXISTING LIGHT FIXTURES REFER TO ELECTRICAL PLAN
 - 12B. REMOVE LIGHT FIXTURES COMPLETELY AS REQUIRED UNDER EXISTING GWS BOFFIT TO REMAIN
 - 12C. REMOVE EXISTING LIGHT FIXTURES TO BE RELOCATED REFER TO ELECTRICAL PLAN
 - 12D. REPLACE EXISTING LIGHT FIXTURES REFER TO ELECTRICAL PLAN

① EXISTING KEY NOTES

- 1. EXISTING CONSTRUCTION TO REMAIN
- 1A. EXISTING CEILING PANELS OR OPEN TO STRUCTURE CEILING OR GWS CEILING AND LIGHT FIXTURES TO REMAIN.
- 1B. EXISTING GWS BOFFIT TO REMAIN.



2330 PINE HURST DRIVE
 LOUISVILLE, KY 40222
 WWW.STUDIOAARCHITECTS.COM



CONSULTANTS

PROJECT NAME

**KROGER STORE
 L-758**

234 EAST BROOK PARKWAY
 MT. WASHINGTON, KY

CLIENT



KROGER COMPANY

1632 Dimity Station Court
 Louisville, Kentucky 40223

**DEMOLITION
 REFLECTED CEILING
 FLOOR PLAN**
 SCALE: 3/32" = 1'-0"

No.	Description	Date

REVIEW SET/PERMIT SET

© 2018 STUDIO A ARCHITECTS. ALL RIGHTS RESERVED. THIS DOCUMENT IS THE PROPERTY OF STUDIO A ARCHITECTS. NO PART OF THIS DOCUMENT MAY BE REPRODUCED OR TRANSMITTED IN ANY FORM OR BY ANY MEANS, ELECTRONIC OR MECHANICAL, WITHOUT THE WRITTEN PERMISSION OF STUDIO A ARCHITECTS.

AD1.2

Project number: 18-KR-05-758
 Date: AUGUST 17, 2018

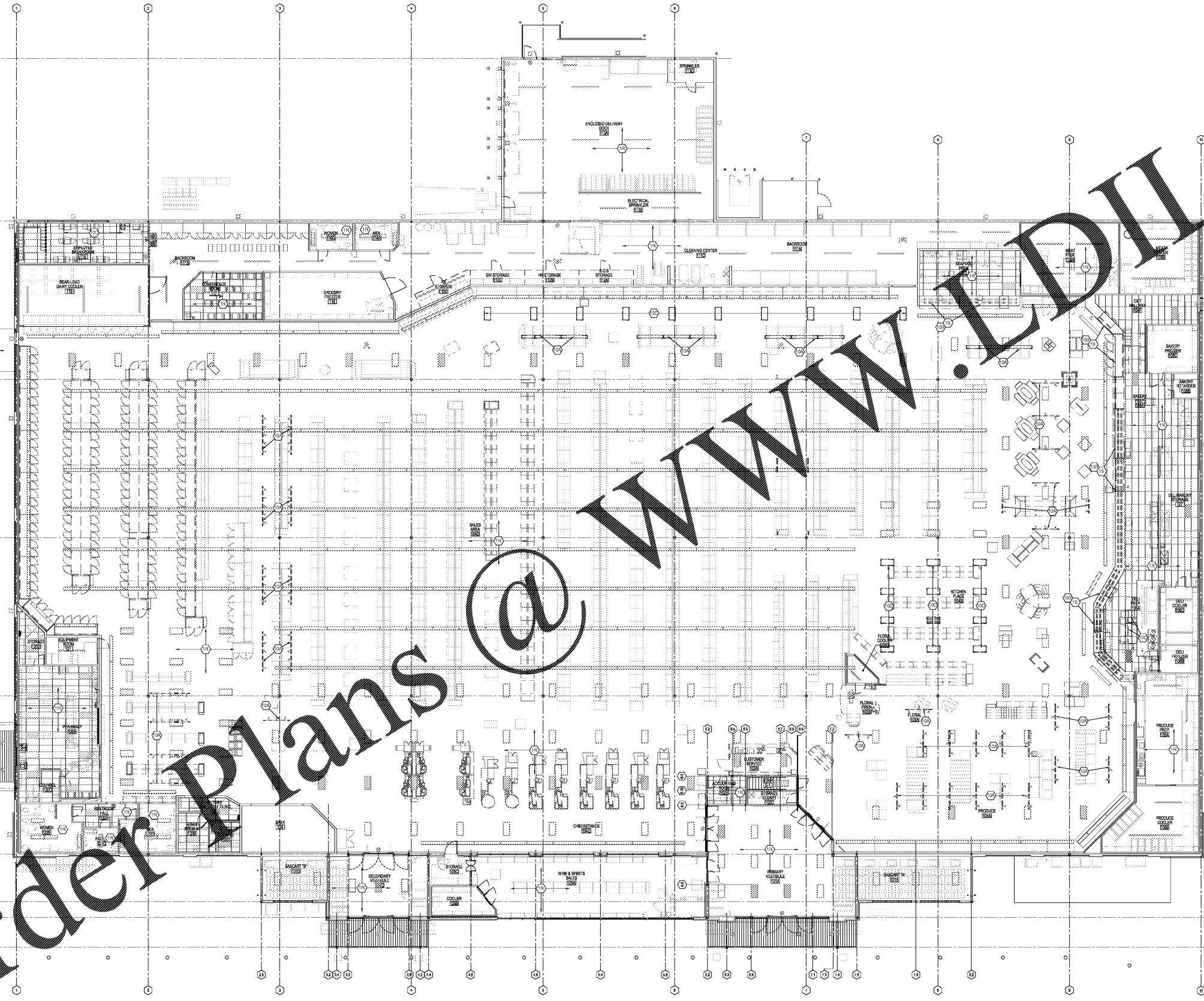

A
AD1.2
 MAIN LEVEL DEMOLITION REFLECTED CEILING PLAN
 SCALE: 3/32"=1'-0"

B
AD1.2
 ELEVATED OFFICE
 DEMOLITION REFLECTED CEILING PLAN
 SCALE: 3/32"=1'-0"

Order Plans @ www.LDLine.com