

Order Plans

GENERAL NOTES:

1. PROVIDE CONNECTIONS TO ALL THERMOSTATS. SEE MECHANICAL PLANS FOR DETAILS.
2. AHUS ARE ABOVE ACCESSIBLE CEILING THROUGHOUT.

LEGEND NOTES:

- ① COORDINATE MOUNTING LOCATION WITH MECHANICAL CONTRACTOR.
- ② THIS AREA TO BE PRICED AS AD-ALTERNATE (INCLUDES LIVING, KITCHEN, AND SLEEPING QUARTERS). VERIFY AREA WITH ARCHITECTURAL PLANS.

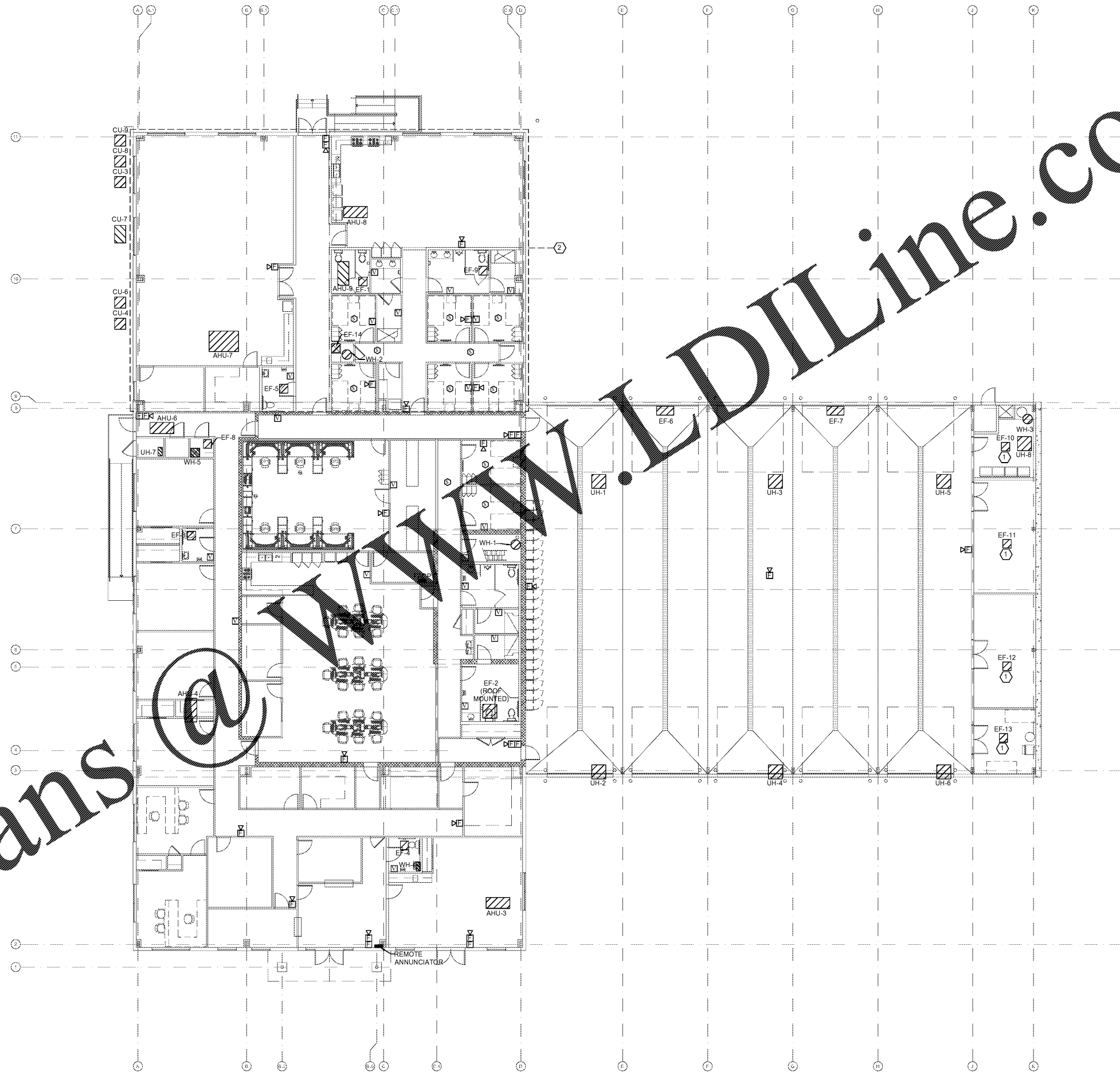

R DESIGN WORKS

FANNIN COUNTY:
722 Black Dog Trail
P.O. Box 639
Blue Ridge, GA 30513
Phone 706.374.4304

COBB COUNTY:
1490 Shiloh Road NW
Suite #300
Kennesaw, GA 30144
Phone 770.790.3655
Fax 770.790.3650

SAVANT Engineering, LLC

3064 Roswell Road, Suite D-301
Sandy Springs, GA 30342 770.319.7400
Project 16047 ©2016

TITLE: MECHANICAL EQUIP AND FIRE ALARM PLAN - ELECTRICAL

PROJECT: FANNIN CO. PUBLIC SAFETY COMPLEX
964 WINDY RIDGE ROAD
BLUE RIDGE, GA 30513

ISSUE:	REVISIONS:



DRAWN BY/ CHECKED BY:	DATE:
IJC/SWL	4.19.2017
PROJECT NO.	SHEET NO.:
1517	E-1.3

1 MECHANICAL EQUIP AND FIRE ALARM PLAN - ELECTRICAL
E1.3 SCALE: 3/32" = 1'-0"