



**R DESIGN WORKS**

FANNIN COUNTY:  
722 Black Dog Trail  
P. O. Box 639  
Blue Ridge, GA 30513  
Phone 706.374.4304

COBB COUNTY:  
1480 Shiloh Road NW  
Suite #300  
Kennesaw, GA 30144  
Phone 770.790.3655  
Fax 770.790.3650

**SAVANT Engineering, LLC**

3064 Roswell Road, Suite D-301  
Sandy Springs, GA 30342 770.319.7400  
Project 16047 ©2016

**SITE PLANS - ELECTRICAL**  
**FANNIN CO. PUBLIC SAFETY COMPLEX**  
**964 WINDY RIDGE ROAD**  
**BLUE RIDGE, GA 30513**

TITLE:

PROJECT:

ISSUE:

REVISIONS:

SEAL



DRAWN BY/

DATE:

JC/SWL

4.19.2017

PROJECT NO.

SHEET NO.:

1517

E-1.0

Copyright © 2016  
R Design Works

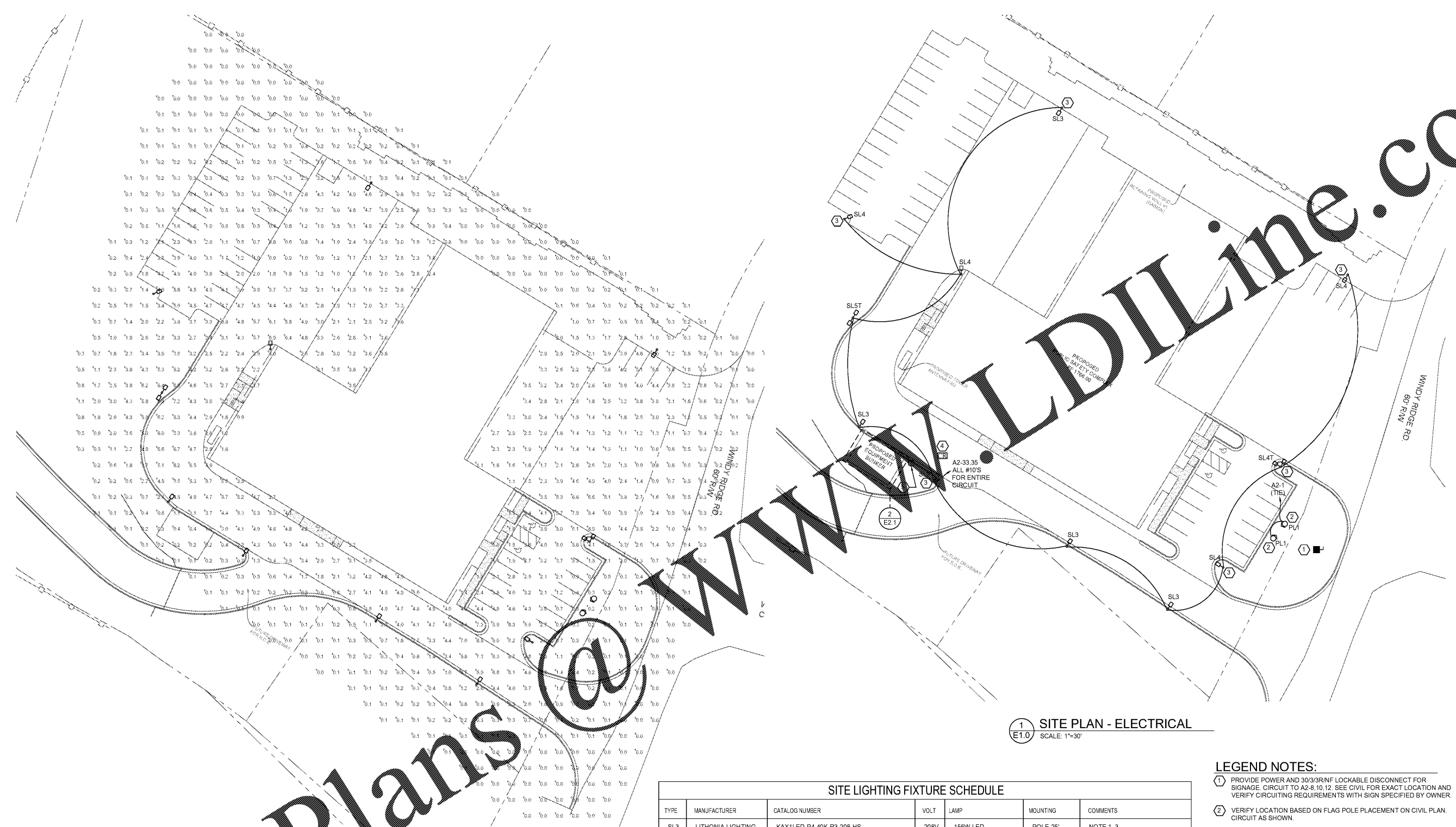

**1 SITE PLAN - ELECTRICAL**  
SCALE: 1"=30'

**2 SITE PLAN - PHOTOMETRICS**  
SCALE: 1"=30'

**SITE LIGHTING FIXTURE SCHEDULE**

TYPE	MANUFACTURER	CATALOG NUMBER	VOLT	LAMP	MOUNTING	COMMENTS
SL3	LITHONIA LIGHTING	KAX1LED-P4-40K-R3-208-HS	208V	156W LED	POLE-25'	NOTE 1, 3
SL4	LITHONIA LIGHTING	KAX1LED-P4-40K-R4-208-HS	208V	156W LED	POLE-25'	NOTE 1, 3
SL4T	LITHONIA LIGHTING	KAX1LED-P4-40K-R4-208-HS	208V	(2) 156W LED	POLE-25'	NOTE 1, 3, 4
SL5T	LITHONIA LIGHTING	KAX1LED-P4-40K-R5-208-HS	208V	(2) 156W LED	POLE-25'	NOTE 1, 3, 4
PL1	LITHONIA LIGHTING	DSXF1LED-1-40K-NSP-MVOLT	120V	19W LED	GROUND	NOTE 1, 2

**NOTES:**

1. FINISH SELECTED BY ARCHITECT.
2. AIM AT FLAG POLE.
3. PROVIDE WITH CONCRETE POLE BASE. POLE IS ALLOWED TO BE ROUND OR SQUARE, WHICHEVER IS LESS COSTLY.
4. DUAL HEADS AS SHOWN.

**LEGEND NOTES:**

1. PROVIDE POWER AND 30/3/BR/NF LOCKABLE DISCONNECT FOR SIGNAGE. CIRCUIT TO A2-8, 10, 12. SEE CIVIL FOR EXACT LOCATION AND VERIFY CIRCUITING REQUIREMENTS WITH SIGN SPECIFIED BY OWNER.
2. VERIFY LOCATION BASED ON FLAG POLE PLACEMENT ON CIVIL PLAN. CIRCUIT AS SHOWN.
3. PROVIDE WP GFCI DUPLEX OUTLET MOUNTED TO POLE. CIRCUIT TO A2-37 WITH ALL #10'S.
4. WP JUNCTION BOX FOR SPECIALTY CARD READER WITH BUZZER AND CAMERA TIED TO SECURITY SYSTEM IN 911 CENTER. CONNECT TO GATE CONTROLS AND CIRCUIT TO EB2-7. PROVIDE CONDUIT FOR ANY LOW VOLTAGE WIRE AS REQUIRED BY SECURITY CONSULTANT. VERIFY ADDITIONAL REQUIREMENTS AND LOCATION BASED ON GATE PLACEMENT. CARD READER AND LV WIRING INSTALLED BY OTHERS.
5. WP JUNCTION BOX FOR GATE TIED TO CARD READER. CIRCUIT GATE TO EB2-73 IF REQUIRED. IF GATE IS SOLAR POWERED, EC TO SUPPLY AND INSTALL ALL ELECTRICAL PROVISIONS NECESSARY FOR GATE TO FUNCTION. COORDINATE REQUIREMENTS WITH GC, OWNER, AND ARCHITECT. VERIFY EXACT LOCATION.

**GENERAL NOTES:**

1. BUILDING MOUNTED FIXTURES ARE INCLUDED IN PHOTOMETRICS, BUT ARE SHOWN ON BUILDING LIGHTING PLAN ON E-1.2.

Order Plans @