

REV.	DATE BY	DESCRIPTION
A	2017-11-03	10% CONCEPT DESIGN
B	2017-12-22	65% SUBMITTAL
C	2018-02-23	95% SUBMITTAL
D	2018-04-13	FOR CONSTRUCTION
E	2018-06-01	FOR CONSTRUCTION

**FLOOR FINISH GENERAL NOTES:**

- SUBMIT SHOP DRAWING LAYOUT INDICATING ALL FLOOR PATTERN LOCATIONS, GRAIN DIRECTION AND SEAMING LOCATIONS.
- INSTALL DIRECTIONAL FLOORING ORIENTED AS INDICATED ON THE FINISH PLANS. IF NOT INDICATED ON PLANS, REQUEST COR'S INPUT.
- CONDUCT MOISTURE TESTS ON ALL CONCRETE SLABS WHERE FINISH MATERIALS ARE SCHEDULED. RECORD PASSING MOISTURE LEVELS PRIOR TO START OF INSTALLATION. REFERENCE MANUFACTURER'S INSTALLATION SPECIFICATIONS FOR EACH FLOOR FINISH TYPE TO VERIFY REQUIREMENTS.
- IN THE EVENT OF HIGHLY ASH CONTENT CONCRETE (OVER 15% BY MASS) IN FLOOR FINISHES WITH ADHESIVES REQUIRES SCARIFYING OF CONCRETE PRIOR TO INSTALLATION.
- ALIGN TRANSITION OF FLOOR MATERIAL WITH CENTER OF DOOR. AT CASED OPENING, REFER TO FINISH PLANS FOR TRANSITION LOCATION.
- PROVIDE SUITABLE TRANSITION STRIPS AT ALL FLOORING JOINTS WITH DISSIMILAR MATERIALS.
- FLOOR TRANSITION STRIPS SHALL BE SUBMITTED TO COR FOR APPROVAL.
- PROVIDE BASE WITH PREFORMED OUTSIDE CORNERS. INSIDE CORNERS MAY BE PREFORMED OR FABRICATED FROM BASE MATERIALS MITERED.
- SEAL CONCRETE PRIOR TO INSTALLING FLOOR MATERIALS WITH MANUFACTURERS APPROVED SEALER.
- ADHESIVES, SEAM SEALERS AND CLEANERS TO BE AS RECOMMENDED BY THE MANUFACTURER.
- ADHESIVES SHALL BE WATER RESISTANT, MILDLY RESISTANT, NON-STAINING, NON-GASSING (LOW VOC) TYPE AS RECOMMENDED BY THE MANUFACTURER.
- ALL EXISTING AREAS DISTURBED BY CONSTRUCTION SHALL BE PATCHED AND REPAIRED TO MATCH SURROUNDING FINISHES.
- DEMO - REMOVE EXISTING FLOORING, ADHESIVE AND MASTIC AT ALL EXISTING FLOORING SCHEDULED FOR DEMOLITION. PATCH AND PREP SUBSTRATE TO MEET MANUFACTURER'S REQUIREMENTS FOR NEW FLOORING MATERIAL INSTALLATION. FLOAT SUBFLOOR AS NECESSARY TO ALIGN FINISHED SURFACE BETWEEN NEW FLOORING AND EXISTING TO REMAIN.

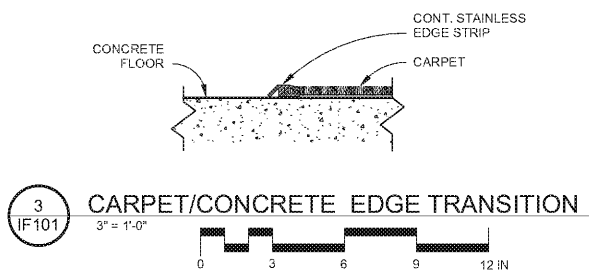
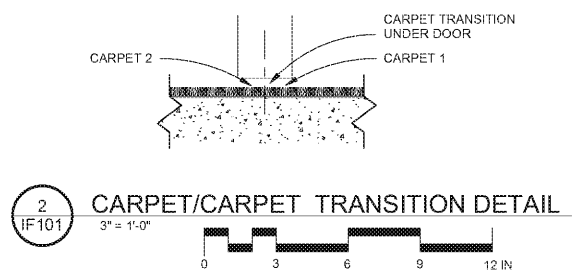

2 IF101 CARPET/CARPET TRANSITION DETAIL  
3" = 1'-0"

3 IF101 CARPET/CONCRETE EDGE TRANSITION  
3" = 1'-0"

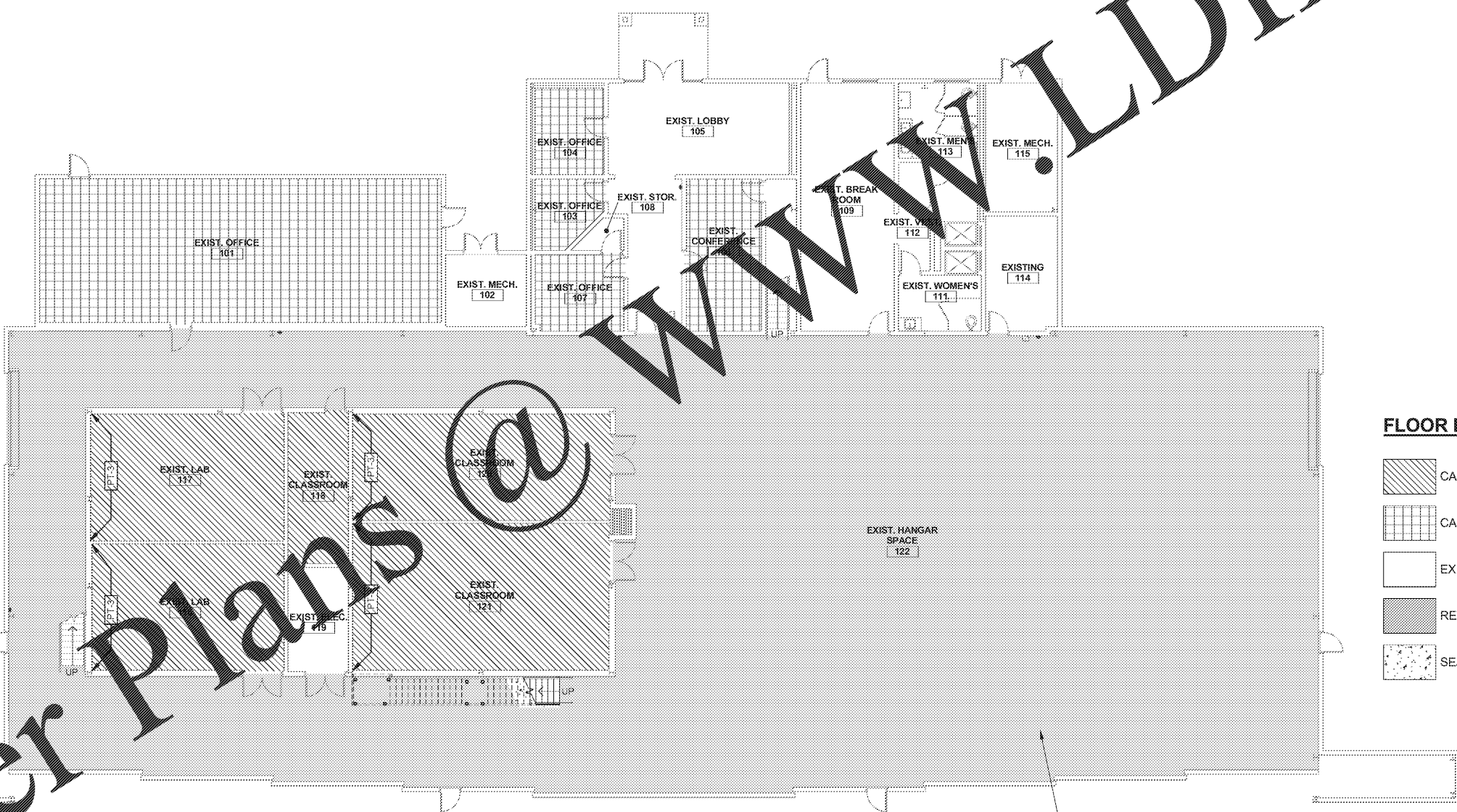

1 IF101 FLOOR & WALL FINISH PLAN - FIRST FLOOR  
3/32" = 1'-0"

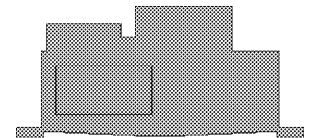

KEY PLAN

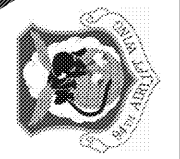

CIVIL ENGINEERING  
94th AIRLIFT WING  
DOBBINS AIR RESERVE BASE, GEORGIA

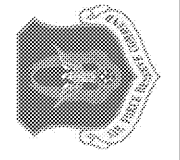

CROFT & ASSOCIATES  
3400 Blue Springs Road,  
Suite 200  
Kennesaw, GA 30144  
770.528.7744 (o)  
770.528.7168 (f)  
www.croftaa.com



Calculating...

PROJECT	REPAIR FACILITY & ADDITION
LOCATION	BUILDING 747 FGWB 08-0027 DOBBINS AIR RESERVE BASE, GEORGIA
DRAWING	FLOOR & WALL FINISH PLAN - FIRST FLOOR
CONTACT	PROJECT CONTACT: rob@crft.com

PROJECT No.	2017-238
PROJ. OFFICER	J. MORGAN
DESIGNED	M. GUNN
CHECKED	J. MORGAN
DATE	2018-06-01
DRAWING	29 OF 45

IF101

Order Plans @

WWW.LDILine.com