

REV.	DATE BY	DESCRIPTION
A	2017-11-03	10% CONCEPT DESIGN
B	2017-12-22	65% SUBMITTAL
C	2018-02-23	85% SUBMITTAL
D	2018-04-13	FOR CONSTRUCTION
E	2018-06-01	FOR CONSTRUCTION

- RCP LEGEND:**
- GWB CEILING
 - 2' x 2' ACT GRID
 - 2' x 2' PARABOLIC LIGHT
 - 2' x 4' PARABOLIC LIGHT
 - STRIP LIGHT
 - 2' x 2' SUPPLY REGISTER
 - 2' x 2' RETURN REGISTER

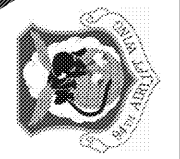

CIVIL ENGINEERING
94th AIRLIFT WING
 DOBBINS AIR RESERVE BASE, GEORGIA

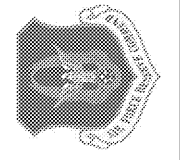

CROFT & ASSOCIATES
 3400 Blue Springs Road,
 Suite 200
 Marietta, GA 30144
 770.529.7744 (p)
 770.529.7168 (f)
 www.croftaa.com



REPAIR FACILITY & ADDITION
BUILDING 747
 FGWB 08-0027
 DOBBINS AIR RESERVE BASE, GEORGIA
REFLECTED CEILING PLAN - SECOND FLOOR -
CLASSROOM ADDITION
 PROJECT CONTRACT: 17-0132
 ROBERT.A.SMITH@us.af.mil

PROJECT	LOCATION	DRAWING	CONTACT
PROJECT No:	2017-238		
PROJ. OFFICER:	J. MORGAN		
DESIGNED:	M. GUNN		
CHECKED:	J. MORGAN		
DATE:	2018-06-01		
DRAWING 18	OF 45		

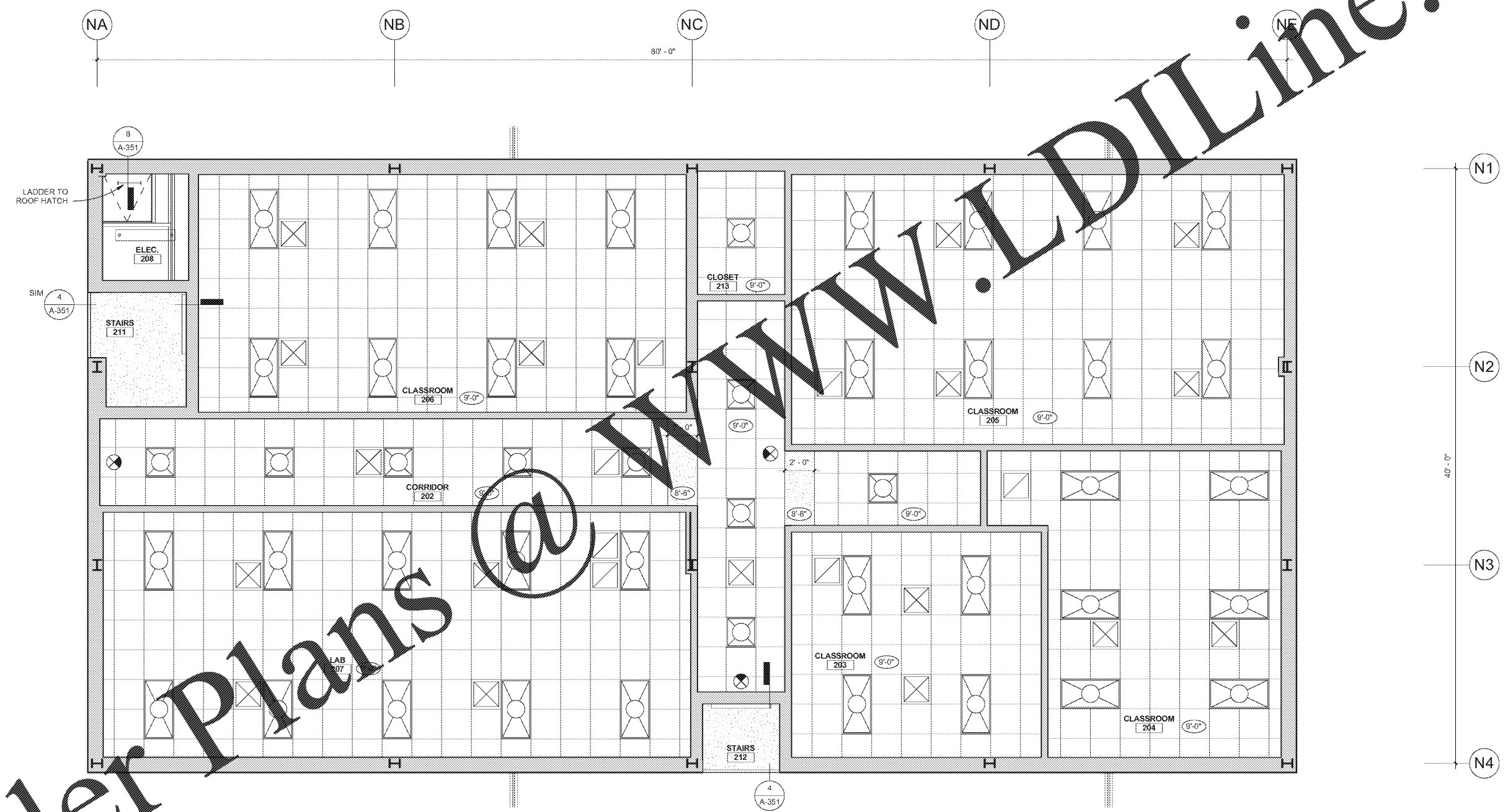

Order Plans @ www.WLDLine.com

1 REFLECTED CEILING PLAN - SECOND FLOOR
 A-131
 1/4" = 1'-0"

