

**GENERAL NOTES:**

- DO NOT SCALE DRAWINGS. USE DIMENSIONS ONLY.
- CONTRACTOR SHALL VERIFY ALL DIMENSIONS AND JOB CONDITIONS AND NOTIFY COR IMMEDIATELY OF DISCREPANCIES BEFORE PROCEEDING WITH THE WORK. DOORS SHALL BE LOCATED 4" FROM THE ADJACENT WALL, UNLESS NOTED OTHERWISE.
- DIMENSIONS ARE TO FACE OF GWB OR GRIDLINE U.N.O.
- INTERIOR PARTITIONS TO BE STC 49 MINIMUM.

**CONSTRUCTION DOCS.**

REV.	DATE	DESCRIPTION
A	2017-11-03	10% CONCEPT DESIGN
B	2017-12-22	65% SUBMITTAL
C	2018-02-23	95% SUBMITTAL
D	2018-04-13	FOR CONSTRUCTION
E	2018-06-01	FOR CONSTRUCTION



CIVIL ENGINEERING  
94th AIRLIFT WING  
DOBBINS AIR RESERVE BASE, GEORGIA



CROFT & ASSOCIATES  
3400 Blue Springs Road,  
Suite 200  
Kennesaw, GA 30144  
770.529.7744 (p)  
770.529.7168 (f)  
www.croftaa.com



REPAIR FACILITY & ADDITION  
BUILDING 747  
FGWB 08-0027  
DOBBINS AIR RESERVE BASE, GEORGIA  
OVERALL FLOOR PLAN - FIRST FLOOR  
PROJECT CONTACT:  
rob@croftaa.com

PROJECT	LOCATION	DRAWING	CONTACT
2017-238	J MORGAN	M. GUNN	J. MORGAN
2018-06-01	14	OF	45

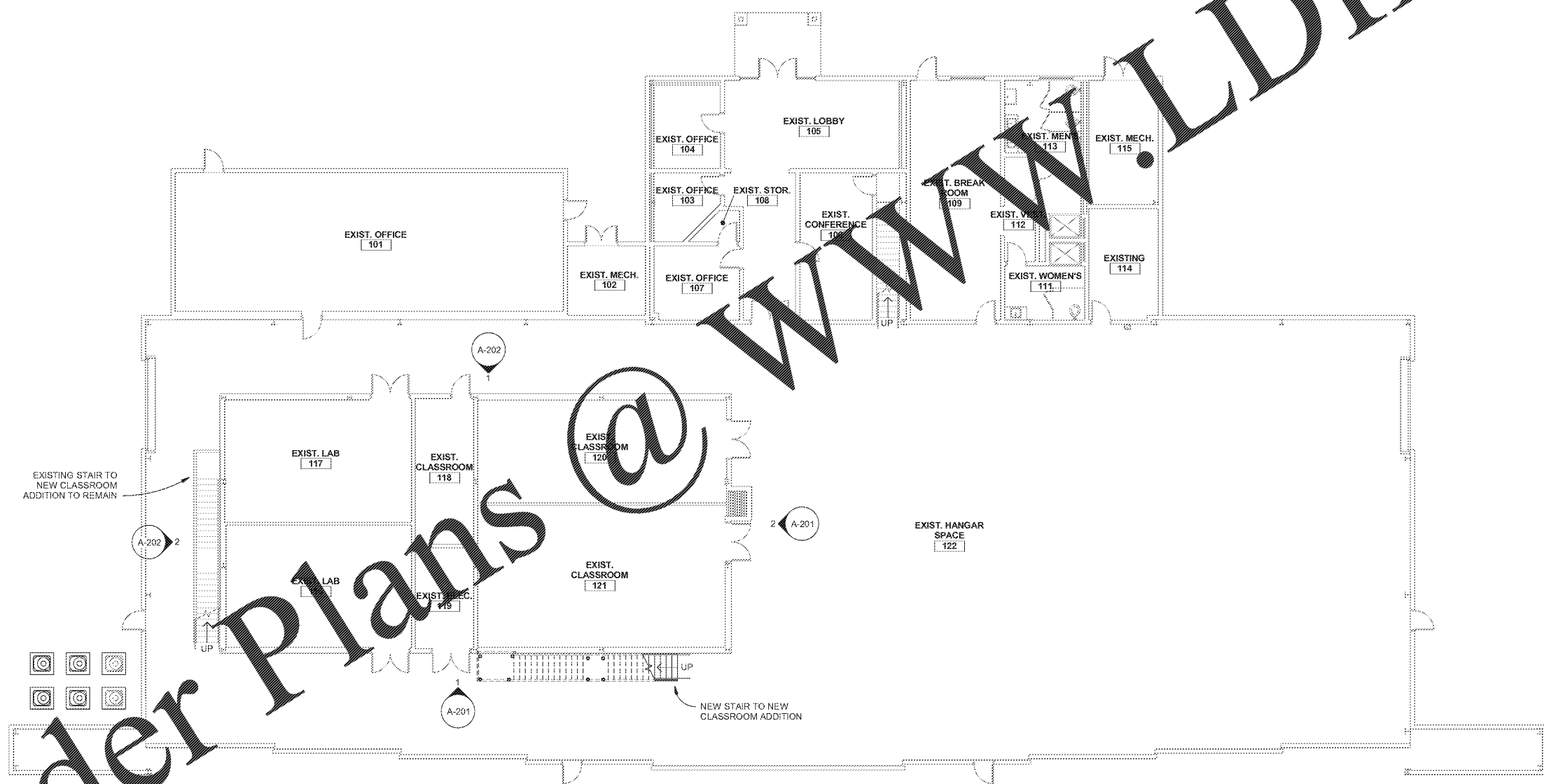

1  
A-101  
OVERALL FLOOR PLAN - FIRST FLOOR  
3/32" = 1'-0"  
0 5 10 25 FT  
PLAN NORTH

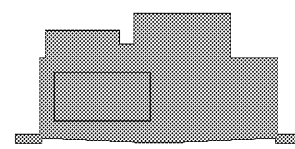

KEY PLAN