

LIFE SAFETY LEGEND:

- 1-HOUR FIRE RATED WALL
- 1-HOUR FIRE & SMOKE RATED WALL
- 2-HOUR FIRE RATED WALL
- 2-HOUR FIRE & SMOKE RATED WALL
- SMOKE RATED WALL
- EXIT SIGN
- FIRE ALARM PULL STATION
- FIRE ALARM STROBE
- FIRE ALARM HORN
- FIRE ALARM HORN/STROBE
- FIRE ALARM CONTROL PANEL
- SMOKE DETECTOR
- CO2 DETECTOR
- EMERGENCY LIGHT
- TRAVEL DISTANCE
- FIRE EXTINGUISHER & CABINET
- FIRE EXTINGUISHER & BRACKET
- DOOR RATING (MINUTES)
- TRAVEL DISTANCE TO FEC
- DOOR EGRESS LOAD
- P = PROVIDED R = REQUIRED

| REV. | DATE | DESCRIPTION |
|------|------------|------------------|
| B | 2017-12-27 | 65% SUBMITTAL |
| C | 2018-02-23 | 65% SUBMITTAL |
| D | 2018-04-13 | FOR CONSTRUCTION |
| E | 2018-06-01 | FOR CONSTRUCTION |

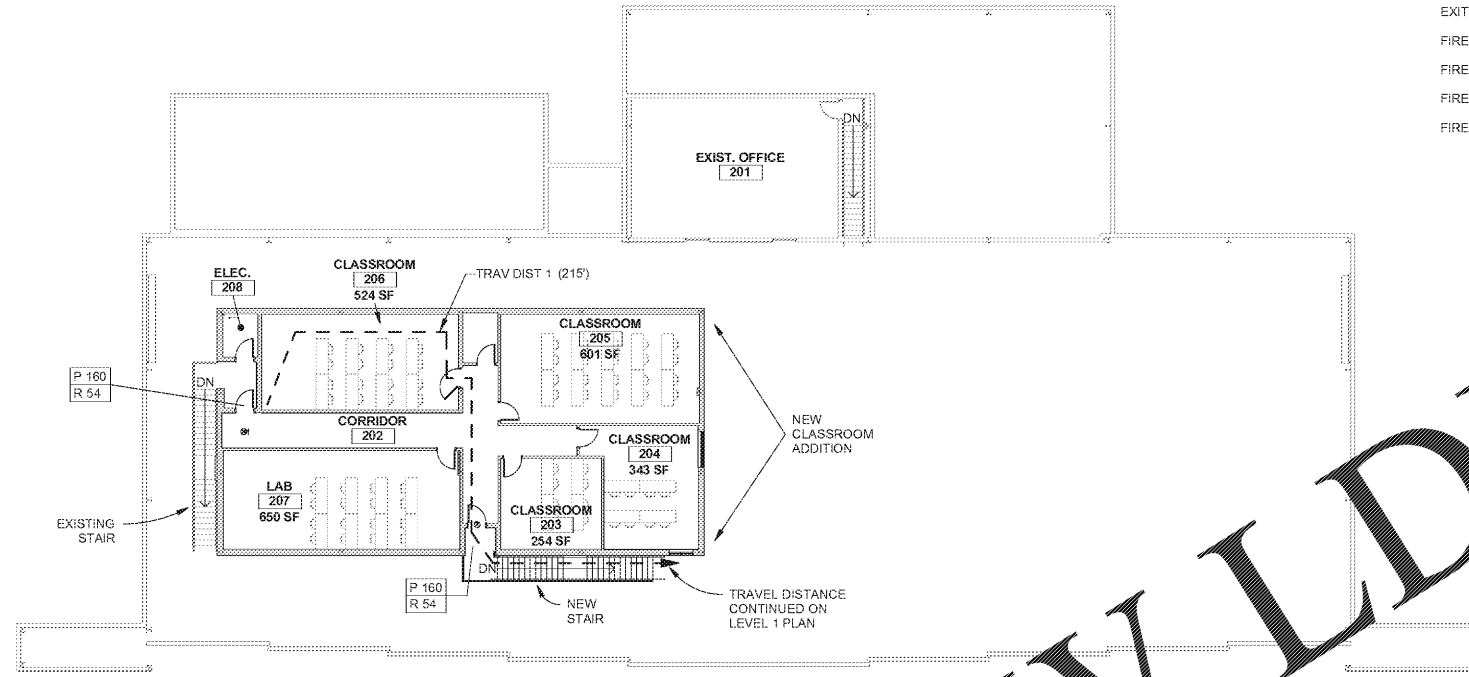

2 LIFE SAFETY PLAN - SECOND FLOOR
 1/16" = 1'-0"
 PLAN NORTH

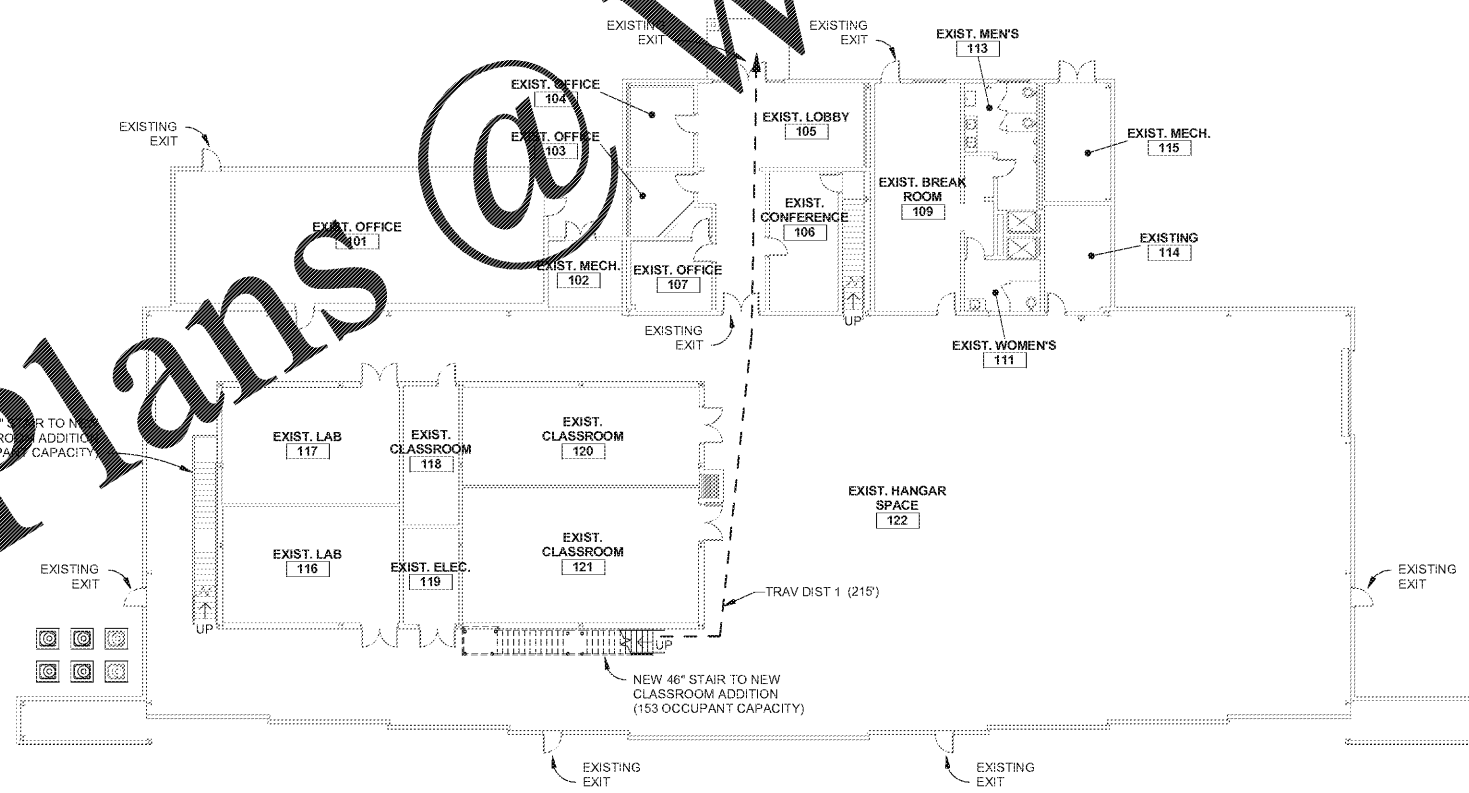

1 LIFE SAFETY PLAN - FIRST FLOOR
 1/16" = 1'-0"
 PLAN NORTH

NOTE:
 -LEVEL 1 IS EXISTING CONSTRUCTION
 -NEW STAIR TO NEW CLASSROOM ADDITION
 IS ONLY FLOOR PLAN CHANGE ON LEVEL 1

WWW.LDILine.com

CODE RESEARCH:

| THIS BUILDING IS SPRINKLERED PER NFPA 13 | | | | |
|---|--------------------------|-------------------------------|----------------|-----------|
| OCCUPANCY CLASSIFICATION & TYPE OF CONSTRUCTION | | | | |
| APPLICABLE CODE | OCCUPANCY CLASS. | | TYPE OF CONST. | |
| INTERNATIONAL BUILDING CODE 2015 EDITION | BUSINESS STORAGE GROUP B | GROUP S-1 | TYPE II-B | |
| NFPA 101 2012 EDITION | BUSINESS INDUSTRIAL | | TYPE II(000) | |
| HEIGHT / STORY(S) / AREA / PERIMETER PER IBC TABLE 503 (2015) | | | | |
| ALLOW. (WITHOUT INCREASES) | HEIGHT | STORY(S) | AREA | PERIM. |
| ALLOW. (INCREASES) | 55'-0" | 2 | 17500 SF | UNLIM. |
| PROVIDED | 75'-0" | 3 | 52500 SF | UNLIM. |
| | 1'-0" | 2 | 19300 SF | 750'-0" |
| SPRINKLER INCREASE | | FRONTAGE INCREASE | | |
| HEIGHT (+20'-0") | STORY (+1) | AREA (+200%) | NOT USED | |
| | | | | |
| TOTAL AREA INCREASE | | TOTAL HGT & STORY(S) INCREASE | | |
| SPRINK = 200% | IBC EQUATION 5-1 | ALLOW. | INCREASE | TOTAL |
| FRONT = NOT USED | Alt = 17500 SF | HGT = 55'-0" | +20'-0" | = 75'-0" |
| TOTAL = 200% | Alt = 52500 SF | STY = 2 | +1 | = 3 |
| OCCUPANT LOAD TABLE (LEVEL 1) | | | | |
| RM # | RM NAME | AREA | OCC. FACTOR | OCC. LOAD |
| 101 | EXIST. OFFICE | 1355 SF | 100 SF | 14 |
| 103 | EXIST. OFFICE | 98 SF | 100 SF | 1 |
| 104 | EXIST. OFFICE | 140 SF | 100 SF | 1 |
| 105 | EXIST. LOBBY | 389 SF | 7 SF | 56 |
| 106 | EXIST. CONFERENCE | 268 SF | 7 SF | 38 |
| 107 | EXIST. OFFICE | 158 SF | 100 SF | 2 |
| 108 | EXIST. STOR. | 27 SF | 500 SF | 0 |
| 109 | EXIST. BREAK ROOM | 546 SF | 7 SF | 78 |
| 116 | EXIST. LAB | 572 SF | 50 SF | 11 |
| 117 | EXIST. LAB | 577 SF | 50 SF | 12 |
| 118 | EXIST. CLASSROOM | 215 SF | 20 SF | 11 |
| 120 | EXIST. CLASSROOM | 646 SF | 20 SF | 32 |
| 121 | EXIST. CLASSROOM | 887 SF | 20 SF | 44 |
| 122 | EXIST. HANGAR SPACE | 10375 SF | 500 SF | 21 |
| | | 16252 SF | | 320 |
| OCCUPANT LOAD TABLE (LEVEL 2) | | | | |
| RM # | RM NAME | AREA | OCC. FACTOR | OCC. LOAD |
| 201 | EXIST. OFFICE | 808 SF | 100 SF | 8 |
| 203 | CLASSROOM | 254 SF | 20 SF | 13 |
| 204 | CLASSROOM | 343 SF | 20 SF | 17 |
| 205 | CLASSROOM | 601 SF | 20 SF | 30 |
| 206 | CLASSROOM | 524 SF | 20 SF | 26 |
| 207 | LAB | 650 SF | 50 SF | 13 |
| | | 3180 SF | | 107 |
| EXITS PROVIDED (LEVEL 1 - EXISTING) | | | | |
| SIZE | # OF DOORS | NUMBER OF OCCUPANTS | | |
| 3'-0" | 8 DOOR(S) @ 160 OCC/DR | = 1280 OCC. PROVIDED FOR | | |
| EXITS PROVIDED (LEVEL 2 NEW CLASSROOM) | | | | |
| SIZE | # OF DOORS | NUMBER OF OCCUPANTS | | |
| 3'-0" | 2 DOOR(S) @ 160 OCC/DR | = 320 OCC. PROVIDED FOR | | |
| TRAVEL DISTANCES | | | | |
| PATH | TOTAL DISTANCE | MAX | | |
| TRAV DIST 1 | 214'-4" | 300' | | |

CONSTRUCTION DOCS.

CIVIL ENGINEERING
 94th AIRLIFT WING
 DOBBINS AIR RESERVE BASE, GEORGIA

CROFT & ASSOCIATES
 3400 Blue Springs Road,
 Suite 200
 Marietta, GA 30144
 770.529.7144 (o)
 770.529.7148 (f)
 www.croft.com

STATE OF GEORGIA
 REGISTERED ARCHITECT
 ANTHONY W. CROFT

REPAIR FACILITY & ADDITION
 BUILDING 747
 FGWB 08-0027
 DOBBINS AIR RESERVE BASE, GEORGIA

LIFE SAFETY PLANS
 PROJECT CONTACT: robert.lind@us.af.mil

| | |
|---------------|------------|
| PROJECT No | 2017-238 |
| PROJ. OFFICER | J. MORGAN |
| DESIGNED | M. GUNN |
| CHECKED | J. MORGAN |
| DATE | 2018-06-01 |
| DRAWING | 3 OF 45 |

LS101