

WALL SECTION NOTES

- 1 5 RIB V-GROOVE METAL ROOF
- 2 3/4" TONGUE AND GROOVE APA RATED EXT. PLYWOOD SHEATHING, SEE STRUCT.
- 3 RAFTERS - SEE STRUCT.
- 4 CONTINUOUS STORMGUARD WATER & ICE SHIELD UNDER ENTIRE METAL ROOFING & UP PARAPET WALL. SECURE UNDER METAL COPING.
- 5 EXTEND WALL UP TO SHEATHING BETWEEN EACH RAFTER
- 6 DRIP EDGE
- 7 5/4" CEDAR FASCIA - PAINT GREEN
- 8 1/2" CEDAR SOFFIT, PRE-FINISHED STAIN
- 9 PAINT BLACK
- 10 WINDOW, SEE WINDOW SCHEDULE
- 11 3/4" PLYWOOD FULL WIDTH OF LADDER, FULL HEIGHT OF WALL
- 12 BRICK ROWLOCK SILL - SLOPE FOR POSITIVE DRAINAGE
- 13 METAL FLASHING
- 14 TYVEK DRAINWRAP UP TO 9'-0" A.F.F. TAILOR W/ VENT & WATERSHIELD ABOVE. LAP OVER TYVEK 4" AT TRANSITION
- 15 1/2" PLYWOOD
- 16 BRICK VENEER, RUNNING BOND
- 17 WEEPS, SEE SPECIFICATIONS
- 18 GROUT SOLID
- 19 PRESSURE TREATED MINIMAL 2X FLOOR FRAMING AT 24" O.C.
- 20 3/4" PLYWOOD SHEATHING, GLUE & SCREWED
- 21 FLOOR FINISH MATERIAL, SEE ROOM FINISH SCHEDULE
- 22 WALL BASE, SEE ROOM FINISH SCHEDULE, SHEET A-610
- 23 1/2" GYP. IM BOND
- 24 1X8 BEVEL CEDAR SIDING, WITH 6" EXPOSURE, STAIN
- 25 SIGNAGE, SEE SIGN DRAWINGS
- 26 FOUNDATION INSULATION NOTE
- 27 NOMINAL 1X4 FURRING AT 24" O.C.
- 28 BLOCKING
- 29 FOUNDATION INSULATION, 2" AT FOOTING, 1" AT FOUNDATION THERMAL BREAK
- 30 WALL FINISH, SEE FFE SHEETS
- 31 NOMINAL 2X4 FRAMING AT 16" O.C.
- 32 METAL RIDGE FLASHING
- 33 1/2" PLYWOOD ROUGH SAWN FINISH, BATTEN STRIPS AT EACH JOINT
- 34 NOMINAL 2X CONTINUOUS LEDGER, SEE STRUCT.
- 35 WHITE LED - SEE SIGN DRAWINGS
- 36 5/4" X 6" CEDAR TRIM - PAINT GREEN
- 37 BLOCKING - SEE STRUCTURAL
- 38 METAL COPING CAP - GALVANIZED FLASHING PRIMED & PAINTED GREEN
- 39 VERTICAL CEDAR SIDING, STAIN
- 40 50 MIL SINGLE PLY PVC ROOF MEMBRANE - TURN UP WALL TO BOTTOM OF OVERHANG AND SECURE UNDER CAP FLASHING. AT WALLS HIGHER THAN 60" SECURE MEMBRANE WITH MECHANICAL FASTENERS PER MANUFACTURER.
- 41 WRAP BEAM WITH 5/4" CEDAR TRIM, STAIN
- 42 JOHNS MANVILLE ENR0Y3, 4" RIGID INSULATION
- 43 5/8" APA RATED EXT PLYWOOD SHEATHING
- 44 5/4" X 5" CEDAR WOOD TRIM
- 45 COLUMN, (PAINT ALL EXPOSED AREAS BLACK) - SEE STRUCT.
- 46 5/4" X 4" CEDAR WOOD TRIM
- 47 5/4" CEDAR WOOD TRIM
- 48 5" METAL GUTTER, COLOR TO MATCH WOOD TRIM
- 49 BEAM, (PAINT ALL EXPOSED AREAS BLACK) - SEE STRUCT.
- 50 26 GA. 2-1/2" EXPOSED CORRUGATED METAL PANELS, GALV.
- 51 2X8 PINE CAP (EASE EDGE)
- 52 LIGHT FIXTURE, SEE ELECTRICAL
- 53 WOOD TRUSS - SEE STRUCTURAL
- 54 NOMINAL 2X4 FIRESTOP AT CEILING LINE
- 55 ACOUSTICAL CEILING, SEE FINISH SCHEDULE
- 56 VAPOR BARRIER
- 57 DOOR, SEE DOOR SCHEDULE
- 58 SILICONE SEALANT
- 59 CONTINUOUS RIDGE VENT
- 60 5/4X4" CEDAR TRIM - PAINT GREEN
- 61 10"X10" VENTILATION LOUVER BEYOND AT EACH END
- 62 NOMINAL 2X JOISTS - SEE STRUCT.
- 63 6" KRAFT FACED BATT INSULATION, PAPER FACE TO BUILDING INTERIOR
- 64 4" WIDE X CONT. SOFFIT VENT WITH INSECT SCREEN
- 65 CONCRETE FOOTING - SEE STRUCT.
- 66 HEADER, SEE STRUCT.
- 67 NOMINAL 2X6 STUDS AT 16" O.C.
- 68 NOMINAL 2X4 STUDS AT 16" O.C.
- 69 THRESHOLD, SEE DOOR SCHEDULE
- 70 1/2" MOISTURE RESISTANT GYP. BD.
- 71 CERAMIC WALL TILE - SEE ROOM FINISH SCHEDULE, A-610
- 72 24X30 ACCESS OPENING WITH WALK OFF MAT-RUN UP & SECURE TO WALL WITH TERMINATION BAR
- 73 CONCRETE SLAB, SEE STRUCTURAL
- 74 BLOCKING FOR SEATING, LOCATE AS SHOWN ON FFE SHEETS
- 75 1/2" AIR GAP MAX.
- 76 BRICK ANGLE, SEE STRUCT.
- 77 FIBERGLASS REINFORCED PLASTIC (FRP) PANELS
- 78 4X8X16 SOLID BLOCK - SEE STRUCT.
- 79 DECORATIVE RAFTERS AT 24" O.C., SEE RCP
- 80 ADD BLOCKING AS REQUIRED FOR SUPPORT OF SURFACE MOUNTED TV - SEE EQ/FFE, SEE ELECT.
- 81 NEOPRENE JOINT FILLER
- 82 CONTINUOUS FLASHING AROUND SCUPPER
- 83 8"X12" METAL OVERFLOW SCUPPER
- 84 3"X8" SCUPPER OPENING, PROVIDE MEMBRANE FLASHING ALL SIDES
- 85 PROVIDE STAINLESS STEEL CAP AROUND ENTIRE OPENING AND ABOVE BRICK ROWLOCK
- 86 ROWLOCK COURSE
- 87 ACTUAL 6X6 TREATED CEDAR POST
- 88 1/2" CEMENT BOARD 18" HIGH
- 89 1 1/2" X 1/2" METAL FURRING CHANNELS
- 90 BRICK TIES
- 91 CONT. 6" METAL SLIP TRACK - SEE STRUCT.
- 92 6" METAL STUDS - SEE STRUCT.
- 93 NEW CONT. METAL STUD TRACK, SEE STRUCT.
- 94 8"X8"X16" SLIP TRACK CMU
- 95 BILCO "TYPE NB" 2'-6" X 3'-0" ROOF HATCH FURNISHED AND INSTALLED BY GC - PAINT BLACK
- 96 CURB WITH INTERGRAL CAP FLASHING
- 97 PROVIDE BLOCKING AS REQUIRED TO SECURE HATCH TO ROOF STRUCTURE
- 98 ROOF DRAIN, SEE PLUMBING FOR CONTINUATION.
- 99 1/2X2 1/2" STEEL LADDER BRACKETS - WELD TO SIDE RAILS & BOLT TO WALL WITH 2 3/8" DIA LAG BOLTS, BRACKET TO RUN IN.
- 100 3/4" DIA. STEEL RUNGS - WELD TO SIDE RAILS AT 12" O.C.
- 101 1/2" X 1/2" STEEL SIDE RAILS WITH EASED EDGES
- 102 SECURE LADDER TO FLOOR WITH 3"X3"X1/4" STEEL ANGLE WITH 3/4" DIA. EXPANSION BOLTS, 4" LONG
- 103 5/4"X4" CEDAR TRIM, PREFINISHED, STAIN
- 104 CONT. 2X6 DIAPHRAGM CHORD AROUND PERIMETER OR ROOF - SEE STRUCT.
- 105 NOMINAL 4X4 CEDAR SILL, CHAMFERED
- 106 6" THICK STYROFOAM TYPE IV INSULATION, SQUARE EDGE
- 107 SNO-GEN JR SNOW GUARDS, TYPICAL SLOPED ROOFS, SEE ROOF PLAN
- 108 NOMINAL 2X4 CROSS BRACING AT 16.0 C.
- 109 NOMINAL 2X10 CONTINUOUS



400 N. Ashley Dr.,
Ste. 600
Tampa, FL 33602
P: 813-323-9233
Lic. #: AA-0003590
W: www.bdgllp.com

TEXAS ROADHOUSE
1203 VANN DRIVE
JACKSON, TENNESSEE

BID SET 8/27/2018

THESE DRAWINGS AND PLANS ARE THE PROPERTY OF BGD ARCHITECTS AND ARE NOT TO BE REPRODUCED, COPIED, OR USED IN ANY MANNER WITHOUT THE EXPRESS WRITTEN PERMISSION OF BGD ARCHITECTS. ANY REPRODUCTION OR USE OF THESE DRAWINGS FOR CONSTRUCTION SHALL BE CONSIDERED ACCEPTANCE OF THE TERMS CONTAINED HEREIN AND THE WRITTEN APPROVAL OF BGD ARCHITECTS. ANY CHANGES TO THESE PLANS SHALL BE MADE BY BGD ARCHITECTS. BGD ARCHITECTS SHALL NOT BE RESPONSIBLE FOR ANY DISCREPANCIES OR OMISSIONS ARISING OUT OF OR RELATED TO THESE PLANS. ANY DISCREPANCIES OR OMISSIONS IN THESE PLANS SHALL BE REFERRED IMMEDIATELY TO BGD ARCHITECTS FOR CORRECTION. BGD ARCHITECTS SHALL NOT BE RESPONSIBLE FOR ANY DAMAGES OR LOSSES ARISING OUT OF OR RELATED TO THESE PLANS. BGD ARCHITECTS SHALL NOT BE RESPONSIBLE FOR ANY DAMAGES OR LOSSES ARISING OUT OF OR RELATED TO THESE PLANS. BGD ARCHITECTS SHALL NOT BE RESPONSIBLE FOR ANY DAMAGES OR LOSSES ARISING OUT OF OR RELATED TO THESE PLANS.

ISSUE	BY	DATE	DESCRIPTION

Architect of Record
Chris G. Kirschner, AIA, LEED AP
TN License # 103505

PROJECT INFORMATION BLOCK			
JOB #	188002	DATE	08-01-2018
DRAWN BY:	RC	CHECKED BY:	SS

SHEET TITLE	
WALL SECTIONS	
SHEET NUMBER	

A-310

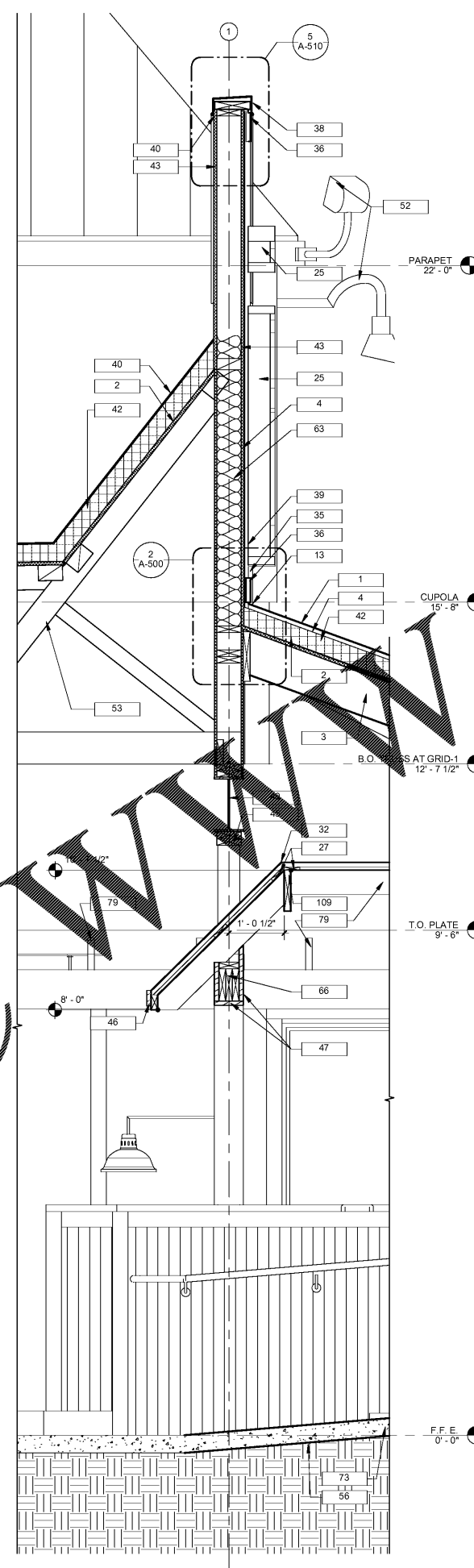

2 WALL SECTION
3/4" = 1'-0"

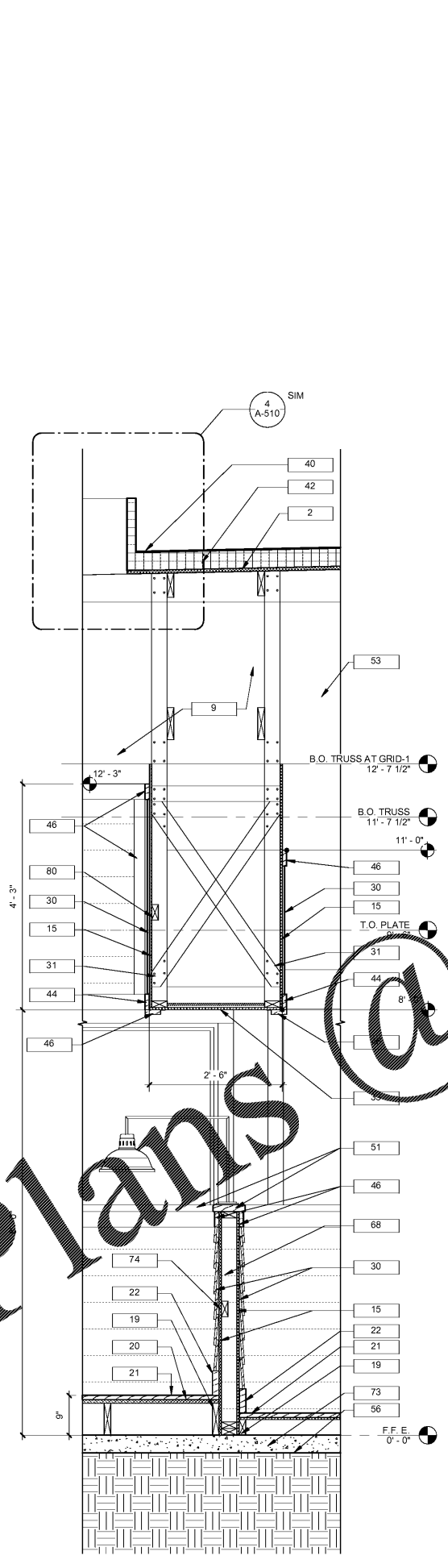

3 WALL SECTION
3/4" = 1'-0"

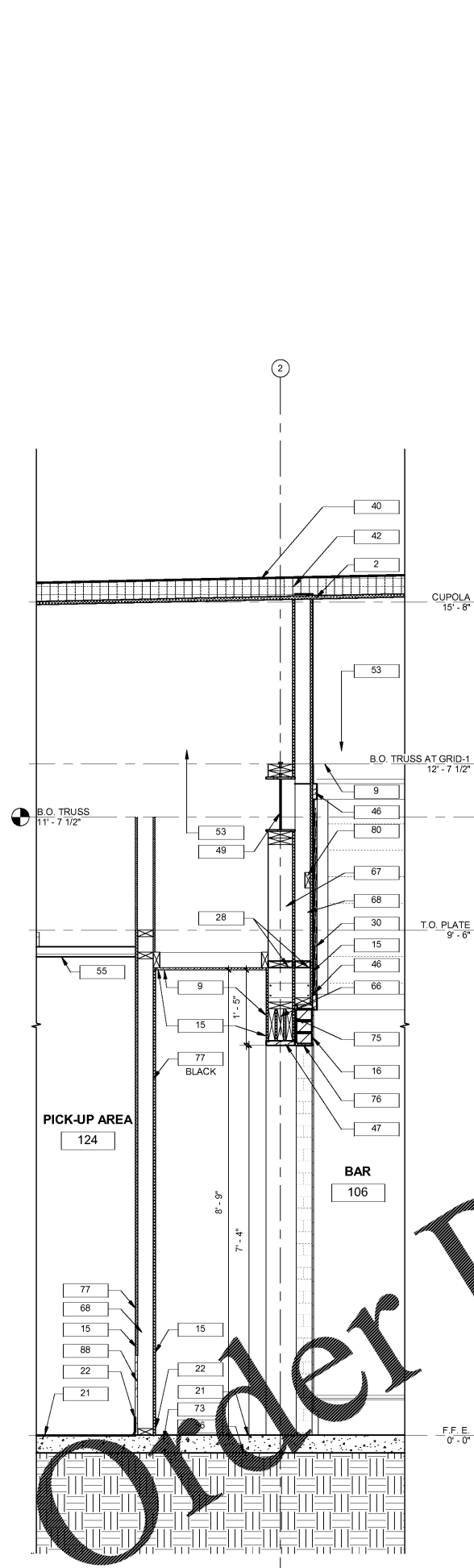

4 WALL SECTION
3/4" = 1'-0"

Order Plans @