

GEORGIA

UNIFORM CODING SYSTEM

 FOR SOIL EROSION AND SEDIMENT CONTROL PRACTICES

 GEORGIA SOIL AND WATER CONSERVATION COMMISSION

STRUCTURAL PRACTICES

CODE	PRACTICE	DETAIL	MAP SYMBOL	DESCRIPTION
C	CONCRETE			A small temporary barrier or dam constructed across a road, drainage ditch or area of concentrated flow.
Ch	CONCRETE CHANNEL			Improving, constructing or stabilizing an open channel, existing stream, or ditch.
Co	CONSTRUCTION FENCE			A graded stone pile located at the construction site wall to provide a place for removing mud from tires thereby protecting public areas.
D	DEFENSE			An earth channel or ditch located above, below or across a slope to divert runoff. This may be a temporary or permanent structure.
Ds	DEFENSE STRUCTURE			A flexible curtain of heavy-duty fabric or other material designed to safely conduct surface runoff down a slope. This is temporary and inoperative.
Fi	FILTER RING			A temporary stone barrier constructed at storm drain inlets and pond outlets.
Rd	ROAD FLUX DIV			A permanent or temporary stone filter dam installed across small streams or drainages.
Ri	REMOVAL FILLING			A device or structure placed in front of a permanent stormwater detention pond outlet structure to serve as a temporary sediment filter.
Sd	SEDIMENT BARRIER			A barrier to prevent sediment from leaving the construction site. It may be made of a bank of stone or hay, brush, logs and poles, posts, or a silt fence.
Su	SILT TRAP			An impounding area created by excavating around a storm drain trap line. The excavated area will be filled and stabilized on completion of construction activities.
Sb	SEDIMENT BASIN			A basin created by excavation or a dam across a roadway, surface water runoff temporarily stored allowing the bulk of the sediment to drop out.
Sa	TEMPORARY SEDIMENT TRAP			A small temporary pond that drains around a storm drain trap line. The principle feature distinguishing a temporary sediment trap from a temporary sediment basin is the lack of a pipe or riser.
Sk	SKIMMER			A bypass device that receives/draws water from the surface of sediment ponds, traps, or basins at a controlled rate of flow.
St	STORMWATER OUTLET PROTECTION			A paved or short section of riprap channel at the outlet of a storm drain equipped with permanent erosion and sediment control measures as indicated on this plan.
Su	SURFACE REPAIR			A rough soil surface with horizontal depressions on a contour or slopes left in a roughened condition after grading.
Tc	TURBIDITY CURTAIN			A floating or stacked barrier installed within the water (It may also be referred to as a floating boom, sill barrier, or sill curtain).
Tr	TREE PROTECTION			To protect desirable trees from injury during construction activities.

VEGETATIVE PRACTICES

CODE	PRACTICE	DETAIL	MAP SYMBOL	DESCRIPTION
Bi	BARRIER			Strip of undisturbed original vegetation, enhanced or restored existing vegetation or the reestablishment of vegetation surrounding an area of disturbance or working stream.
Dd1	DEFERRED AREA REVEGETATION WITH MULCH			Establishing temporary protection for disturbed areas where seedlings may not have a suitable growing season to produce an erosion retaining cover.
Dd2	DEFERRED AREA REVEGETATION WITH MULCH AND SEED			Establishing a temporary vegetative cover with fast growing seedlings on disturbed areas.
Dd3	DEFERRED AREA REVEGETATION WITH PERMANENT PLANTING			Establishing a permanent vegetative cover on disturbed areas.
Dd4	DEFERRED AREA REVEGETATION WITH PERMANENT PLANTING AND MULCH			A permanent vegetative cover using seeds on highly erodible or critically eroded lands.
Du	DIET CONTROL ON BARRIERS			Controlling surface and air movement of dust on construction site, roadways and similar sites.
Fl-Co	FLOODWAYS AND CHANNELS			Substance formulated to assist in the solid/liquid separation of suspended particles in runoff.
Ss	SLOPE STABILIZATION			A protective covering used to prevent erosion and establish temporary or permanent vegetation on steep slopes, shore lines, or channels.
Tac	TACKERS AND BINDERS			Substances used to anchor straw or hay matting by coating the organic material to bind together.

LEGEND

	DISTURBED AREA LIMITS
	DOUBLE ROW TYPE 'S' SILT FENCE
	SLOPE STABILITY MATTING. CONTRACTOR SHALL PLACE AS SOON AS SLOPE IS CONSTRUCTED AND SHALL REMAIN PERMANENTLY HYDRATED AND TACKERS SHALL BE APPLIED IN CONJUNCTION WITH MATTING.

3011 SUTTON GATE DRIVE

 SUWANEE, GA 30080

 TEL: (770) 274-9000

 FAX: (770) 251-2243

 www.clarkpatterson.com

SOUTH TRANSPORTATION & MAINTENANCE FACILITY

 FACILITIES AND TRANSPORTATION SERVICES DEPARTMENT

 FULTON COUNTY, GEORGIA

 FULTON COUNTY BOARD OF EDUCATION

S.Y. RICHARDS, ARCHITECT, INC.

 GEORGIA

 MONROE

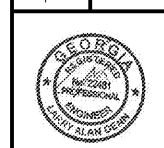

SHEET TITLE:

FINAL PHASE ESCP PLAN

DATE:

 June 22, 2018

DRAWING NO:

 /

SHEET:

C-10E

OF:

 PROPOSAL

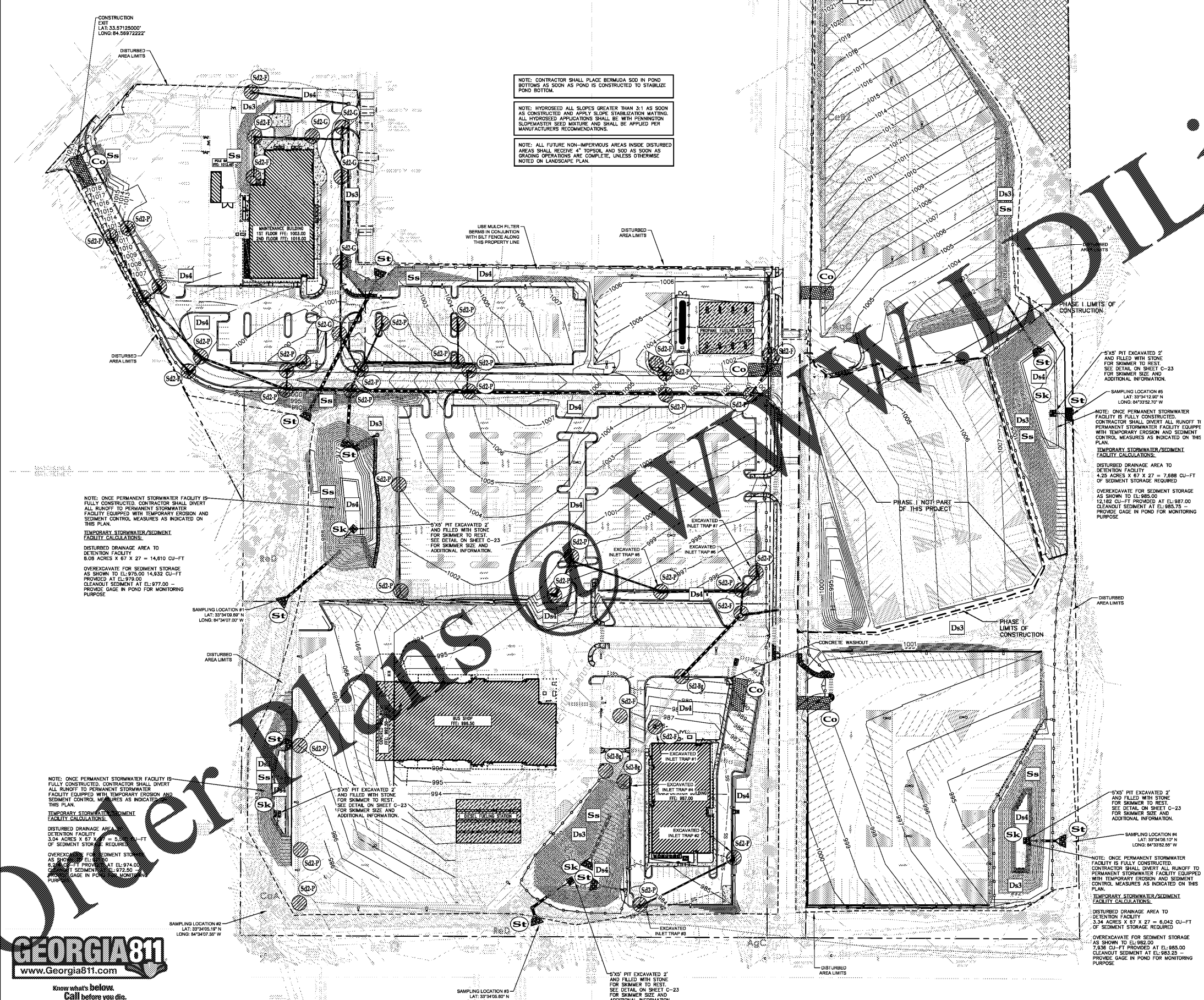

NOTE: CONTRACTOR SHALL PLACE BERMUDA SOD IN POND BOTTOMS AS SOON AS POND IS CONSTRUCTED TO STABILIZE POND BOTTOM.

 NOTE: HYDROSEED ALL SLOPES GREATER THAN 3:1 AS SOON AS CONSTRUCTED AND APPLY SLOPE STABILIZATION MATTING. ALL HYDROSEED APPLICATIONS SHALL BE WITH PENNONTON SLOPEMASTER SEED MIXTURE AND SHALL BE APPLIED PER MANUFACTURERS RECOMMENDATIONS.

 NOTE: ALL FUTURE NON-IMPERVIOUS AREAS INSIDE DISTURBED AREAS SHALL RECEIVE 4" TOPSOIL AND SOD AS SOON AS GRADING OPERATIONS ARE COMPLETE, UNLESS OTHERWISE NOTED ON LANDSCAPE PLAN.

CONSTRUCTION EXIT

 T.S. 83.6712000' N

 LONG: 84.5897222' W

NOTE: ONCE PERMANENT STORMWATER FACILITY IS FULLY CONSTRUCTED, CONTRACTOR SHALL DIVERT ALL RUNOFF TO PERMANENT STORMWATER FACILITY EQUIPPED WITH TEMPORARY EROSION AND SEDIMENT CONTROL MEASURES AS INDICATED ON THIS PLAN.

 TEMPORARY STORMWATER/SEDIMENT FACILITY CALCULATIONS:

 DISTURBED DRAINAGE AREA TO DETENTION FACILITY

 6.08 ACRES X 67 X 27 = 14,810 CU-FT

 OVEREXCAVATE FOR SEDIMENT STORAGE AS SHOWN TO EL: 975.00

 PROVIDED AT EL: 978.00

 CLEANOUT SEDIMENT AT EL: 977.00

 PROVIDE GAGE IN POND FOR MONITORING PURPOSE

NOTE: ONCE PERMANENT STORMWATER FACILITY IS FULLY CONSTRUCTED, CONTRACTOR SHALL DIVERT ALL RUNOFF TO PERMANENT STORMWATER FACILITY EQUIPPED WITH TEMPORARY EROSION AND SEDIMENT CONTROL MEASURES AS INDICATED ON THIS PLAN.

 TEMPORARY STORMWATER/SEDIMENT FACILITY CALCULATIONS:

 DISTURBED DRAINAGE AREA TO DETENTION FACILITY

 3.04 ACRES X 67 X 27 = 5,260 CU-FT

 OVEREXCAVATE FOR SEDIMENT STORAGE AS SHOWN TO EL: 970.00

 PROVIDED AT EL: 974.00

 CLEANOUT SEDIMENT AT EL: 972.50

 PROVIDE GAGE IN POND FOR MONITORING PURPOSE

SAMPLING LOCATION #2

 LAT: 33°45'18" N

 LONG: 84°34'07" W

SAMPLING LOCATION #3

 LAT: 33°45'18" N

 LONG: 84°34'12" W

Order Plans

ORDER PLANS

Order Plans

ORDER PLANS

ORDER PLANS