

**GEORGIA
UNIFORM CODING SYSTEM**
FOR SOIL EROSION AND SEDIMENT CONTROL PRACTICES
GEORGIA SOIL AND WATER CONSERVATION COMMISSION

STRUCTURAL PRACTICES				STRUCTURAL PRACTICES					
CODE	PRACTICE	DETAIL	MAP SYMBOL	DESCRIPTION	CODE	PRACTICE	DETAIL	MAP SYMBOL	DESCRIPTION
Sd1	SEDIMENTATION			A temporary sedimentation basin or structure designed to capture sediment from runoff before it enters a stream, ditch, or water body.	Sd2	SEDIMENTATION			A temporary sedimentation basin or structure designed to capture sediment from runoff before it enters a stream, ditch, or water body.
Ds1	DESIGNATED			A temporary slope or structure designed to stabilize a slope or structure during construction.	Ds2	DESIGNATED			A temporary slope or structure designed to stabilize a slope or structure during construction.
Du1	DESIGNATED			A temporary structure designed to stabilize a slope or structure during construction.	Du2	DESIGNATED			A temporary structure designed to stabilize a slope or structure during construction.
Ds3	DESIGNATED			A temporary structure designed to stabilize a slope or structure during construction.	Ds4	DESIGNATED			A temporary structure designed to stabilize a slope or structure during construction.
Du3	DESIGNATED			A temporary structure designed to stabilize a slope or structure during construction.	Du4	DESIGNATED			A temporary structure designed to stabilize a slope or structure during construction.
Ds4	DESIGNATED			A temporary structure designed to stabilize a slope or structure during construction.	Du4	DESIGNATED			A temporary structure designed to stabilize a slope or structure during construction.

VEGETATIVE PRACTICES				
CODE	PRACTICE	DETAIL	MAP SYMBOL	DESCRIPTION
Vf1	VEGETATION			Planting of vegetation to stabilize a slope or structure during construction.
Vf2	VEGETATION			Planting of vegetation to stabilize a slope or structure during construction.
Vf3	VEGETATION			Planting of vegetation to stabilize a slope or structure during construction.
Vf4	VEGETATION			Planting of vegetation to stabilize a slope or structure during construction.
Vf5	VEGETATION			Planting of vegetation to stabilize a slope or structure during construction.
Vf6	VEGETATION			Planting of vegetation to stabilize a slope or structure during construction.
Vf7	VEGETATION			Planting of vegetation to stabilize a slope or structure during construction.
Vf8	VEGETATION			Planting of vegetation to stabilize a slope or structure during construction.
Vf9	VEGETATION			Planting of vegetation to stabilize a slope or structure during construction.
Vf10	VEGETATION			Planting of vegetation to stabilize a slope or structure during construction.
Vf11	VEGETATION			Planting of vegetation to stabilize a slope or structure during construction.
Vf12	VEGETATION			Planting of vegetation to stabilize a slope or structure during construction.
Vf13	VEGETATION			Planting of vegetation to stabilize a slope or structure during construction.
Vf14	VEGETATION			Planting of vegetation to stabilize a slope or structure during construction.
Vf15	VEGETATION			Planting of vegetation to stabilize a slope or structure during construction.
Vf16	VEGETATION			Planting of vegetation to stabilize a slope or structure during construction.
Vf17	VEGETATION			Planting of vegetation to stabilize a slope or structure during construction.
Vf18	VEGETATION			Planting of vegetation to stabilize a slope or structure during construction.
Vf19	VEGETATION			Planting of vegetation to stabilize a slope or structure during construction.
Vf20	VEGETATION			Planting of vegetation to stabilize a slope or structure during construction.

CONSTRUCTION SCHEDULE

INSTALLATION OF SED. CONTROL MEASURES	MAINTENANCE OF EROSION AND SEDIMENT CONTROL MEASURES	CLEARING & GRUBBING	GRADING	GRASSING-MULCHING, TEMP & PERMANENT
WEEK 1	WEEK 1	WEEK 1-2	WEEK 2	WEEK 2
COMPLETION	COMPLETION		COMPLETION	COMPLETION

SOIL SERIES:
wgB2 - Wickham fine sandy loam, 2 to 6 percent slopes, eroded

NOTE:
ANY DISTURBED AREA LEFT EXPOSED FOR A PERIOD GREATER THAN 14 DAYS SHALL BE STABILIZED WITH MULCH OR TEMPORARY SEEDING

EROSION CONTROL MEASURES WILL BE MAINTAINED AT ALL TIMES. IF FULL IMPLEMENTATION OF THE APPROVED PLAN DOES NOT PROVIDE FOR EFFECTIVE EROSION CONTROL, ADDITIONAL EROSION AND SEDIMENT CONTROL MEASURES SHALL BE IMPLEMENTED TO CONTROL OR TREAT THE SEDIMENT SOURCE.

THE DESIGN PROFESSIONAL WHO PREPARED THE ES&PC PLAN IS TO INSPECT THE INSTALLATION OF THE INITIAL SEDIMENT STORAGE REQUIREMENTS AND PERIMETER CONTROL BMP'S WITHIN 7 DAYS AFTER INSTALLATION.

THE ESCAPE OF SEDIMENT FROM THE SITE SHALL BE PREVENTED BY THE INSTALLATION OF EROSION AND SEDIMENT CONTROL MEASURES AND PRACTICES PRIOR TO LAND DISTURBING ACTIVITIES.

WASTE MATERIALS SHALL NOT BE DISCHARGED TO WATERS OF THE STATE, EXCEPT AS AUTHORIZED BY A SECTION 404 PERMIT

NON-EXEMPT ACTIVITIES SHALL BE CONDUCTED WITHIN THE 25 OR 50 FOOT UNDISTURBED STREAM BUFFERS AS MEASURED FROM THE POINT OF WHERE VEGETATION OR WITHIN 5 FEET OF THE INSTALLED MARSH BUFFER MEASUREMENT FROM THE JURISDICTION DETERMINATION WITHOUT FIRST ACQUIRING THE NECESSARY VARIANCES AND PERMITS

AMENDMENTS/REVISIONS TO THE ES&PC PLAN WHICH HAVE A SIGNIFICANT EFFECT ON BMP'S WITH A HYDRAULIC COMPONENT MUST BE CERTIFIED BY THE DESIGN PROFESSIONAL

TOTAL ACREAGE: 0.90 AC
TOTAL DISTURBED ACREAGE: 0.41 AC

SEDIMENT CONTROL CALCULATIONS

Disturbed Area (acres)	Runoff Vol. of Control (cubic yard)	BMP's Utilized	Actual Vol. of Sediment per BMP (cubic yard)	Total Actual Vol. of Sediment (cubic yard)
0.41	28	1. Sd1 2. Ds1 3. Du1	22	52

Calculations based upon the following:
Assumes a silt fence placed on a 2:1 slope and allowed to fill 3 feet, i.e., volume = $\frac{1}{2}(8' \times 3') \times \text{length, ft.} = 9 \text{ cu. ft./ft. or } 0.33 \text{ cu. yd./ft.}$



BEARINGS ARE BASED ON NORTH AMERICAN DATUM OF 1983 GEORGIA STATE PLANE COORDINATE SYSTEM (WESTERN ZONE) ELEVATIONS ARE BASED ON NORTH AMERICAN VERTICAL DATUM OF 1988

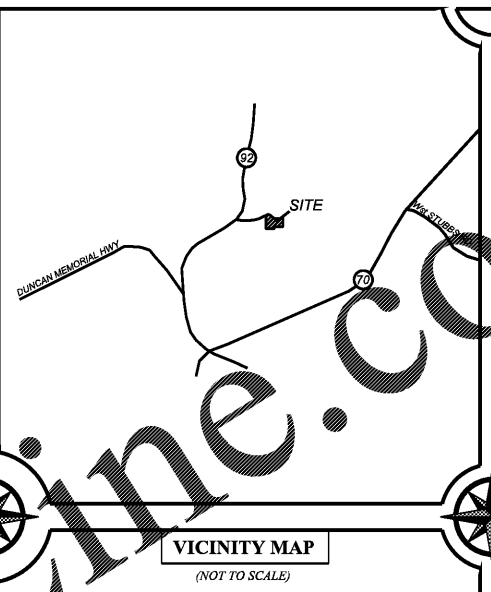
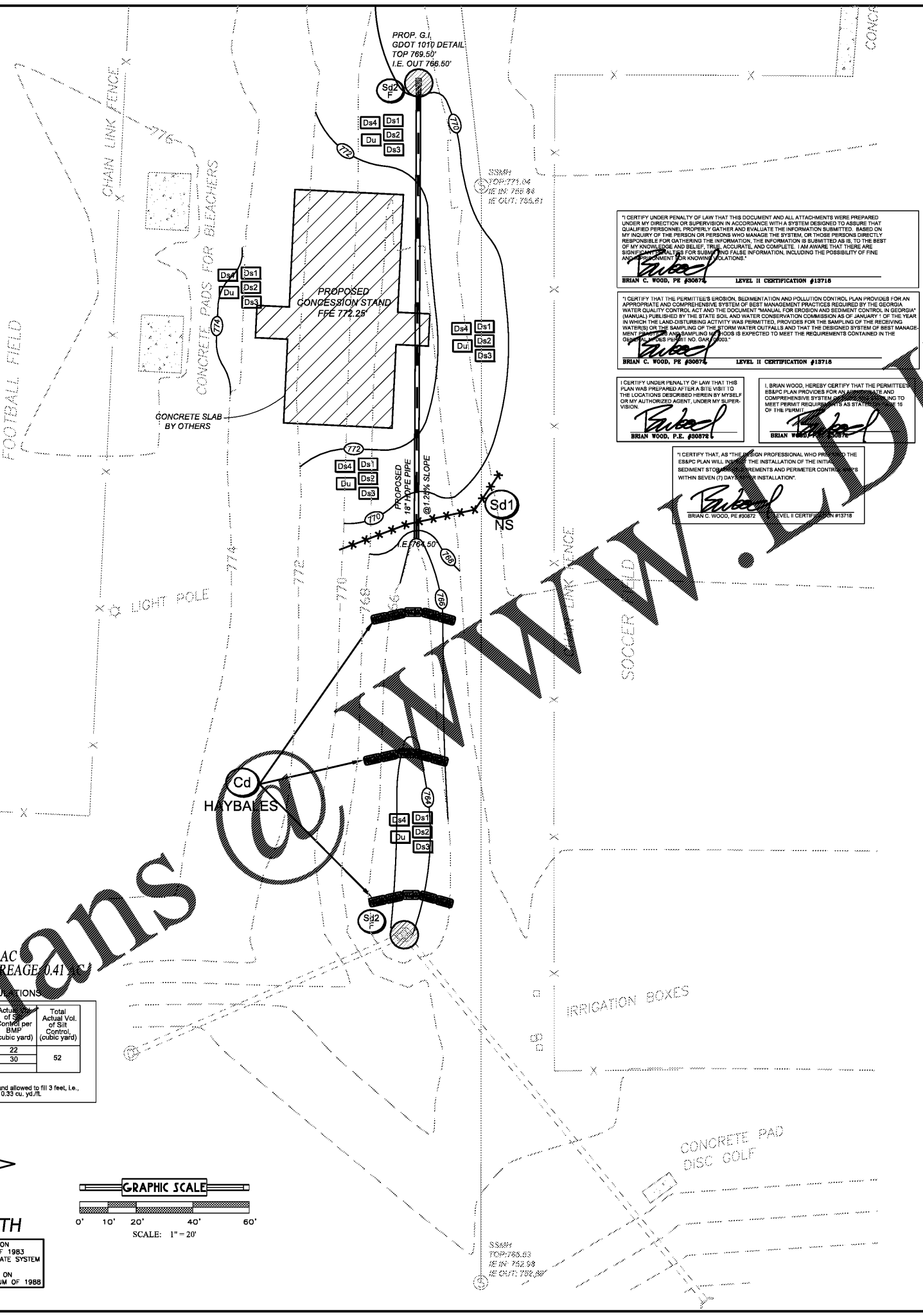
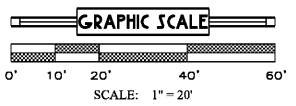

PROJECT DATA

- AUTHORIZED AGENT: DUSOUTH SURVEYING & ENGINEERING, INC.
CONTACT: JERRY D. WOOD, GRS
22 BARNETT SHOALS ROAD
WATKINSVILLE, GA 30677
- TOTAL PROJECT ACREAGE: 0.90 ACRES
 - TAX PARCEL #: 01400150006
 - FLOOD PLAIN: A PORTION OF THE PROPERTY LIES WITHIN A FLOOD ZONE ACCORDING TO FIRM COMMUNITY PANEL NUMBER 13097C0166D, DATED MARCH 4, 2013.
 - UNDERGROUND UTILITY SERVICES SUCH AS ELECTRIC, WATER, GAS, SANITARY SEWER LINES OR WELLS MAY OR MAY NOT EXIST AND MAY OR MAY NOT BE SHOWN HEREON.
 - TOPOGRAPHIC INFORMATION: FIELD RUN BY DUSOUTH SURVEYING & ENGINEERING, INC. MARCH 2018.
 - THERE ARE NO STATE WATERS LOCATED WITHIN 200' OF THE SITE.

- GENERAL EROSION CONTROL NOTES:
- A PERMANENT GROUND COVER WILL BE ESTABLISHED IN ACCORDANCE TO THE VEGETATIVE PLAN SHOWN ON THE BMP DETAIL SHEET.
 - ALL EROSION CONTROL MEASURES MUST BE CHECKED DAILY AND MAINTAINED AS NECESSARY TO PREVENT EROSION.
 - EROSION AND SEDIMENTATION CONTROL MEASURES SHALL BE MAINTAINED AT ALL TIMES. ADDITIONAL EROSION AND SEDIMENTATION CONTROL MEASURES AND PRACTICES SHALL BE INSTALLED IF DEEMED NECESSARY BY ON-SITE INSPECTIONS.
 - THE INSTALLATION OF EROSION AND SEDIMENTATION CONTROL MEASURES AND PRACTICES SHALL OCCUR PRIOR TO OR CONCURRENT WITH LAND-DISTURBING ACTIVITIES.
 - MAINTENANCE OF ALL SOIL EROSION AND SEDIMENTATION CONTROL MEASURES AND PRACTICES, WHETHER TEMPORARY OR PERMANENT, SHALL BE AT ALL TIMES THE RESPONSIBILITY OF THE PROPERTY OWNER.
 - THE ESCAPE OF SEDIMENT FROM THE SITE SHALL BE PREVENTED BY THE INSTALLATION OF EROSION AND SEDIMENT CONTROL MEASURES AND PRACTICES PRIOR TO, OR CONCURRENT WITH, LAND-DISTURBING ACTIVITIES.
 - EROSION CONTROL MEASURES WILL BE MAINTAINED AT ALL TIMES. IF FULL IMPLEMENTATION OF THE APPROVED PLAN DOES NOT PROVIDE FOR EFFECTIVE EROSION CONTROL, ADDITIONAL EROSION AND SEDIMENT CONTROL MEASURES SHALL BE IMPLEMENTED TO CONTROL OR TREAT THE SEDIMENT SOURCE. PRACTICES WILL BE CHECKED DAILY.
 - Ds1-Ds2-Ds3-Su-Mb ON ALL SLOPES AND TYPE "S" Sd1 IN ALL CRITICAL AREAS; NO CRITICAL AREAS ARE ANTICIPATED TO OCCUR ON SITE.
 - STANDARDS AND SPECIFICATIONS: ALL DESIGNS WILL CONFORM TO AND ALL WORK WILL BE PERFORMED IN ACCORDANCE WITH THE SPECIFICATIONS OF THE PUBLICATION ENTITLED "MANUAL FOR EROSION AND SEDIMENT CONTROL IN GEORGIA."
 - ADDITIONAL MEASURES WILL BE ADDED IF DETERMINED TO BE NEEDED BY ON-SITE INSPECTIONS.
 - NO PORTION OF THE PROPERTY SHOWN HEREON IS IN A DESIGNATED FLOOD HAZARD AREA ACCORDING TO THE COMMUNITY NO. # 13097C0166D, DATED MARCH 4, 2013.
 - THERE ARE NO WETLANDS SHOWN ON SITE PER THE NATIONAL WETLANDS INVENTORY MAPS.
 - NO DISPOSAL ON SITE: ALL CONSTRUCTION DEBRIS WILL BE DISPOSED IN A DOUGLAS COUNTY/STATE APPROVED LANDFILL.
 - NO STAGING AREAS ON SITE FOR PETROLEUM PRODUCTS, CONSTRUCTION PRODUCTS SUCH AS PAINTS AND STAINS, OR CHEMICAL PRODUCTS SUCH AS PESTICIDES, HERBICIDES, OR FERTILIZERS.
 - A 25 FOOT UNDISTURBED BUFFER ADJACENT TO ALL STREAMS, CREEKS, LAKES, PONDS, ETC. IS REQUIRED TO BE MAINTAINED BY THE SOIL EROSION AND SEDIMENT CONTROL ORDINANCE (ARTICLE 4 SECTION 4.3 PARAGRAPH 15).
 - A DOUBLE ROW OF TYPE "C" SILT FENCE IS REQUIRED ALONG ALL 25' UNDISTURBED BUFFERS. SEDIMENT STORAGE MAINTENANCE INDICATORS MUST BE INSTALLED IN SEDIMENT STORAGE STRUCTURES, INDICATING THE 1/3 FULL VOLUME.
 - THE Sd2-F AND Sd2-P IS NOT TO BE USED CONCURRENTLY IN THE AREA OF APPLICATION. Sd2-P IS TO BE USED AFTER THE INSTALLATION OF PAVEMENT. IN ADDITION, EXCAVATED INLET TRAPS MAY BE USED. THE ADDITIONAL STORAGE PROVIDED BY THE USE OF Sd2-P (SEE DETAIL) HAS NOT BEEN INCORPORATED INTO THE SILT CALCULATIONS. THIS ADDITIONAL STORAGE IS ABOVE AND BEYOND THE 67 CY/AC REQUIRED FOR EACH BASIN.
 - WATERING OR IRRIGATION WILL BE USED IN ACCORDANCE WITH PAGE 8-42 OF THE FIFTH EDITION MANUAL FOR EROSION AND SEDIMENTATION CONTROL IN GEORGIA.
 - NO SLOPES TO EXCEED 3 TO 1. CRITICAL AREAS ARE AT ALL DETENTION PONDS, ALL SLOPES GREATER THAN 2.5 TO 1, AND ALL SLOPES GREATER THAN 10 FEET IN HEIGHT.
 - WASTE DISPOSAL: SOIL MATERIALS, INCLUDING BUILDING MATERIALS, SHALL NOT BE DISCHARGED TO WATERS OF THE STATE, EXCEPT AS AUTHORIZED BY A SECTION 404 PERMIT.
 - THE SOIL EROSION AND SEDIMENT CONTROL PLAN IS IN COMPLIANCE WITH WASTE DISPOSAL, SANITARY SEWER, OR SEPTIC TANK REGULATIONS.
 - NON-EXEMPT ACTIVITIES SHALL NOT BE CONDUCTED WITHIN THE 25' UNDISTURBED STATE BUFFERS AS MEASURED FROM THE POINT OF WRESTED VEGETATION WITHOUT FIRST ACQUIRING THE NECESSARY VARIANCES AND PERMITS.
 - AMENDMENTS TO THE PLAN THAT HAVE A SIGNIFICANT EFFECT ON BMP'S WITH A HYDRAULIC COMPONENT MUST BE CERTIFIED BY THE DESIGN PROFESSIONAL.

CHANGES	DATE

DATE
03-28-18

PROJECT
18-056

EROSION CONTROL PLAN

SHEET
2 of 3



LEVEL II CERTIFICATION #13718

DUSOUTH
SURVEYING & ENGINEERING, INC.
22 BARNETT SHOALS RD.
WATKINSVILLE, GA 30677
706.310.1961 OFFICE
Email: dusouthsurveying@gmail.com
Online: www.dusouthsurveying.com

SITE PLAN FOR:
**DOUGLAS COUNTY
CONCESSION
STAND**

5000 HWY 92
DOUGLASVILLE, GA
DOUGLAS COUNTY, GEORGIA