

FOOTBALL FIELD

LANDSCAPING NOTES:

1. PROVIDE PINE STRAW MULCH AROUND ALL TREES AND SHRUBS
2. PROVIDE WATER ON ALL SHRUBS AND GATOR BAGS ON TREES.
3. PROVIDE A TWO-YEAR TREE AND SHRUB MAINTENANCE BOND.
4. PARKING LOT ISLANDS, PENINSULAS AND MEDIANS MUST HAVE CLEAN, CULTIVATED SOIL TO A TOTAL DEPTH OF ONE AND ONE-HALF (1.5) FEET. NATIVE SUBSOIL IS ACCEPTABLE IN THESE AREAS OF THE SOIL IS AMENDED WITH APPROPRIATE SOIL AMENDMENTS AND THOROUGHLY TILLED. OTHERWISE, LOAMY TOPSOIL IS REQUIRED.
5. PROVIDE HYDRO SEEDING.

DOUGLAS COUNTY BOUNDARY WATERS PARK

1. A PRECONSTRUCTION LANDSCAPE CONFERENCE IS REQUIRED FOR THIS PROJECT. CALL THE GREENWOOD COUNTY ARBORIST. THERE ARE CRITICAL FACTORS ON THE LANDSCAPE PLAN THAT AFFECT BOTH THE GENERAL CONTRACTOR AND THE LANDSCAPE CONTRACTOR. PLANTING AREA DIMENSIONS, PLANTING METHODS AND AS WELL AS PLANT MATERIALS MUST BE IN ACCORDANCE WITH THE APPROVED PLAN, OR THE LANDSCAPE INSPECTOR MAY DELAY THE RELEASE OF THE CERTIFICATE OF OCCUPANCY.
2. THE SITE CONTRACTOR SHALL COORDINATE SERVICE ROUTING OF ALL GAS, TELEPHONE, AND ELECTRICAL LINES WITH THE APPROPRIATE UTILITY COMPANY. ALL CONSTRUCTION MUST COMPLY WITH EACH UTILITY'S STANDARDS AND SPECIFICATIONS AND NOT INTERFERE WITH TREE PLANTING SITES TO BE PRESERVED.
3. TREE PROTECTION DEVICES MUST BE INSTALLED AND INSPECTED PRIOR TO ANY CLEARING, GRUBBING OR GRADING. FOR PROJECTS OVER (2) ACRES
4. ISLANDS AND MEDIANS MUST BE COVERED WITH FOUR (4) INCHES OF ORGANICAL MULCH MATERIAL (REPLACE PERIODICALLY). TO DISCOURAGE SOIL COMPACTION FROM PEDESTRIAN TRAFFIC, THESE AREAS MAY BE PLANTED WITH LOW EVERGREEN SHRUBS, BUT NOT GRASS.
5. WHEN DIGGING NEAR TREES, THE CONTRACTOR SHALL PRUNE ALL EXPOSED ROOTS ONE (1) INCH IN DIAMETER AND LARGER ON THE SIDE OF THE TRENCH ADJACENT TO THE TREES. PRUNING SHALL CONSIST OF MAKING A CLEAN CUT FLUSH WITH THE SIDE OF THE TRENCH TO PROMOTE NEW ROOT GROWTH.
7. PROTECT THE TRUNKS OF ANY TREES BEING PRESERVED WITHIN THE TEMPORARY OR PERMANENT EASEMENTS WITH STRAP ON PLANKING OR SIMILAR PROTECTIVE DEVICE.

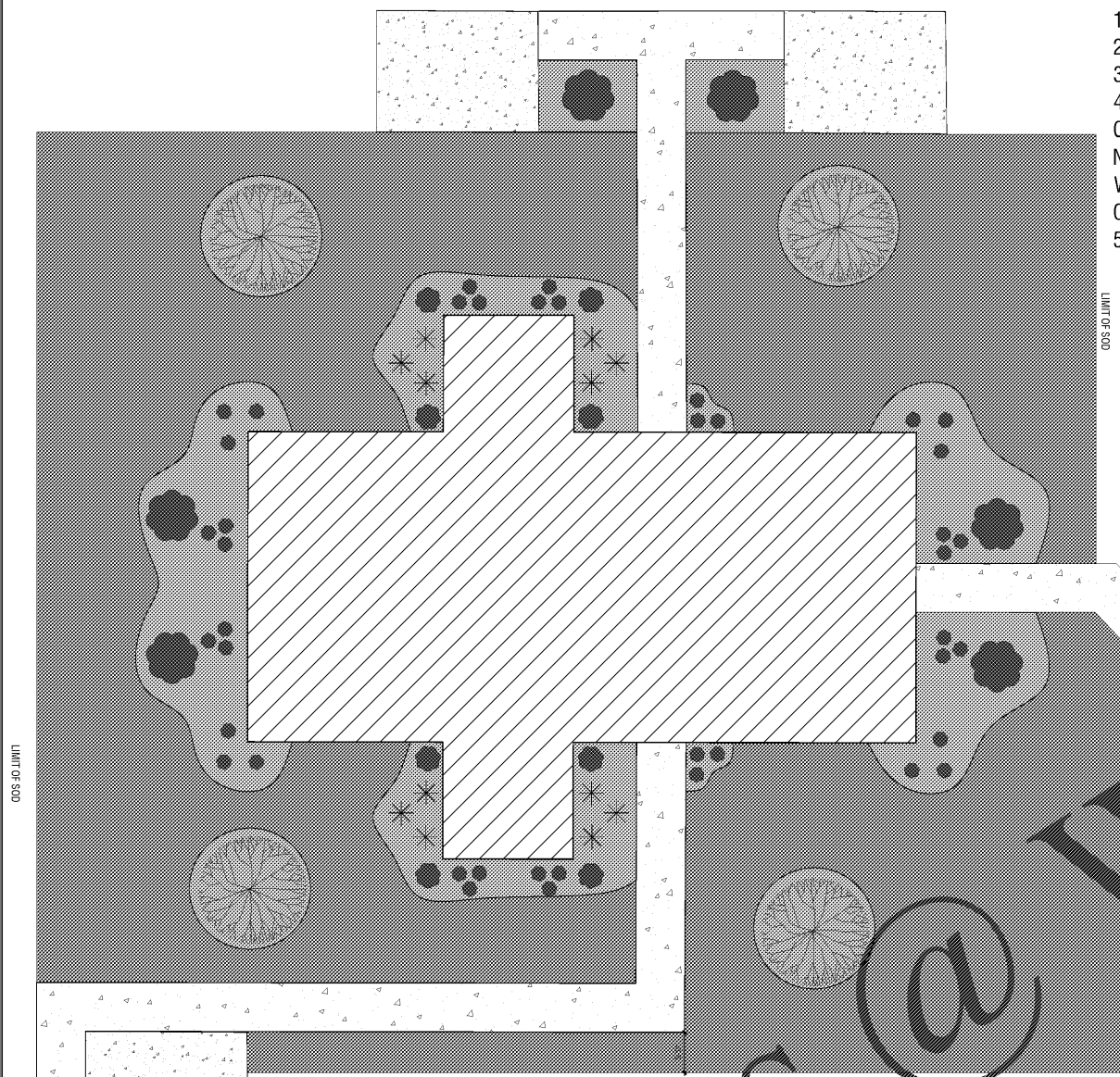

LANDSCAPING SCHEDULE

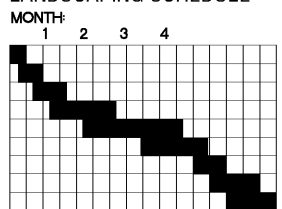

CLEARING AND GRUBBING
 INSTALL CONSTRUCTION OUTLET
 INSTALL PERIMETER SILT FENCE
 ROUGH GRADING AND TEMPORARY GRASSING
 INSTALL WATER, SANITARY & STORM SEWER UTILITIES
 INSTALL SE&SC MEASURES AROUND UTILITY STRUCTURES
 INSTALL OF CURB AND GUTTER AND PAVING
 FINAL GRADING & ESTABLISH PERMANENT GRASSING
 REMOVAL OF SEDIMENT CONTROL STRUCTURES

1. THE TIME AND PERIODS ABOVE ARE NOT EXACT OR READILY DETERMINABLE

1 LANDSCAPE PLAN
1/8" = 1'-0"

| | |
|--|--|
| | 3" CALIPER TRIDENT MAPLE |
| | 6" SINGLE TRUNK KOUSA DOGWOOD "SUMMER STARS" |
| | 3 GALLON LOROPETALUM "CRIMSON FIRE" |
| | 3 GALLON INDIAN HAWTHORNE "ROSALINDA" |
| | 3 GALLON KNOCKOUT ROSE "RADRAZZ" |

| REVISION NUMBER | DATE | REMARKS | NUMBER | DATE | REMARKS |
|-----------------|----------|---------|--------|------|---------|
| 1 | 00-00-00 | N/A | | | |

CONSULTANTS

CARTER WATKINS ASSOCIATES ARCHITECTS, INC.
 POST OFFICE BOX 1064
 137 EAST WASHINGTON STREET
 MONROE, GEORGIA 30655
 Fax: 770-267-1064
 email@carterwatkins.com www.carterwatkins.com

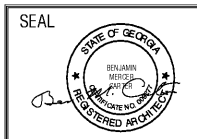

DOUGLAS COUNTY BOUNDARY WATERS PARK CONCESSION STAND
 DOUGLASVILLE, GEORGIA

| | |
|--------------------------------|--------------------------|
| SHEET TITLE: LANDSCAPE PLAN | NUMBER: LS 1.0 |
| PRINTED: | |

DATE: 06/19/18
PRINTED

Order Plans

WWW.LDPLANS.COM

The Document is the property of Carter Watkins Associates. Reproduction of any kind is prohibited under Federal Copyright Laws.