

| REVISIONS/ISSUANCES | | |
|---------------------|------|-------------|
| NO. | DATE | DESCRIPTION |
| | | |
| | | |
| | | |

NOTES: (THIS SHEET ONLY)

- 1. PROVIDE AUDIO VISUAL CONNECTIVITY AND COMPONENTS, SEE DETAIL.
- 2. GENERAL ROUTE ALL DATA CABLES TO DM-4.
- 3. PROVIDE AUDIO VISUAL CONTROLLER PER DETAIL AND SPECIFICATIONS.
- 4. PROVIDE TWO RACK MOUNTABLE POWER STRIPS PER RACK AND CONNECT THEM TO POWER OUTLETS.
- 5. EXISTING TWO POST RACK, PROVIDE NEW RACK FOR SPECIFIED COMPONENTS.
- 6. PROVIDE SPECIFIED DATA NETWORK SWITCHES, PATCH PANELS, WIRE MANAGERS, PATCH CORDS AND ETC. IN NEW DATA NETWORK RACK FOR ALL NEW PORTS SHOWING. INTERCONNECT NEW SWITCHES TO EXISTING CCCC CATALYTIC THIS SERIES SWITCHES WITH STACKING CABLES AND WITH FIBER OPTIC CABLE SFP NETWORK MODULE.

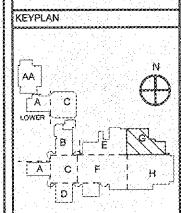

AH&P
CONSULTING ENGINEERS
ANDREWS, HAMMOND & POWELL, INC.
250 Charter Lane
Suite 100
Macon, Georgia 31210
Macon (478) 485-8301
FAX (478) 485-8210
WWW.AHPENR.COM



Manley Spangler Smith Architects
A Professional Corporation

505 East Taylor St.
P.O. Box 680
Griffin, Georgia 30224
Office 770.227.5473
Fax 770.228.3442

PROJECT:
RENOVATIONS, MODIFICATIONS, & ADDITIONS TO HENRY COUNTY SCHOOLS - GROUP 18 WOODLAND HIGH SCHOOL (ITEM C)

CLIENT:
HENRY COUNTY BOARD OF EDUCATION

SHEET TITLE:
ELECTRICAL NEW WORK LOW VOLTAGE PLAN - SECTOR "G"

1.11.88
F.T.E. - 1.887
FACILITY CODE: 675-0408
© 2018 Manley Spangler Smith Architects, P.C.
PROJECT NUMBER: 201721C
DATE: 08.07.18
SCALE: 1/8"=1'-0"
DRAWN BY: AAS
CHECKED BY: MPO

SHEET NO.: E310

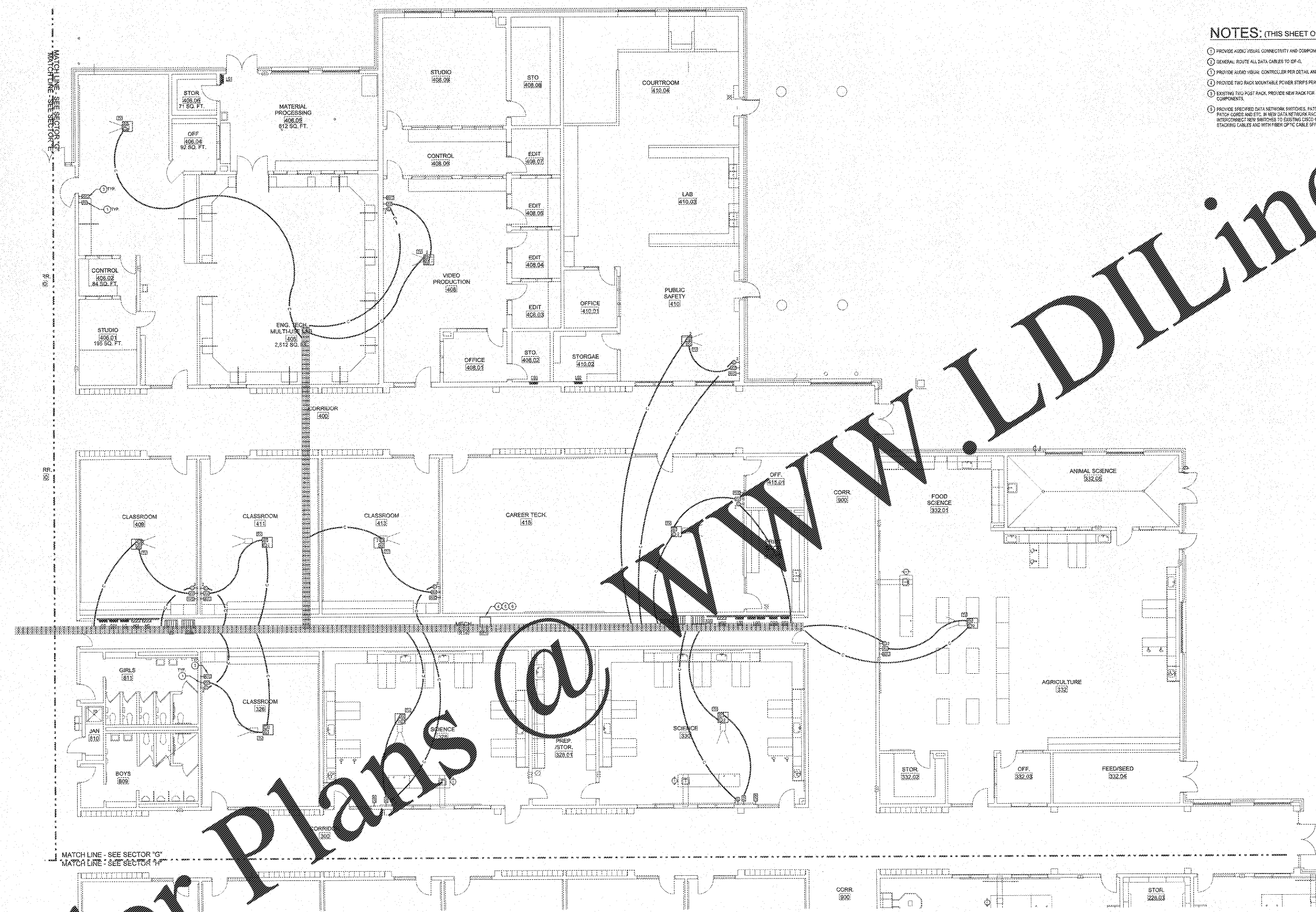

ELECTRICAL NEW WORK LOW VOLTAGE PLAN - SECTOR "G"
SCALE: 1/8"=1'-0"

NOTE TO CONTRACTOR CONCERNING PROJECT PHASING:
THE WORK SHOWN ON THE DRAWINGS AND SPECIFICATIONS ILLUSTRATES THE COMPLETED CONTRACTUAL REQUIREMENTS. THIS PROJECT IS PHASED IN MULTIPLE PHASES. THE AREA OF EACH PHASE IS DESCRIBED IN THE ARCHITECTURAL DOCUMENTS AND THE CONTRACTOR SHALL REVIEW THESE PHASING REQUIREMENTS. CONTRACTOR SHALL INCLUDE IN HIS BID ALL COSTS REQUIRED TO ACCOMPLISH THE CONTRACT IN PHASES. THE CONTRACT DOCUMENTS DO NOT DESCRIBE THE SPECIFIC WORK REQUIRED BY THE CONTRACTOR TO PREPARE THE PROJECT IN PHASES, BUT CONTRACTOR SHALL PREPARE PHASING PLAN AND SUBMIT TO ARCHITECT/ENGINEER AND HENRY COUNTY MAINTENANCE DEPARTMENT PRIOR TO BEGINNING WORK.

GENERAL NOTES

- CONTRACTOR SHALL ROUTE VOICE, DATA AND OTHER SYSTEMS IN CONDUIT FROM WALL CLOSET TO ABOVE CORRIDOR CEILING. CABLES SHALL TRAVEL IN ROUTED VIA JOISTS AND EXISTING CABLE TRAY SYSTEM TO RESTRICTION. JOISTS SHALL BE IDENTIFIED ON BOTH SIDES OF CORRIDOR IN "X" EXTENTS TO ACCESS EXISTING CABLE TRAY SYSTEM ABOVE CORRIDOR CEILING.
- ALL LOW VOLTAGE SYSTEMS ROUTED OUTSIDE OF BUILDING SHALL HAVE LIGHTNING PROTECTION APPLIED TO COPPER CABLES AS IT ENTERS THE BUILDING.
- ELECTRICAL INSTALLATIONS ON EXISTING WALLS SHALL HAVE CONDUIT METALLED CON-SHALED WITHIN MAZONRY. CONTRACTOR SHALL NOT UNDER ANY CIRCUMSTANCES UTILIZE BRASS OR METAL BRACKETRY TO INSTALL NEW BRACKETS. BRACKETS SHALL BE CUT INTO EXISTING MASONRY WITH FILE CONDUIT FINISH IN EXISTING WALL FROM ABOVE ACCESSIBLE CEILING.

Order Plans @

WWW.LDILine.com