

NOTES: (THIS SHEET ONLY)

- 1 PROVIDE AUDIO VISUAL CONNECTIVITY AND COMPONENTS. SEE DETAIL.
- 2 PROVIDE HALL BRACKET MOUNTED INTERACTIVE WHITEBOARD WITH ARM MOUNTED SHORT THROW PROJECTOR FOR THIS CLASSROOM AS SPECIFIED.
- 3 PROVIDE AUDIO VISUAL CONTROLLER PER DETAIL AND SPECIFICATIONS.
- 4 PROVIDE TWO RACK MOUNTABLE POWER STRIPS PER BACK AND CONNECT THEM TO POWER OUTLETS.
- 5 EXISTING TWO POST RACK IS FULLY POPULATED. PROVIDE NEW RACK FOR SPECIFIED COMPONENTS.
- 6 PROVIDE SPECIFIED DATA NETWORK SWITCHES, PATCH PANELS, WIRE MANAGERS, PATCH CORDS AND PATCH PANELS FOR ALL NEW PORTS. SHOWN INTERCONNECT NEW SWITCHES TO EXISTING CISCO CATALYST 3850 SERIES SWITCHES WITH STACKING CABLES AND WITH FIBER OPTIC CABLE OFF NETWORK MODULE.
- 7 GENERAL ROUTE ALL DATA CABLES TO IDF-E.

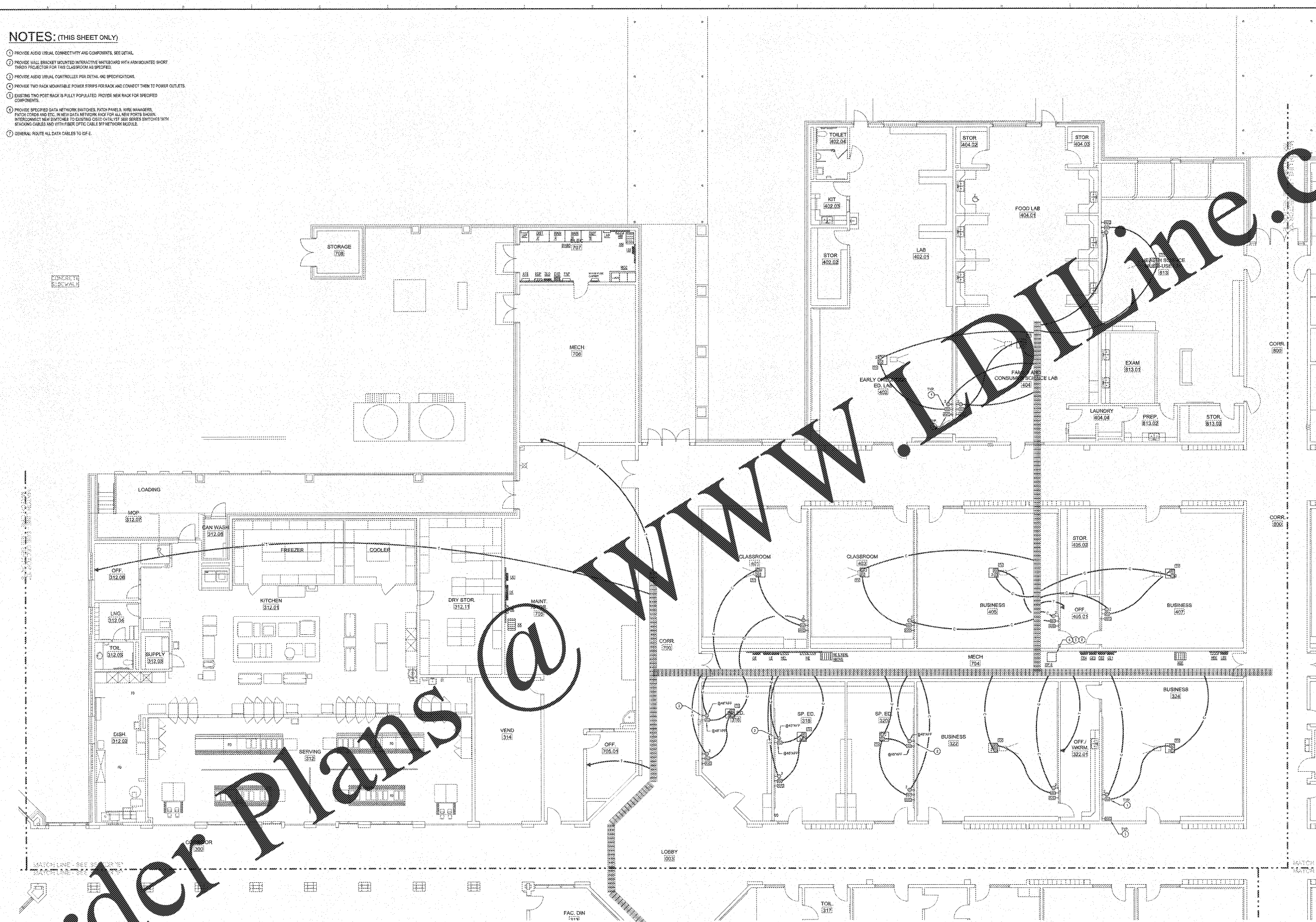

REVISIONS/ISSUANCES		
NO.	DATE	DESCRIPTION

AH&P
ENGINEERS
ANDREWS, HARRICK & POWELL, INC.
250 Chalmers Lane
Suite 100
Macon, Georgia 31210
Macon (478) 405-8301
FAX (478) 405-8210
WWW.AHPENR.COM



Manley Spangler Smith Architects
A Professional Corporation

825 East Taylor St.
P.O. Box 883
Guthrie, Georgia 30224
Office 770.227.5473
Fax 770.228.3442

PROJECT: RENOVATIONS, MODIFICATIONS, & ADDITIONS TO HENRY COUNTY SCHOOLS - GROUP 40 WOODLAND HIGH SCHOOL (ITEM C)

CLIENT: HENRY COUNTY BOARD OF EDUCATION

SHEET TITLE: ELECTRICAL NEW WORK LOW VOLTAGE PLAN - SECTOR "E"

LU: 88
P.T.S.: 1,687
FACILITY CODE: 875-608
PROJECT NUMBER: 201731-C
DATE: 06.07.13
SCALE: 1/8"=1'-0"
DRAWN BY: AJS
CHECKED BY: NHO

SHEET NO.: E308

GENERAL NOTES

1. CONTRACTOR SHALL PROVIDE ALL DATA AND OTHER SYSTEMS IN CONJUNCTION WITH THIS PROJECT. CONTRACTOR SHALL PROVIDE ALL TRUNKING ROUTED VIA J-HAT AND EXISTING TRUNKING SHALL BE REUSED TO DESTROYED. WORKERS SHALL BE ADVISED OF CORRIDORS ON CEILING TO ACCESS EXISTING TRUNKING FROM AN APPROVED CORRIDOR CEILING.
2. ALL LOW VOLTAGE SYSTEMS ROUTED OUTSIDE OF ANEERS SHALL HAVE LIGHTNING PROTECTION AND TO COPPER CONDUCTOR AS IF IT WERE THE BUILDING.
3. ALL ELECTRICAL INSTALLATION ON EXISTING WALLS SHALL BE CONDUCTED IN CONCEALED MANNER. CONTRACTOR SHALL NOT UNDER ANY CIRCUMSTANCE, EXPOSE METAL MOUNTING TO EXISTING WALL DEVICES. SHALL BE CUT INTO EXISTING MASONRY WITH FLEX CONDUIT FISHED IN EXISTING WALL FROM ABOVE ACCESSIBLE CEILING.

NOTE TO CONTRACTOR CONCERNING PROJECT PHASING:

THE WORK SPECIFIED ON THE DRAWINGS AND SPECIFICATIONS ILLUSTRATES THE COMPLETED CONTRACTUAL REQUIREMENTS. THIS PROJECT IS PHASED IN MULTIPLE PHASES. THE AREA OF EACH PHASE IS DESCRIBED IN THE ARCHITECTURAL DOCUMENTS AND THE CONTRACTOR SHALL REVIEW THESE PHASING REQUIREMENTS. CONTRACTOR SHALL INCLUDE IN HIS BID ALL COSTS REQUIRED TO ACCOMPLISH THE CONTRACT IN PHASES. THE CONTRACT DOCUMENTS DO NOT DESCRIBE THE SPECIFIC WORK REQUIRED BY THE CONTRACTOR TO PERFORM THE PROJECT IN PHASES. THE CONTRACTOR SHALL PREPARE PHASING PLAN AND SUBMIT TO ARCHITECT/ENGINEER AND HENRY COUNTY MAINTENANCE DEPARTMENT PRIOR TO BEGINNING WORK.

ELECTRICAL NEW WORK LOW VOLTAGE PLAN - SECTOR "E"
SCALE: 1/8"=1'-0"