

NOTES: (THIS SHEET ONLY)

- PROVIDE CORNER MOUNT BRACKET FOR THIS CAMERA FOR FULL 180° VIEWING ANGLE.
- SMOKE DAMPER INTERFACE RELAY FURNISHED WITH FIRE ALARM SYSTEM. CONNECT TO AND THRU RELAY AS REQUIRED.
- DUCT MOUNTED SMOKE DETECTOR PROVIDED & WIRED BY DIVISION 28 FOR ROOF MOUNTED AIR CONDITIONERS, INSTALLED BY DIVISION 22.
- INSTALL REMOTE RESEAL FOR DUCT MOUNTED SMOKE DETECTOR IN ACCESSIBLE CEILING IN CORRIDOR.
- PROVIDE VANDAL RESISTANT DOME FOR THIS CAMERA. MOUNT AT 12' A.F.F.
- CONNECT FIRE PROTECTION SYSTEM FLOOR AND TAMPER SWITCHES TO FIRE ALARM SYSTEM.
- CONNECT TO EXISTING FIRE ALARM AND VOICE EVACUATION PANEL IN THE MAIN BUILDING. ROUTE CIRCUITS IN 1/2" CONDUIT AND PROVIDE LINE IDENTIFICATION AND RANGE SUPPRESSION DEVICES ON BOTH ENDS OF THE CIRCUIT EXTENDING INTO EACH BUILDING.
- CONNECT TO EXISTING DECENTRATED SYSTEM IN THE MAIN BUILDING. PROVIDE NOTED CONDUIT, WIRE CABLES, AND RANGE SUPPRESSION DEVICES ON BOTH ENDS OF THE CABLE CIRCUIT EXTENDING INTO EACH BUILDING.
- PROVIDE ACCESS POINT MOUNTING BRACKET FOR CYMBALUS AT THIS ACCESS POINT.
- PROVIDE AUDIO VISUAL PRIVACY AND LOCKOUT. SEE DETAILS.
- PROVIDE AUDIO VISUAL CONFERENCE. PER DETAIL. SEE SPECIFICATIONS.

REVISIONS/ISSUANCES		
NO.	DATE	DESCRIPTION

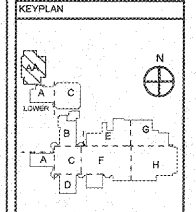

AH&P
CONSULTING ENGINEERS
ANDREWS, HAMMOCK & FOWELL, INC.
251 Charter Lane
Suite 100
Macon, Georgia 31210
Macon (478) 405-8301
FAX (478) 405-8210
WWW.AHPENGR.COM



Manley Spangler Smith Architects
A Professional Corporation

525 East Taylor St.
P.O. Box 680
Griffin, Georgia 30224
Office 770.227.8473
Fax 770.228.3442

PROJECT: RENOVATIONS, MODIFICATIONS, & ADDITIONS TO HENRY COUNTY SCHOOLS - GROUP 11 WOODLAND HIGH SCHOOL (ITEM C)

CLIENT: HENRY COUNTY BOARD OF EDUCATION

SHEET TITLE: ELECTRICAL NEW WORK LOW VOLTAGE PLAN - SECTOR "AA"

DATE: 08.07.18
SCALE: 1/8"=1'-0"
DRAWN BY: AJB
CHECKED BY: NHO

SHEET NO.: E303

GENERAL NOTES

- CONTRACTOR SHALL ROUTE VOICE DATA AND OTHER SYSTEMS IN CONDUIT FROM TRAIL OUTLET TO ABOVE CORRIDOR CEILING. CABLES SHALL THEN BE ROUTED VIA J-hooks AND EXISTING CABLE TRAY SYSTEM TO DISTRIBUTION. J-hooks SHALL BE INSTALLED ON BOTH SIDES OF CORRIDOR OR A CENTURIES TO ACCESS EXISTING CABLE TRAY SYSTEM ABOVE CORRIDOR CEILING.
- ALL LOW VOLTAGE SYSTEMS ROUTED OUTSIDE OF BUILDING SHALL HAVE LIGHTNING PROTECTION APPLIED TO CORRESPONDING AS IT ENTERS THE BUILDING.
- ELECTRICAL INSTALLATIONS ON EXISTING WALLS SHALL HAVE CIRCUITS INSTALLED CONCEALED WITHIN MASONRY. CONTRACTOR SHALL NOT UNDER ANY CIRCUMSTANCE, UTILIZE EXISTING METAL RACKING TO INSTALL NEW DEVICES. BUSES SHALL BE CUT INTO EXISTING MASONRY WITH FLEX CONDUIT FISHED IN EXISTING WALL FROM ABOVE ACCESSIBLE CEILING.

NOTE TO CONTRACTOR CONCERNING PROJECT PHASING:

THE WORK SPECIFIED ON THE DRAWINGS AND SPECIFICATIONS ILLUSTRATED THE COMPLETED CONTRACTUAL REQUIREMENTS. THIS PROJECT IS PHASED IN MULTIPLE PHASES. THE AREA OF EACH PHASE IS DESCRIBED IN THE ARCHITECTURAL DOCUMENTS AND THE CONTRACTOR SHALL REVIEW THESE PHASING REQUIREMENTS. CONTRACTOR SHALL INCLUDE IN HIS/BY ALL COSTS REQUIRED TO ACCOMPLISH THE CONTRACT IN PHASES. THE CONTRACTOR SHALL NOT OBTAIN THE SPECIFIC WORK REQUIRED BY THE CONTRACTOR TO PERFORM THE PROJECT IN PHASES, BUT CONTRACTOR SHALL PREPARE PHASING PLAN AND SUBMIT TO ARCHITECT/ENGINEER AND HENRY COUNTY MAINTENANCE DEPARTMENT PRIOR TO BEGINNING WORK.

ELECTRICAL NEW WORK LOW VOLTAGE PLAN - SECTOR "AA"

SCALE: 1/8"=1'-0"

Order Plans @

WWW.LDILINE.COM