

**NOTES: (THIS SHEET ONLY)**

- ① PROVIDE AUDIO VISUAL CONNECTIVITY AND COMPONENTS. SEE DETAIL.
- ② PROVIDE AUDIO VISUAL CONTROLLER PER DETAIL AND SPECIFICATIONS.
- ③ PROVIDE TWO RACK MOUNTABLE POWER STRIPS PER RACK AND CONNECT THEM TO POWER OUTLETS.
- ④ EXISTING TWO POST RACK.
- ⑤ PROVIDE SPECIFIED DATA NETWORK SWITCHES, PATCH PANELS, WIRE MANAGERS, PATCH CORDS AND ETC. IN EACH DATA NETWORK RACK FOR ALL NEW PORTS SHOWN. INTERCONNECT NEW SWITCHES TO EXISTING CSDD CATALYST RISE SERVER SWITCHES WITH STACKING CABLES AND WITH FIBER OPTIC CABLES BY NETWORK MEDIA.
- ⑥ GENERAL: ROUTE ALL DATA CABLES ON THIS SHEET TO DF-A.

REVISIONS/ISSUANCES		
NO.	DATE	DESCRIPTION

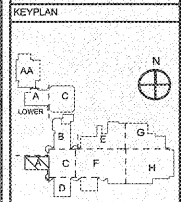

**AH&P**  
CONSULTING ENGINEERS

ANDREWS, HAMMOCK & POWELL, INC.  
250 Chatham Lane  
Suite 103  
MACON, GEORGIA 31210  
MACON (478) 405-8301  
FAX (478) 405-8210  
WWW.AHPENGR.COM



**Manley Spangler Smith Architects**  
A Professional Corporation

525 East Taylor St.  
P.O. Box 880  
Griffin, Georgia 30224  
Office 770.227.5473  
Fax 770.228.3442

PROJECT:  
RENOVATIONS,  
MODIFICATIONS, &  
ADDITIONS TO HENRY  
COUNTY SCHOOLS -  
GROUP 10  
WOODLAND HIGH SCHOOL  
(ITEM C)

CLIENT:  
HENRY COUNTY  
BOARD OF EDUCATION

SHEET TITLE:  
ELECTRICAL NEW WORK  
LOW VOLTAGE PLAN -  
SECTOR "A" UPPER  
LEVEL

1:11 = 88  
F.T.E. = 1,887  
FACILITY CODE: 675-0402

© 2018 Manley Spangler Smith Architects, PC  
PROJECT NUMBER: 201731C  
DATE: 06.07.18  
SCALE: 1/8"=1'-0"  
DRAWN BY: AJS  
CHECKED BY: HAD

SHEET NO.:  
E301

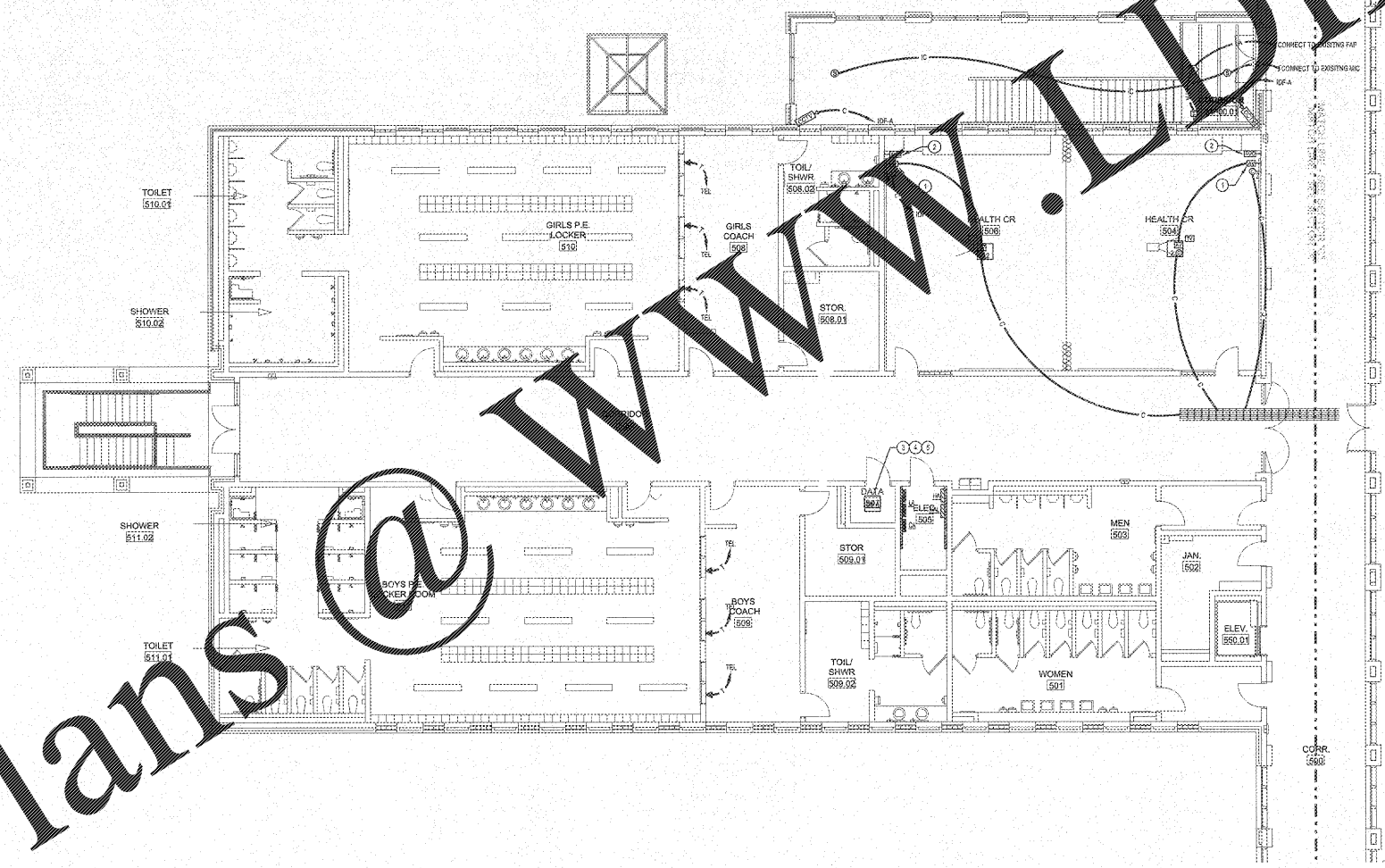

**ELECTRICAL NEW WORK LOW VOLTAGE PLAN - SECTOR "A" UPPER LEVEL**

SCALE: 1/8"=1'-0"

**GENERAL NOTES**

- CONTRACTOR SHALL ROUTE VOICE, DATA AND OTHER SYSTEMS IN CONDUIT FROM WALL OUTLET TO ABOVE CEILING OR BELOW. CABLES SHALL THEN BE ROUTED VIA HANGING LANE EXISTING CABLE TRAY SYSTEM TO DESTINATION. SWITCHES SHALL BE INSTALLED ON BOTH SIDES OF CONDUITORS OR IN CENTERS TO ACCESS EXISTING CABLE TRAY SYSTEM ABOVE CEILING.
- ALL LOW VOLTAGE SYSTEMS ROUTED OUTSIDE OF BUILDING SHALL HAVE LIGHTNING PROTECTION APPLIED TO CONDUIT CABLES AS IT ENTERS THE BUILDING.
- ELECTRICAL INSTALLATIONS ON EXISTING WALLS SHALL HAVE CONDUITS INSTALLED CONCEALED WITHIN MASONRY. CONTRACTOR SHALL NOT JUMP ANY CONCURRENCE. UTILIZE SURFACE METAL RACEWAY TO INSTALL NEW DEVICES. BOXES SHALL BE CUT INTO EXISTING MASONRY WITH FLEXI-CONDUIT FINISH IN EXISTING WALL FROM NEARLY ACCESSIBLE CEILING.

**NOTE TO CONTRACTOR CONCERNING PROJECT PHASING:**

THE WORK SHOWN ON THE DRAWINGS AND SPECIFICATIONS ILLUSTRATES THE COMPLETE CONTRACTUAL REQUIREMENTS. THIS PROJECT IS PHASED IN MULTIPLE PHASES. THE AREA OF EACH PHASE IS DESCRIBED IN THE ARCHITECTURAL DOCUMENTS AND THE CONTRACTOR SHALL REVIEW THESE PHASING REQUIREMENTS. CONTRACTOR SHALL INCLUDE IN HIS BID ALL COSTS REQUIRED TO ACCOMPLISH THE CONTRACT WORK. THE CONTRACT DOCUMENTS DO NOT DESCRIBE THE SPECIFIC WORK REQUIRED BY THE CONTRACTOR TO PERFORM THE PROJECT IN PHASES. BUT CONTRACTOR SHALL PREPARE PHASING PLAN AND SUBMIT TO ARCHITECT/ENGINEER AND HENRY COUNTY MAINTENANCE DEPARTMENT PRIOR TO BEGINNING WORK.

Order Plans @ [www.worldline.com](http://www.worldline.com)